

**AUSTIN COLOR GUARD
REGIONAL CONTEST INFORMATION
RA/IA/OPEN/WORLD PRELIMS
SA SEMIS/ALL CLASS FINALS
SATURDAY & SUNDAY, FEBRUARY 29 & MARCH 1, 2020**



LOCATION

Rouse High School
1222 Raider Way
Leander, TX 78641

EMERGENCY CONTACTS (DAY OF SHOW ONLY)

CONTEST ADMINISTRATOR: Stephanie Bonebrake / 817-781-7995 / Stephanie@wgi.org
CONTEST ADMINISTRATOR (SA SEMI FINALS ONLY): AJ Kise / 484-934-4578 / aj@wgi.org
EVENT PARTNER: Jason Robb / 936-662-7306 / jason.robb@leanderisd.org

JUDGE PANEL

Panels are available in this packet.

COMPETITIONSUITE DETAILS

ACCESSING YOUR GROUP - <https://help.competitionsuite.com/article/16-accessing-your-group>

ADDING YOUR STAFF - <https://help.competitionsuite.com/article/61-adding-staff-members>

ACCESSING COMMENTARY - <https://help.competitionsuite.com/article/17-accessing-commentary>

MUSIC UPLOADS - <https://help.competitionsuite.com/article/74-uploading-performance-music>

Score Summary Sheets are also located in your CompetitionSuite account with your overall score.

ADDITIONAL REGIONAL INFO

PRELIMS LOGISTICAL SCHEDULE - <https://tinyurl.com/w9926xk>

SA SEMI FINALS LOGISTICAL SCHEDULE - <https://tinyurl.com/r2xkncq>

FINALS LOGISTICAL SCHEDULE - <https://tinyurl.com/sxdthda>

WARM UP AREAS – Music is permitted at moderate levels in body and equipment warm up. If you wish to use music you must provide your own sound system.

SCORE POSTING – Posted in the Cafeteria

REGIONAL REMINDERS - <https://wgi.org/wp-content/uploads/2020/01/2020CGRegionalReminders.pdf>

Winter Guard International, Inc.

2405 Cross Pointe Drive, Miamisburg, OH 45342/ Phone: 937-247-5919/ Fax: 937-247-9212/ Email: office@wgi.org Web: <http://wgi.org>

AUSTIN COLOR GUARD REGIONAL CONTEST INFORMATION SA PRELIMS ONLY SATURDAY, FEBRUARY 29, 2020



LOCATION

Glenn High School
1320 Collaborative Way
Leander, TX 78641

EMERGENCY CONTACTS *(DAY OF SHOW ONLY)*

CONTEST ADMINISTRATOR: AJ Kise / 484-934-4578 / aj@wgi.org
EVENT PARTNER: Kim Shuttlesworth / 512-897-8697 / kim.shuttlesworth@leanderisd.org
PRACTICE CONTACT: Jason Robb / 512-570-2057 / jason.robb@leanderisd.org

JUDGE PANEL

Panels included in this packet.

COMPETITIONSUITE DETAILS

ACCESSING YOUR GROUP - <https://help.competitionsuite.com/article/16-accessing-your-group>

ADDING YOUR STAFF - <https://help.competitionsuite.com/article/61-adding-staff-members>

ACCESSING COMMENTARY - <https://help.competitionsuite.com/article/17-accessing-commentary>

MUSIC UPLOADS - <https://help.competitionsuite.com/article/74-uploading-performance-music>

Score Summary Sheets are also located in your CompetitionSuite account with your overall score.

ADDITIONAL REGIONAL INFO

PRELIMS LOGISTICAL SCHEDULE - <https://tinyurl.com/w7ymdx3>

WARM UP AREAS – Music is permitted at moderate levels in both body and equipment warm up. If you wish to use music you must provide your own sound system.

SCORE POSTING – Posted in the concession area.

REGIONAL REMINDERS - <https://wgi.org/wp-content/uploads/2020/01/2020CGRegionalReminders.pdf>



Austin Color Guard Regional Judge Panels

Saturday @ Glenn HS

	<i>Equipment</i>	<i>Movement</i>	<i>Design Analysis</i>	<i>General Effect</i>	
SA Prelims	Doug Henderson	Beverly Brahan	Brian Murphy	Chad Quamme	Michael Stone

T&P - Dan Middlesworth
Lead Judge - Beverly Brahan

Saturday @ Rouse HS

	<i>Equipment</i>	<i>Movement</i>	<i>Design Analysis</i>	<i>General Effect</i>	
IA/SO/IO/SW/IW Prelims	Kimberly Presley	Jackie Campbell	Travis Wingate	Paul Lampkin	Gilles Ouellette
SA Semis					

T&P - Michelle Hernandez
Lead Judge - Paul Lampkin

Sunday at Rouse HS Finals

	<i>Equipment</i>	<i>Movement</i>	<i>Design Analysis</i>	<i>General Effect</i>	
ALL Classes	Kimberly Presley	Beverly Brahan	Brian Murphy	Paul Lampkin	Michael Stone

T&P - Michelle Hernandez
LJ - Beverly Brahan

Rouse HS
Site Maps &
Performance
Area Info

WGI Austin Color Guard Regional Rouse High School



Bus/Truck/
Staff Parking

Color Guard
Check In

Guard Area

Spectator
Entrance

Prop Unload/
Load

Spectator Parking



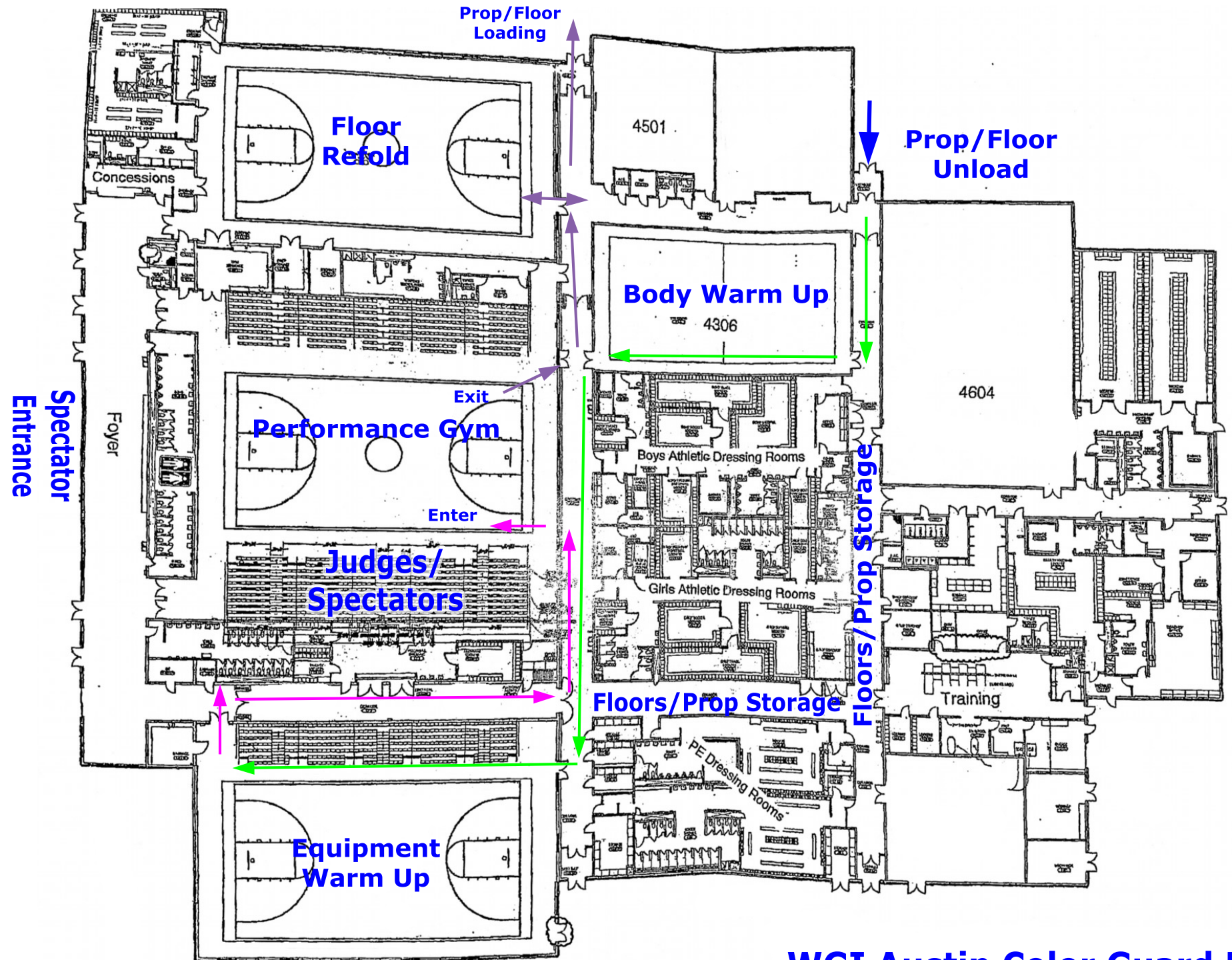

**WGI Austin Color Guard Regional
Rouse High School**



WGI Austin Regional Competition Area Rouse High School, Leander, TX

All WGI contest sites must have a minimum of seventy by one hundred feet (70' x 100') to accommodate a "safety zone" of five (5) feet from any spectator seating. If no spectators are seated on the left and right sides, then the safety zone will be eliminated on the left and right sides of the competition area and can extend to a maximum of 106'X 78'.

The "competition area" at this event measures 100'X 72'. All performing groups must be prepared to perform within that area. Floors (tarps) may not extend into the safety zones per rules found in the WGI Adjudication Manual and Rulebook.

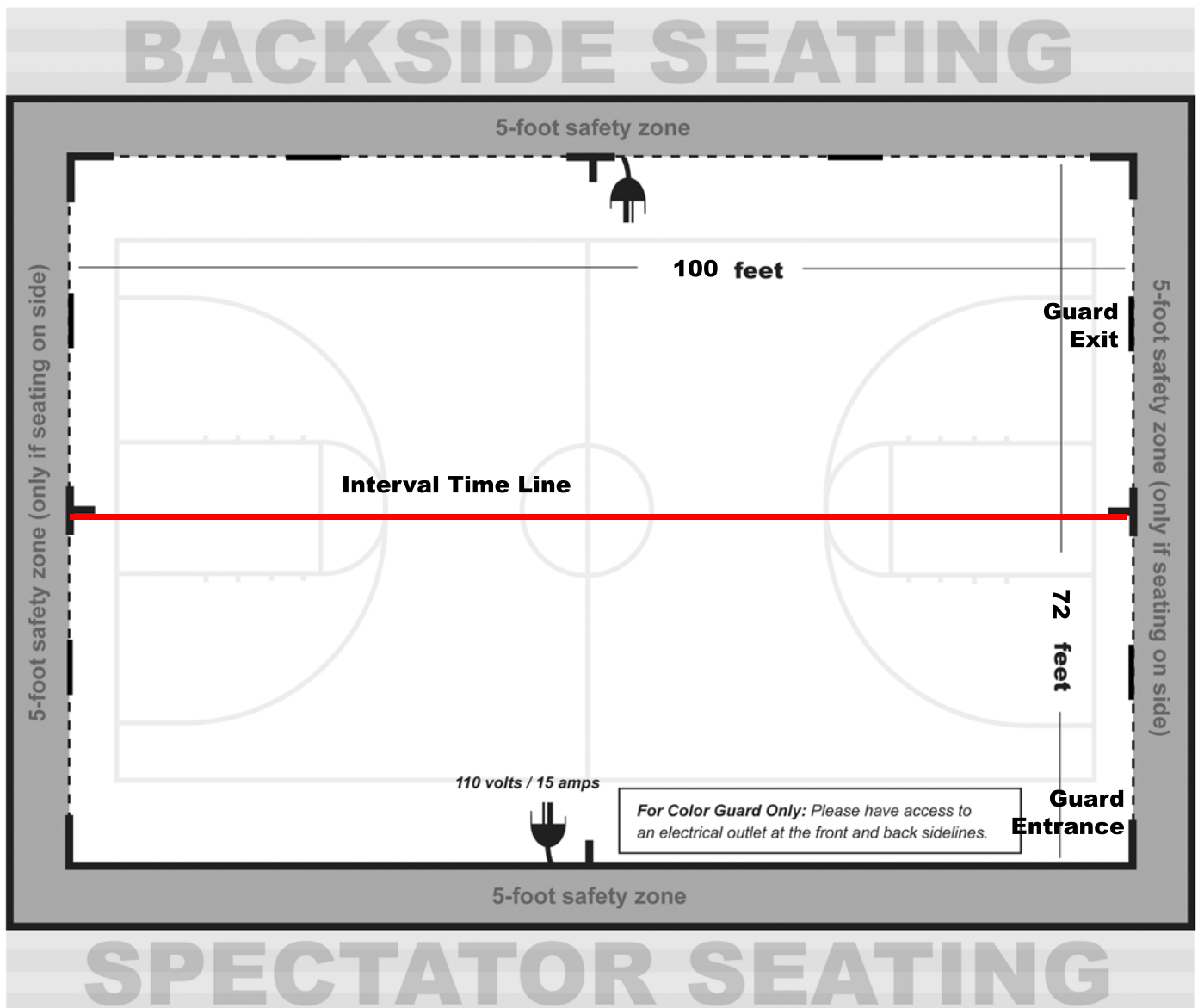

20 WGI
20 I AM WGI



JOIN THE AUSTIN - ROUSE CG REGIONAL BAND!

BAND

- Free all-in-one group communication platform.
- Share group announcements via push notification, text message or email.
- Robust group calendar and membership management.
- Customizable to your unique communication needs.
- Available for your mobile device and desktop.

BAND LINK:

<https://band.us/n/a9a520K0Fa0as>

- 1 Go to the Apple App Store or Google Play Store, search for BAND and download.
- 2 Sign up using your phone number, email, Facebook account or Google account.
- 3 Scan the QR code or use the link below to join the BAND.



#WGI2020

#IAMWGI

Glenn HS
Site Maps &
Performance
Area Info

**Spectator
Parking**

Tom Glenn Stadium

**Spectator
Entrance**

**Prop Drop
Off**

**Performance
Gym**

**Guard
Check In/**

**Equipment
Warm Up**

**Body
Warm Up**

**Overflow
Bus/Truck
Parking**

Glenn High School

**Bus/Truck
Parking**

**WGI Austin Color Guard Regional
Glenn High School
SA Prelims Only**

**WGI Austin Color Guard Regional
Glenn High School
SA Prelims Only**

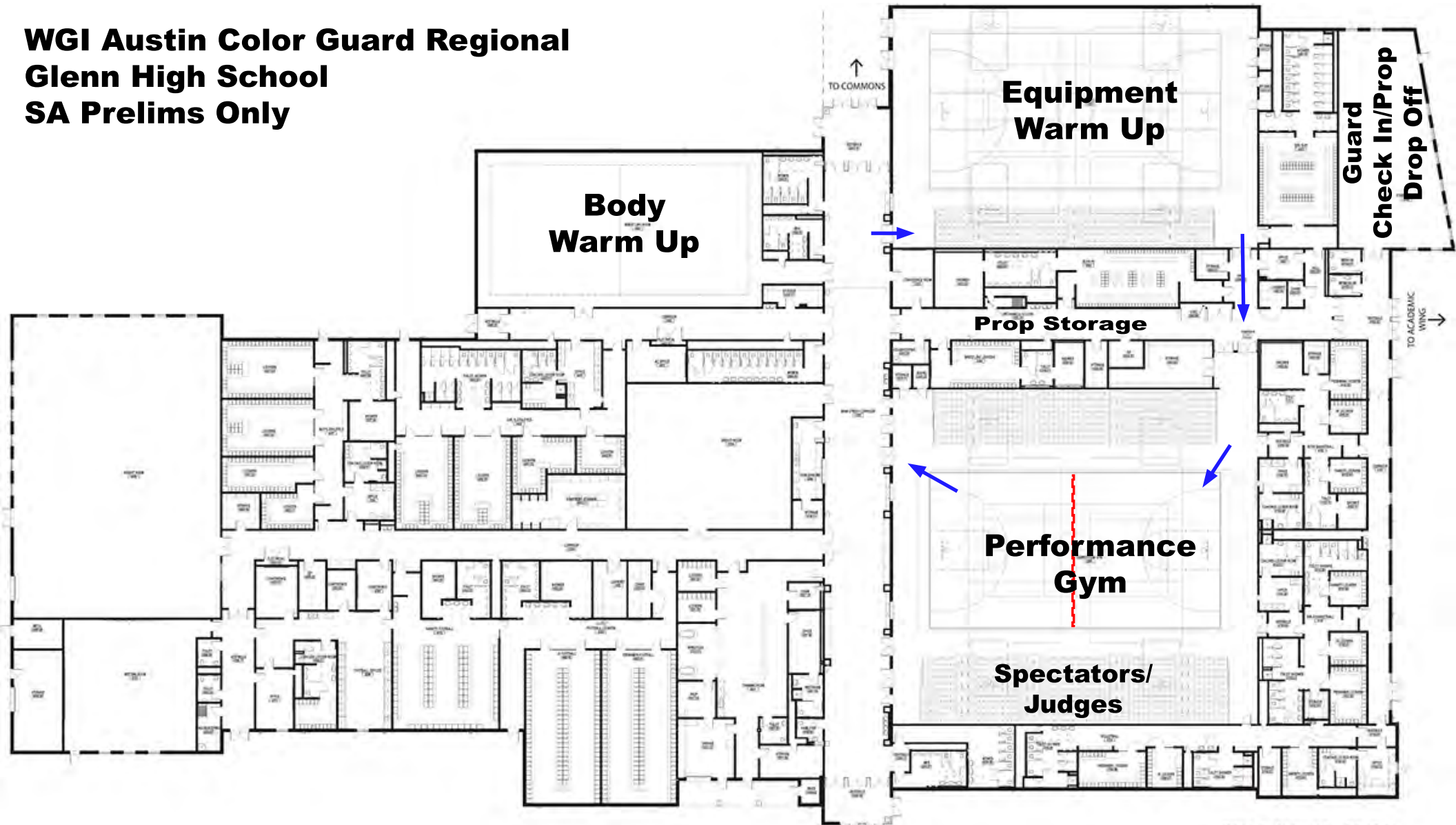

**Spectator
Entrance**

TOM GLENN HIGH SCHOOL
ATHLETICS WING FLOOR PLAN
ARTURO LOMELI, PRINCIPAL

pfluger



WGI Austin Regional Competition Area Glenn High School, Leander, TX

All WGI contest sites must have a minimum of seventy by one hundred feet (70' x 100') to accommodate a "safety zone" of five (5) feet from any spectator seating. If no spectators are seated on the left and right sides, then the safety zone will be eliminated on the left and right sides of the competition area and can extend to a maximum of 106'X 78'.

The "competition area" at this event measures All performing groups must be prepared to perform within that area. Floors (tarps) may not extend into the safety zones per rules found in the WGI Adjudication Manual and Rulebook.

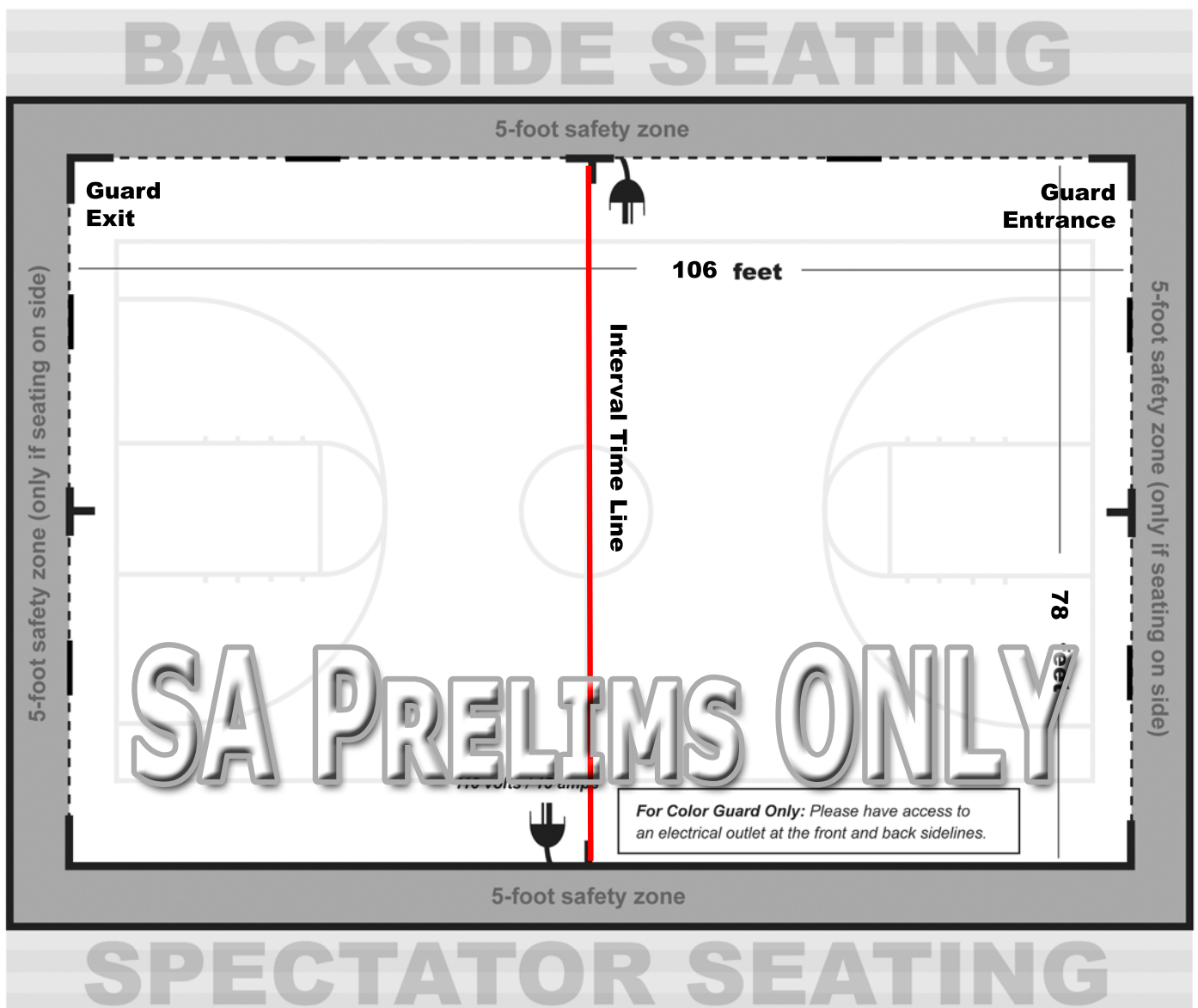

2020 **i**AM WGI



JOIN THE AUSTIN - GLENN CG REGIONAL BAND!

BAND

- Free all-in-one group communication platform.
- Share group announcements via push notification, text message or email.
- Robust group calendar and membership management.
- Customizable to your unique communication needs.
- Available for your mobile device and desktop.

BAND LINK:

<https://band.us/n/a2af2fK1F59aZ>

- 1** Go to the Apple App Store or Google Play Store, search for BAND and download.
- 2** Sign up using your phone number, email, Facebook account or Google account.
- 3** Scan the QR code or use the link below to join the BAND.



#WGI2020

#IAMWGI

From the WGI Policy Manual

4.120 Sound Policy (Color Guard)

- All color guards should do a sound check at the designated times provided in the contest information packet to ensure the playability of any device or CD. Color guards should check the soundtrack at multiple places in the music to verify playability of any device
- Color guards should still do a sound check if they are using the WGI Music Upload in CompetitionSuite to ensure everything is correct.
- Color guard is responsible for providing the method that the music will be played, e.g. CD, MP3, computer, etc. Each color guard should have two methods to play their soundtrack in the event one does not work.
- Color guard must provide their music in a timely manner to the designated sound operator. Any delay in providing music is the responsibility of the color guard.
- Color guards using the Music Upload process through CompetitionSuite should have a backup using another device type such as an MP3 player, iPhone, or CD.
- Color guard must have a designated person at the sound table to operate any device provided to play music such as MP3 players or computers. Guard's representative is responsible to set up and play device. If a CD is provided, the color guard representative must instruct the sound operator as to what track or other relevant information is needed to start the music when directed by the contest Timing and Penalty judge or after the color guard's introduction.
- If the color guard has an issue with the music such as music is too soft, it begins in the wrong place or skips, the color guard's representative must make the decision to stop the music and tell the operator to stop the music. If the color guard representative chooses not to stop and the color guard completes their performance, the color guard will not be offered an opportunity to perform again.
- Interval timing will continue as the color guard resets and begins again. The Contest Administrator has the sole discretion in waiving any timing penalty due to the restart. If the stoppage is due to faulty sound equipment, operator error or an unexplained reason, overtime penalty may be waived.
- Issues related to the equipment provided by the color guard, quality of the CD or the color guard's representative error (using wrong playlist on MP3, etc.) will result in the actual interval timing being used and penalties, if any, being assessed.
- Volume direction must come from the color guard representative at the sound table. Direction will not be taken from the audience viewing area or across the floor. Final volume discretion is given to the sound operator based on their equipment and the Chief Judge who ultimately determines an appropriate volume level.
- The color guard representative may provide direction to the sound operator during the performance regarding equalization.
- It is the responsibility of the color guard to provide their music for each performance and to ensure that their soundtrack is working appropriately. CDs may not be left at sound table between performances.
- Under no circumstances will verbal abuse of the sound operator be tolerated. Penalties will be assessed per current WGI rules