

MID EAST POWER REGIONAL CONTEST INFORMATION IA/SO/IO/SW/IW PRELIMS ALL CLASS FINALS SATURDAY & SUNDAY, MARCH 14 & 15, 2020



LOCATION

BB&T Arena at Northern Kentucky University
500 Louie B Nunn Drive
Highland Heights, KY 41099

Per arena guidelines, all purses, backpacks, etc. are subject to search by arena personnel.

EMERGENCY CONTACTS (DAY OF SHOW ONLY)

CONTEST ADMINISTRATOR: Jamie Rightmyer / 585-721-8715 / Jamie@wgi.org

JUDGE PANEL

Panels are listed below.

COMPETITIONSUITE DETAILS

ACCESSING YOUR GROUP - <https://help.competitionsuite.com/article/16-accessing-your-group>

ADDING YOUR STAFF - <https://help.competitionsuite.com/article/61-adding-staff-members>

ACCESSING COMMENTARY - <https://help.competitionsuite.com/article/17-accessing-commentary>

MUSIC UPLOADS - <https://help.competitionsuite.com/article/74-uploading-performance-music>

Score Summary Sheets are also located in your CompetitionSuite account with your overall score.

ADDITIONAL REGIONAL INFO

PRELIMS LOGISTICAL SCHEDULE - <https://tinyurl.com/su9asx5>

FINALS LOGISTICAL SCHEDULE - <https://tinyurl.com/tsbwhfa>

WARM UP AREAS – Music is not permitted in either body or equipment warm up as sound carries to the performance floor.

SCORE POSTING – Scores posted in the main atrium lobby of the arena.

REGIONAL REMINDERS - <https://wgi.org/wp-content/uploads/2020/01/2020CGRegionalReminders.pdf>

Winter Guard International, Inc.

2405 Cross Pointe Drive, Miamisburg, OH 45342/ Phone: 937-247-5919/ Fax: 937-247-9212/ Email: office@wgi.org Web: <http://wgi.org>

MID EAST POWER REGIONAL CONTEST INFORMATION SA PRELIMS & SEMI FINALS ONLY SATURDAY, MARCH 14, 2020



LOCATION

Hamilton High School
1165 Eaton Avenue
Hamilton, OH 45013

EMERGENCY CONTACTS (DAY OF SHOW ONLY)

CONTEST ADMINISTRATOR: AJ Kise / 484-934-4578 / AJ@wgi.org

JUDGE PANEL

Panels are listed below.

COMPETITIONSUITE DETAILS

ACCESSING YOUR GROUP - <https://help.competitionsuite.com/article/16-accessing-your-group>

ADDING YOUR STAFF - <https://help.competitionsuite.com/article/61-adding-staff-members>

ACCESSING COMMENTARY - <https://help.competitionsuite.com/article/17-accessing-commentary>

MUSIC UPLOADS - <https://help.competitionsuite.com/article/74-uploading-performance-music>

Score Summary Sheets are also located in your CompetitionSuite account with your overall score.

ADDITIONAL REGIONAL INFO

PRELIMS LOGISTICAL SCHEDULE - TBA

FINALS LOGISTICAL SCHEDULE - TBA

WARM UP AREAS – Music is not permitted in warm up as it will disturb the other guard in the area.

SCORE POSTING – Scores are posted outside the cafeteria near the spirit shop.

REGIONAL REMINDERS - <https://wgi.org/wp-content/uploads/2020/01/2020CGRegionalReminders.pdf>

Mid East Power Regional Judge Panels



Saturday @ Hamilton HS

	<i>Equipment</i>	<i>Movement</i>	<i>Design Analysis</i>	<i>General Effect</i>	
Scholastic A Prelims Scholastic A Semis	Robert Solomon	Erin Brown	Tom Slaughter	James Goodrich	Paul Lampkin

T&P - Chris Tomsa
Lead Judge - Paul Lampkin

Saturday @ BB&T Arena

	<i>Equipment</i>	<i>Movement</i>	<i>Design Analysis</i>	<i>General Effect</i>	
IA/SO/IO/SW/IW Prelims	John Fisher	Michael Turner	William Chumley	Meghan McCourt	Dale White

T&P - Brad Love
Lead Judge - William Chumley

Sunday @ BB&T Arena

	<i>Equipment</i>	<i>Movement</i>	<i>Design Analysis</i>	<i>General Effect</i>	
ALL FINALS	John Fisher	Erin Brown	William Chumley	James Goodrich	Meghan McCourt
	Robert Solomon	Michael Turner	Tom Slaughter	Paul Lampkin	Dale White

T&P - Brad Love
Lead Judge - William Chumley



Mid East Power Regional Critique Schedule @ BB& T Arena

Color Guard	Hometown	Class	Critique Time
Collage	Akron, OH	IA	3:10 PM
Ventures A	Kitchener-Waterloo, Ontario, Canada	IA	3:10 PM
m.Pure Winter Guard	Southgate, MI	IA	3:10 PM
Ladies of South Shore	Chicago, IL	IA	3:10 PM
Miamisburg HS A	Miamisburg, OH	IA	3:22 PM
Odin Winter Guard	Detroit, MI	IA	3:22 PM
Onyx	Dayton, OH	IA	3:22 PM
SSJC-South Shore Jr. Cadets	Chicago, IL	IA	3:22 PM
Bellbrook HS	Bellbrook, OH	SO	3:34 PM
Greenfield-Central HS	Greenfield, IN	SO	3:34 PM
Jamestown HS	Jamestown, NY	SO	3:34 PM
O Fallon Township HS	O'Fallon, IL	SO	3:34 PM
Milford HS (OH)	Milford, OH	SO	3:46 PM
Ben Davis HS	Indianapolis, IN	SO	3:46 PM
Hamilton Southeastern HS	Fishers, IN	SO	3:46 PM
Centerville HS	Centerville, OH	SO	3:46 PM
LaPorte HS	La Porte, IN	SO	3:58 PM
Decatur Central HS	Indianapolis, IN	SO	3:58 PM
Marian Catholic HS	Chicago Heights, IL	SO	3:58 PM

IA/SO Critique Concludes

4:10 PM

Allegiance	Dundee, IL	IO	8:40 PM
Phoenix Independent	Sylvania, OH	IO	8:40 PM
Onyx	Dayton, OH	IO	8:40 PM
Independence Winter Guard	Tinley Park, IL	IO	8:40 PM

Fishers HS	Fishers, IN	SW	8:52 PM
Carmel HS	Carmel, IN	SW	8:52 PM
Center Grove HS	Greenwood, IN	SW	8:52 PM
Plymouth-Canton Educational Park	Canton, MI	SW	8:52 PM
Warren Central HS	Indianapolis, IN	SW	9:08 PM
Miamisburg HS	Miamisburg, OH	SW	9:08 PM
Norwin HS	North Huntingdon, PA	SW	9:08 PM
Northview HS	Brazil, IN	SW	9:08 PM
Avon HS	Avon, IN	SW	9:24 PM
Juxtaposition	Westerville, OH	IW	9:24 PM
Inspire	Indianapolis, IN	IW	9:24 PM
Onyx	Dayton, OH	IW	9:24 PM
Lexis	Lexington, KY	IW	9:40 PM

IO/SW/IW Critique Concludes

9:56 PM

To be eligible for critique you must be attending the 2020 World Championships and have signed up prior to Wednesday, February 19th

If you are unable to make it to critique, please notify the Contest Administrator as soon as possible. Those groups who do not appear for critique without notifying the CA may lose their critique opportunities in the future.

BB&T Arena Site Maps & Performance Area Info

WGI Mid East Color Guard Power Regional BB&T Arena at Northern Kentucky University



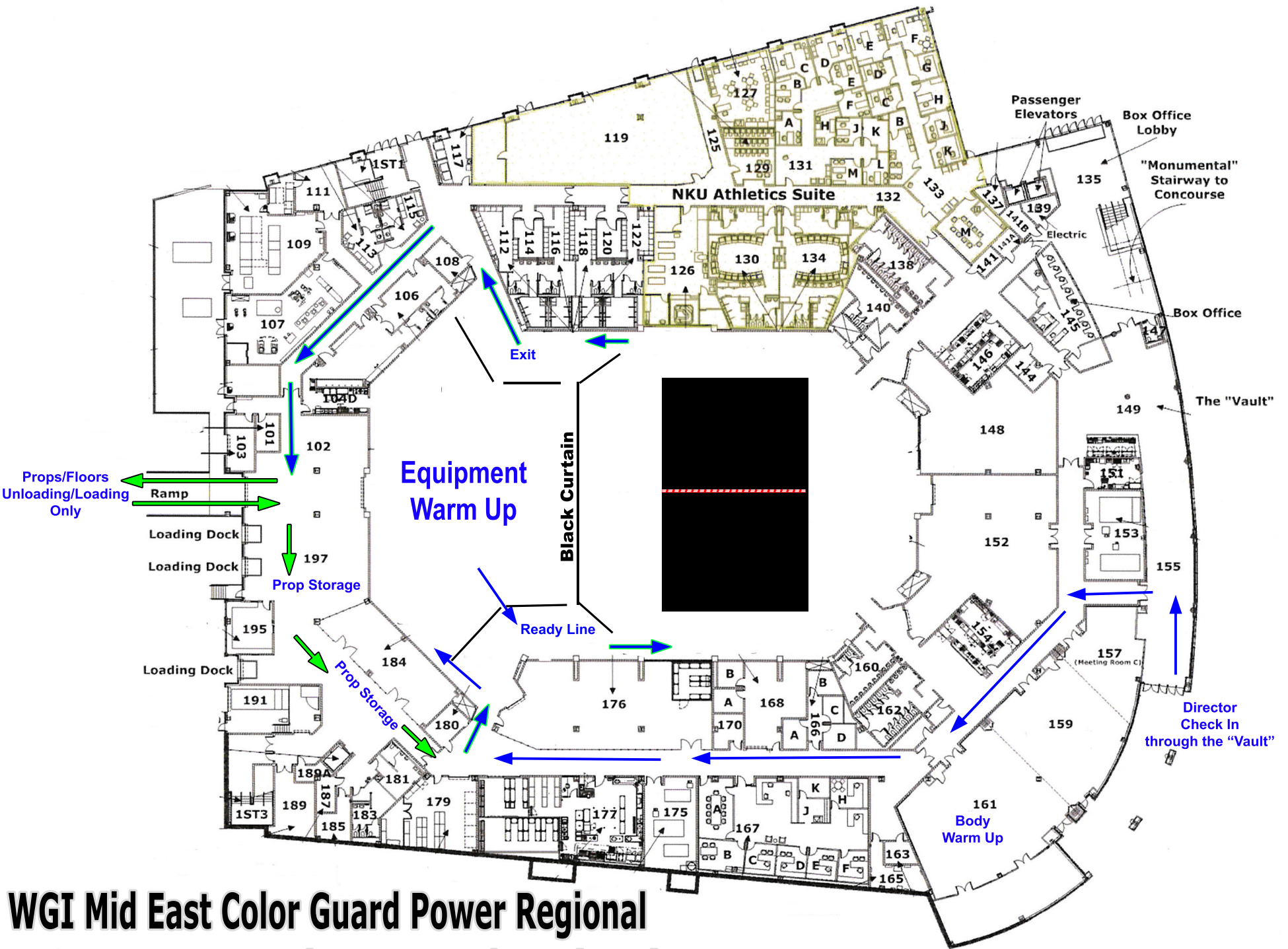

WGI Mid East Color Guard Power Regional BB&T Arena at Northern Kentucky University

WGI Mid East Color Guard Power Regional

BB&T Arena

Northern Kentucky University

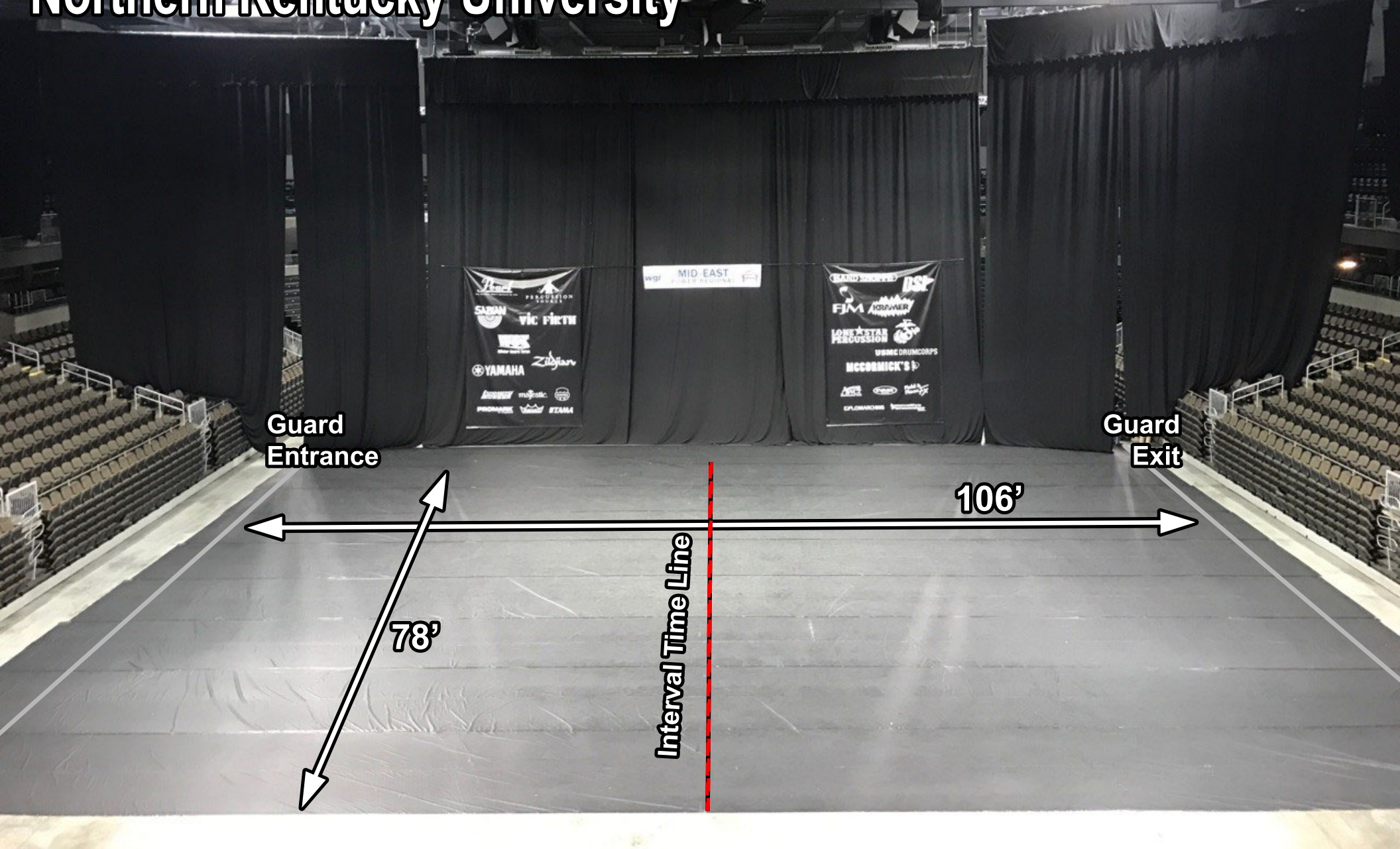



**Mid East Power Regional Competition Area
Northern Kentucky University, BB&T Arena, Highland Heights, KY**

All WGI contest sites must have a minimum of seventy by one hundred feet (70' x 100') to accommodate a “safety zone” of five (5) feet from any spectator seating. If no spectators are seated on the left and right sides, then the safety zone will be eliminated on the left and right sides of the competition area and could extend to a maximum of 106' X 78'.

The “competition area” at this event measures 106' X 78'. All performing groups must be prepared to perform within that area. Floors (tarps) may not extend into the safety zones per rules found in the WGI Adjudication Manual and Rulebook.

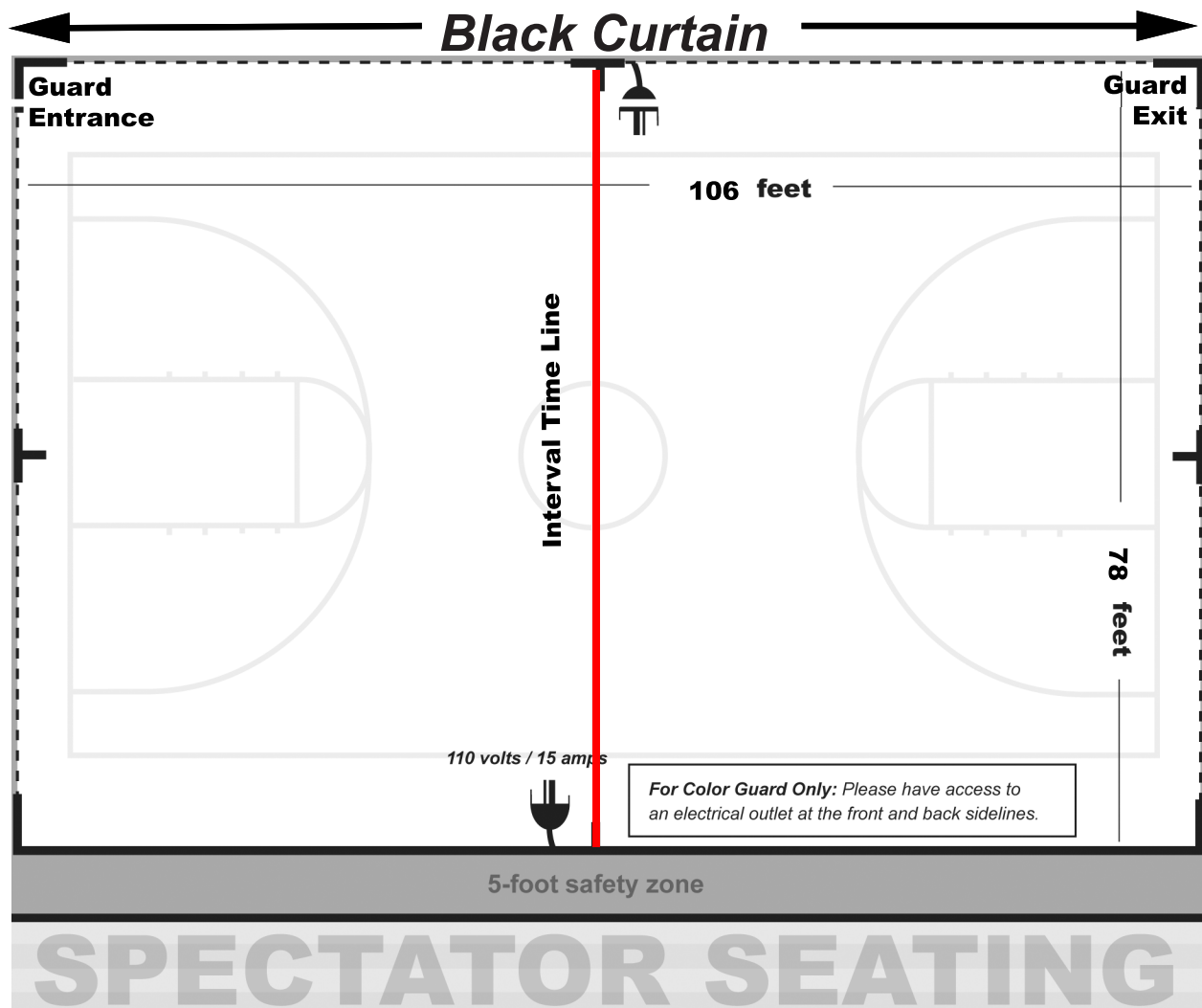

WGI Mid East Color Guard Power Regional BB&T Arena at Northern Kentucky University



University Dr, Newport, KY 41076 to Furniture Fair

Drive 1.3 miles, 5 min

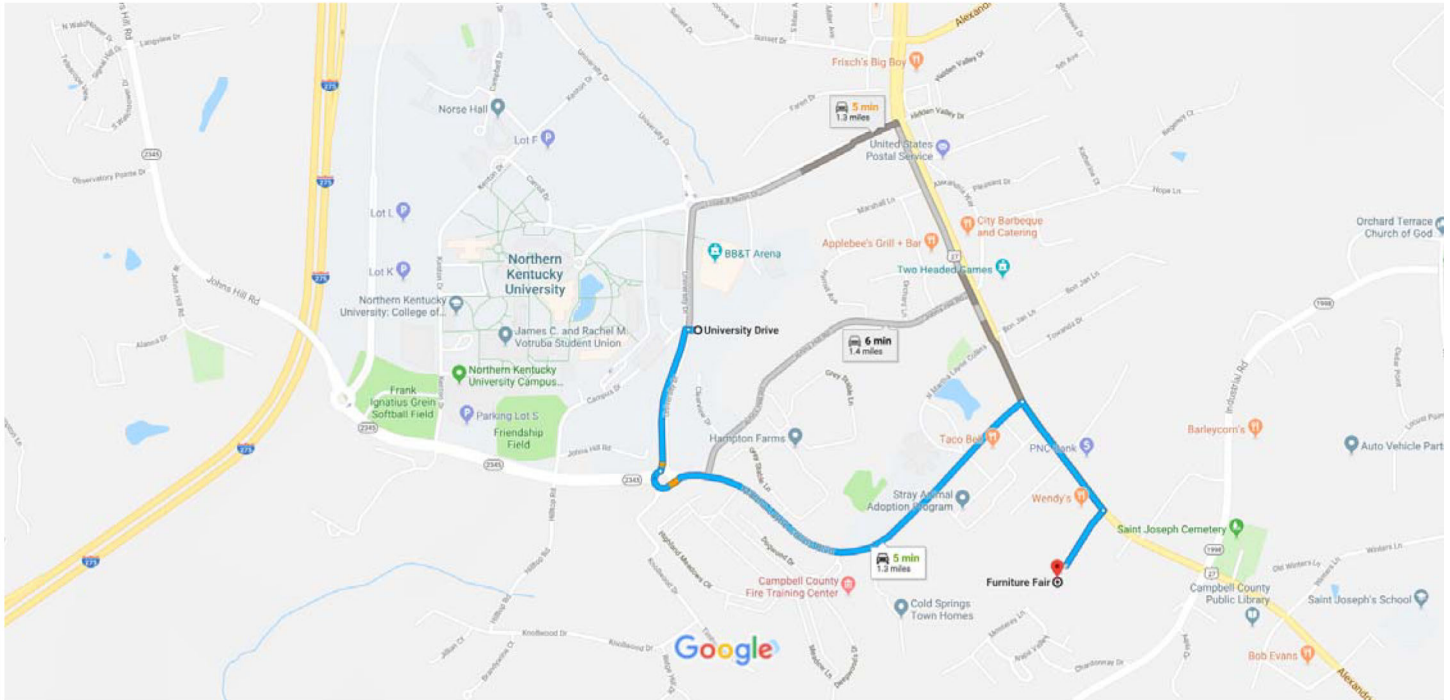

Map data ©2018 Google 500 ft

University Dr

Newport, KY 41076

1. Head west toward University Dr
75 ft
2. Turn left at the 1st cross street onto University Dr
0.2 mi
3. At the traffic circle, take the 3rd exit onto KY-2345/Martha Layne Collins Blvd
Pass by Arby's (on the right in 0.7 mi)
0.7 mi
4. Turn right onto Alexandria Pike
0.2 mi
5. Turn right
0.1 mi

Furniture Fair

3710 Alexandria Pike, Cold Spring, KY 41076

These directions are for planning purposes only. You may find that construction projects, traffic, weather, or other events may cause conditions to differ from the map results, and you should plan your route accordingly. You must obey all signs or notices regarding your route.

SA ONLY

Hamilton HS
Site Maps &
Performance
Area Info

All floors/props must be loaded immediately after performance. Trucks may then proceed to the Bus/Truck lot.

Bus/Truck
Parking

Floor/Prop
Loading

Spectator
Parking

GYM

Warm Up

Short Term
Truck Parking

Guard
Check In

Group Drop Off

Floor/Prop
Unloading

Truck/Trailer
Entrance

WGI Mid East Power Regional Hamilton High School SA PRELIMS AND SEMIS ONLY

Bus/Truck
Overflow

**To warm up areas and
performance area**

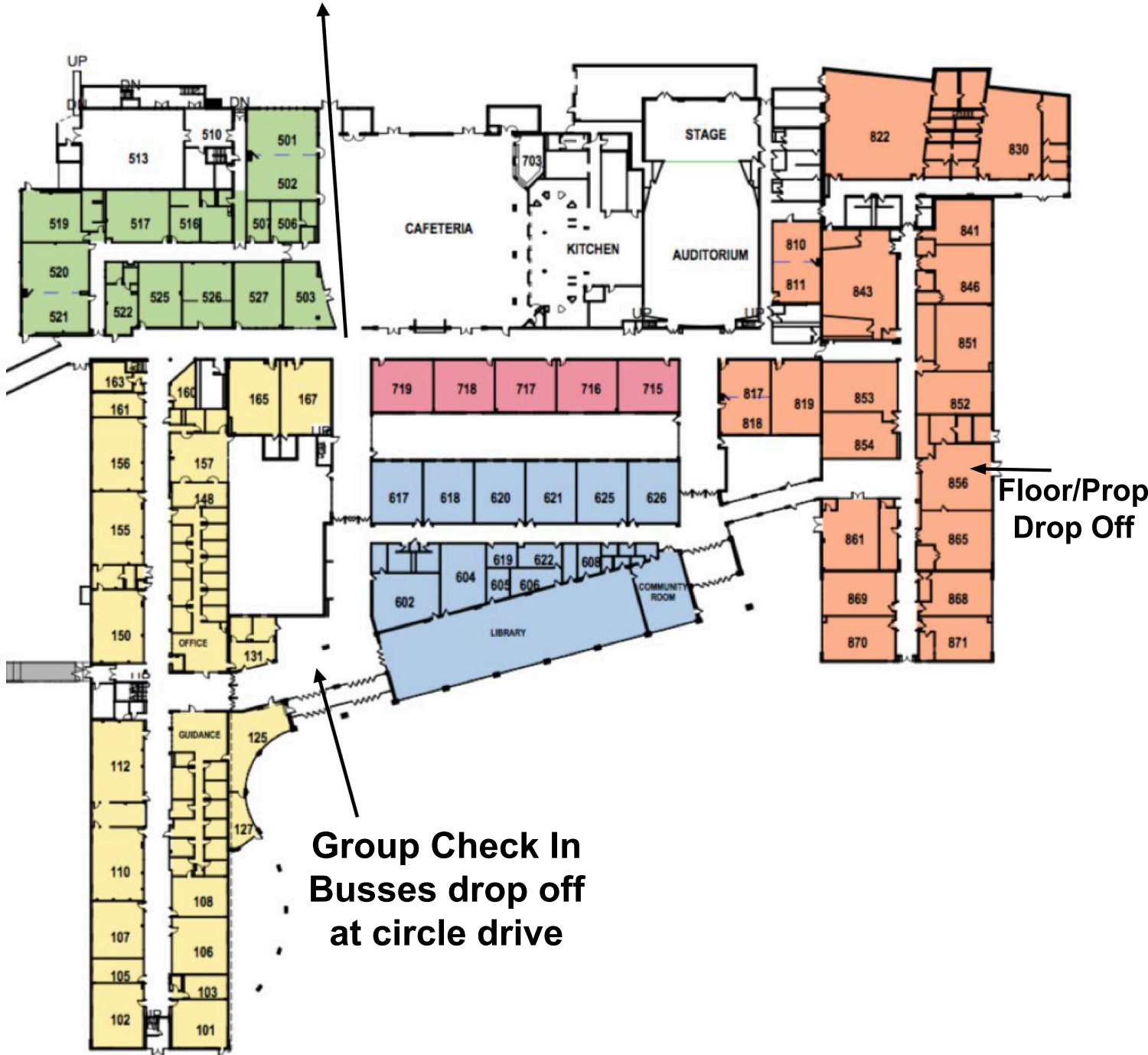

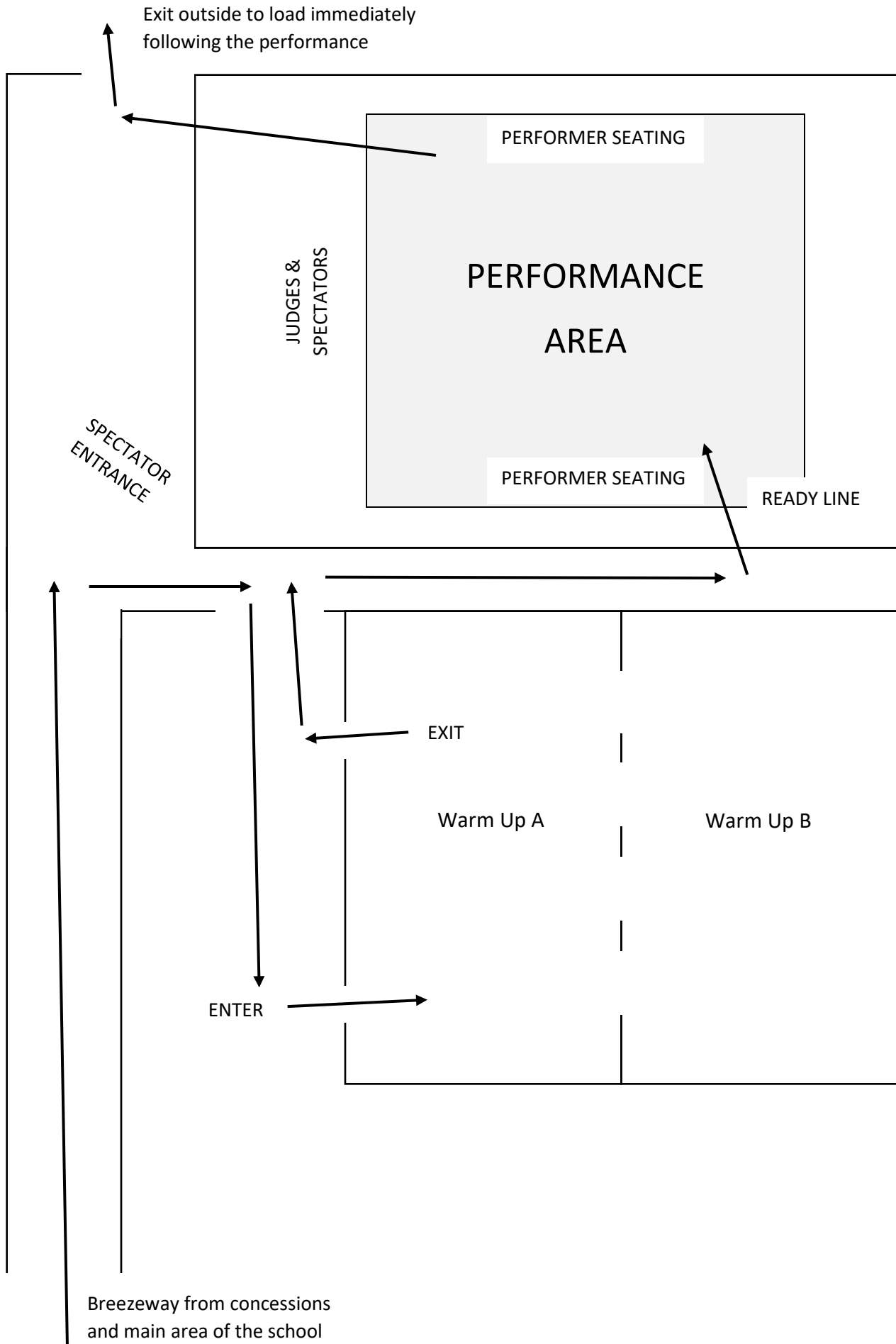

Mid East Power Regional SA Prelims & Semi Finals Hamilton High School

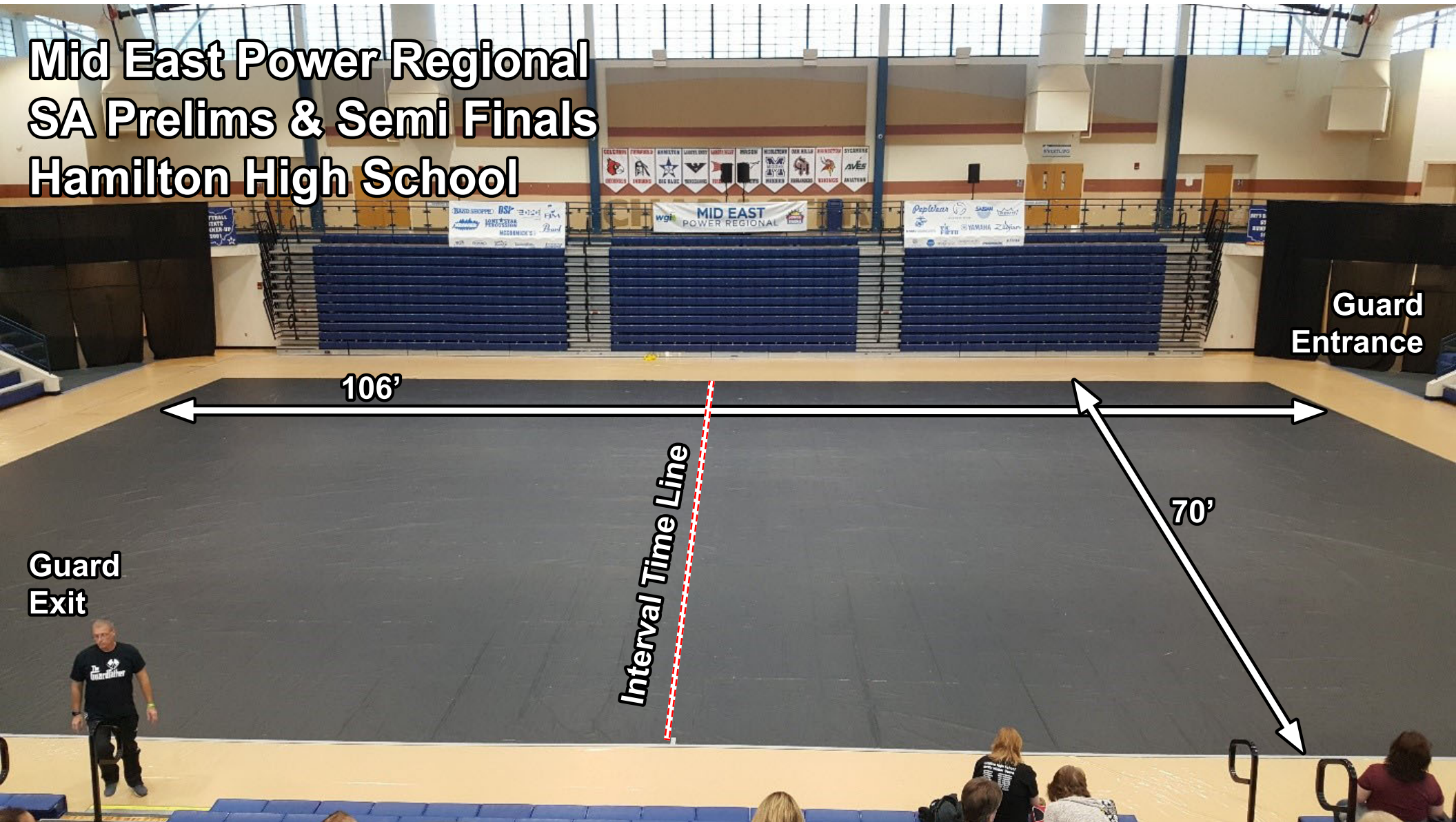



Mid East Power Regional Competition Area Hamilton High School, Hamilton, OH

All WGI contest sites must have a minimum of seventy by one hundred feet (70' x 100') to accommodate a "safety zone" of five (5) feet from any spectator seating. If no spectators are seated on the left and right sides, then the safety zone will be eliminated on the left and right sides of the competition area and can extend to a maximum of 106'X 78'.

The "competition area" at this event measures 106'X 70. All performing groups must be prepared to perform within that area. Floors (tarps) may not extend into the safety zones per rules found in the WGI Adjudication Manual and Rulebook.

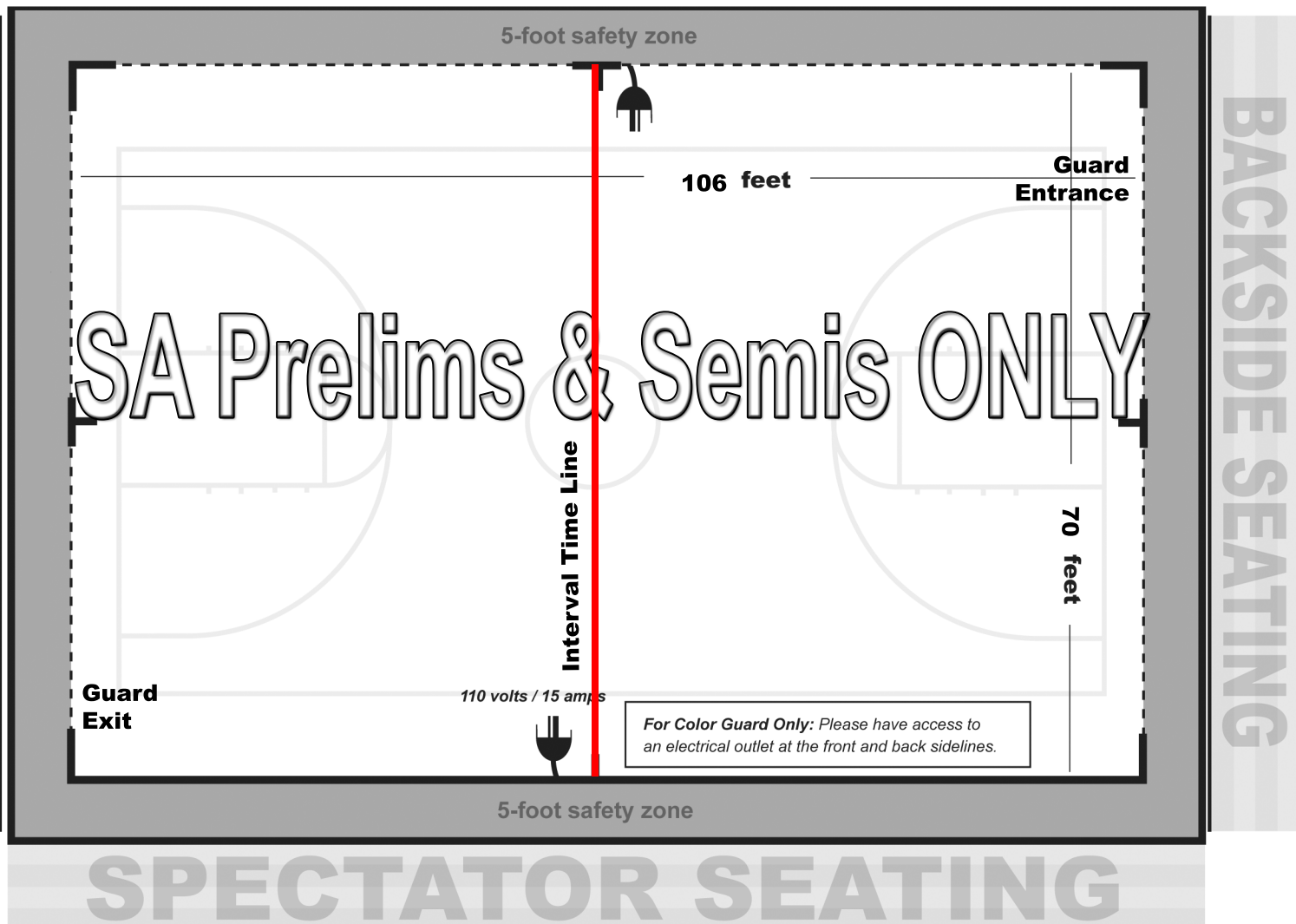

From the WGI Policy Manual

4.120 Sound Policy (Color Guard)

- All color guards should do a sound check at the designated times provided in the contest information packet to ensure the playability of any device or CD. Color guards should check the soundtrack at multiple places in the music to verify playability of any device
- Color guards should still do a sound check if they are using the WGI Music Upload in CompetitionSuite to ensure everything is correct.
- Color guard is responsible for providing the method that the music will be played, e.g. CD, MP3, computer, etc. Each color guard should have two methods to play their soundtrack in the event one does not work.
- Color guard must provide their music in a timely manner to the designated sound operator. Any delay in providing music is the responsibility of the color guard.
- Color guards using the Music Upload process through CompetitionSuite should have a backup using another device type such as an MP3 player, iPhone, or CD.
- Color guard must have a designated person at the sound table to operate any device provided to play music such as MP3 players or computers. Guard's representative is responsible to set up and play device. If a CD is provided, the color guard representative must instruct the sound operator as to what track or other relevant information is needed to start the music when directed by the contest Timing and Penalty judge or after the color guard's introduction.
- If the color guard has an issue with the music such as music is too soft, it begins in the wrong place or skips, the color guard's representative must make the decision to stop the music and tell the operator to stop the music. If the color guard representative chooses not to stop and the color guard completes their performance, the color guard will not be offered an opportunity to perform again.
- Interval timing will continue as the color guard resets and begins again. The Contest Administrator has the sole discretion in waiving any timing penalty due to the restart. If the stoppage is due to faulty sound equipment, operator error or an unexplained reason, overtime penalty may be waived.
- Issues related to the equipment provided by the color guard, quality of the CD or the color guard's representative error (using wrong playlist on MP3, etc.) will result in the actual interval timing being used and penalties, if any, being assessed.
- Volume direction must come from the color guard representative at the sound table. Direction will not be taken from the audience viewing area or across the floor. Final volume discretion is given to the sound operator based on their equipment and the Chief Judge who ultimately determines an appropriate volume level.
- The color guard representative may provide direction to the sound operator during the performance regarding equalization.
- It is the responsibility of the color guard to provide their music for each performance and to ensure that their soundtrack is working appropriately. CDs may not be left at sound table between performances.
- Under no circumstances will verbal abuse of the sound operator be tolerated. Penalties will be assessed per current WGI rules

20^{WGI}
20^{iAM}

JOIN THE
MID EAST CG
POWER
REGIONAL
BAND!



- Free all-in-one group communication platform.
- Share group announcements via push notification, text message or email.
- Robust group calendar and membership management.
- Customizable to your unique communication needs.
- Available for your mobile device and desktop.

BAND LINK:

<https://band.us/n/a5a924u7Add5u>



1

Go to the Apple App Store or Google Play Store, search for BAND and download.

2

Sign up using your phone number, email, Facebook account or Google account.

3

Scan the QR code or use the link below to join the BAND.



#WGI2020

#IAMWGI



2020 WGI REGIONAL PATCH DELAYED

Order yours today to receive
them as soon as they arrive.



\$8 Plus Tax • **FREE DOMESTIC SHIPPING** ON ORDERS OF 10 OR MORE!

SHOP.WGI.ORG

POWERED BY *PepWear*