

THERE COULD BE DIFFERENT PROTOCOLS AT EACH WGI EVENT, PLEASE READ THROUGH ALL INFORMATION CAREFULLY.

DALLAS COLOR GUARD

REGIONAL CONTEST INFORMATION

SATURDAY & SUNDAY, MARCH 19 & 20, 2022



LOCATION

Coppell High School
185 West Parkway Boulevard
Coppell, TX 75019

EMERGENCY CONTACTS (DAY OF SHOW ONLY)

CONTEST ADMINISTRATOR: Stephanie Bonebrake/ 817-781-7995/ Stephanie@wgi.org
EVENT PARTNER: Matthew Rummel/ 615-512-7035/ matthew.d.rummel@gmail.com

JUDGE PANEL

Judge Panels are in this packet.

COMPETITIONSUITE DETAILS

ACCESSING YOUR GROUP - <https://help.competitionsuite.com/article/16-accessing-your-group>

ADDING YOUR STAFF - <https://help.competitionsuite.com/article/61-adding-staff-members>

ACCESSING COMMENTARY - <https://help.competitionsuite.com/article/17-accessing-commentary>

MUSIC UPLOADS - <https://help.competitionsuite.com/article/74-uploading-performance-music>

Score Summary Sheets are also located in your CompetitionSuite account with your overall score.

ADDITIONAL REGIONAL INFO

PRELIMS LOGISTICAL SCHEDULE - <https://tinyurl.com/4setsbc5>

FINALS LOGISTICAL SCHEDULE - <https://tinyurl.com/bdevkvcb>

WARM UP AREAS – Music is permitted in the warm up areas. A sound system with iPod hook up will be available for your use. If you wish to use a CD, you must provide your own sound system.

RETREAT – Each group may designate one individual to represent the group on the floor during retreat. Masks are recommended. If your group is not attending retreat, please designate one individual (parent, staffer, or designated representative) to stay and retrieve your award at the conclusion of retreat. Please inform the Contest Administrator on site if your group will not be attending retreat.

REGIONAL REMINDERS – <https://wgi.org/wp-content/uploads/2022/01/2022CGRegionalReminders.pdf>

Dallas Color Guard Regional (March) Judge Panels

PRELIMS					
	Equipment	Movement	Design Analysis	General Effect	General Effect
SA	Jennifer Karp	Patricia Beggy	Tom Slaughter	Michael Higbe	Michael Stone
SRA	Tim Landess	Erin Brown	Travis Wingate	Kendall LeJeune	Gilles Ouellette
IA	Tim Landess	Erin Brown	Travis Wingate	Kendall LeJeune	Gilles Ouellette
SO	Tim Landess	Erin Brown	Travis Wingate	Kendall LeJeune	Gilles Ouellette
IO	Tim Landess	Erin Brown	Travis Wingate	Kendall LeJeune	Gilles Ouellette
SW	Tim Landess	Erin Brown	Travis Wingate	Kendall LeJeune	Gilles Ouellette
IW	Tim Landess	Erin Brown	Travis Wingate	Kendall LeJeune	Gilles Ouellette

Timing and Penalties - Michelle Hernandez

FINALS					
	Equipment	Movement	Design Analysis	General Effect	General Effect
SRA	Jennifer Karp	Patricia Beggy	Tom Slaughter	Michael Higbe	Michael Stone
SA	Jennifer Karp	Patricia Beggy	Tom Slaughter	Michael Higbe	Michael Stone
IA	Jennifer Karp	Patricia Beggy	Tom Slaughter	Michael Higbe	Michael Stone
SO	Jennifer Karp	Patricia Beggy	Tom Slaughter	Michael Higbe	Michael Stone
IO	Jennifer Karp	Patricia Beggy	Tom Slaughter	Michael Higbe	Michael Stone
SW	Jennifer Karp	Patricia Beggy	Tom Slaughter	Michael Higbe	Michael Stone
IW	Jennifer Karp	Patricia Beggy	Tom Slaughter	Michael Higbe	Michael Stone

Timing and Penalties - Michelle Hernandez

Lead Judge - Mike Stone



**Bus/Truck
Parking**

**Bus/Truck
Parking**

**Spectator
Parking**

**Spectator
Entrance
Performance
Gym**

**Warm Up
Area**

**Color Guard
Check In**

Coppell High School

**Prop Unload
& Load Area**

**WGI Dallas Color Guard Regional
Coppell High School**

© 2016 Google

Imagery Date: 4/27/2016 32°58'31.36" N 96°59'59.29" W elev 475 ft

Prop Loading/Unloading

Unit Storage

Prop Storage

Vendors

Bus/Truck Parking

Judges

Spectator Seating

Vertical

Time-line

Performance Entrance

Performance Exit

Spectator Entrance

Concession

Equipment Warm-Up

Floor Folding

Unit Check-in

Main Entrance

Bus Loop Drop Off

Spectator Parking

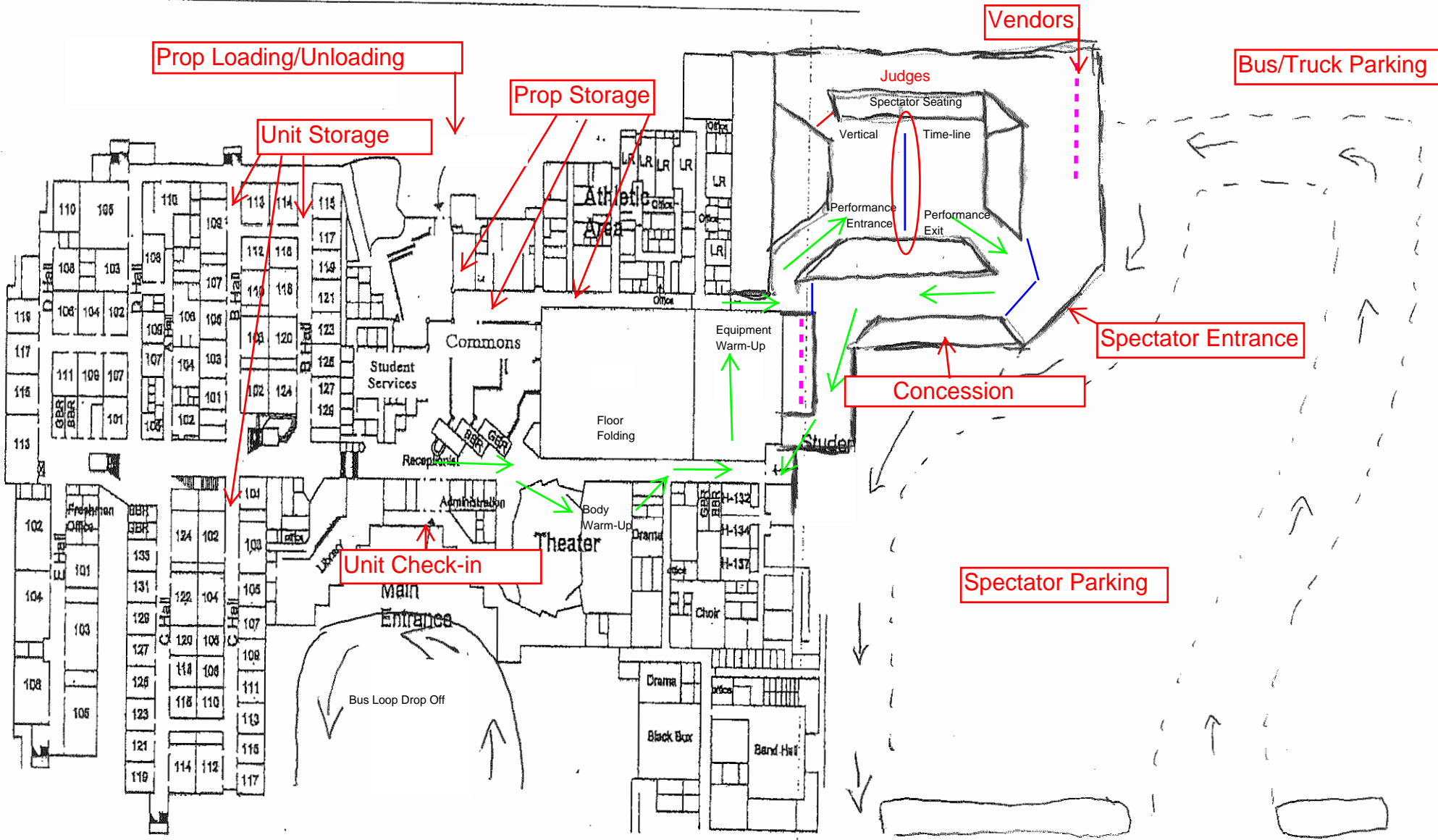

WGI Dallas Color Guard Regional Performance Gym

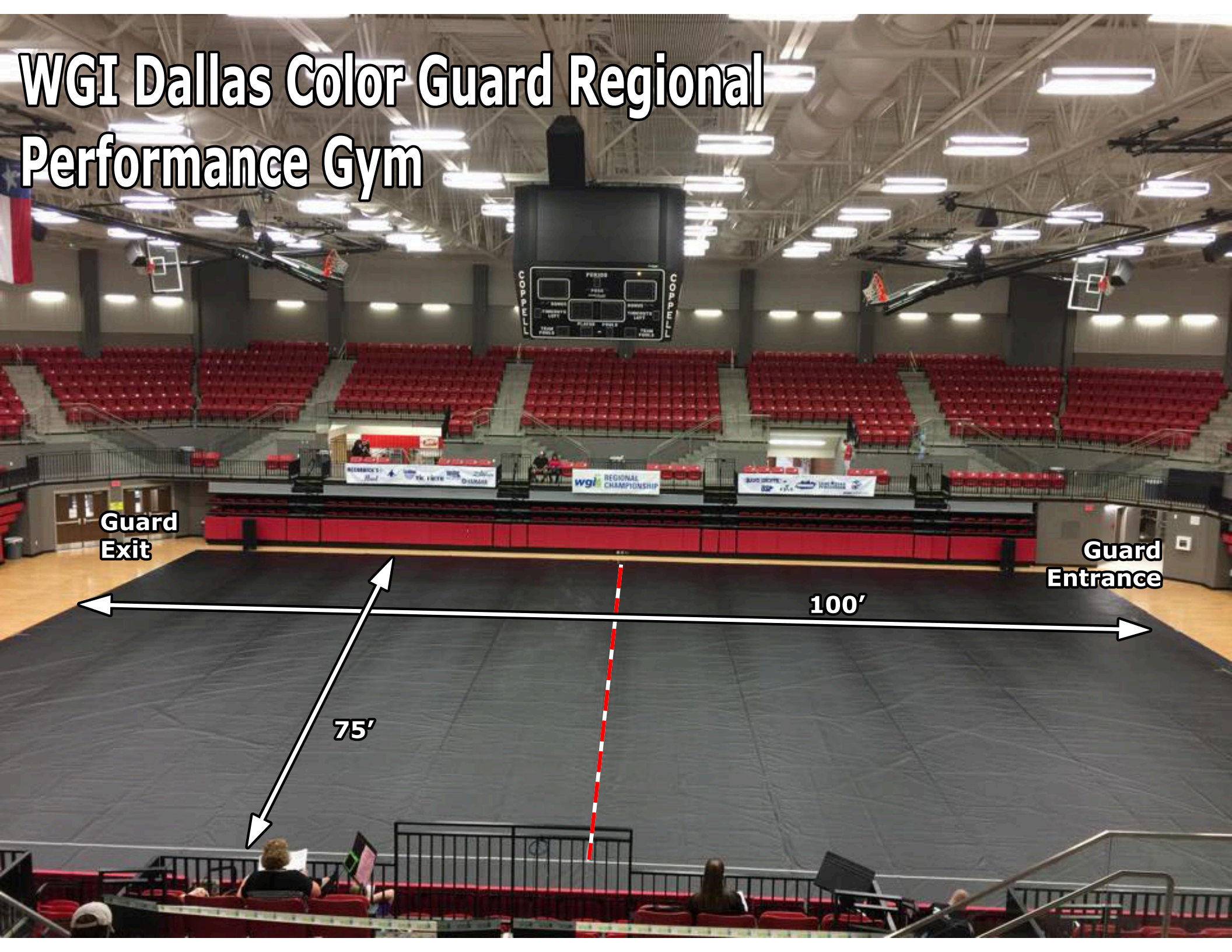

Guard
Exit

Guard
Entrance

100'

75'



Dallas Regional Competition Area Coppell High School, Coppell, TX

All WGI contest sites must have a minimum of seventy by one hundred feet (70' x 100') to accommodate a "safety zone" of five (5) feet from any spectator seating. If no spectators are seated on the left and right sides, then the safety zone will be eliminated on the left and right sides of the competition area and can extend to the maximum of 106'X 78'.

The "competition area" at this event measures 100'X 75'. All performing groups must be prepared to perform within that area. Floors (tarps) may not extend into the safety zones per rules found in the WGI Adjudication Manual and Rulebook.

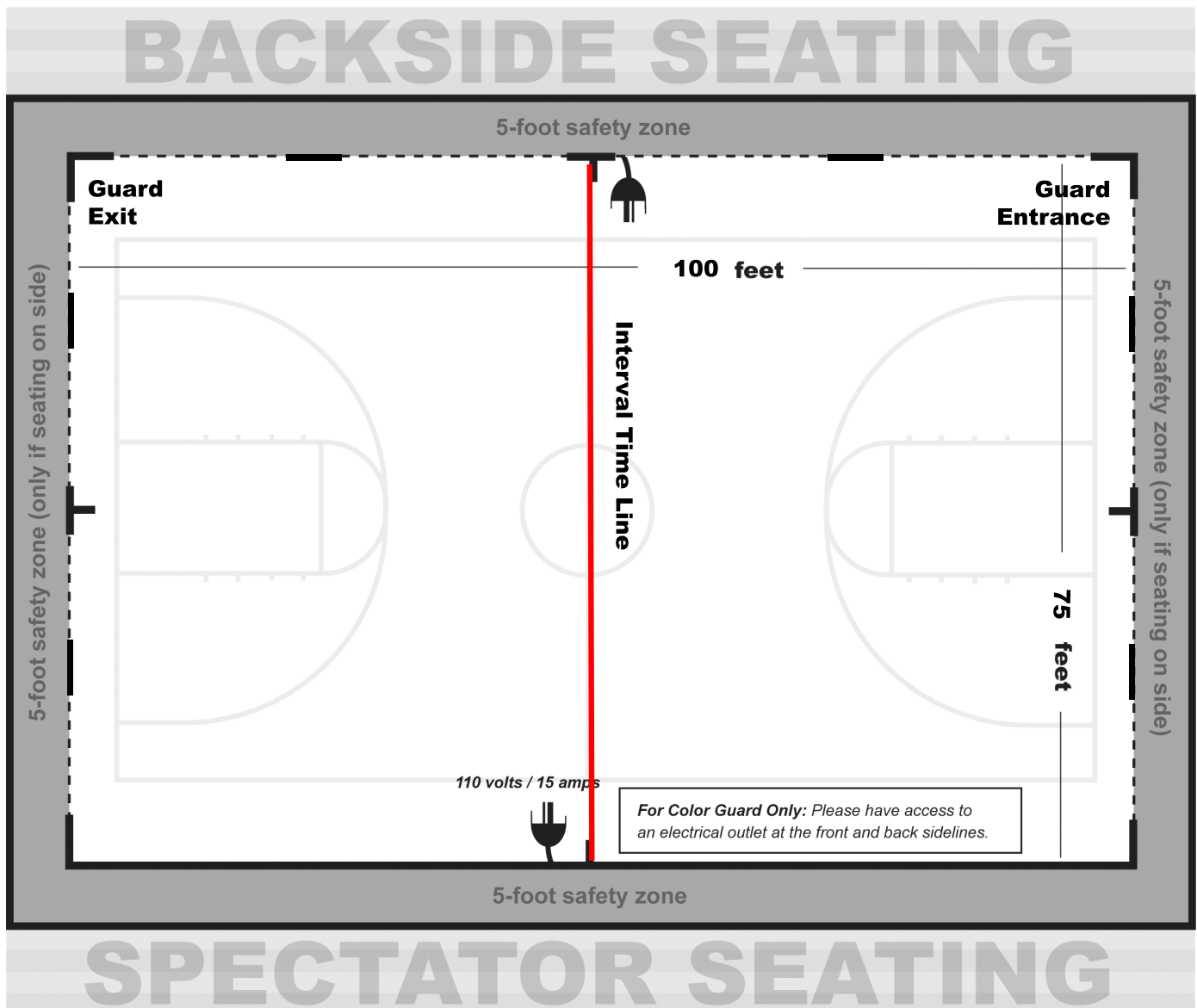

From the WGI Policy Manual

4.120 Sound Policy (Color Guard)

- All color guards should do a sound check at the designated times provided in the contest information packet to ensure the playability of any device or CD. Color guards should check the soundtrack at multiple places in the music to verify playability of any device
- Color guards should still do a sound check if they are using the WGI Music Upload in CompetitionSuite to ensure everything is correct.
- Color guard is responsible for providing the method that the music will be played, e.g. CD, MP3, computer, etc. Each color guard should have two methods to play their soundtrack in the event one does not work.
- Color guard must provide their music in a timely manner to the designated sound operator. Any delay in providing music is the responsibility of the color guard.
- Color guards using the Music Upload process through CompetitionSuite should have a backup using another device type such as an MP3 player, iPhone, or CD.
- Color guard must have a designated person at the sound table to operate any device provided to play music such as MP3 players or computers. Guard's representative is responsible to set up and play device. If a CD is provided, the color guard representative must instruct the sound operator as to what track or other relevant information is needed to start the music when directed by the contest Timing and Penalty judge or after the color guard's introduction.
- If the color guard has an issue with the music such as music is too soft, it begins in the wrong place or skips, the color guard's representative must make the decision to stop the music and tell the operator to stop the music. If the color guard representative chooses not to stop and the color guard completes their performance, the color guard will not be offered an opportunity to perform again.
- Interval timing will continue as the color guard resets and begins again. The Contest Administrator has the sole discretion in waiving any timing penalty due to the restart. If the stoppage is due to faulty sound equipment, operator error or an unexplained reason, overtime penalty may be waived.
- Issues related to the equipment provided by the color guard, quality of the CD or the color guard's representative error (using wrong playlist on MP3, etc.) will result in the actual interval timing being used and penalties, if any, being assessed.
- Volume direction must come from the color guard representative at the sound table. Direction will not be taken from the audience viewing area or across the floor. Final volume discretion is given to the sound operator based on their equipment and the Chief Judge who ultimately determines an appropriate volume level.
- The color guard representative may provide direction to the sound operator during the performance regarding equalization.
- It is the responsibility of the color guard to provide their music for each performance and to ensure that their soundtrack is working appropriately. CDs may not be left at sound table between performances.
- Under no circumstances will verbal abuse of the sound operator be tolerated. Penalties will be assessed per current WGI rules



FLOMARCHING

**This event will be
webcast LIVE on
FloMarching**

**For more info visit
WGI.org/webcast**

