



# IMPORTANT HEALTH & SAFETY UPDATES

# MASKS RECOMMENDED

**WGI INDIANAPOLIS COLOR GUARD REGIONAL**  
***(WARREN CENTRAL HIGH SCHOOL)***

**EVERYONE IN ATTENDANCE AT THIS REGIONAL IS RECOMMENDED TO  
WEAR A MASK.**

Performers may remove their mask while in warm up or while on the performance floor but are recommended to wear their mask at all other times in the building. Everyone else with the group is recommended to wear a mask at all times.

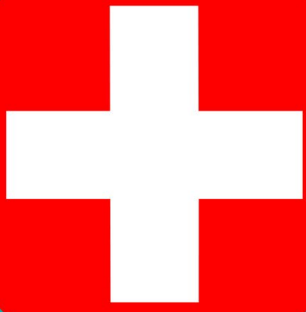

# IMPORTANT HEALTH & SAFETY UPDATES

# MASKS RECOMMENDED

**WGI INDIANAPOLIS COLOR GUARD REGIONAL**  
***GREENFIELD CENTRAL HIGH SCHOOL***  
***SA PRELIMS & SEMI FINALS ONLY***

**EVERYONE IN ATTENDANCE AT THIS REGIONAL IS RECOMMENDED TO  
WEAR A MASK.**

Performers may remove their mask while in warm up or while on the performance floor but are recommended to wear their mask at all other times in the building. Everyone else with the group is recommended to wear a mask at all times.

***THERE COULD BE DIFFERENT PROTOCOLS AT EACH WGI EVENT, PLEASE READ THROUGH ALL INFORMATION CAREFULLY.***

# **INDIANAPOLIS COLOR GUARD**

## **REGIONAL CONTEST INFORMATION**

### **RA/IA/OPEN/WORLD PRELIMS**

### **ALL FINALS**

### **SATURDAY & SUNDAY, MARCH 19 & 20, 2022**



---

#### **LOCATION**

Warren Central High School  
9500 East 16<sup>th</sup> Street  
Indianapolis, IN 46229

For GPS address use 9651 East 21<sup>st</sup> Street, Indianapolis, IN 46229

---

#### **EMERGENCY CONTACTS (DAY OF SHOW ONLY)**

CONTEST ADMINISTRATOR: Jeanne Strong / 720-641-3945 / [Jeanne@wgi.org](mailto:Jeanne@wgi.org)  
EVENT PARTNER: Ed Meckes / 317-691-9150 / [emeckes@warren.k12.in.us](mailto:emeckes@warren.k12.in.us)

---

#### **JUDGE PANEL**

Judge Panels are available in this packet.

---

#### **COMPETITIONSUITE DETAILS**

ACCESSING YOUR GROUP - <https://help.competitionsuite.com/article/16-accessing-your-group>

ADDING YOUR STAFF - <https://help.competitionsuite.com/article/61-adding-staff-members>

ACCESSING COMMENTARY - <https://help.competitionsuite.com/article/17-accessing-commentary>

MUSIC UPLOADS - <https://help.competitionsuite.com/article/74-uploading-performance-music>

*Score Summary Sheets are also located in your CompetitionSuite account with your overall score.*

---

#### **ADDITIONAL REGIONAL INFO**

PRELIMS LOGISTICAL SCHEDULE - <https://tinyurl.com/56vzv88d>

FINALS LOGISTICAL SCHEDULE - <https://tinyurl.com/3j5us33e>

WARM UP AREAS – Music is not permitted as it will disturb the other color guard in the space.

RETREAT – Each group may designate one individual to represent the group on the floor during retreat. Masks are recommended. If your group is not attending retreat, please designate one individual (parent, staffer, or designated representative) to stay and retrieve your award at the conclusion of retreat. Please inform the Contest Administrator on site if your group will not be attending retreat.

REGIONAL REMINDERS – <https://wgi.org/wp-content/uploads/2022/01/2022CGRegionalReminders.pdf>

***WARREN CENTRAL HIGH SCHOOL DOES NOT PERMIT ANY OUTSIDE FOOD OR BEVERAGE TO BE BROUGHT INTO THE FACILITY.***

**THERE COULD BE DIFFERENT PROTOCOLS AT EACH WGI EVENT, PLEASE READ  
THROUGH ALL INFORMATION CAREFULLY.**

# **INDIANAPOLIS COLOR GUARD REGIONAL CONTEST INFORMATION SA PRELIMS & SEMI FINALS ONLY SATURDAY, MARCH 19, 2022**



---

## **LOCATION**

Greenfield Central High School  
810 North Broadway Street  
Greenfield, IN 46140

---

## **EMERGENCY CONTACTS (DAY OF SHOW ONLY)**

CONTEST ADMINISTRATOR: Kendra Whelchel / 303-946-3349 / [Kendra@wgi.org](mailto:Kendra@wgi.org)  
EVENT PARTNER: Chris Wing / 317-467-6727 / [cwing@gcsc.k12.in.us](mailto:cwing@gcsc.k12.in.us)

---

## **JUDGE PANEL**

Judge Panels are available in this packet.

---

## **COMPETITIONSUITE DETAILS**

ACCESSING YOUR GROUP - <https://help.competitionsuite.com/article/16-accessing-your-group>

ADDING YOUR STAFF - <https://help.competitionsuite.com/article/61-adding-staff-members>

ACCESSING COMMENTARY - <https://help.competitionsuite.com/article/17-accessing-commentary>

MUSIC UPLOADS - <https://help.competitionsuite.com/article/74-uploading-performance-music>

*Score Summary Sheets are also located in your CompetitionSuite account with your overall score.*

---

## **ADDITIONAL REGIONAL INFO**

PRELIMS LOGISTICAL SCHEDULE - <https://tinyurl.com/8x2avxma>

SEMI FINALS LOGISTICAL SCHEDULE - <https://tinyurl.com/yazsdwhu>

WARM UP AREAS – Music is not permitted as it will disturb the other color guard in the area.

REGIONAL REMINDERS – <https://wgi.org/wp-content/uploads/2022/01/2022CGRegionalReminders.pdf>

# Indianapolis Color Guard Regional (March)

## Judge Panels

### SCHOLASTIC A PRELIMS & SEMI FINALS @ GREENFIELD CENTRAL HS

	Equipment	Movement	Design Analysis	General Effect	General Effect
<b>SA</b>	Denise Bonfiglio	Meghan McCourt	Hieu Nguyen	Christine Dillon	Ted Wemhoff

Timing and Penalties - Chris Tomsa

### ALL OTHER PRELIMS AT WARREN CENTRAL HS

	Equipment	Movement	Design Analysis	General Effect	General Effect
<b>SRA</b>	Tim Hudnall	Jackie Campbell	George Oliviero	William Chumley	Damon Padilla
<b>IRA</b>	Tim Hudnall	Jackie Campbell	George Oliviero	William Chumley	Damon Padilla
<b>IA</b>	Tim Hudnall	Jackie Campbell	George Oliviero	William Chumley	Damon Padilla
<b>SO</b>	Tim Hudnall	Jackie Campbell	George Oliviero	William Chumley	Damon Padilla
<b>IO</b>	Tim Hudnall	Jackie Campbell	George Oliviero	William Chumley	Damon Padilla
<b>SW</b>	Tim Hudnall	Jackie Campbell	George Oliviero	William Chumley	Damon Padilla
<b>IW</b>	Tim Hudnall	Jackie Campbell	George Oliviero	William Chumley	Damon Padilla

Timing and Penalties - Phil Tanner

### ALL CLASS FINALS AT WARREN CENTRAL HS

	Equipment	Movement	Design Analysis	General Effect	General Effect
<b>SRA</b>	Damon Padilla	Hieu Nguyen	Denise Bonfiglio	William Chumley	Meghan McCourt
<b>IRA</b>	Damon Padilla	Hieu Nguyen	Denise Bonfiglio	William Chumley	Meghan McCourt
<b>SA</b>	Damon Padilla	Hieu Nguyen	Denise Bonfiglio	William Chumley	Meghan McCourt
<b>IA</b>	Damon Padilla	Hieu Nguyen	Denise Bonfiglio	William Chumley	Meghan McCourt
<b>SO</b>	Denise Bonfiglio	Hieu Nguyen	William Chumley	Meghan McCourt	Damon Padilla
<b>IO</b>	Denise Bonfiglio	Hieu Nguyen	William Chumley	Meghan McCourt	Damon Padilla
<b>SW</b>	Denise Bonfiglio	Hieu Nguyen	William Chumley	Meghan McCourt	Damon Padilla
<b>IW</b>	Denise Bonfiglio	Hieu Nguyen	William Chumley	Meghan McCourt	Damon Padilla

Timing and Penalties - Phil Tanner

# **Warren Central HS Site Maps**

# Spectator Parking

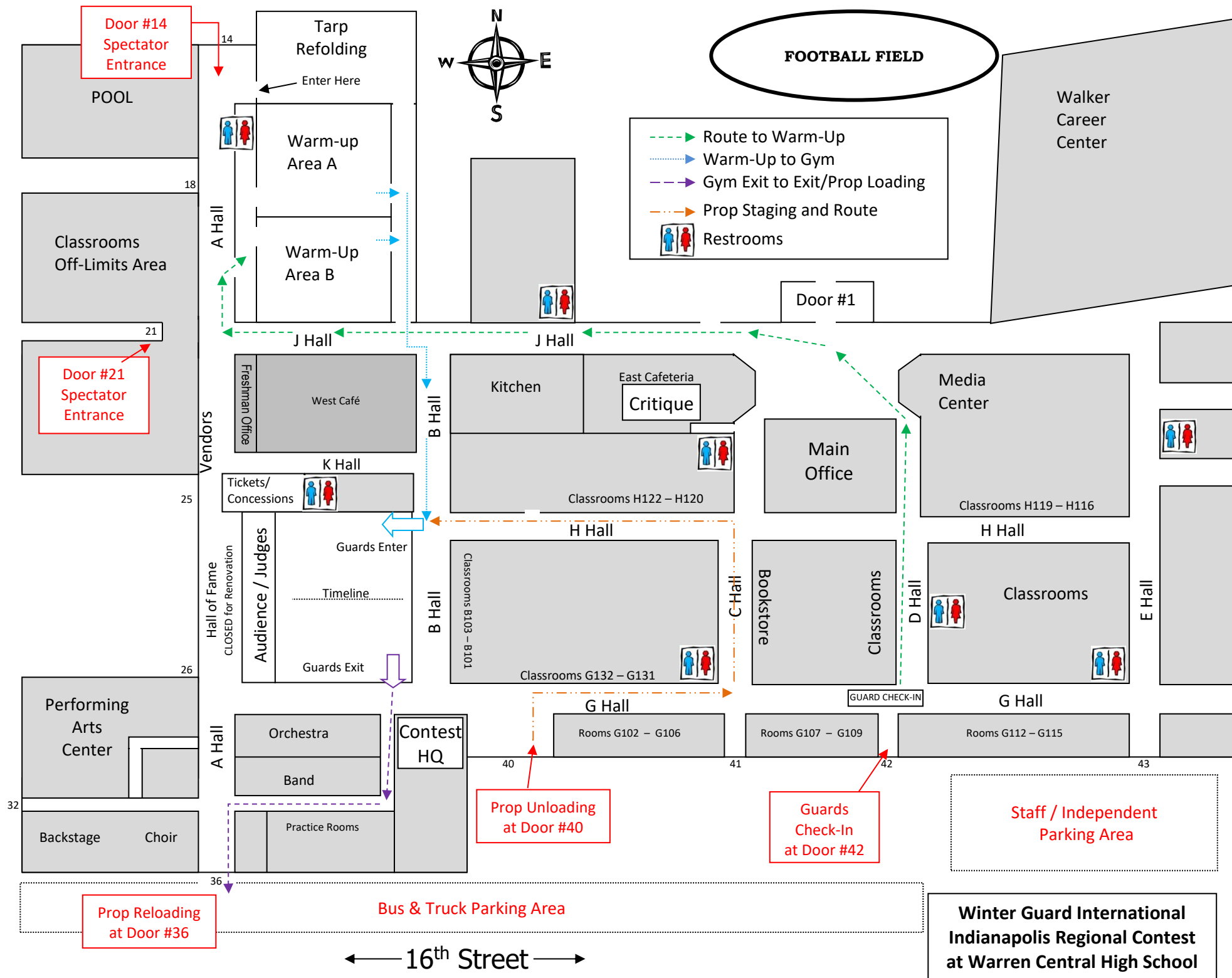





WGI Indianapolis Color Guard Regional  
WARREN CENTRAL HS  
Indianapolis, Indiana

Spectator Entrance  
Door #14

Spectator Entrance  
Door #21

PERFORMANCE  
GYM

Equipment/Prop Load  
Door #36

Equipment/Prop Unload  
Door #40

Guard Check-In  
Door #42

STAFF / PERFORMER  
PARKING

BUS / TRUCK / TRAILER PARKING  
NEW PARKING AREA FOR LARGE VEHICLES

ENTRANCE FOR BUSES, TRUCKS  
& STAFF VEHICLES

Spectator parking

Spectators Enter Campus



# WGI Indianapolis Color Guard Regional

## Warren Central High School

### RA/IA/Open/World Prelims

### All Finals

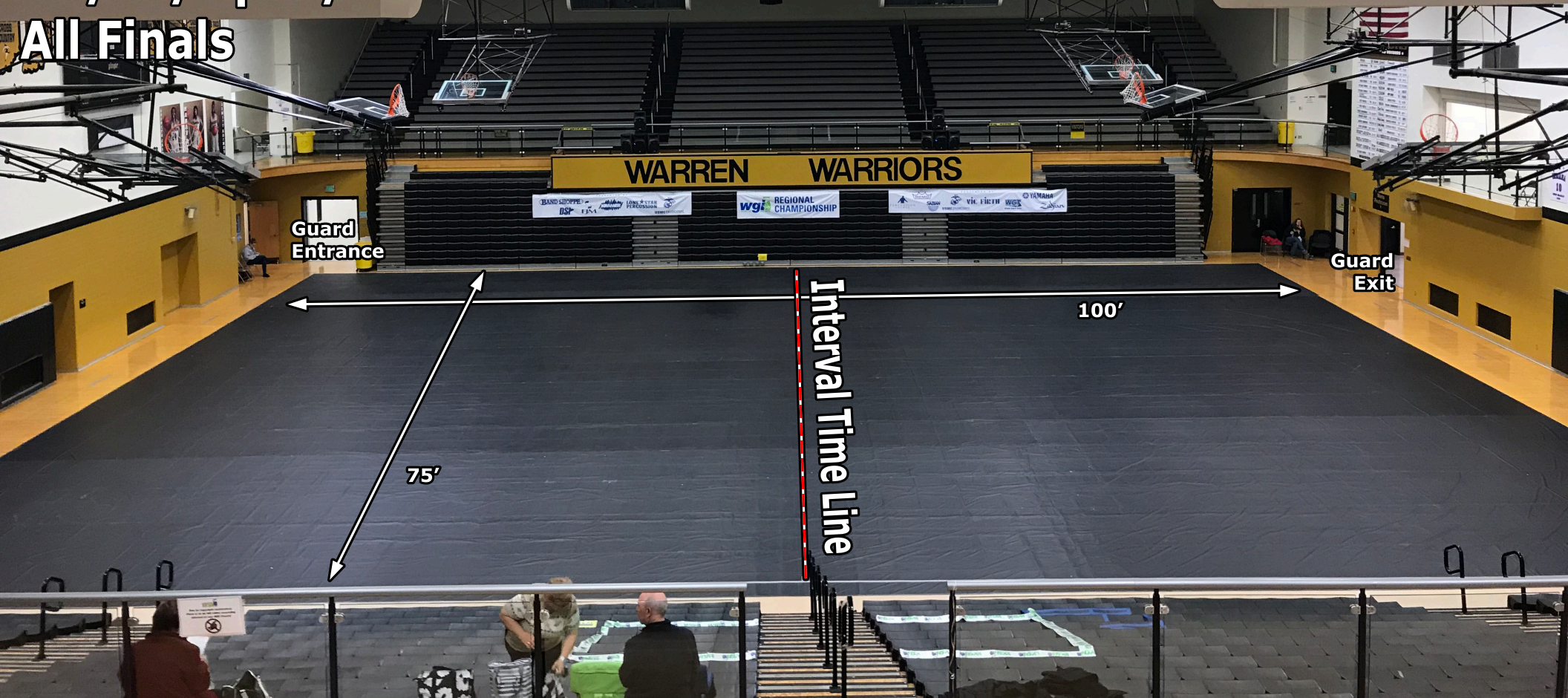



## Indianapolis Regional Competition Area Warren Central High School, Indianapolis, IN

All WGI contest sites must have a minimum of seventy by one hundred feet (70' x 100') to accommodate a "safety zone" of five (5) feet from any spectator seating. If no spectators are seated on the left and right sides, then the safety zone will be eliminated on the left and right sides of the competition area and can extend to the maximum of 106'X 78'.

The "competition area" at this event measures 100'X 75'. All performing groups must be prepared to perform within that area. Floors (tarps) may not extend into the safety zones per rules found in the WGI Adjudication Manual and Rulebook.

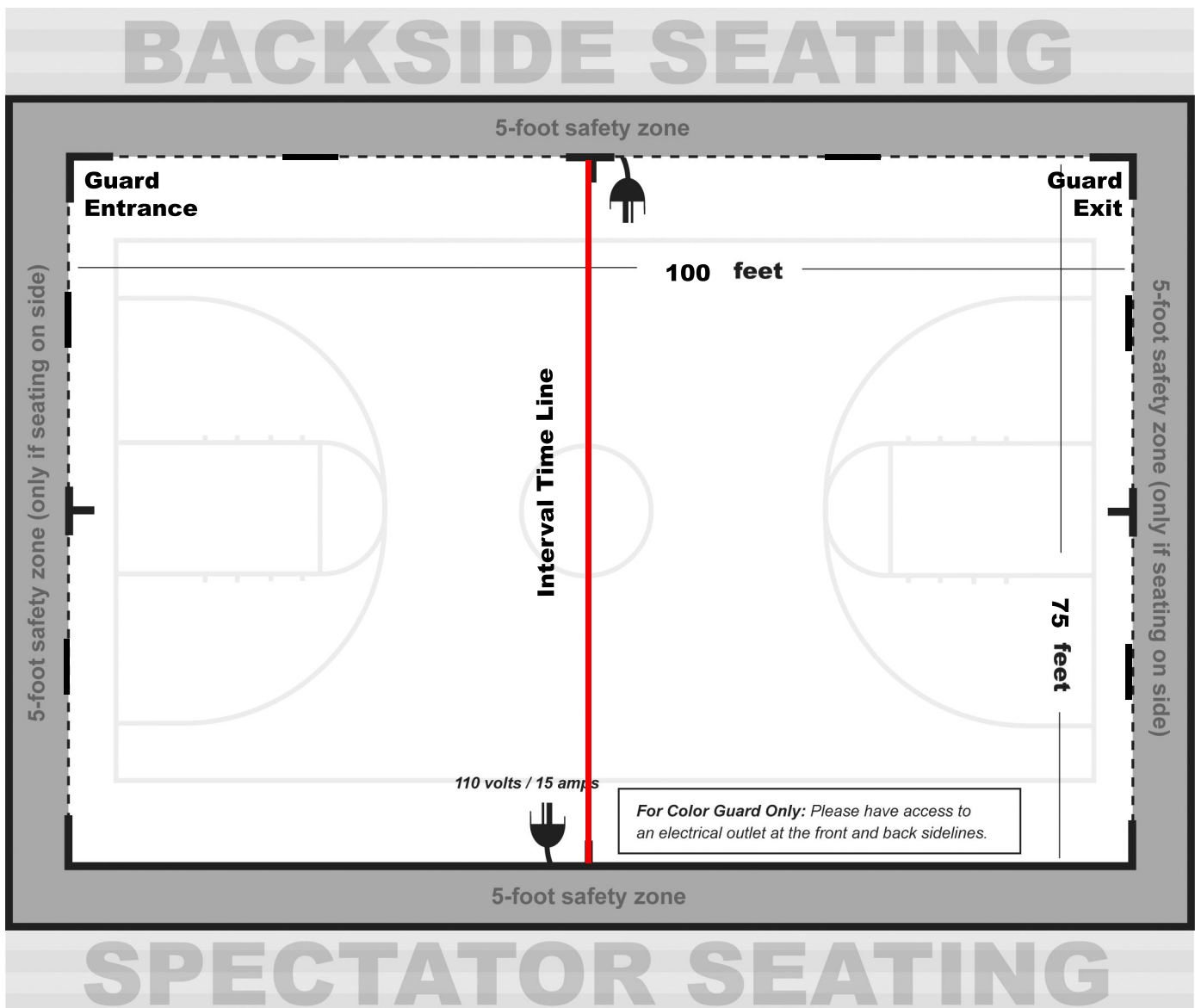

# **Greenfield Central HS SA ONLY Site Maps**



# WGI Indianapolis Color Guard Regional SA Prelims and Semi Finals ONLY Greenfield Central High School

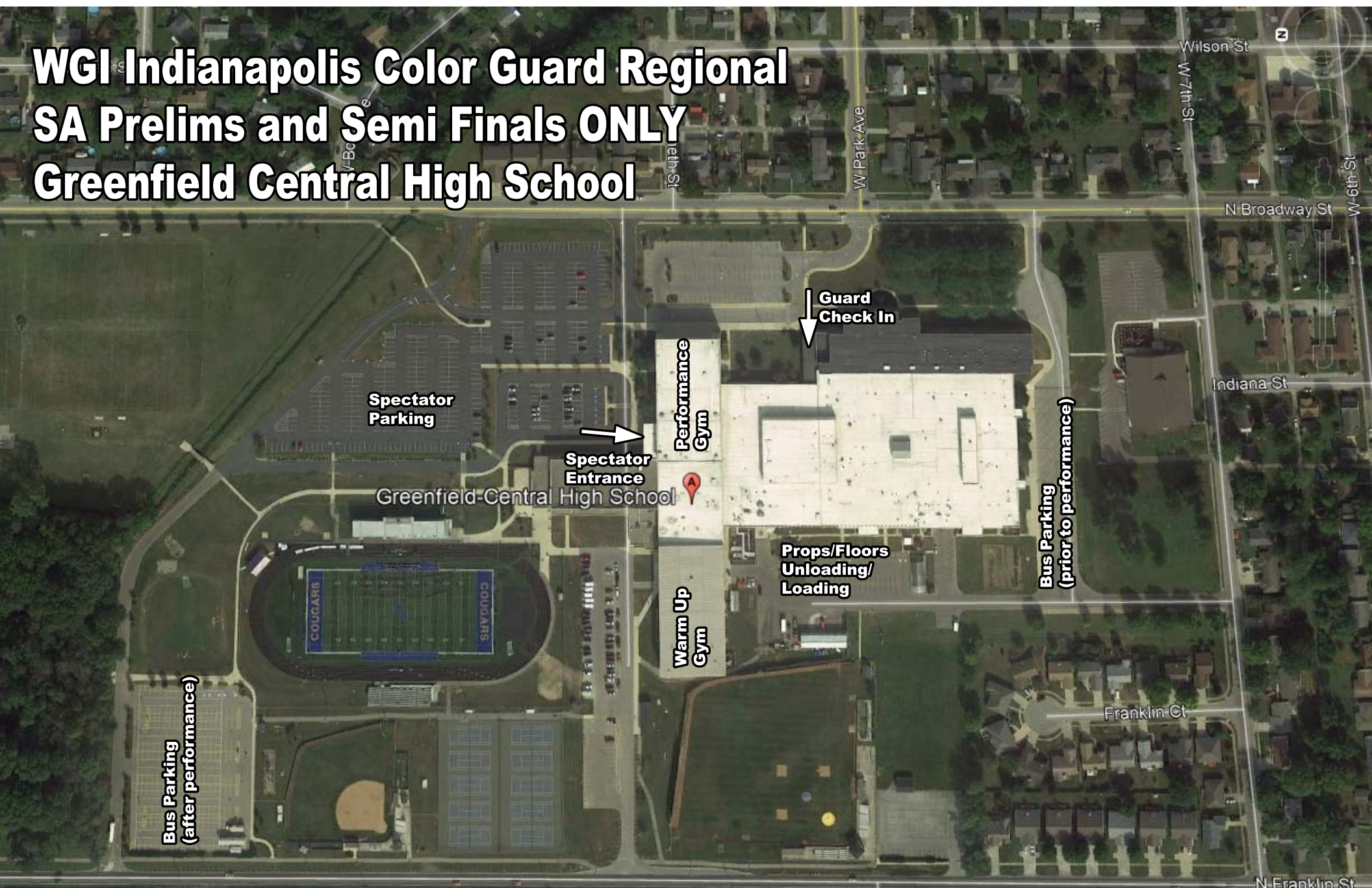

**Spectator  
Parking**

**Spectator  
Entrance**

Greenfield-Central High School

**Performance  
Gym**

**Guard  
Check In**

**Warm Up  
Gym**

**Props/Floors  
Unloading/  
Loading**

**Bus Parking  
(prior to performance)**

**Bus Parking  
(after performance)**

Franklin Ct

N Franklin St

Wilson St

W 7th St

W Park Ave

N Broadway St

Indiana St

W 6th St



WGI Indianapolis Color Guard Regional  
SA Prelims and Semis ONLY

Greenfield-Central High School

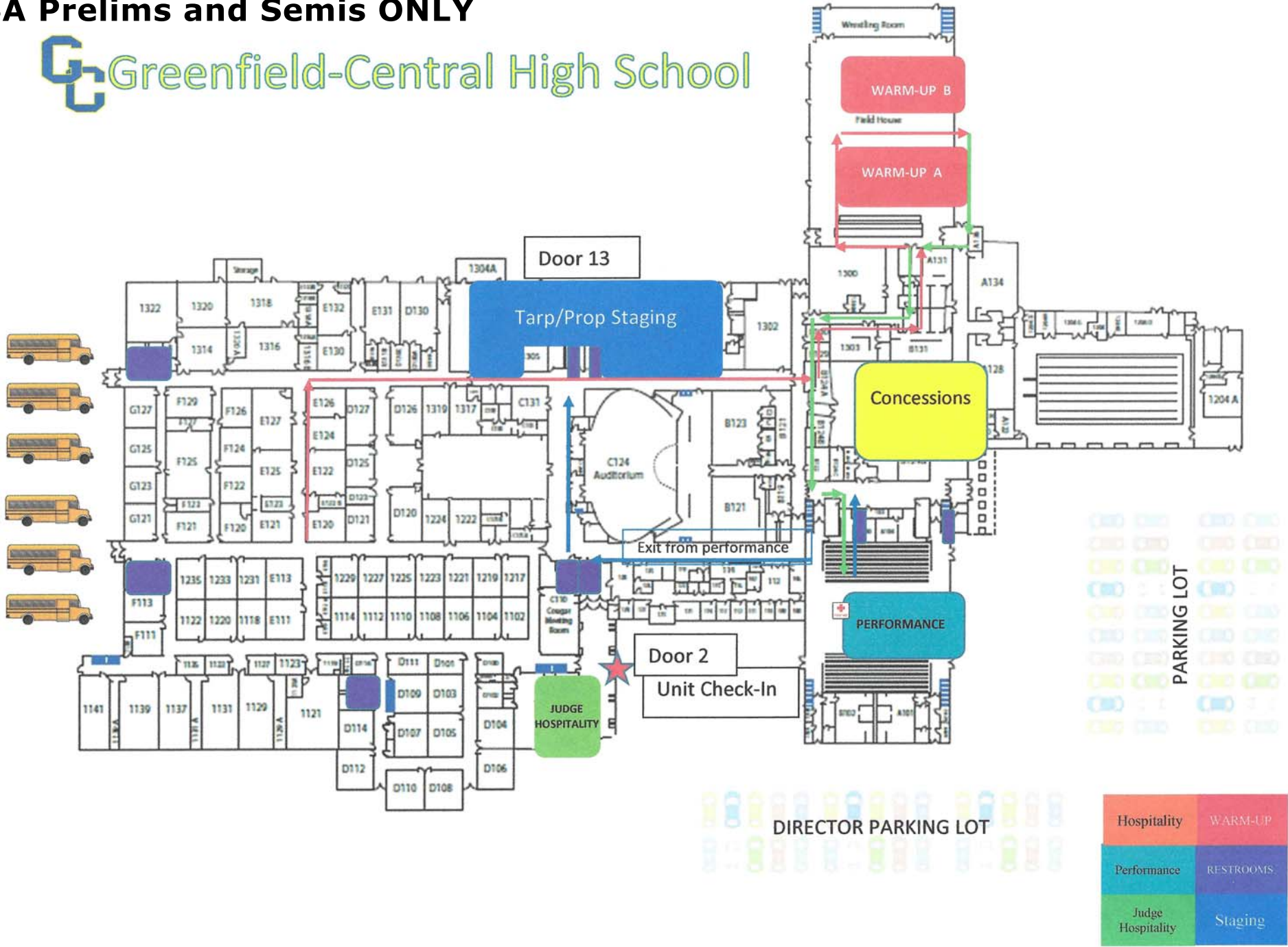



# WGI Indianapolis Color Guard Regional

## Greenfield Central High School

### Scholastic A Prelims and Semi Finals

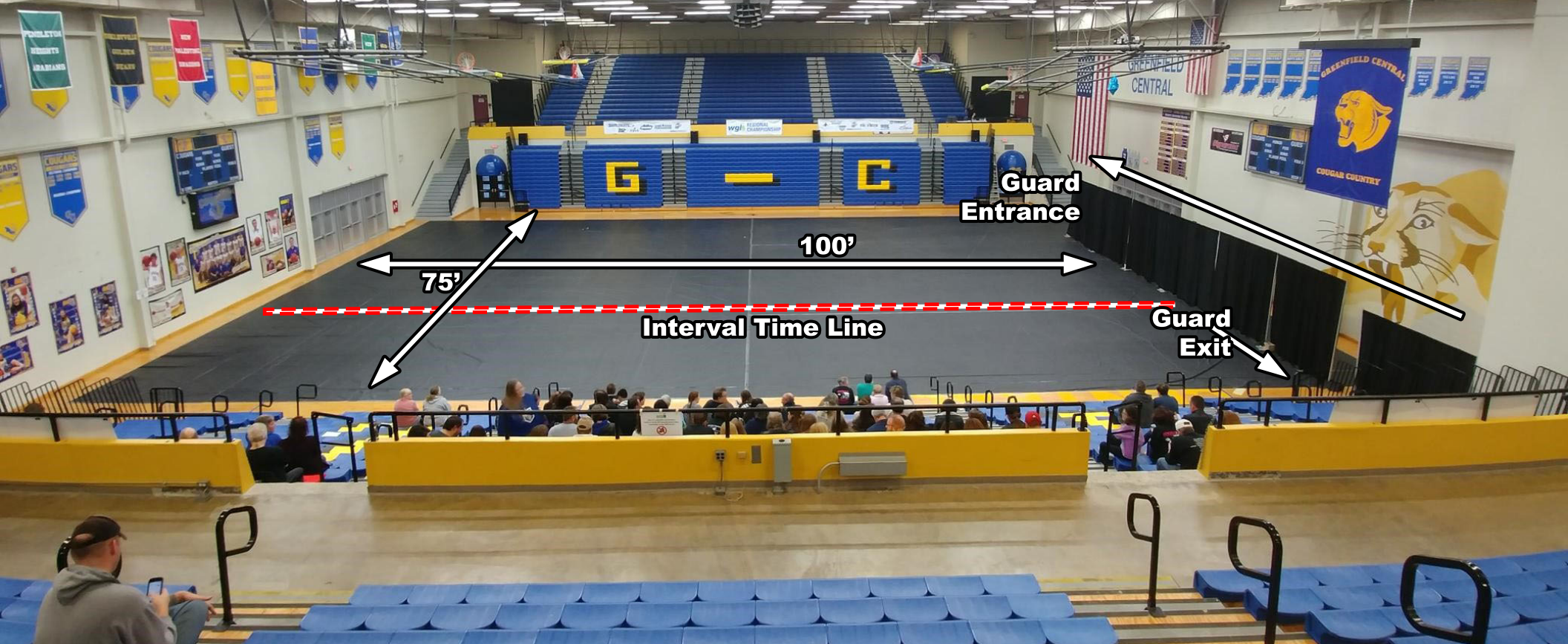



**WGI Indianapolis Color Guard Regional Competition Area  
Greenfield Central HS, Greenfield, IN  
SA Prelims/Semis ONLY**

All WGI contest sites must have a minimum of seventy by one hundred feet (70' x 100') to accommodate a "safety zone" of five (5) feet from any spectator seating. If no spectators are seated on the left and right sides, then the safety zone will be eliminated on the left and right sides of the competition area and can extend to the maximum of 106'X 78'.

The "competition area" at this event measures 100'X 75'. All performing groups must be prepared to perform within that area. Floors (tarps) may not extend into the safety zones per rules found in the WGI Adjudication Manual and Rulebook.

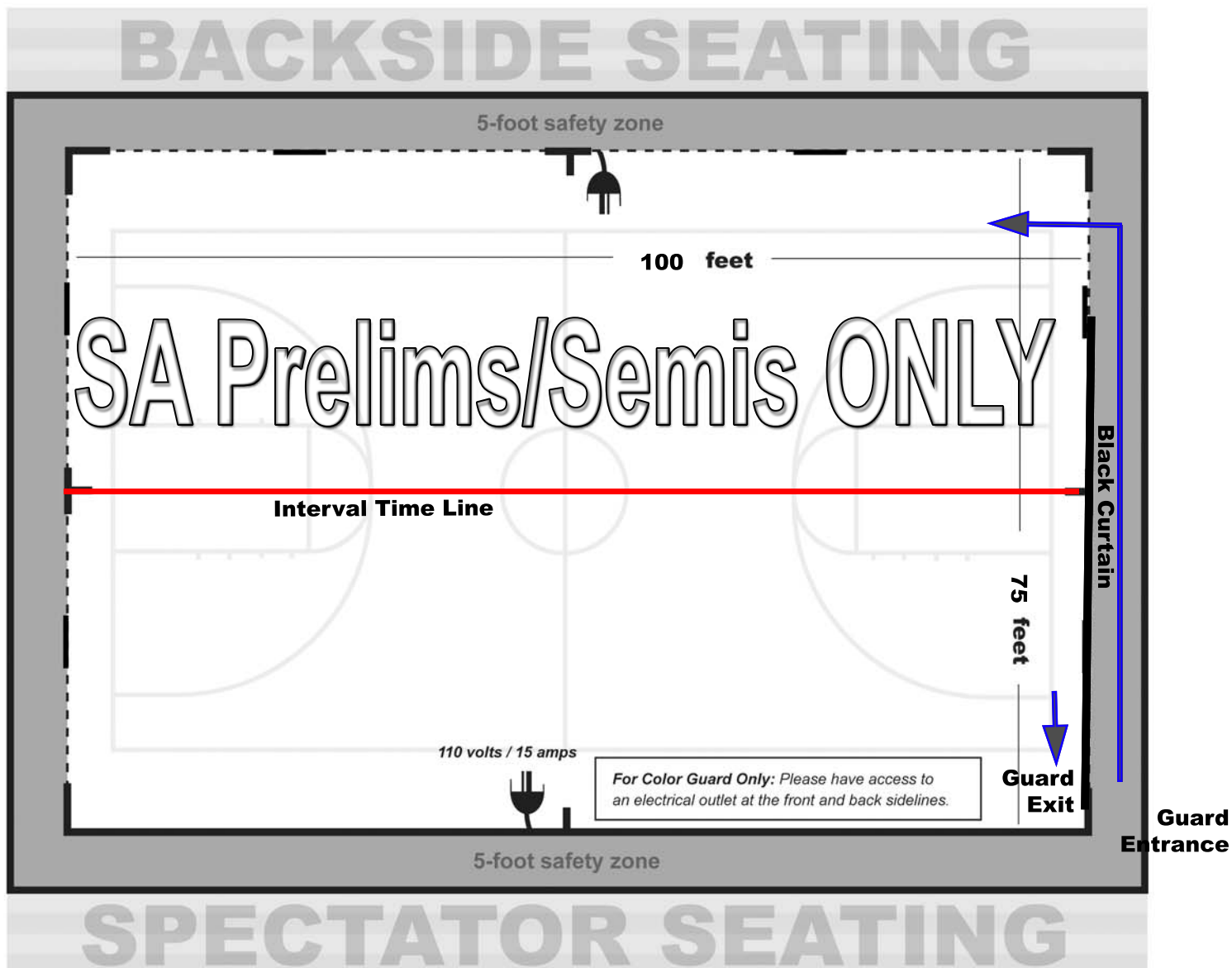

## ***From the WGI Policy Manual***

### **4.120 Sound Policy (Color Guard)**

- All color guards should do a sound check at the designated times provided in the contest information packet to ensure the playability of any device or CD. Color guards should check the soundtrack at multiple places in the music to verify playability of any device
- Color guards should still do a sound check if they are using the WGI Music Upload in CompetitionSuite to ensure everything is correct.
- Color guard is responsible for providing the method that the music will be played, e.g. CD, MP3, computer, etc. Each color guard should have two methods to play their soundtrack in the event one does not work.
- Color guard must provide their music in a timely manner to the designated sound operator. Any delay in providing music is the responsibility of the color guard.
- Color guards using the Music Upload process through CompetitionSuite should have a backup using another device type such as an MP3 player, iPhone, or CD.
- Color guard must have a designated person at the sound table to operate any device provided to play music such as MP3 players or computers. Guard's representative is responsible to set up and play device. If a CD is provided, the color guard representative must instruct the sound operator as to what track or other relevant information is needed to start the music when directed by the contest Timing and Penalty judge or after the color guard's introduction.
- If the color guard has an issue with the music such as music is too soft, it begins in the wrong place or skips, the color guard's representative must make the decision to stop the music and tell the operator to stop the music. If the color guard representative chooses not to stop and the color guard completes their performance, the color guard will not be offered an opportunity to perform again.
- Interval timing will continue as the color guard resets and begins again. The Contest Administrator has the sole discretion in waiving any timing penalty due to the restart. If the stoppage is due to faulty sound equipment, operator error or an unexplained reason, overtime penalty may be waived.
- Issues related to the equipment provided by the color guard, quality of the CD or the color guard's representative error (using wrong playlist on MP3, etc.) will result in the actual interval timing being used and penalties, if any, being assessed.
- Volume direction must come from the color guard representative at the sound table. Direction will not be taken from the audience viewing area or across the floor. Final volume discretion is given to the sound operator based on their equipment and the Chief Judge who ultimately determines an appropriate volume level.
- The color guard representative may provide direction to the sound operator during the performance regarding equalization.
- It is the responsibility of the color guard to provide their music for each performance and to ensure that their soundtrack is working appropriately. CDs may not be left at sound table between performances.
- Under no circumstances will verbal abuse of the sound operator be tolerated. Penalties will be assessed per current WGI rules





# **FLOMARCHING**

**This event will be  
webcast LIVE on  
FloMarching**

**For more info visit  
[WGI.org/webcast](http://WGI.org/webcast)**

