



WGI Atlanta Color Guard Regional

Site:

Harrison High School NW
4500 Due West Road
Kennesaw, GA 30152

Dimensions: 106' X 67'

Front Side Bleacher Rows: appx 18 **Seating Capacity:** appx 950

Approximate Ceiling Height: 50 ft

There are stairs between the warm up areas and the performance gym.

There are no permanent obstructions directly over the competition area.

Color guards do not enter the competition area directly from the outdoors.

There is electrical power available at the front and back sidelines.

Color guards do not exit the competition area directly to the outdoors.

The hallways surrounding the performance gym will be utilized for prop storage prior to the competition.

In case of inclement weather, an indoor area to refold floors will be made available, otherwise, there is no indoor floor refolding.

There will be a blue vinyl tarp covering the wooden gym floor.

The distance from the warm up area to the competition area is appx 2 minutes.

There are not separate areas for body and equipment.

Warm Up Areas

Auxiliary Gym

Dimensions: appx 55ft. X 35ft.

No obstructions in the area.

Music may not be used as it may disturb the other group in the warm up area.

The above information is being provided to you in order give you the most complete information we currently have on this contest. All information is subject to change either before or during the event by contest personnel based on need.

Detail of Performance Area Lower Level

Performance and Equipment Exit

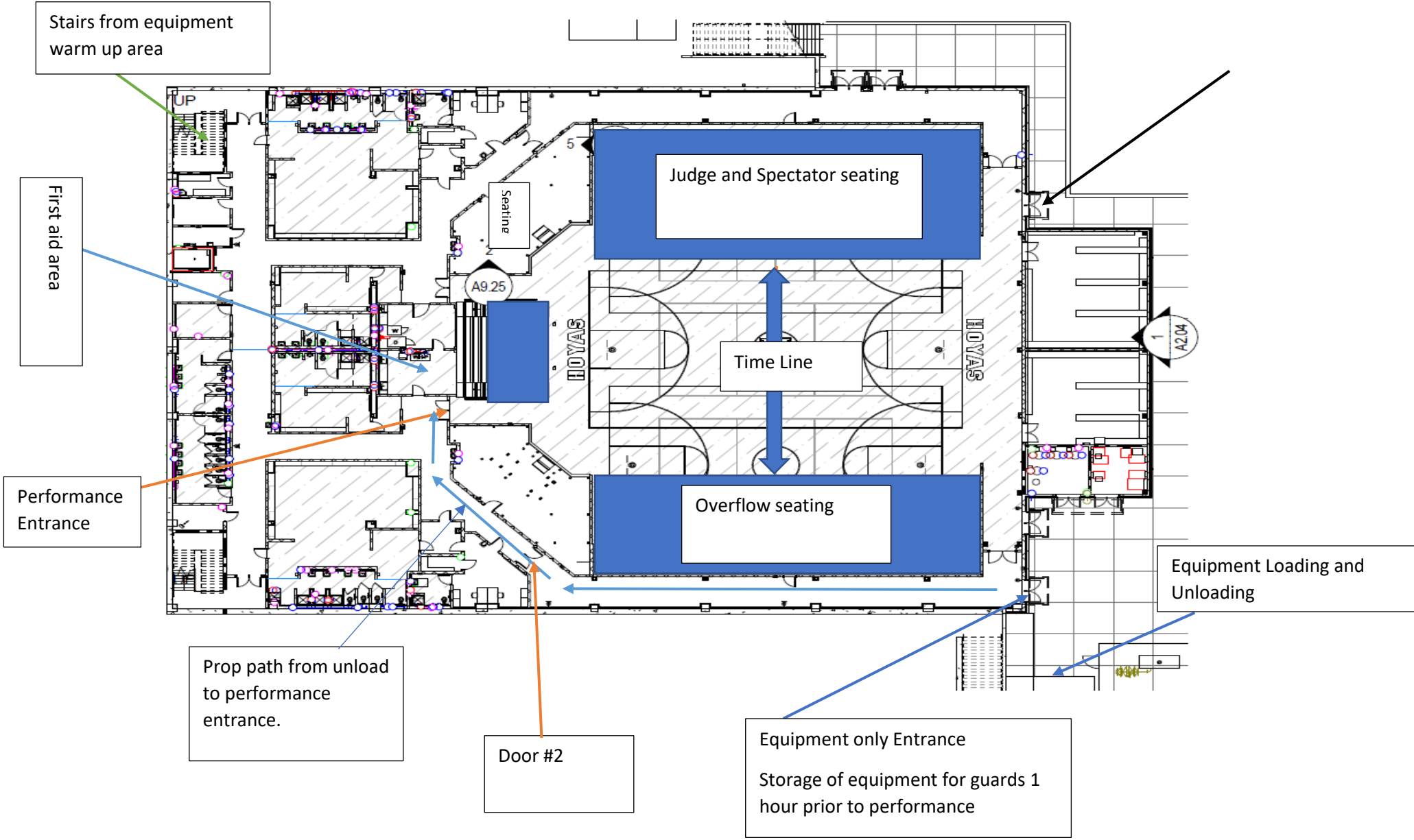

Detail of Performance Area Lower Level

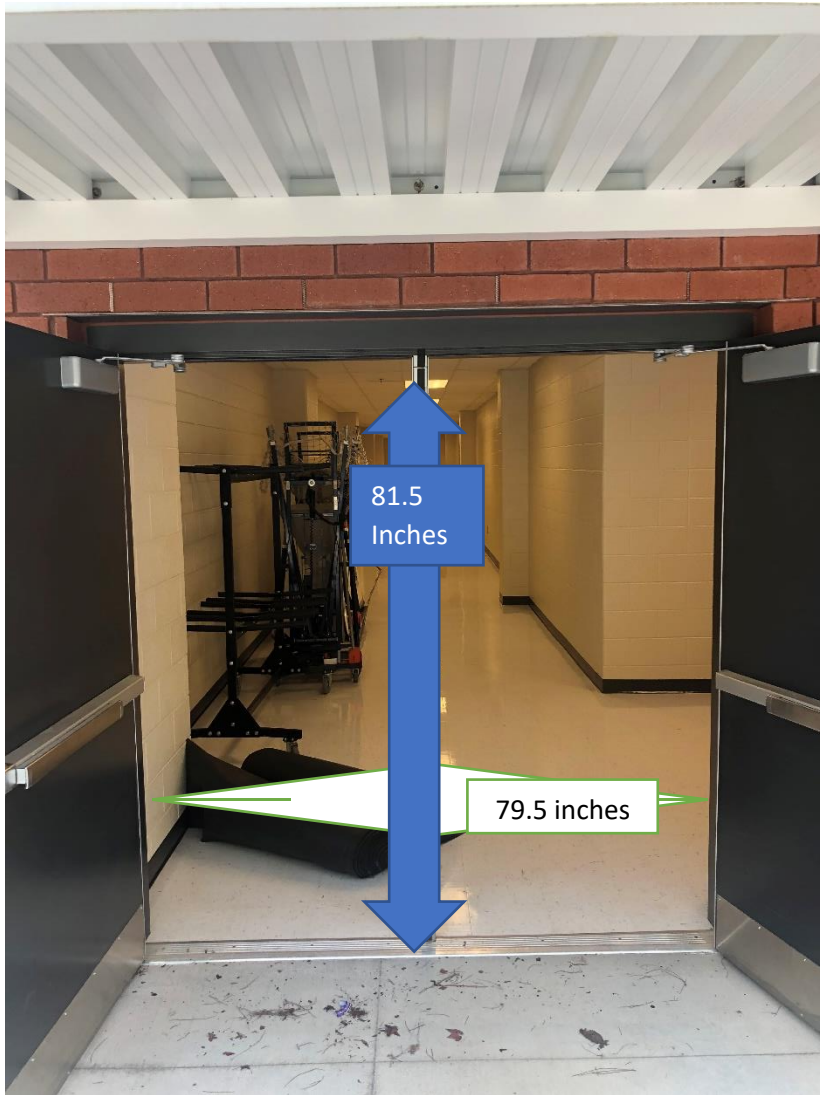

Prop Entrance Door:

Center Bar is removable.

1.5 Cleat at the top of center bar.

Height measurements are from floor to cleat.

Detail of Performance Area Lower Level

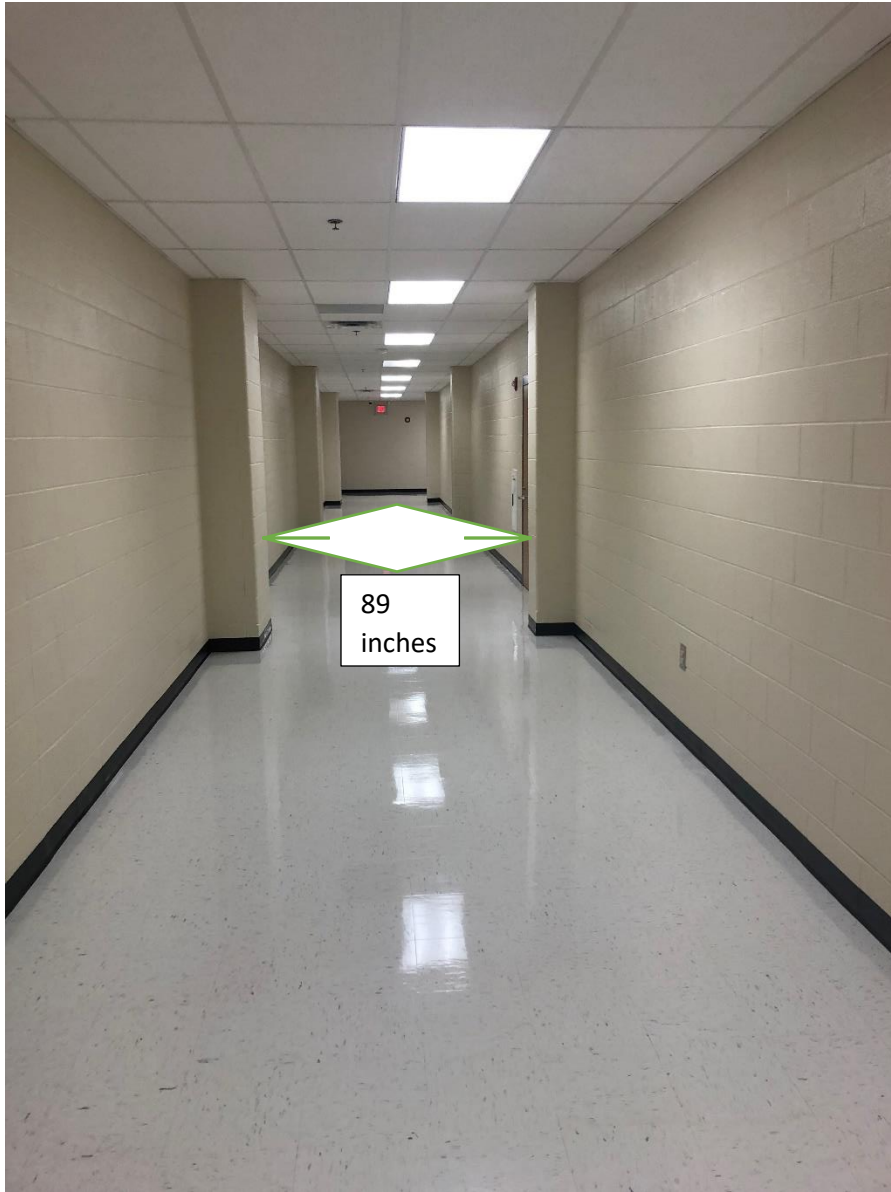

89
inches

Hallway – Prop Staging and storage before performance.

Detail of Performance Area Lower Level

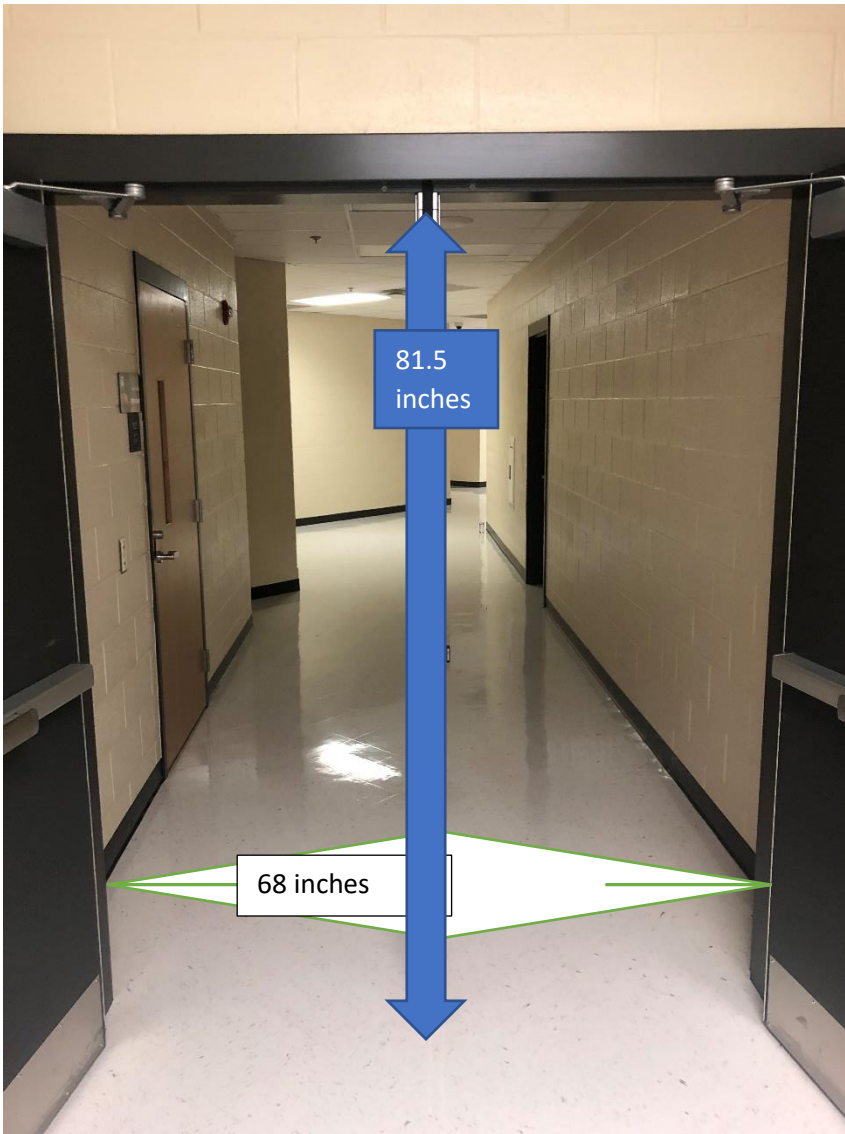

Door #2

Center Bar is Removable

1.5 Cleat at the top of center bar.

Height measurements are from floor to cleat.

Detail of Performance Area Lower Level

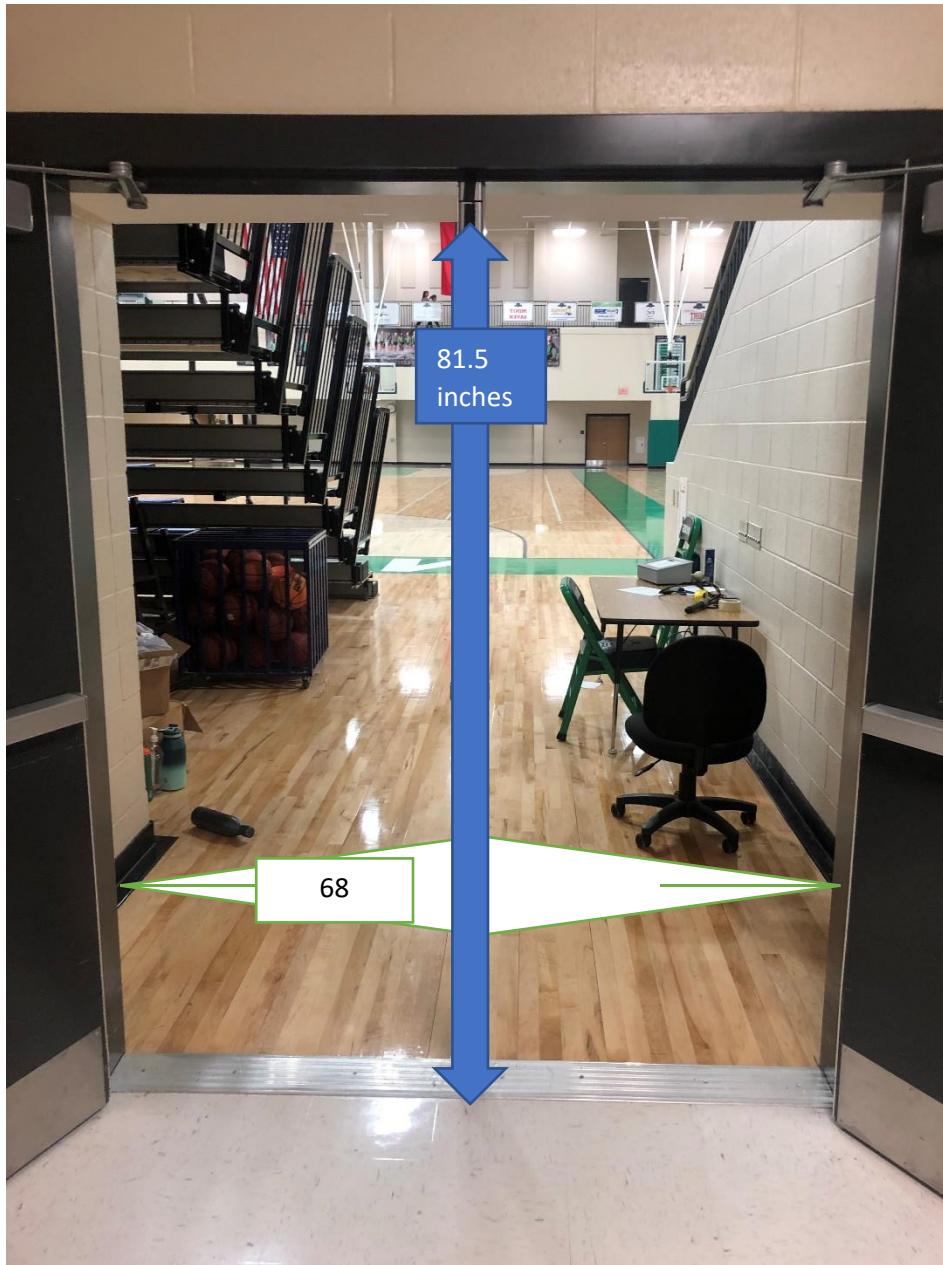

Performance Entrance Door

Center Bar is removable 1.5 cleat at top of center door.

1.5 cleat at the top of center bar.

Height measurements are from floor to cleat.

Detail of Performance Area Lower Level



Exit door for Props and Units.

Center Bar is removable

1.5 cleat at the top of center bar.

Height measurements are from floor to cleat.