

2018 St. Louis Regional Contest Information

Saturday, March 17
Prelims Begin 9 AM
Finals Begin 6 PM

Facility: Francis Howell High School
7001 Highway 94 South
St. Charles, MO 63304

Emergency Contacts (day of show only)

Tom Hachmeister—708-220-5192
Duane Williams—314-288-7714

Ticket Prices/Info

Prelims—\$15
Finals—\$15
Combo—\$23
Non finalists—FREE

Cash or check
Please make checks payable to MCCGA

Please contact the show sponsor ticket contact PRIOR to the show if you have any questions or have a special circumstance.

WGI requires a \$5 backside seat charge. The event partner for this contest has generously decided to cover these costs for non finalist guards.

Regional Contact Info

Contest Administrator—Tom Hachmeister
708-220-5192
tomh@wgi.org

General & Practice Info—Duane Williams
314-288-7714
mccgapresident@yahoo.com

Judge panels are available in this packet.

General Contest Info

TO LISTEN TO JUDGES COMMENTARY: Each director should be set up with an account through CompetitionSuite. This is the only to receive judge's commentary for any WGI event. Instructions to do this are available [here](#).

SOUND CHECK: One hour prior to the start of the contest and during breaks at the discretion of the Contest Administrator. If you choose to use the new music upload feature available in CompetitionSuite, WGI suggests you still do a sound test. Information regarding music uploads is available in the Regional Reminders.

WARM-UP AREA: All maps are located in this packet. There is to be no music in warm up as it is shared space.

PRELIM SCORES: Posted in lobby area.

RECAPS AND FINALS INFO: Pick up 1 hour after your class prelims at the score posting table.

CRITIQUE: There will not be a critique available at this event.

FINALS SCHEDULE: The finals schedule will be made available to you after it has been determined. The SA Class is in ROUNDS for this regional.

FINALISTS: All open and world class color guards must make qualifying score to progress to finals. Qualifying scores are located in the regional reminders.

VIDEOS: No video cameras will be allowed in any contest venue and no authorized space will be provided for groups to record their performance. Any liability associated with unauthorized recordings will rest with the individual or organization making the recording. WGI does not condone, nor accept any liability for, any unauthorized recording during the event.

PRACTICE SITES: Color guards making practice arrangements through the regional committee must settle their invoice at check in upon arriving on Saturday.

PLEASE NOTE: WGI has adopted and will enforce a **NO SMOKING** policy at all WGI Regionals, including practice facilities.

Don't forget to review the [Regional Reminders!](#)



Winter Guard International

2405 Crosspointe Drive, Dayton, OH 45342 Phone: 937-247-5919 Fax: 937-247-9212 Email: office@wgi.org <http://www.wgi.org>



Accessing Judge Commentary

You must have already activated your Competition Suite Account Profile in order for you to be able to listen to WGI judge commentary.

From a Smart phone:

Download the Commentary app:

- Apple: <https://itunes.apple.com/us/app/competitionsuite-commentary/id594112091?ls=1&mt=8>
- Android: <https://play.google.com/store/apps/details?id=com.competitionsuite.commentary>

From the website:

1. Visit <http://competitionsuite.com/login/> and log in using the password you set up in your CompetitionSuite profile.
2. Click on "Performances" on the left side of the page under your group's name.
3. Click on the appropriate commentary file you'd like to download or listen to.

Support

If you have questions, feel free to contact support at help@competitionsuite.com.

WGI St. Louis Color Guard Regional Judge Panels



PRELIMS

	Equipment	Movement	Design Analysis	General Effect	
SRA	Jason Derting	Patty Beggy	Dan Niebauer	Phil Madden	Adam Sage
IRA	Jason Derting	Patty Beggy	Dan Niebauer	Phil Madden	Adam Sage
SA	Jason Derting	Michael Thompson	Keith Baker	Phil Madden	Adam Sage
IA	Patty Beggy	Michael Thompson	Keith Baker	Dan Niebauer	Adam Sage
SO	Patty Beggy	Michael Thompson	Keith Baker	Dan Niebauer	Adam Sage
IO	Patty Beggy	Michael Thompson	Keith Baker	Dan Niebauer	Adam Sage

T&P Alex Vallar

FINALS

	Equipment	Movement	Design Analysis	General Effect	
SRA	Patty Beggy	Michael Thompson	Keith Baker	Dan Niebauer	Adam Sage
IRA	Patty Beggy	Michael Thompson	Keith Baker	Dan Niebauer	Adam Sage
SA	Michael Thompson	Patty Beggy	Keith Baker	Phil Madden	Dan Niebauer
IA	Jason Derting	Patty Beggy	Keith Baker	Dan Niebauer	Adam Sage
SO	Jason Derting	Patty Beggy	Phil Madden	Dan Niebauer	Adam Sage
IO	Jason Derting	Patty Beggy	Phil Madden	Dan Niebauer	Adam Sage

T&P Alex Vallar

WGI St. Louis Color Guard Regional Francis Howell High School

Spectator Parking

Overflow Parking

Spectator Entrance

Performance Gym

Color Guard Check In

Prop Entrance

Bus/Truck Parking



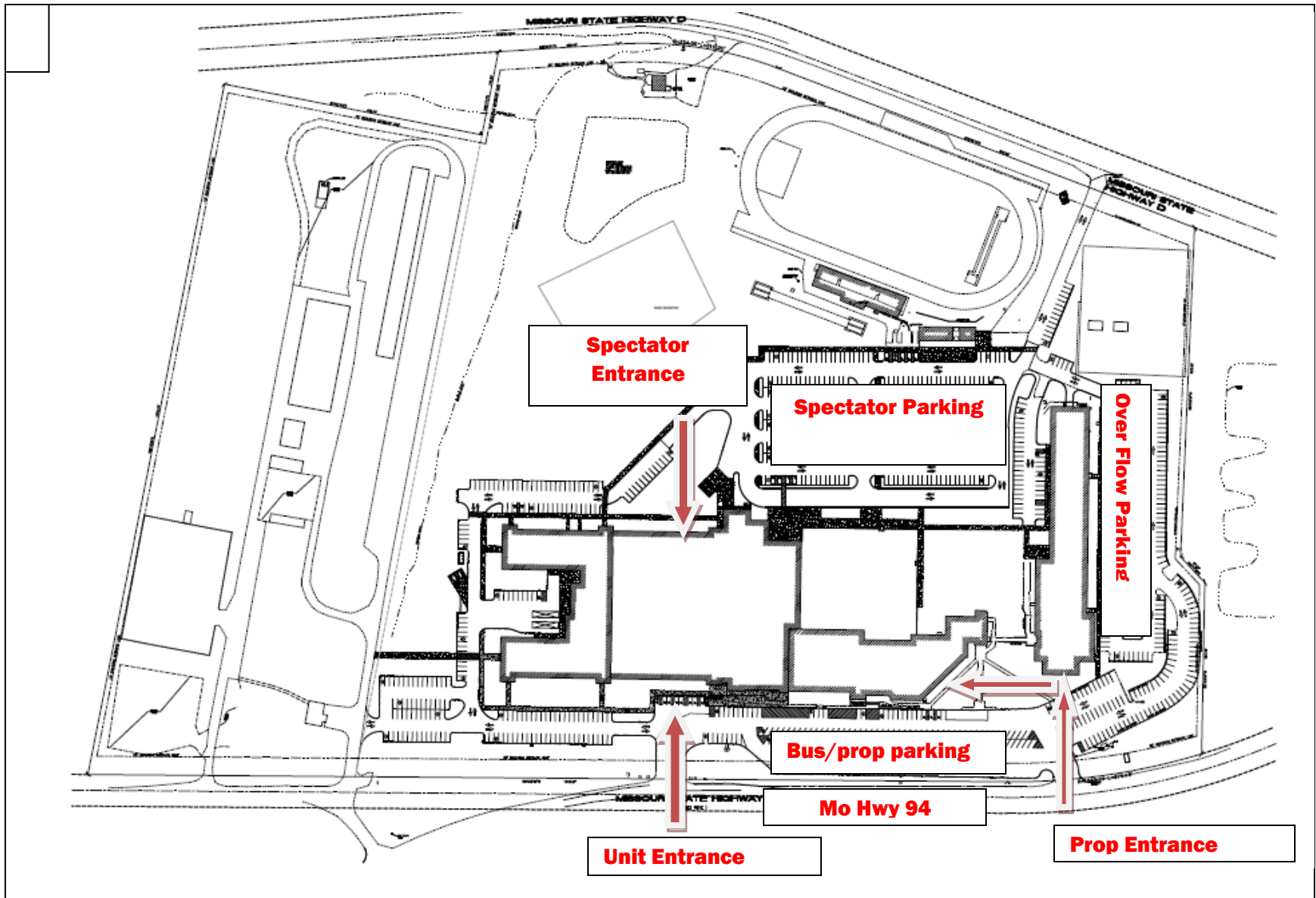

Francis Howell High School

MASTER ACTIVITIES FLOOR PLAN - MAIN LEVEL

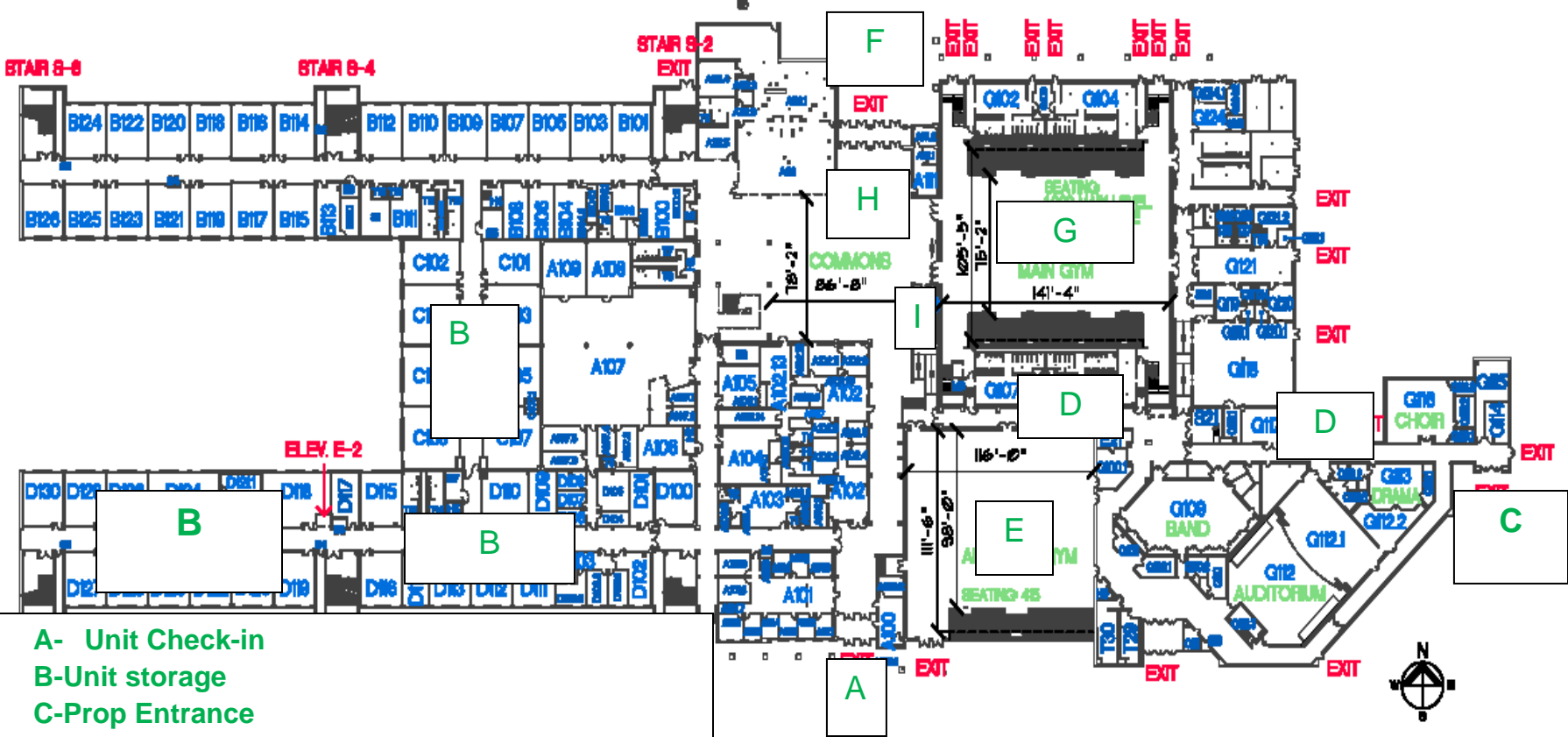

- A- Unit Check-in
- B-Unit storage
- C-Prop Entrance
- D-Prop Storage
- E-Warm up area
- F-Spectator Entrance
- G- Performance gym
- H-Concessions
- I-tabulation room



HOENER ASSOCIATES, INC.
ARCHITECTS ST. LOUIS, MISSOURI

WGI St. Louis Color Guard Regional Francis Howell High School

**Guard
Exit**

106'

Interval Time Line

78'

**Guard
Entrance**

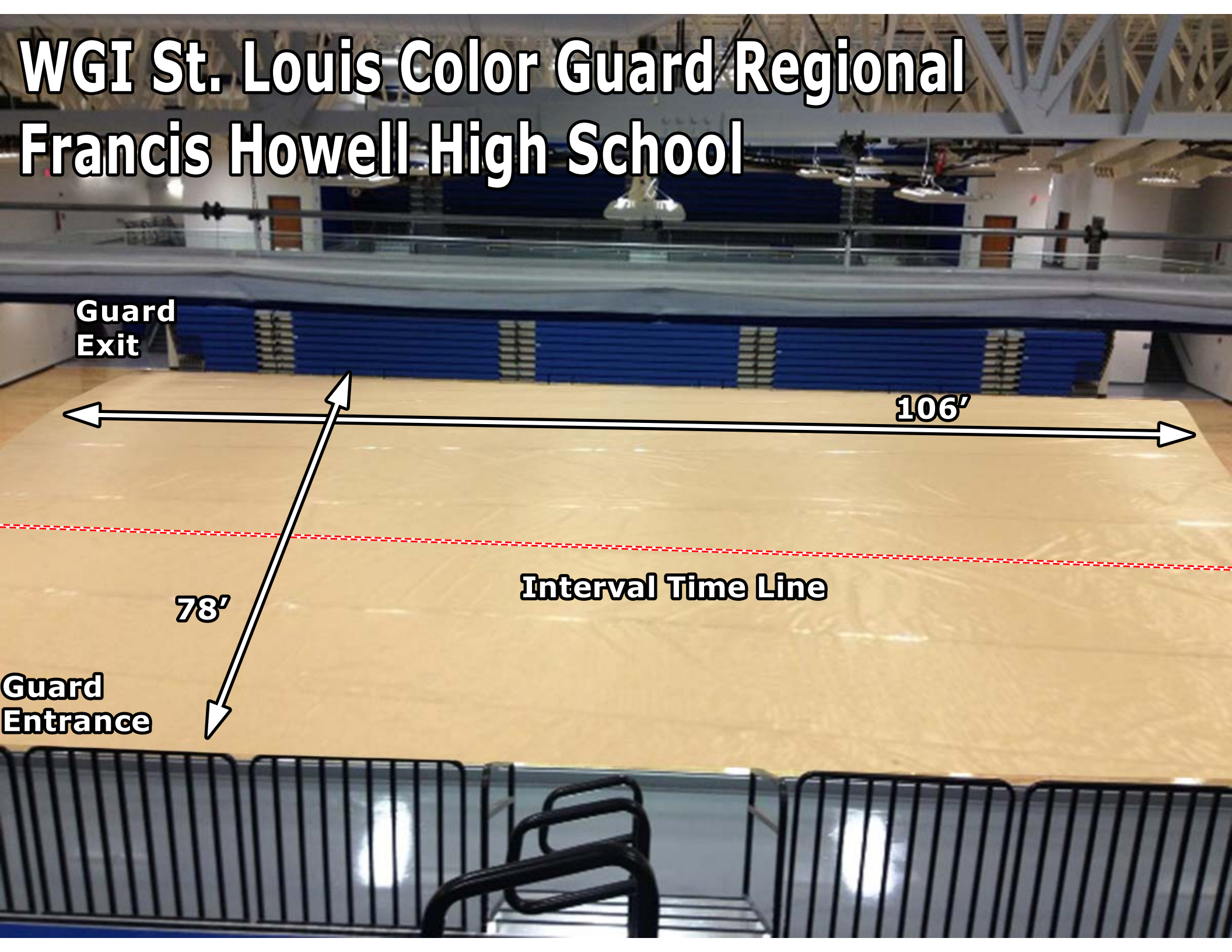



WGI St. Louis Color Guard Regional Competition Area Francis Howell High School, St. Charles, MO

All WGI contest sites must have a minimum of seventy by one hundred feet (70' x 100') to accommodate a "safety zone" of five (5) feet from any spectator seating. If no spectators are seated on the left and right sides, then the safety zone will be eliminated on the left and right sides of the competition area and can extend to the maximum of 106'X 78'.

The "competition area" at this event measures 106' X 78'. All performing groups must be prepared to perform within that area. Floors (tarps) may not extend into the safety zones per rules found in the WGI Adjudication Manual and Rulebook

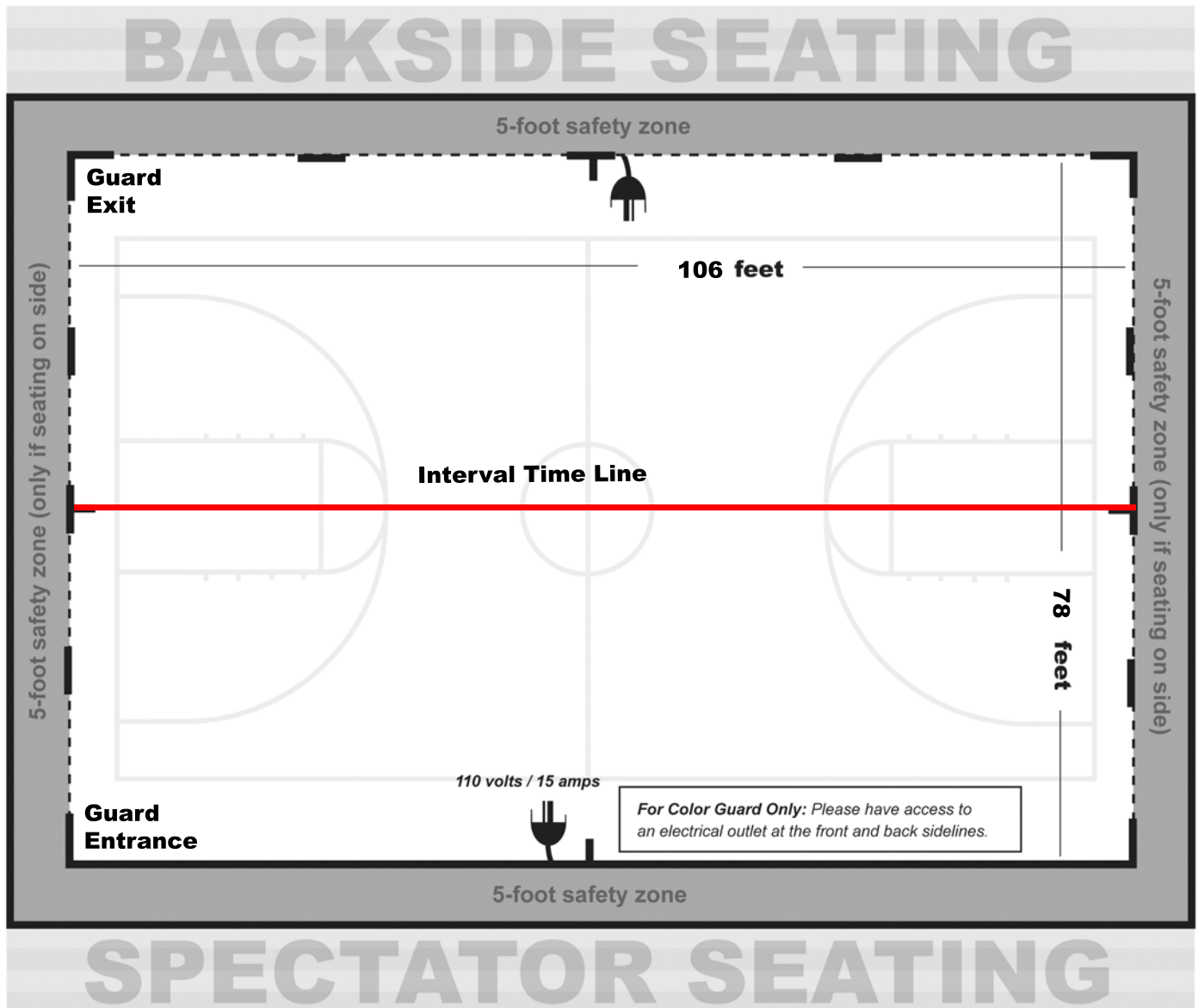

From the 2018 WGI Policy Manual

4.120 Sound Policy (Color Guard)

- All color guards should do a sound check at the designated times provided in the contest information packet to ensure the playability of any device or CD. Color guards should check the soundtrack at multiple places in the music to verify playability of any device.
- Color guards should still do a sound check if they are using the WGI Music Upload in CompetitionSuite to ensure everything is correct.
- Color guard is responsible for providing the method that the music will be played, e.g. CD, MP3, computer, etc. Each color guard should have two methods to play their soundtrack in the event that one does not work.
- Color guard must provide their music in a timely manner to the designated sound operator. Any delay in providing music is the responsibility of the color guard.
- Color guards using the upload process through Competition Suite should have a back up using another device type such as an MP3 player, iPhone, or CD
- Color guard must have a designated person at the sound table to operate any device provided to play music such as MP3 players or computers. Guard's representative is responsible to set up and play device. If a CD is provided, the color guard representative must instruct the sound operator as to what track or other relevant information is needed to start the music when directed by the contest Timing and Penalty judge or after the color guard's introduction.
- If the color guard has an issue with the music such as music is too soft, it begins in the wrong place or skips, the color guard's representative must make the decision to stop the music and tell the operator to stop the music. If the color guard representative chooses not to stop and the color guard completes their show, the color guard shall not be offered an opportunity to perform again.
- Interval timing will continue as the color guard resets and begins again. The Contest Administrator has the sole discretion in waiving any timing penalty due to the restart. If the stoppage is due to faulty sound equipment, operator error or an unexplained reason, overtime penalty may be waived.
- Issues related to the equipment provided by the color guard, quality of the CD or the color guard's representative error (using wrong playlist on MP3, etc.) will result in the actual interval timing being used and penalties, if any, being assessed.
- Volume direction must come from the color guard representative at the sound table. Direction will not be taken from the audience viewing area or across the floor. Final volume discretion is given to the sound operator based on their equipment and the Chief Judge who ultimately determines an appropriate volume level.
- The color guard representative may provide direction to the sound operator during the performance regarding equalization.
- It is the responsibility of the color guard to provide their music for each performance and to ensure that their soundtrack is working appropriately. CDs may not be left at sound table between performances.
- Under no circumstances will verbal abuse of the sound operator be tolerated. Penalties will be assessed per current WGI rules