



Nashville Color Guard Regional

Site:

Wilson Central High School
419 Wildcat Way
Lebanon, TN 37090

Dimensions: 106' x 65'

Front Side Bleacher Rows: 20

Seating Capacity: appx 1400

Approximate Ceiling Height: appx 27 ft

There are no stairs to contend with in the competition area. There are stairs between equipment warm up and the ready line.

There are no permanent obstructions above the competition floor.

Color guards do not enter the competition area directly from the outdoors.

There is electrical power available at the front and back sideline.

Color guards do not exit the competition area directly to the outdoors.

The hallways near the performance gym will be utilized for prop storage prior to the competition.

There will be a black vinyl tarp measuring appx 75'x105' covering the wooden gym floor.

There is no indoor space to refold floors after the performance. In case of inclement weather, there will be an alternative.

There are separate areas for body and equipment.

It is appx 2 minutes between body and equipment.

It is appx 1 minute between equipment and the ready line.

Body Warm Up

Cafeteria

Dimensions: 70' x 55'

No obstructions in the area.

Music may be used in body warm up at moderate levels to be determined per the contest director.

Equipment Warm Up

Auxiliary Gym

Dimensions: 90ft. X 60ft.

Approximate Ceiling Height: appx 27 ft

No obstructions in the area.

Music may be used in equipment warm up at moderate levels to be determined per the contest director.

The above information is being provided to you in order give you the most complete information we currently have on this contest. All information is subject to change either before or during the event by contest personnel based on need.

Floor/Prop Entry



85"

66"

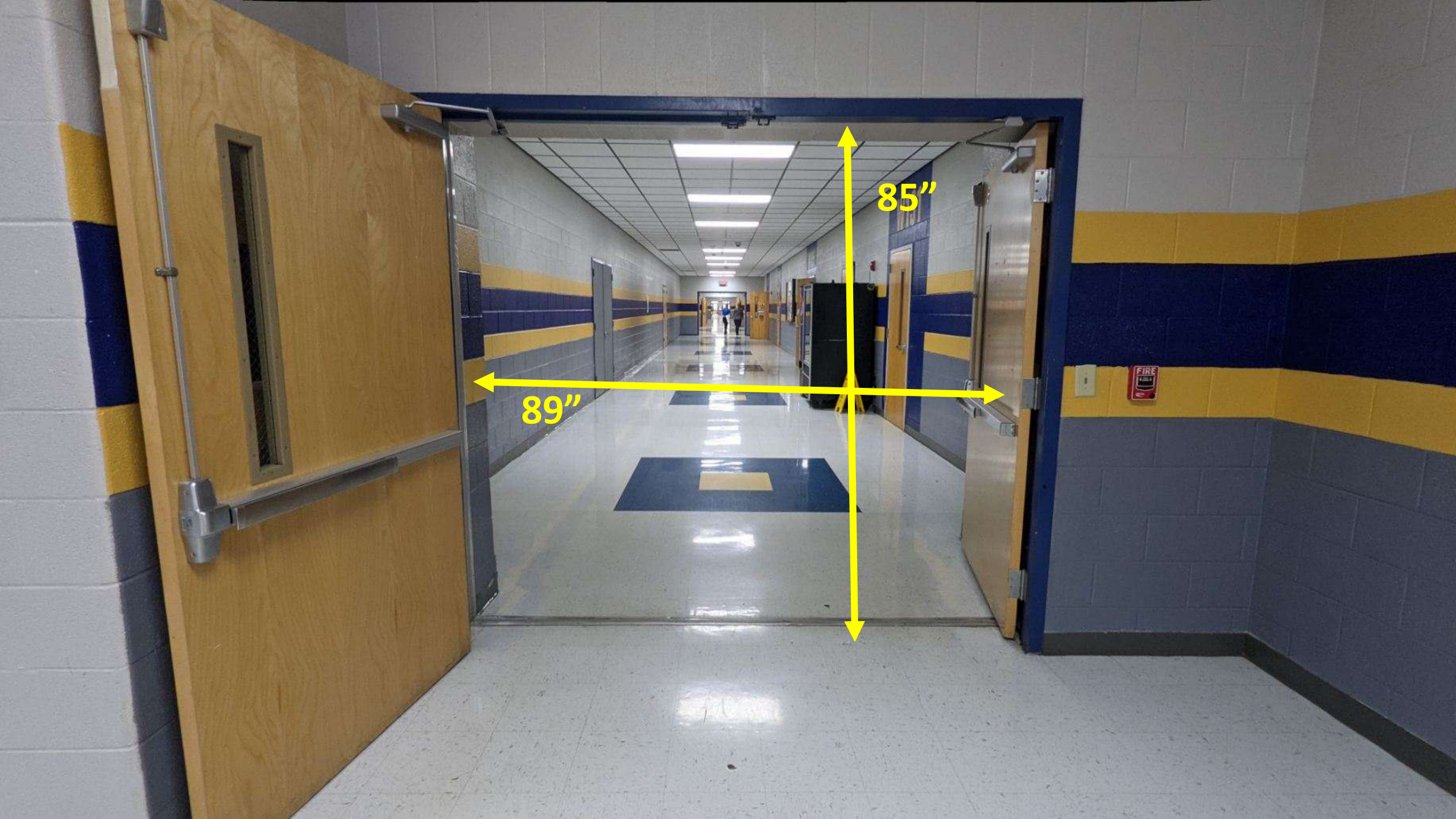

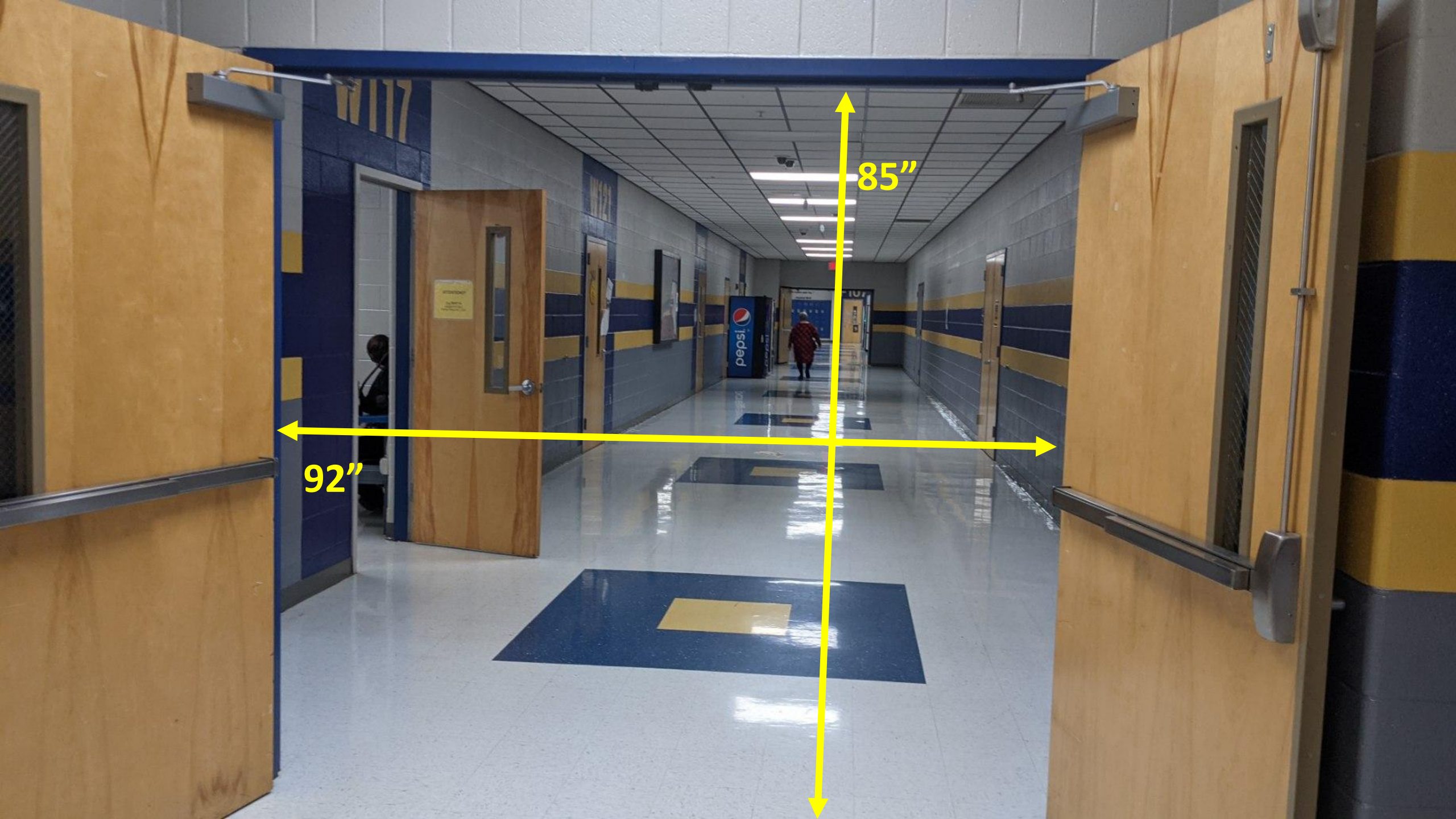

92"

85"

Performance Entry

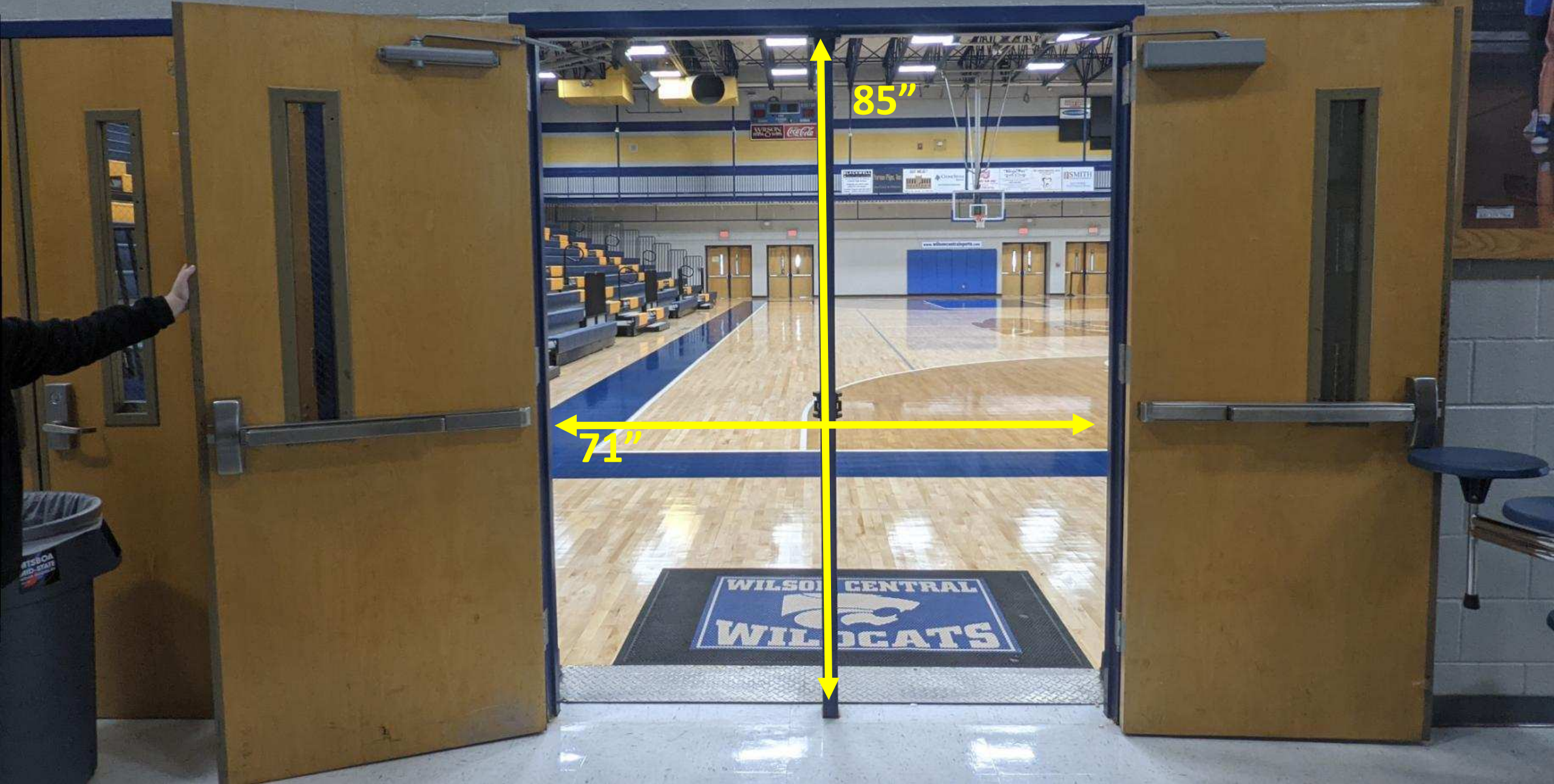

85"

71"

MINASTIUM

Performance Exit

