

IMPORTANT HEALTH & SAFETY UPDATES

MASKS RECOMMENDED

WGI PHOENIX COLOR GUARD REGIONAL

EVERYONE IN ATTENDANCE AT THIS REGIONAL IS RECOMMENDED TO WEAR A MASK.

Performers may remove their mask while in warm up or while on the performance floor but are recommended to wear their mask at all other times in the building. Everyone else with the group is recommended to wear a mask at all times.

THERE COULD BE DIFFERENT PROTOCOLS AT EACH WGI EVENT, PLEASE READ THROUGH ALL INFORMATION CAREFULLY.

PHOENIX COLOR GUARD

REGIONAL CONTEST INFORMATION

SATURDAY, MARCH 12, 2022



LOCATION

Canyon View High School
6024 N. Perryville Road
Waddell, AZ 85355

EMERGENCY CONTACTS (DAY OF SHOW ONLY)

CONTEST ADMINISTRATOR: Kendra Whelchel / 303-946-3349 / Kendra@wgi.org
EVENT PARTNER: Mellanie Risch / 480-254-8740 / mellanie.risch@wgaz.org

JUDGE PANEL

EQ Brian Kenny
MV JC Clarke-Bentley
DA Swaga Deb
GE Shirl Chumley & James Goodrich
T&P Will Torres
LJ Shirley Dorritie

COMPETITIONSUITE DETAILS

ACCESSING YOUR GROUP - <https://help.competitionsuite.com/article/16-accessing-your-group>

ADDING YOUR STAFF - <https://help.competitionsuite.com/article/61-adding-staff-members>

ACCESSING COMMENTARY - <https://help.competitionsuite.com/article/17-accessing-commentary>

MUSIC UPLOADS - <https://help.competitionsuite.com/article/74-uploading-performance-music>

Score Summary Sheets are also located in your CompetitionSuite account with your overall score.

ADDITIONAL REGIONAL INFO

PRELIMS LOGISTICAL SCHEDULE - <https://tinyurl.com/wvr7dcjc>

FINALS LOGISTICAL SCHEDULE - <https://tinyurl.com/47k2hebn>

WARM UP AREAS – Music is permitted in the warm up areas. If you wish to use music you must provide your own sound system.

RETREAT – Each group may designate one individual to represent the group on the floor during retreat. If your group is not attending retreat, please designate one individual (parent, staffer, or designated representative) to stay and retrieve your award at the conclusion of retreat. Please inform the Contest Administrator on site if your group will not be attending retreat.

REGIONAL REMINDERS – <https://wgi.org/wp-content/uploads/2022/01/2022CGRegionalReminders.pdf>

WGI Phoenix Color Guard Regional Canyon View HS



Trailer Parking

Performance Gym
Canyon View Arena
Spectator Entrance

Prop Storage
Equipment Warm Up

Body Warm Up

6024 N Perryville Rd

Guard Check In
Canyon View High School

Bus Parking

Bus Entrance

Spectator Parking

Accelerator

W Bethany Home Rd

W Bethany Home Rd

W Bethany Home Rd

Canyon View Tennis Courts

CANYON VIEW
JAGUARS



Canyon View High School
 6024 N Perryville Rd.
 Waddell, AZ 85355

Additional warm up (unofficial)

Trailer Parking
 Access from Perryville Rd

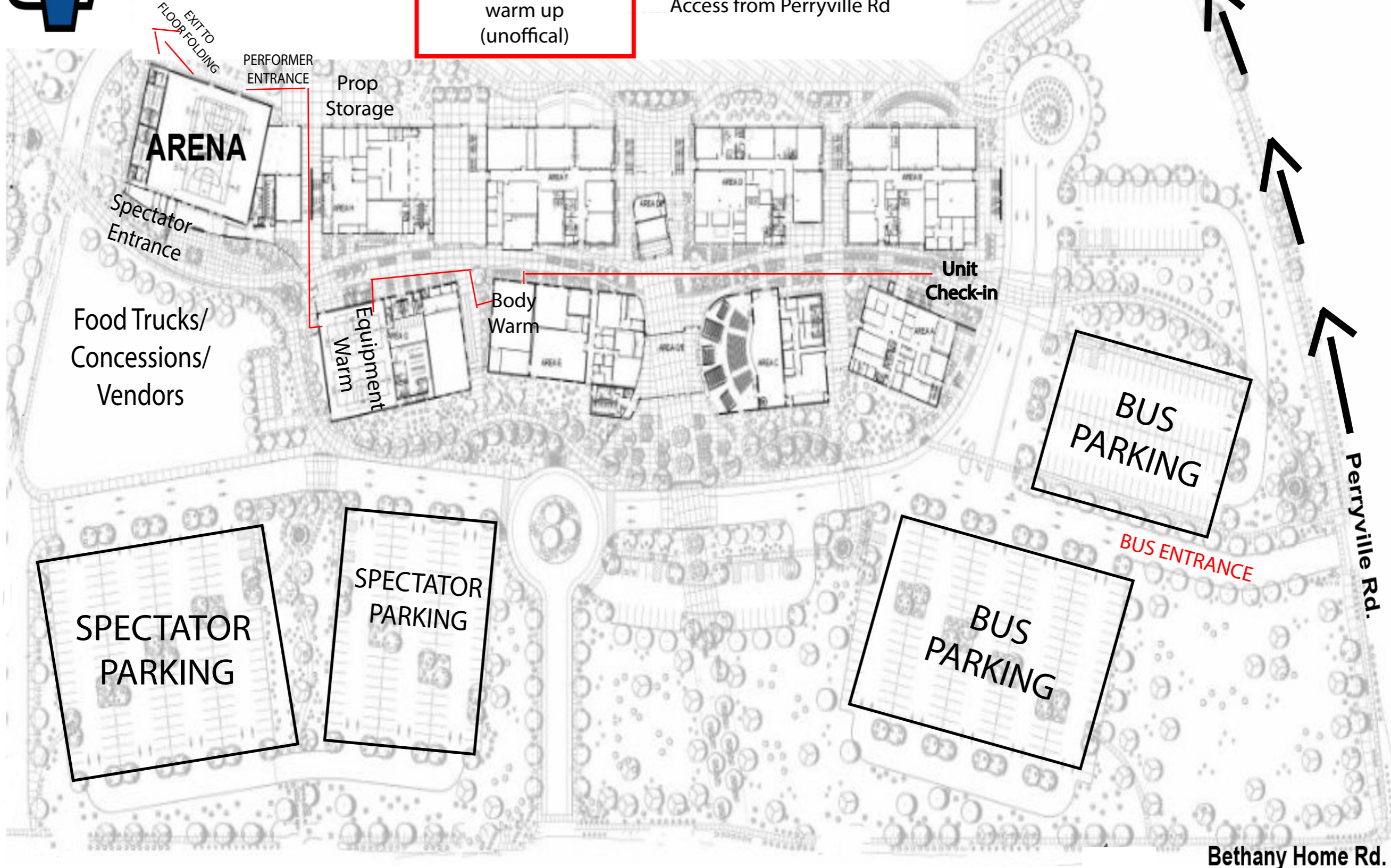

Bethany Home Rd.



Phoenix Regional Competition Area Canyon View HS, Waddell, AZ

All WGI contest sites must have a minimum of seventy by one hundred feet (70' x 100') to accommodate a "safety zone" of five (5) feet from any spectator seating. If no spectators are seated on the left and right sides, then the safety zone will be eliminated on the left and right sides of the competition area and can extend to a maximum of 106'X 78'.

The "competition area" at this event measures 106'X 65'. All performing groups must be prepared to perform within that area. Floors (tarps) may not extend into the safety zones per rules found in the WGI Adjudication Manual and Rulebook.

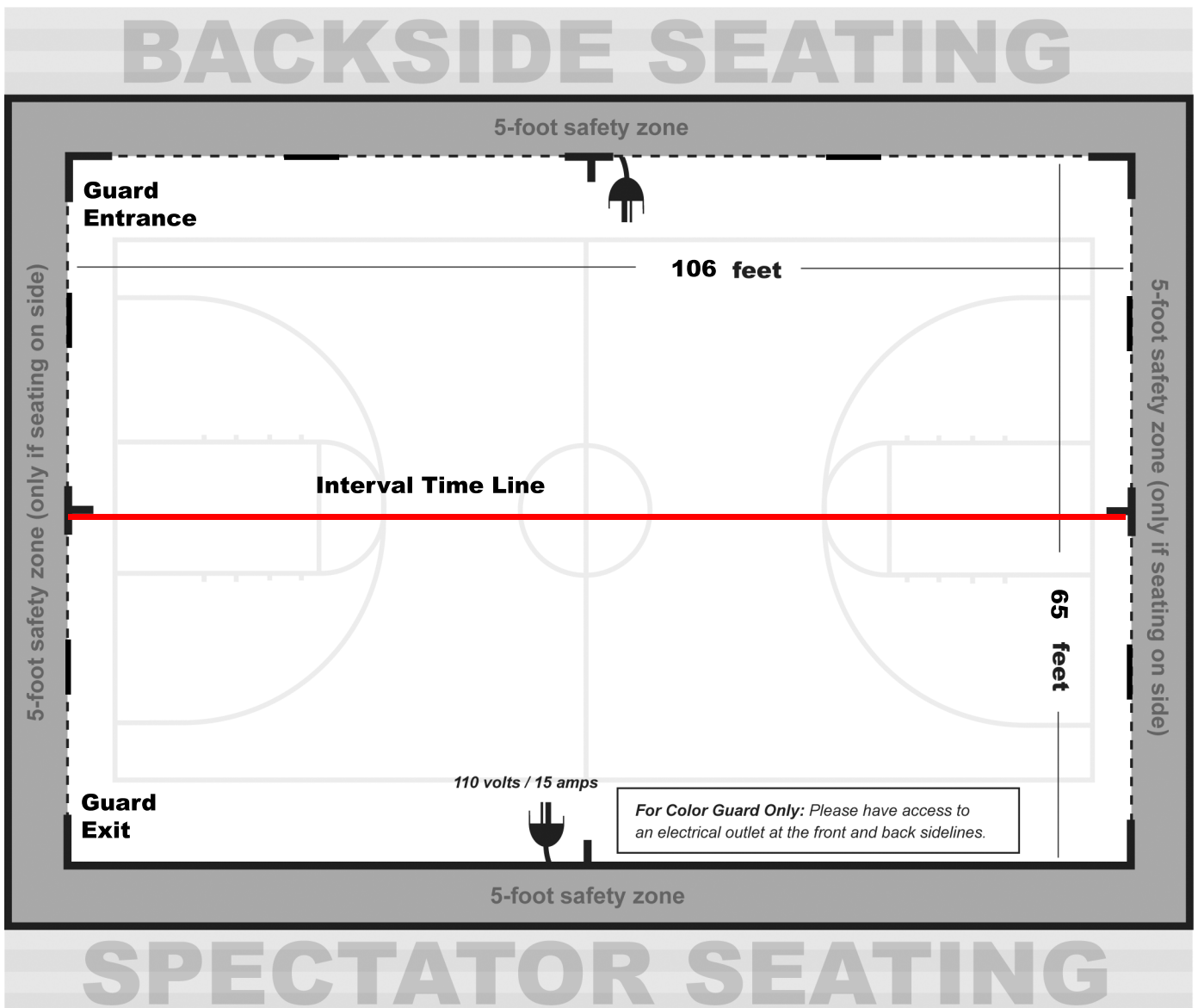

From the WGI Policy Manual

4.120 Sound Policy (Color Guard)

- All color guards should do a sound check at the designated times provided in the contest information packet to ensure the playability of any device or CD. Color guards should check the soundtrack at multiple places in the music to verify playability of any device
- Color guards should still do a sound check if they are using the WGI Music Upload in CompetitionSuite to ensure everything is correct.
- Color guard is responsible for providing the method that the music will be played, e.g. CD, MP3, computer, etc. Each color guard should have two methods to play their soundtrack in the event one does not work.
- Color guard must provide their music in a timely manner to the designated sound operator. Any delay in providing music is the responsibility of the color guard.
- Color guards using the Music Upload process through CompetitionSuite should have a backup using another device type such as an MP3 player, iPhone, or CD.
- Color guard must have a designated person at the sound table to operate any device provided to play music such as MP3 players or computers. Guard's representative is responsible to set up and play device. If a CD is provided, the color guard representative must instruct the sound operator as to what track or other relevant information is needed to start the music when directed by the contest Timing and Penalty judge or after the color guard's introduction.
- If the color guard has an issue with the music such as music is too soft, it begins in the wrong place or skips, the color guard's representative must make the decision to stop the music and tell the operator to stop the music. If the color guard representative chooses not to stop and the color guard completes their performance, the color guard will not be offered an opportunity to perform again.
- Interval timing will continue as the color guard resets and begins again. The Contest Administrator has the sole discretion in waiving any timing penalty due to the restart. If the stoppage is due to faulty sound equipment, operator error or an unexplained reason, overtime penalty may be waived.
- Issues related to the equipment provided by the color guard, quality of the CD or the color guard's representative error (using wrong playlist on MP3, etc.) will result in the actual interval timing being used and penalties, if any, being assessed.
- Volume direction must come from the color guard representative at the sound table. Direction will not be taken from the audience viewing area or across the floor. Final volume discretion is given to the sound operator based on their equipment and the Chief Judge who ultimately determines an appropriate volume level.
- The color guard representative may provide direction to the sound operator during the performance regarding equalization.
- It is the responsibility of the color guard to provide their music for each performance and to ensure that their soundtrack is working appropriately. CDs may not be left at sound table between performances.
- Under no circumstances will verbal abuse of the sound operator be tolerated. Penalties will be assessed per current WGI rules