



WGI Indianapolis Color Guard Regional Regional A Class Prelims Scholastic A Class Prelims/Semis

Site:

Warren Central High School
9500 East 16th Street
Indianapolis, IN 46229

Dimensions: 100' X 75'

Front Side Bleacher Rows: 28

Seating Capacity: 1850

Approximate Ceiling Height: 32 ft

There are no stairs to contend with in the competition area.

There are raised basketball goals appx 21 feet above the competition floor.

Color guards do not enter the competition area directly from the outdoors.

There is electrical power available at the front and back sidelines.

Color guards do not exit the competition area directly to the outdoors.

There is hallway space to be utilized for prop storage prior to the competition.

There is an indoor area to fold floors after the performance.

The performance floor is a wooden gym floor with carpeting laid over the floor to protect it.
The tarp is a tan strip style tarp, measuring appx 100' X 75'.

The distance from the warm up area to the competition area is 290 ft.

There are not separate areas for body and equipment. Large field house will be used for warm ups.

Warm Up Areas

Dimensions: 96ft. X 124ft.

Large field house that will be split into two areas

No obstructions in the area.

Music may not be used as it may disturb the other group in the warm up area.

The above information is being provided to you in order give you the most complete information we currently have on this contest. All information is subject to change either before or during the event by contest personnel based on need.

WARREN CENTRAL HIGH SCHOOL

WGI INDIANAPOLIS COLOR GUARD REGIONAL

DOOR PHOTOS & MEASUREMENTS

BUILDING ENTRY & EXIT

(center posts will be removed; measurements for both outer and inner doors)



PROP HALLWAY #1

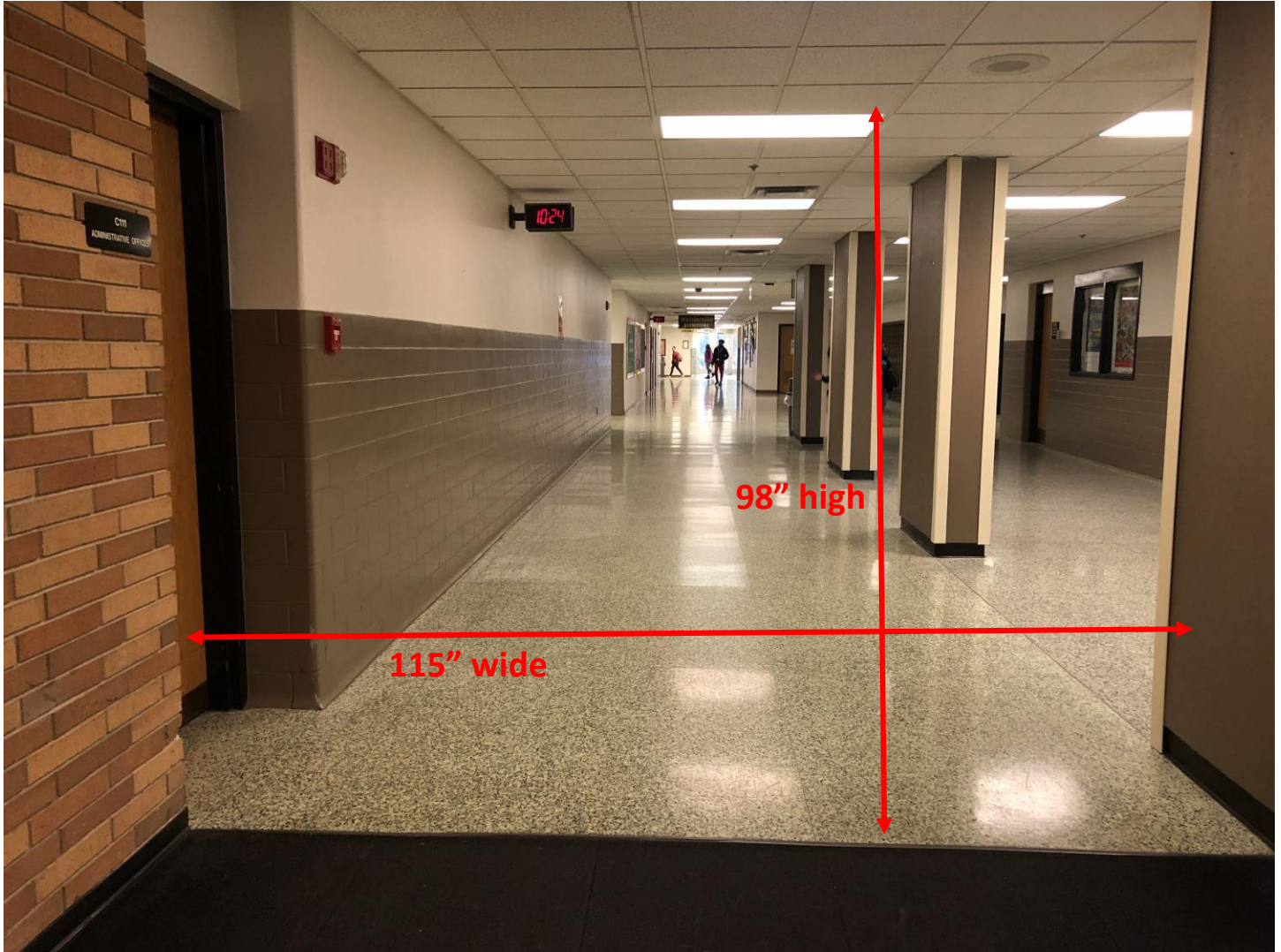

PROP HALLWAY #2



COMPETITION GYM ENTRY

(center posts & door arms will be removed; measurements for both outer and inner doors)

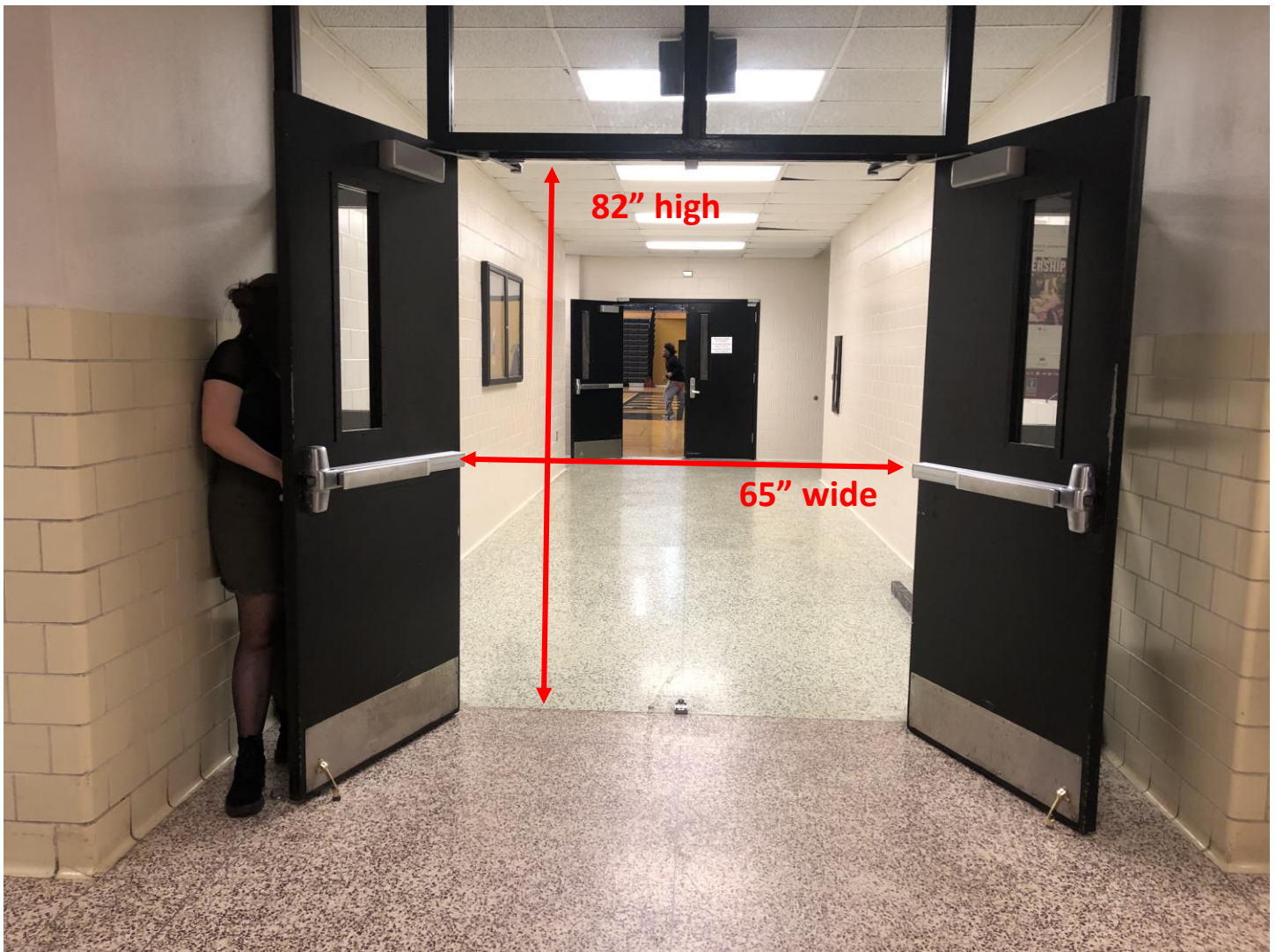

COMPETITION GYM EXIT

(measurements for both outer and inner doors)

