

UPDATED 3/16

DENVER COLOR GUARD REGIONAL CONTEST INFORMATION

SATURDAY, MARCH 18, 2023



LOCATION

University of Denver
Magness Arena
2240 Buchtel Boulevard
Denver, CO 80208

EMERGENCY CONTACTS (*DAY OF SHOW ONLY*)

CONTEST ADMINISTRATOR: Brian Fisher / 727-460-6431 / BrianF@wgi.org
EVENT PARTNER: Kendra Whelchel / 303-946-3349 / rmcga.contestdirector@gmail.com

JUDGE PANEL

EQ Alice Hays
MV Jaycee Clarke-Bentley
DA Izzy Delgado
GE Michael Higbe & Ted Wemhoff (LJ)
T&P John Whelchel

COMPETITIONSUITE DETAILS

ACCESSING YOUR GROUP - <https://help.competitionsuite.com/article/16-accessing-your-group>

ADDING YOUR STAFF - <https://help.competitionsuite.com/article/61-adding-staff-members>

ACCESSING COMMENTARY - <https://help.competitionsuite.com/article/17-accessing-commentary>

MUSIC UPLOADS - <https://help.competitionsuite.com/article/74-uploading-performance-music>

Score Summary Sheets are also located in your CompetitionSuite account with your overall score.

ADDITIONAL REGIONAL INFO

The draft schedules are no longer available. Final schedules are available on the [Denver Event Page](#).

WARM UP AREAS – Music is not permitted in the warm up area as it is shared space.

CRITIQUE – Critique schedule is available in this packet. If your group signs up for critique and then does not attend, you may lose the privilege to attend critique again at a future WGI event.

RETREAT – Captains only. If your group is not attending retreat, please designate one individual (parent, staffer, or designated representative) to stay and retrieve your award at the conclusion of retreat. Please inform the Contest Administrator on site if your group will not be attending retreat.

REGIONAL REMINDERS – <https://wgi.org/wp-content/uploads/2022/12/2023CGRegionalReminders.pdf>

MAGNESS ARENA DOES NOT PERMIT ANY OUTSIDE FOOD OR BEVERAGE TO BE BROUGHT INTO THE FACILITY.



WGI Denver Regional Critique Schedule

Color Guard	Hometown	Class	Critique Time
Bear Creek HS	Lakewood, CO	Scholastic A	4:00 PM
Fossil Ridge HS	Fort Collins, CO	Scholastic A	4:00 PM
Papillion-La Vista South HS	Papillion, NE	Scholastic A	4:00 PM
Palisade HS	Palisade, CO	Scholastic A	4:00 PM
Montrose HS	Montrose, CO	Scholastic A	4:12 PM
Cherry Creek HS	Greenwood Village, CO	Scholastic A	4:12 PM
Ralston Valley HS	Arvada, CO	Scholastic A	4:12 PM
Mesa Ridge HS	Colorado Springs, CO	Scholastic A	4:12 PM
Dakota Ridge HS	Littleton, CO	Scholastic A	4:24 PM
Viridian Winter Guard	Fort Collins, CO	Independent A	4:24 PM
Renaissance Winterguard	Colorado Springs, CO	Independent A	4:24 PM
Sonder	Arvada, CO	Independent A	4:24 PM
Anesidora A	Arvada, CO	Independent A	4:36 PM
Douglas County HS	Castle Rock, CO	Scholastic Open	4:36 PM
Air Academy HS	United States Air Force Academy, CO	Scholastic Open	4:36 PM
Anesidora	Arvada, CO	Independent Open	4:36 PM
Malachi	Denver, CO	Independent World	4:48 PM

Critique Concludes

5:00 PM

Please notify the Contest Administrator if you are unable to attend critique in a timely manner. Failure to do so may result in your color guard forfeiting critique opportunities for the remainder of the season.

Critique is only available for the National Classes (A, Open, World). To be eligible for critique, groups had to sign up on CompetitionSuite ahead of the event.

**Unit flow
Lower Level**

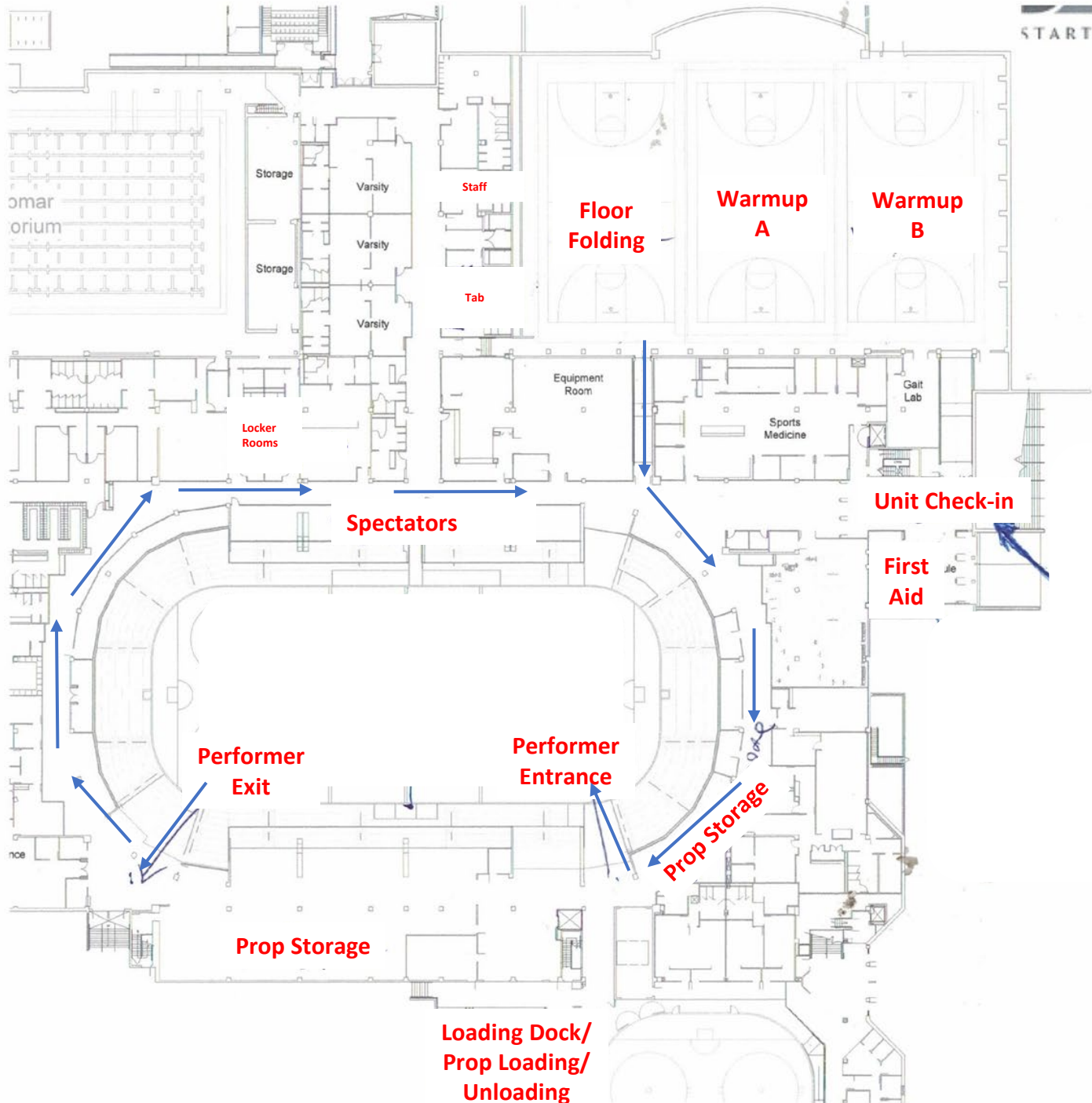

Spectator Level

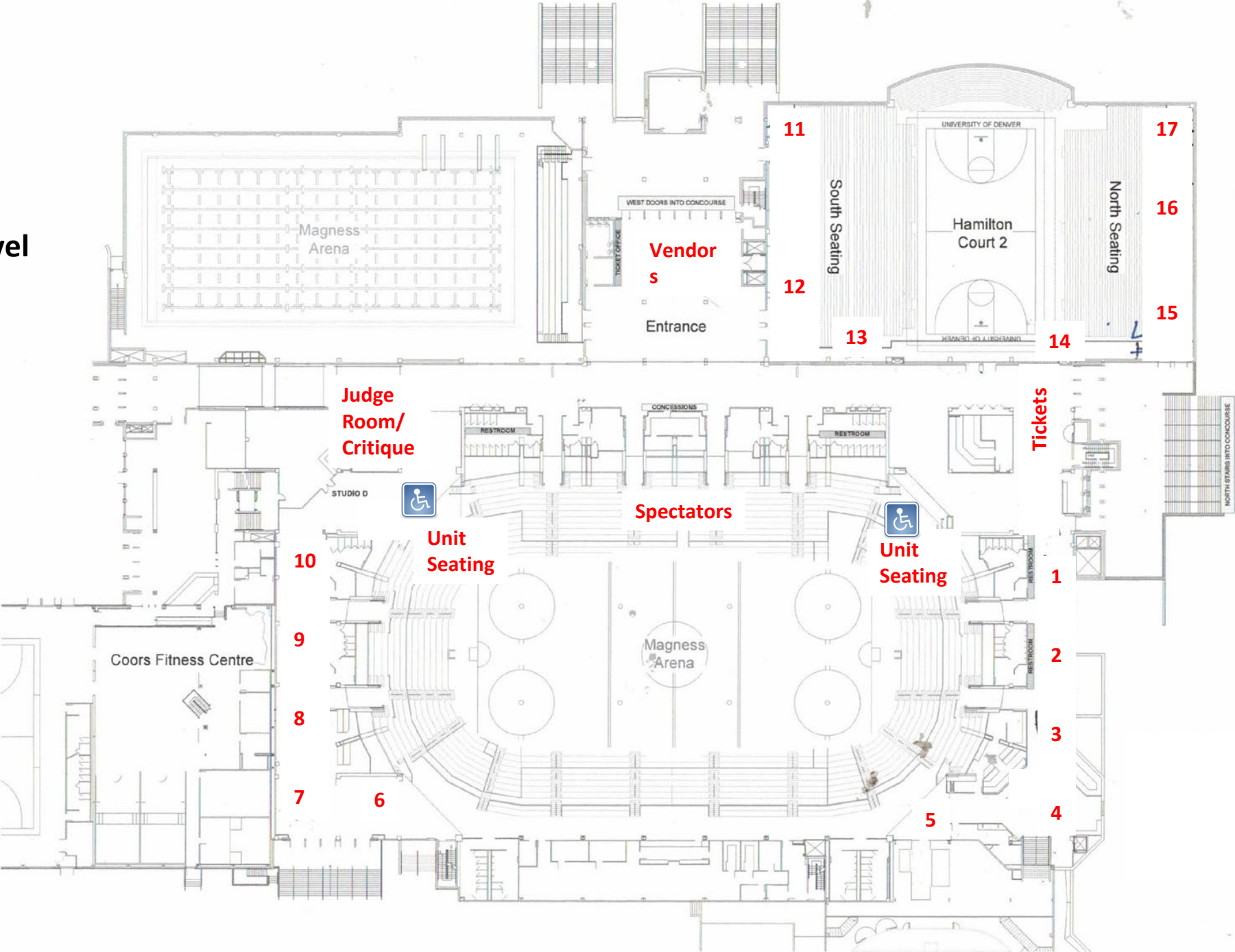

**GUARD
ENTRANCE**

**GUARD
EXIT**

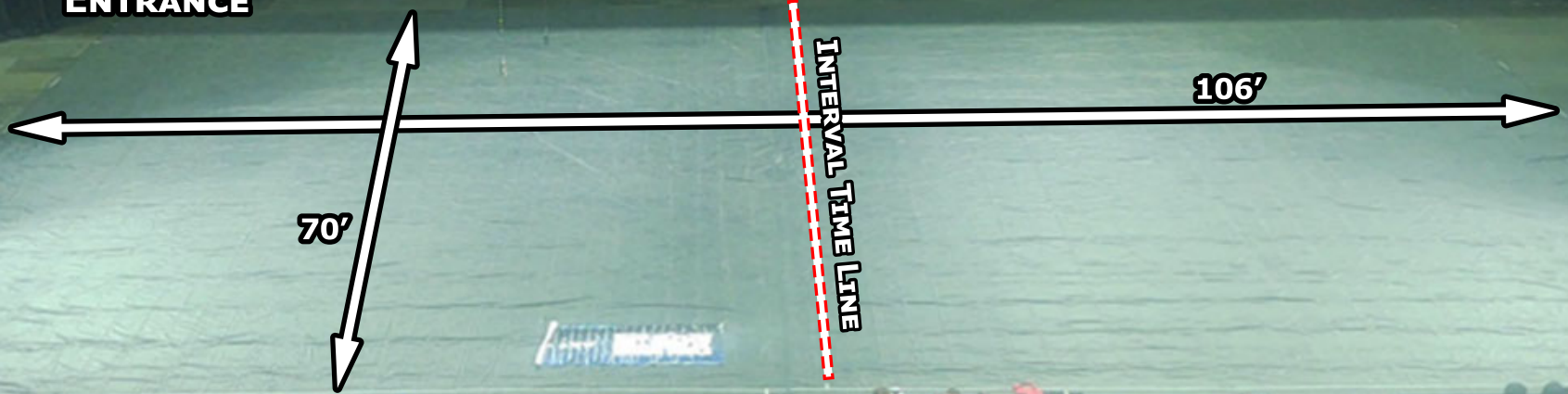

**WGI DENVER COLOR GUARD REGIONAL
MAGNESS ARENA**



Denver Color Guard Regional Competition Area University of Denver, Magness Arena, Denver, CO

All WGI contest sites must have a minimum of seventy by one hundred feet (70' x 100') to accommodate a "safety zone" of five (5) feet from any spectator seating. If no spectators are seated on the left and right sides, then the safety zone will be eliminated on the left and right sides of the competition area and can extend to a maximum of 106'X 78'.

The "competition area" at this event measures 100' X 70'. All performing groups must be prepared to perform within that area. Floors (tarps) may not extend into the safety zones per rules found in the WGI Adjudication Manual and Rulebook.

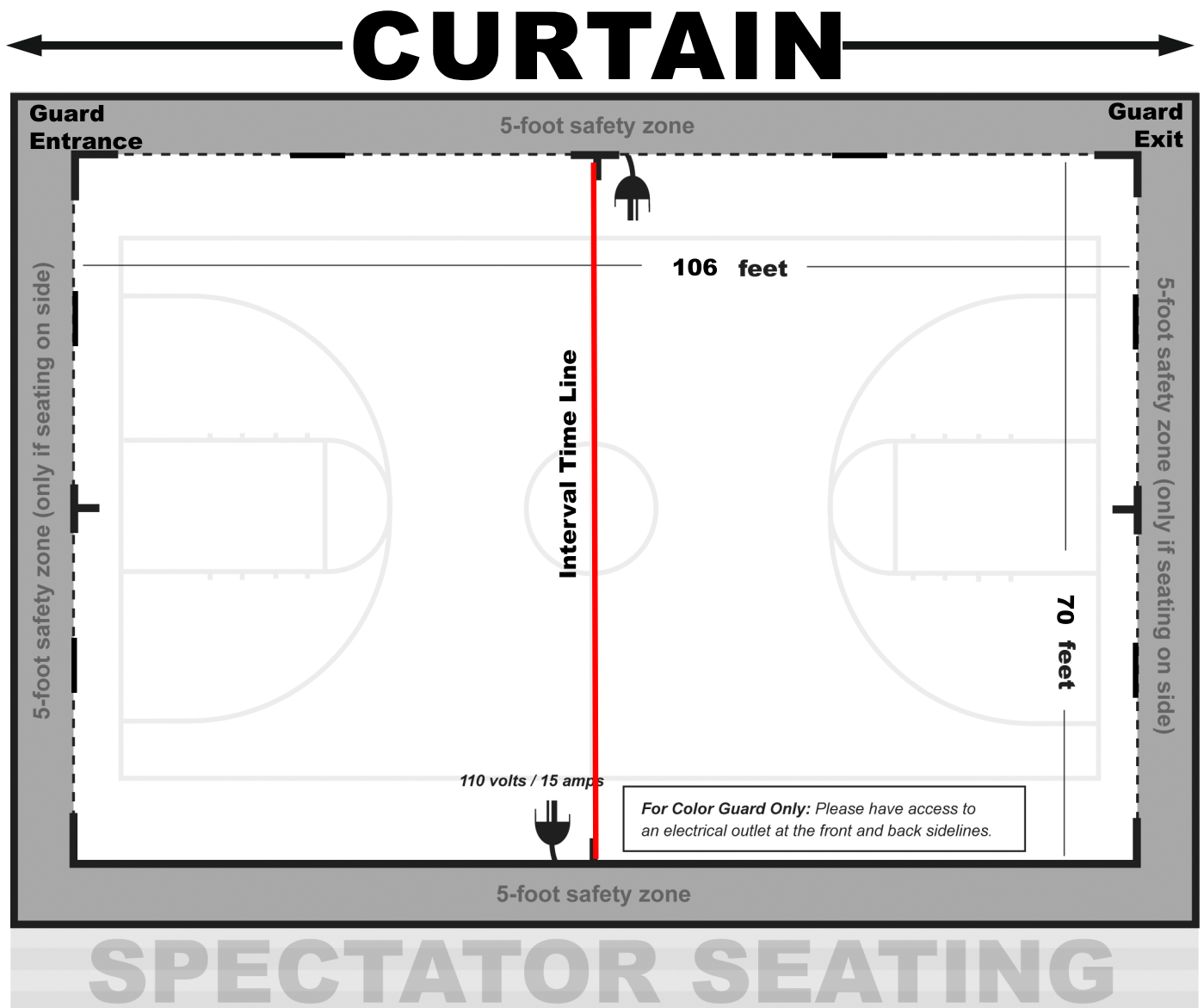

7.3.4 Sound Policy (Color Guard)

- Color Guards must have a designated person at the sound table to provide the method for the soundtrack to be played via smartphone, MP3 player, laptop computer, or music uploaded in CompetitionSuite. The designated person is responsible for setting up and playing the device, and it is strongly recommended to have a backup option in the event of a malfunction.
- It is recommended to do a sound check at the designated times provided in the contest information to ensure the playability of any device used by checking the soundtrack at multiple intervals in the music.
- Color Guard must provide their music in a timely manner to the sound operator. Any delay in providing music is the responsibility of the group.
- If there is an issue with the music such as music is too soft, begins in the wrong place or skips, the designated person must make the decision to stop the music and tell the operator to stop the music. If the choice is made to complete the program, the group will not be offered an opportunity to repeat their performance.
- Interval timing will continue as the group resets and begins again. The Contest Administrator has the sole discretion in waiving any timing penalty due to the restart. If the stoppage is due to faulty sound equipment, operator error or other unexplained reason, overtime penalty may be waived.
- Issues related to the equipment provided by the group or error by the designated person (using wrong playlist on MP3, etc.) will result in the actual interval timing being used and penalties, if any, being assessed.
- Volume direction must come from the designated person at the sound table. Direction will not be taken from the audience viewing area or across the floor.
- Final volume discretion is given to the sound operator based on their equipment and the Chief Judge who ultimately determines an appropriate volume level. Sound decibel levels for each performance venue will be measured from the area designated for the General Effect judges.
- The designated representative may provide direction to the sound operator during the performance regarding equalization.
- Under no circumstances will verbal abuse of the sound operator be tolerated. Penalties will be assessed per current WGI rules.



WATCH



LIVE ON

FLOMARCHING



WATCH LIVE ALL SEASON LONG AND RELIVE YOUR FAVORITE MOMENTS WITH SOUND BY CATCHING THE FLOMARCHING REBROADCAST THE FOLLOWING DAY

SUBSCRIBE TODAY AT [FLOMARCHING.COM](https://www.flomarching.com)

android 

ios



Roku

fire tv 

 chromecast

Be There.