

2019 Southeast Power Regional Contest Information

Saturday, March 23—Prelims - 10 AM

Sunday, March 24—Finals - 9 AM

Facility:

CFE Arena
University of Central Florida
50 North Gemini Boulevard
Orlando, FL 32816

Emergency Contacts

Jeanne Strong—720-641-3945

Mark Ackerson—847-624-0680

Ticket Prices/Info

Prelims Only—\$20

Finals Only—\$23

Weekend Combo Pass—\$34

Ticket prices include a \$2 arena
ticketing fee.

CASH or Credit Cards ONLY

Parking for cars/vans in garage—\$5

**All groups in cars/vans will have to pay to
park.**

Each color guard will receive ten (10) staff passes
unless a PLUS pass was purchased. A PLUS pass
allows an additional seven (7) staff for a total of
seventeen (17). PLUS passes are **NOT** available
for purchase at the event.

WGI does not offer any type of director or bus
driver hospitality at regional championship events.
Please be sure to take care of your drivers and
staff.

**Per arena guidelines all backpacks,
purses, etc. may be searched prior to entry.**

Regional Contact Info

Contest Administrator

Jeanne Strong

Jeanne@wgi.org

720-641-3945

General Info

WGI Office

office@wgi.org

937-247-5919 x 305

General Contest Info

TO LISTEN TO JUDGES COMMENTARY: Each direc-
tor should be set up with an account through Competi-
tionSuite. This is the only way to receive judge's com-
mentary for any WGI event. Instructions to do this are
available [here](#).

SOUND CHECK: One hour prior to the start of the
contest and during breaks at the discretion of the Con-
test Administrator. If you choose to use the new music
upload feature available in CompetitionSuite, WGI sug-
gests you still do a sound test. Information regarding
music uploads is available in the Regional Reminders.

WARM-UP AREA: All maps are located in this pack-
et. Color guards need to check in at least one hour prior
to performance time. There is to be no music in warm
up as it is shared warm up space and will disturb the oth-
er guard in the area.

PRELIM SCORES: Posted in vendor area.

GROUP SUMMARY SHEETS & RECAPS: Available on
CompetitionSuite.com

CRITIQUE: Only those groups attending the 2019
World Championships will be afforded the opportunity for
a critique. An email was sent to all primary and second-
ary contacts regarding signing up before schedules were
posted. Critique schedule will be available in this packet
once it has been finalized.

FINALS SCHEDULE: The finals schedule will be
available on WGI.org after it has been determined. All
open and world class color guards must make qualifying
score to progress to finals. Qualifying scores are listed in
the regional reminders below.

PRACTICE SITES: Color guards making practice ar-
rangements through the regional committee must settle
their invoice prior to attending the regional event. Please
contact the WGI office for additional details.

VIDEOS: No video cameras will be allowed in any
contest venue and no authorized space will be provided
for groups to record their performance. Any liability asso-
ciated with unauthorized recordings will rest with the in-
dividual or organization making the recording. WGI does
not condone, nor accept any liability for, any unauthor-
ized recording during the event.

PLEASE NOTE: WGI has adopted and will enforce a
NO SMOKING policy at all WGI Regionals, including
practice facilities.

Don't forget to review the [Regional Reminders](#)!

Judges

Panels are available in this packet.



Winter Guard International

2405 Crosspointe Drive, Dayton, OH 45342 Phone: 937-247-5919 Fax: 937-247-9212 Email: office@wgi.org <http://www.wgi.org>



WGI Southeast Power Regional Judge Panels

Prelims

	Equipment	Movement	Design Analysis	General Effect	
SA/SO Prelims	Denise Bonfiglio	Hieu Nguyen	Brian Murphy	Michael Pavlock	Dale White
IA/IO/World Prelims	Kimberly Presley	Jeffrey Stewart	Jim Sturgeon	Michael Stone	Ted Wemhoff

Finals

	Equipment	Movement	Design Analysis	General Effect	
All Finals	Denise Bonfiglio	Hieu Nguyen	Brian Murphy	Michael Pavlock	Dale White
	Kimberly Presley	Jeffrey Stewart	Jim Sturgeon	Michael Stone	Ted Wemhoff

T&P

Jen Karp

Lead Judge

Shirley Dorritie

WGI Southeast Power Regional Critique Schedule



Group Name	Hometown	Class	Critique Time
Sunlake HS	Land O Lakes, FL	SA	3:15 PM
Pace HS	Pace, FL	SA	3:15 PM
University HS	Orlando, FL	SA	3:15 PM
Somerset Academy	Pembroke Pines, FL	SA	3:15 PM
Cooper City HS	Cooper City, FL	SA	3:27 PM
Harrison HS	Kennesaw, GA	SA	3:27 PM
Sebastian River HS	Sebastian, Florida	SA	3:27 PM
Fletcher HS	Neptune Beach, FL	SA	3:27 PM
Freedom HS (Tampa)	Tampa, FL	SA	3:39 PM

SA Critique Concludes

3:51 PM

Group Name	Hometown	Class	Critique Time
Oviedo HS	Oviedo, FL	SO	6:30 PM
Lowndes HS	Valdosta, GA	SO	6:30 PM
Nease HS	Ponte Vedra, FL	SO	6:30 PM
Timber Creek HS	Orlando, FL	SO	6:30 PM
William R Boone HS	Orlando, FL	SO	6:42 PM
Seminole HS	Seminole, FL	SO	6:42 PM

SO Critique Concludes

6:54 PM

Group Name	Hometown	Class	Critique Time
Five Winterguard	Clearwater, Florida	IA	8:15 PM
Horizon Independent	Auburndale, FL	IA	8:15 PM
Florida State Winter Guard	Tallahassee, FL	IA	8:15 PM
University of South Florida A	Tampa, FL	IA	8:15 PM
Campbell University presents Carolina Visual Productions	Buies Creek, NC	IA	8:27 PM
Jacksonville University Winterguard	Jacksonville, FL	IA	8:27 PM
Tampa Independent	Tampa, FL	IO	8:27 PM
Pegasus Winterguard	Orlando, FL	IO	8:27 PM
FIU Winterguard	Miami, FL	IO	8:39 PM

Park Vista HS	Lake Worth, FL	SW	8:51 PM
West Broward HS	Pembroke Pines, FL	SW	8:51 PM
Flanagan HS	Pembroke Pines, FL	SW	8:51 PM
Lyman HS	Longwood, FL	SW	8:51 PM
Stoneman Douglas HS	Parkland, FL	SW	9:07 PM
University of South Florida	Tampa, FL	IW	9:07 PM
Relentless	Miami, FL	IW	9:07 PM
First Flight	Cary, NORTH CAROLINA	IW	9:07 PM
UCF Pegasus World	Orlando, FL	IW	9:23 PM

IA/IO/SW/IW Critique Concludes

9:39 PM

To be eligible for critique at a Power Regional, your group must be registered for the 2019 World Championships and you must have signed up for critique in advance.

Please notify the Contest Administrator if you are unable to attend in a timely manner. Failure to do so may result in your color guard forfeiting critique opportunities for the remainder of the season.

All "Primary" and "Secondary" contacts have been connected as Administrators to your group in Competition Suite using their **primary email address on file with the WGI office**.

Only Administrators can approve other staff members to have access to the judge recordings under the **Staff Management** area. Staff members who were associated with your group in 2018 can be approved by simply clicking "Approve Staff Member" to the right of their name. If you wish for other instructors to have access to judge commentary for this group, add other members by following the steps below:

Adding Staff Members

1. Log into your Competition Suite account and select the group you want to manage.
2. Click on **Administration**. *If Administration is disabled, you are not an administrator of your group. Please contact the group's administrator or WGI office.*
3. Click on **Staff Management**
4. Enter your staff member's email address and click **Add Staff Member**.
5. If appropriate, change the staff member to an administrator.
6. Repeat step #4 and #5 for all staff members.

Accessing Judge Commentary

1. You must have set up a Competition Suite Account Profile. <http://competitionsuite.com/login/>
2. Make sure your group Administrator has added/or approved you to have access to the judge recordings.

From a Smart phone:

Download the Commentary app:

Apple: <https://itunes.apple.com/us/app/competitionsuite-commentary/id594112091?ls=1&mt=8>

Android: <https://play.google.com/store/apps/details?id=com.competitionsuite.commentary>

From the website:

1. Visit <http://competitionsuite.com/login/> and log in using the password you set up in your Competition Suite profile.
2. Click on "Performances" on the left side of the page under your group's name.
3. Click on the appropriate commentary file you'd like to download or listen to.

Support

If you have questions, feel free to contact support at help@competitionsuite.com.

**Spectator
Parking
\$5**

**Bus/Truck
Path**

**Color Guard
Check In
Loading Dock
Garage Door**

**Performance
Arena**

**Spectator
Entrance**

Gemini Blvd N

**Bus/Truck
Parking**

**Bus/Truck
Parking**

**WGI Southeast Power Regional
CFE Arena, University of Central Florida**

Google

Imagery Date: 3/5/2016 28°36'22.45" N 81°11'49.07" W elev

© 2016 Google

1990

Body Warm Up

Equipment Warm Up

Performance Direction

Floor Exit

Floor Entrance

Pipe/Drape

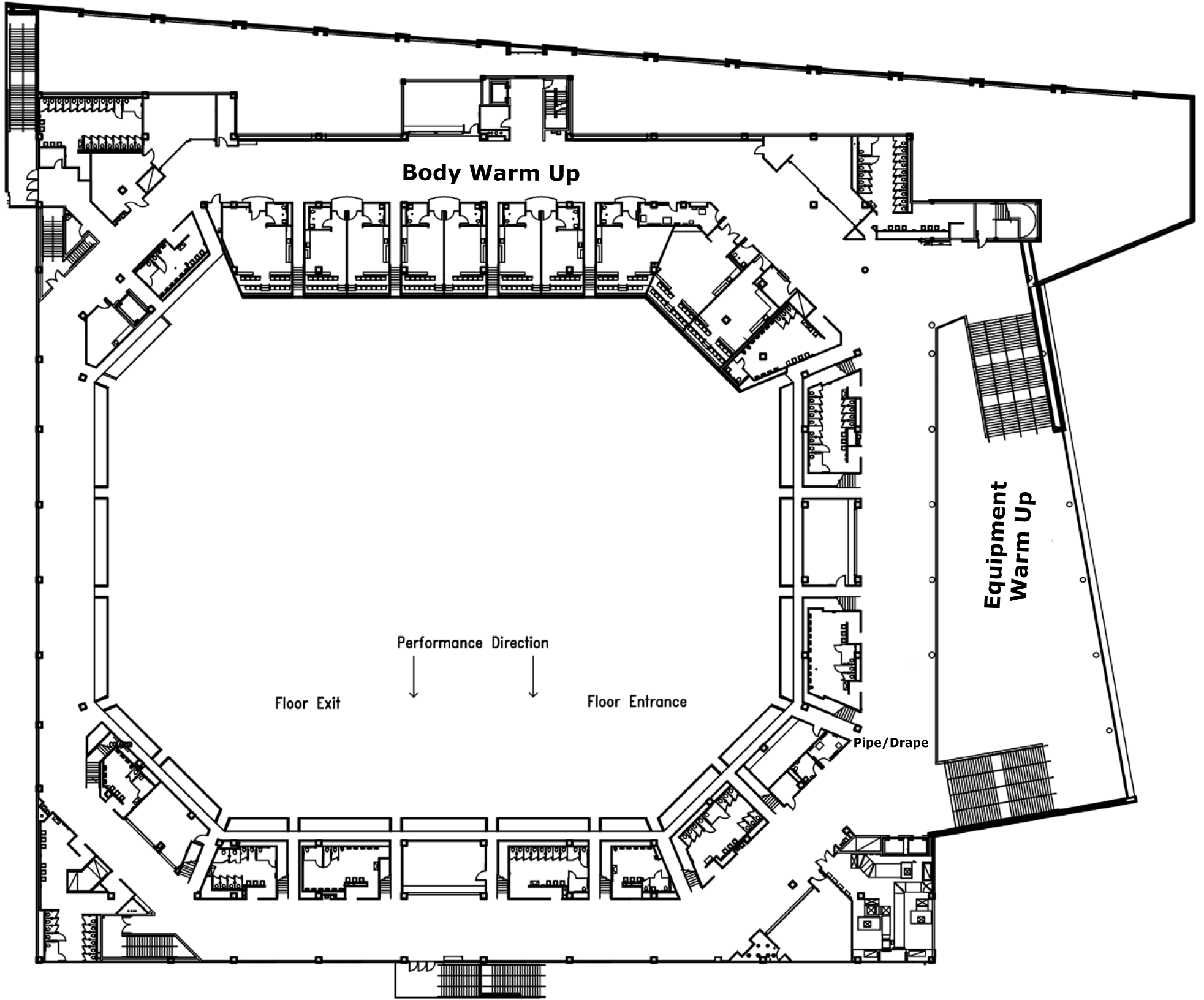

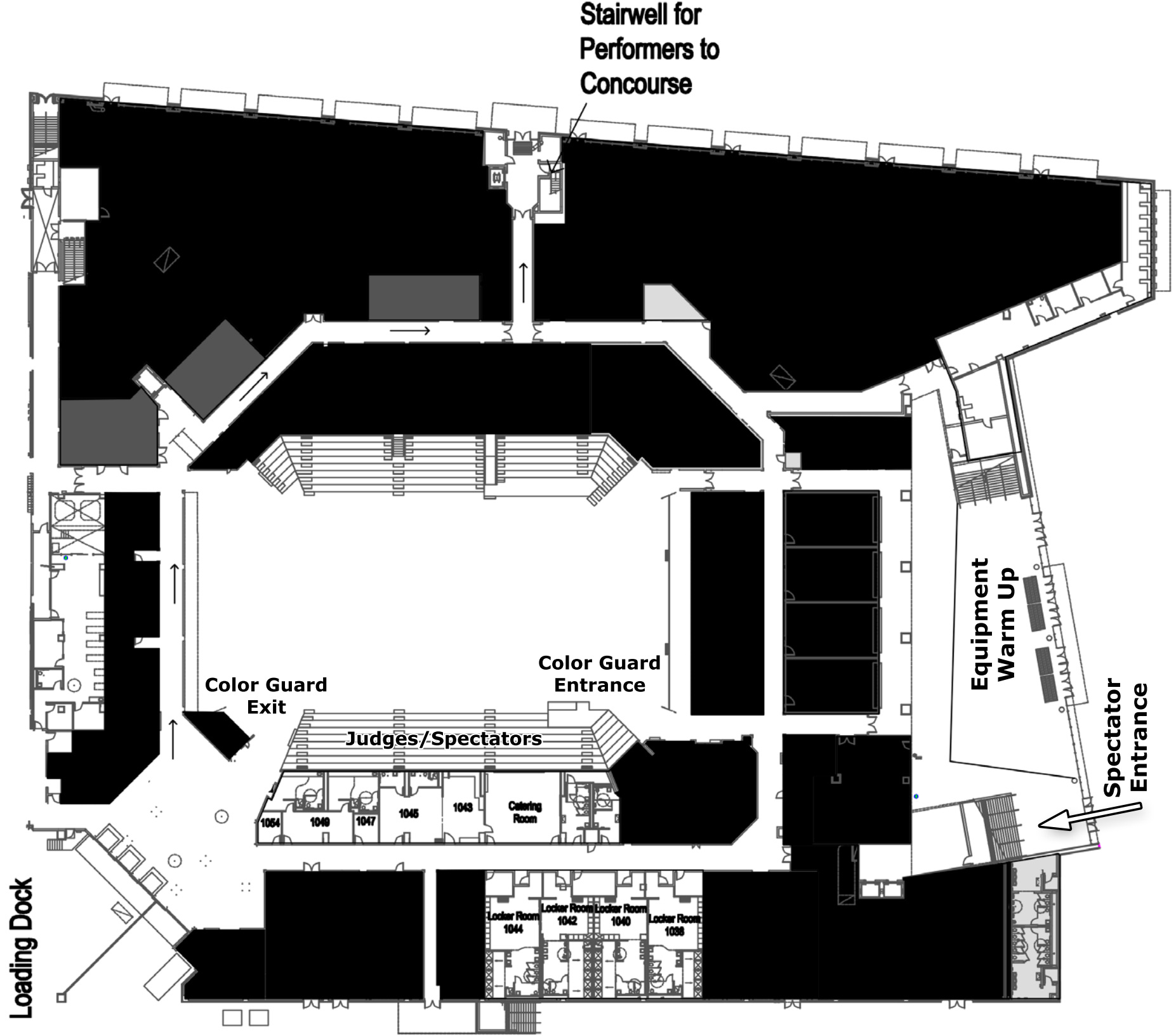

WGI Southeast Power Regional CFE Arena at University of Central Florida Performance Arena





Southeast Power Regional Competition Area CFE Arena, University of Central Florida, Orlando, FL

All WGI contest sites must have a minimum of seventy by one hundred feet (70' x 100') to accommodate a "safety zone" of five (5) feet from any spectator seating. If no spectators are seated on the left and right sides, then the safety zone will be eliminated on the left and right sides of the competition area and can extend to the maximum of 106'X 78'.

The "competition area" at this event measures 106'X 78'. All performing groups must be prepared to perform within that area. Floors (tarps) may not extend into the safety zones per rules found in the WGI Adjudication Manual and Rulebook.

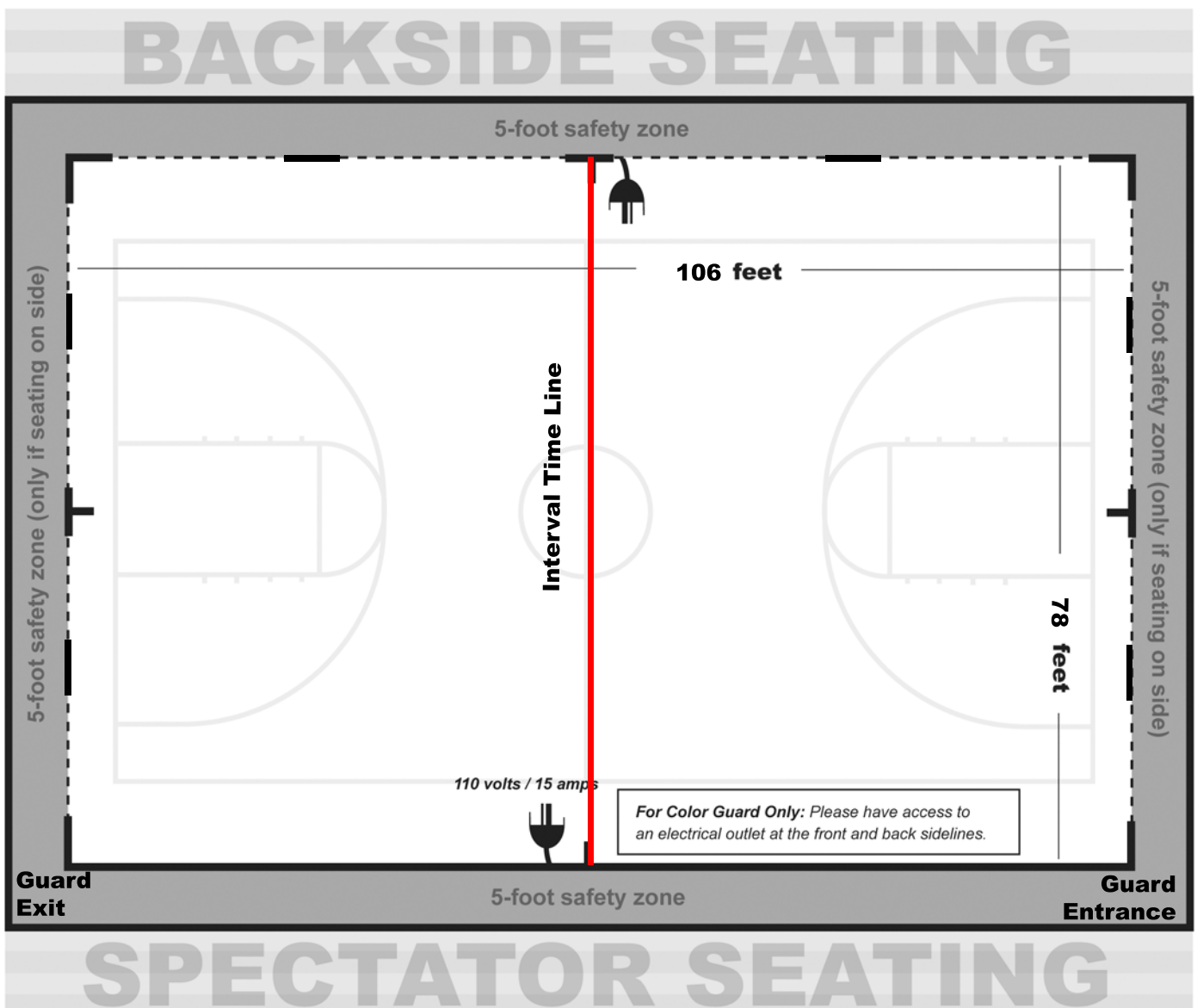

From the 2019 WGI Policy Manual

4.120 Sound Policy (Color Guard)

- All color guards should do a sound check at the designated times provided in the contest information packet to ensure the playability of any device or CD. Color guards should check the soundtrack at multiple places in the music to verify playability of any device
- Color guards should still do a sound check if they are using the WGI Music Upload in CompetitionSuite to ensure everything is correct.
- Color guard is responsible for providing the method that the music will be played, e.g. CD, MP3, computer, etc. Each color guard should have two methods to play their soundtrack in the event one does not work.
- Color guard must provide their music in a timely manner to the designated sound operator. Any delay in providing music is the responsibility of the color guard.
- Color guards using the Music Upload process through CompetitionSuite should have a backup using another device type such as an MP3 player, iPhone, or CD.
- Color guard must have a designated person at the sound table to operate any device provided to play music such as MP3 players or computers. Guard's representative is responsible to set up and play device. If a CD is provided, the color guard representative must instruct the sound operator as to what track or other relevant information is needed to start the music when directed by the contest Timing and Penalty judge or after the color guard's introduction.
- If the color guard has an issue with the music such as music is too soft, it begins in the wrong place or skips, the color guard's representative must make the decision to stop the music and tell the operator to stop the music. If the color guard representative chooses not to stop and the color guard completes their performance, the color guard will not be offered an opportunity to perform again.
- Interval timing will continue as the color guard resets and begins again. The Contest Administrator has the sole discretion in waiving any timing penalty due to the restart. If the stoppage is due to faulty sound equipment, operator error or an unexplained reason, overtime penalty may be waived.
- Issues related to the equipment provided by the color guard, quality of the CD or the color guard's representative error (using wrong playlist on MP3, etc.) will result in the actual interval timing being used and penalties, if any, being assessed.
- Volume direction must come from the color guard representative at the sound table. Direction will not be taken from the audience viewing area or across the floor. Final volume discretion is given to the sound operator based on their equipment and the Chief Judge who ultimately determines an appropriate volume level.
- The color guard representative may provide direction to the sound operator during the performance regarding equalization.
- It is the responsibility of the color guard to provide their music for each performance and to ensure that their soundtrack is working appropriately. CDs may not be left at sound table between performances.
- Under no circumstances will verbal abuse of the sound operator be tolerated. Penalties will be assessed per current WGI rules