



## Chicago Color Guard Regional

### **Site:**

Lincoln Way East High School  
201 Colorado Avenue  
Frankfort, IL 60423

**Dimensions:** 94' x 75'

**Front Side Bleacher Rows:** 25                      **Seating Capacity:** appx 1200

**Approximate Ceiling Height:** appx 40 ft

There are no stairs to contend with in the competition area.

There are raised basketball goals above the competition floor.

Color guards do not enter the competition area directly from the outdoors.

There is electrical power available at the front and back sideline.

Color guards do not exit the competition area directly to the outdoors.

Part of the fieldhouse will be utilized for prop storage prior to the competition.

There will be two tarps on the performance floor. A blue vinyl tarp will cover the majority of the wooden gym floor and a black vinyl tarp will be laid on top of the blue one.

There is indoor floor refolding available.

The distance from the warm up gym to the performance gym is approximately 1 minutes.

There are not separate areas for body and equipment.

### **Warm Up Areas A/B**

Full Auxiliary Fieldhouse Gym Per Group

Dimensions: appx: 70ft. X 55ft.

Approximate Ceiling Height: 25 ft.

There are raised basketball goals above the warm up area.

Music may not be used in warm up as it will disturb the other color guard in the area.

The above information is being provided to you in order give you the most complete information we currently have on this contest. All information is subject to change either before or during the event by contest personnel based on need.

LINCOLN-WAY  
COMMUNITY HIGH SCHOOL  
EAST CAMPUS  
FRANKFORT, ILLINOIS

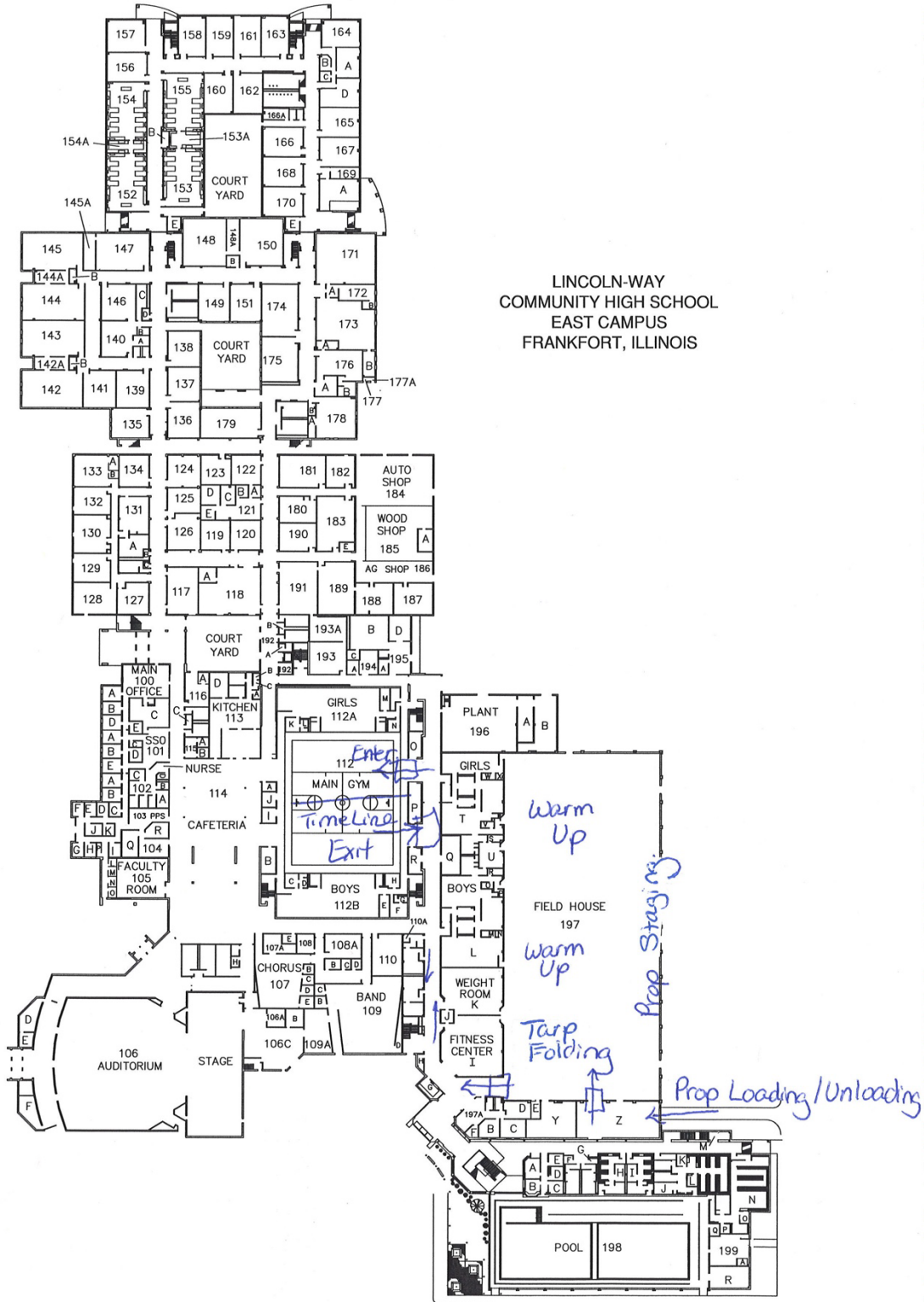

The above information is being provided to you in order give you the most complete information we currently have on this contest. All information is subject to change either before or during the event by contest personnel based on need.



Prop Load/Unload  
140" wide x 115" high

260

The above information is being provided to you in order give you the most complete information we currently have on this contest. All information is subject to change either before or during the event by contest personnel based on need.

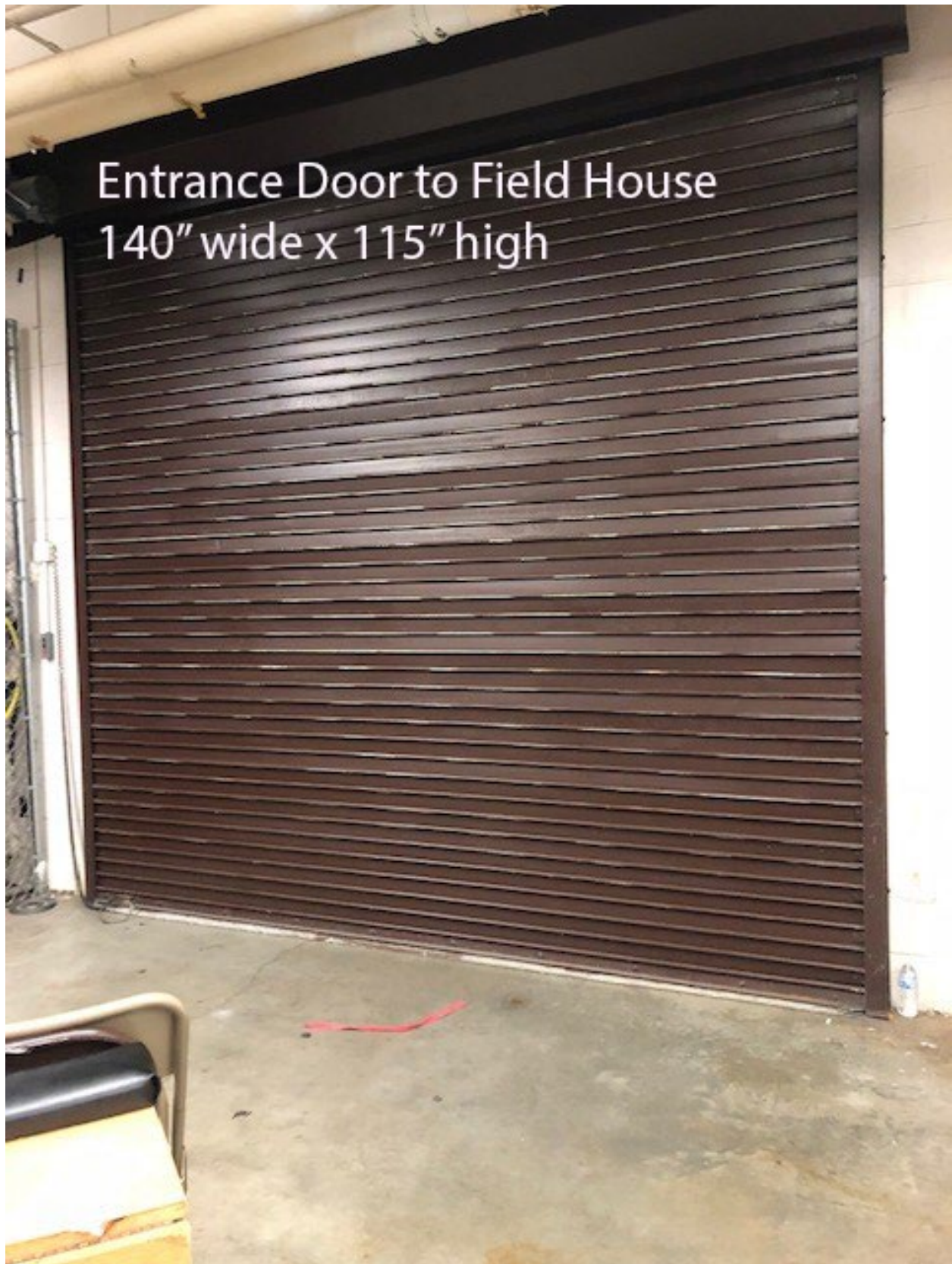

Entrance Door to Field House  
140" wide x 115" high

The above information is being provided to you in order give you the most complete information we currently have on this contest. All information is subject to change either before or during the event by contest personnel based on need.



Exit from Field House  
\*Pole will be removed  
70" wide by 80" tall

The above information is being provided to you in order give you the most complete information we currently have on this contest. All information is subject to change either before or during the event by contest personnel based on need.



Hallway between field house and gym

The above information is being provided to you in order give you the most complete information we currently have on this contest. All information is subject to change either before or during the event by contest personnel based on need.



Hallway between field house and gym

The above information is being provided to you in order give you the most complete information we currently have on this contest. All information is subject to change either before or during the event by contest personnel based on need.



Hallway to Gym Entrance  
\*Pole will be removed  
58" wide x 82" High

The above information is being provided to you in order give you the most complete information we currently have on this contest. All information is subject to change either before or during the event by contest personnel based on need.





Gym Entrance  
\*Pole will be removed  
58" wide x 82" high

The above information is being provided to you in order give you the most complete information we currently have on this contest. All information is subject to change either before or during the event by contest personnel based on need.

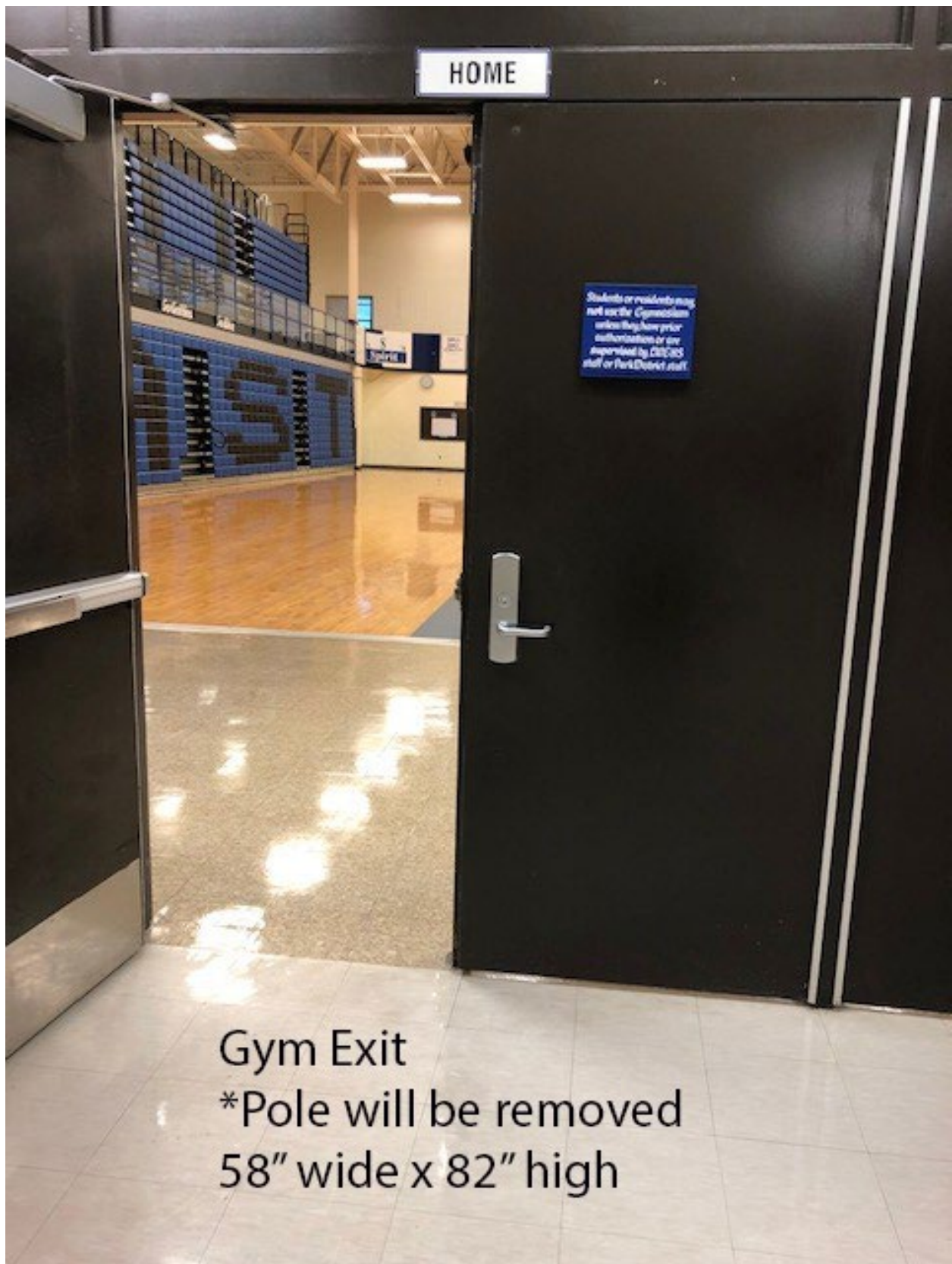

The above information is being provided to you in order give you the most complete information we currently have on this contest. All information is subject to change either before or during the event by contest personnel based on need.