

THERE COULD BE DIFFERENT PROTOCOLS AT EACH WGI EVENT, PLEASE READ THROUGH ALL INFORMATION CAREFULLY.

MINNEAPOLIS PERCUSSION AND WINDS REGIONAL CONTEST INFORMATION

SATURDAY, MARCH 19, 2022



LOCATION

Elk River High School
900 School Street Northwest
Elk River, MN 55330

EMERGENCY CONTACTS (DAY OF SHOW ONLY)

CONTEST ADMINISTRATOR: JASON PARENT – 630.709.1678 / JASON@WGI.ORG
EVENT PARTNER: VLAD BOZ – 651.214.5754 / VLADISLAV.BOZ@GMAIL.COM

JUDGE PANEL

Effect Music – Terry Sanders
Effect Visual & Winds Overall Effect – Mark Waymire
Music & Winds Music Analysis – JJ Pipitone
Visual & Winds Visual Analysis – Sal Adamo
T&P – Bob Johnson

COMPETITIONSUITE DETAILS

ACCESSING YOUR GROUP - <https://help.competitionsuite.com/article/16-accessing-your-group>

ADDING YOUR STAFF - <https://help.competitionsuite.com/article/61-adding-staff-members>

ACCESSING COMMENTARY - <https://help.competitionsuite.com/article/17-accessing-commentary>

Score Summary Sheets are also located in your CompetitionSuite account with your overall score.

ADDITIONAL REGIONAL INFO

PRELIMS LOGISTICAL SCHEDULE – [HTTPS://TINYURL.COM/9RJWDNYW](https://tinyurl.com/9RJWDNYW)

FINALS LOGISTICAL SCHEDULE – [HTTPS://TINYURL.COM/53EMT8YY](https://tinyurl.com/53EMT8YY)

CRITIQUE – TWO (2) STAFF MEMBERS PER GROUP ARE ALLOWED IN THE CRITIQUE ROOM. MASKS ARE REQUIRED.

RETREAT – EACH GROUP MAY DESIGNATE ONE INDIVIDUAL TO REPRESENT THE GROUP ON THE FLOOR DURING RETREAT. **MASKS ARE RECOMMENDED.** IF YOUR GROUP IS NOT ATTENDING RETREAT, PLEASE DESIGNATE ONE INDIVIDUAL (PARENT, STAFFER, OR DESIGNATED REPRESENTATIVE) TO STAY AND RETRIEVE YOUR AWARD AT THE CONCLUSION OF RETREAT. PLEASE INFORM THE CONTEST ADMINISTRATOR ON SITE IF YOUR GROUP WILL NOT BE ATTENDING RETREAT.

No unfolded tarps allowed in parking lots. You may use, as long as space allows without violating any fire codes, a practice tarp and it must be labeled “Practice”. Violation of this policy is subject to penalty. This includes using your performance tarp at remote locations. This is in effect at all sites.

REGIONAL REMINDERS - <https://wgi.org/wp-content/uploads/2022/01/2022-Perc-WindsRegionalReminders.pdf>

Elk River Arena
Field House



Bus, Trailer/Truck
Entrance

Bus Drop-Off/Unit Check-In,
Trailer/Truck Unloading Zone 1

Spectator
Parking

Bus, Trailer/Truck
Parking

Trailer/Truck Loading Zone 2
(Only for Loading While Groups
Still Arriving/Unloading in Zone 1)

Spectator
Entrance



Elk River High School

Jackson Ave NW

Jackson Ave NW

WGI Minneapolis Regional
Elk River HS
Elk River, MN

St NW

Google

School St NW

**WGI Minneapolis Regional
Elk River HS - Elk River, MN**

ELK R

ELK RIVER HIGH SCHOOL

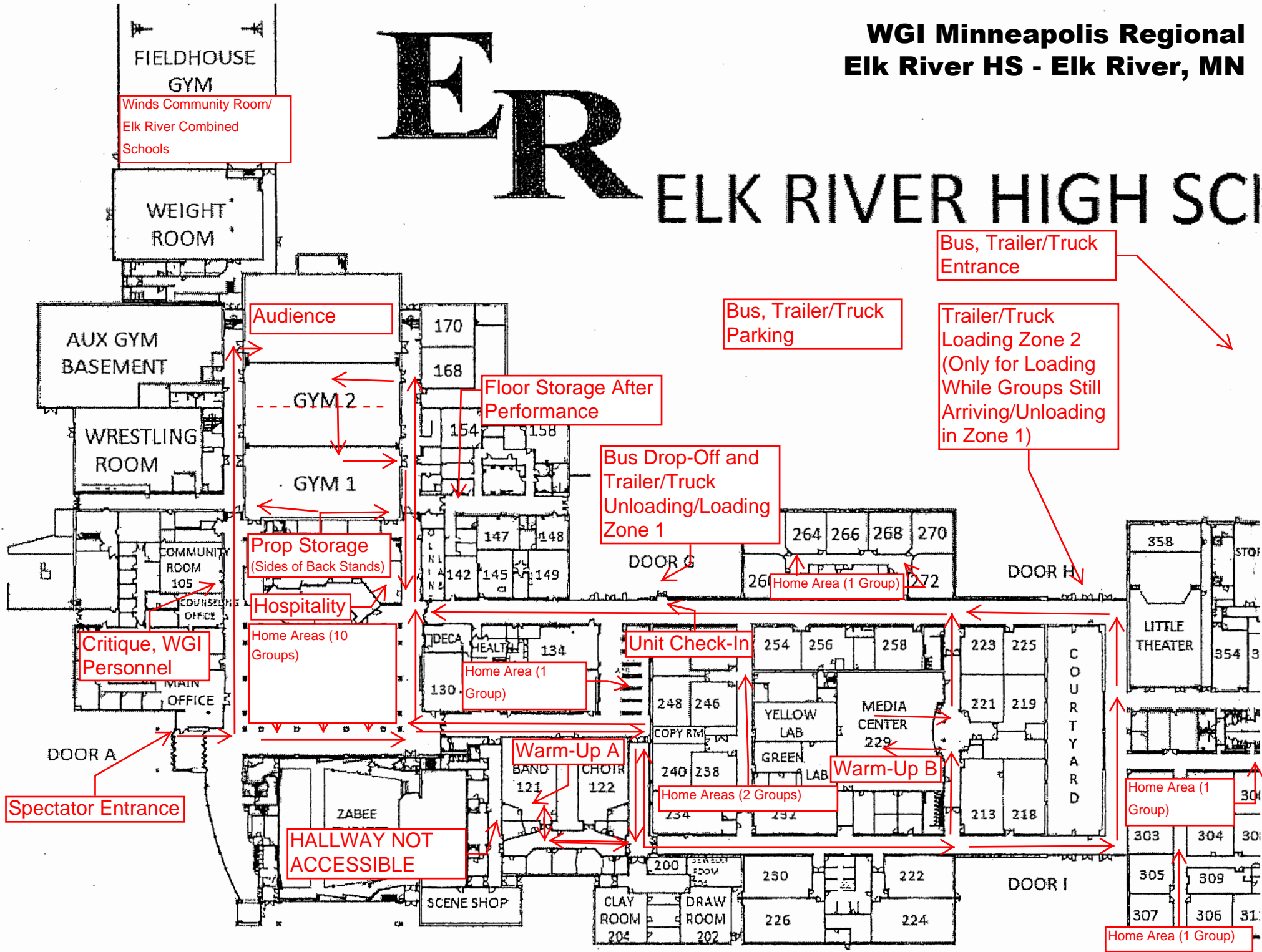



Minneapolis Percussion & Winds Competition Area Elk River HS, Elk River, MN

All WGI contest sites must have a minimum of seventy by one hundred feet (70' x 100') to accommodate a "safety zone" of five (5) feet from any spectator seating. If no spectators are seated on the left and right sides, then the safety zone will be eliminated on the left and right sides of the competition area and extend to the wall.

The "competition area" at this event measures 104' X 72'. All performing groups must be prepared to perform within that area. Floors (tarps) may not extend into the safety zones per rules found in the WGI Adjudication Manual and Rulebook

