

THERE COULD BE DIFFERENT PROTOCOLS AT EACH WGI EVENT, PLEASE READ THROUGH ALL INFORMATION CAREFULLY.

DALLAS PERCUSSION AND WINDS REGIONAL CONTEST INFORMATION

SATURDAY, MARCH 19, 2022



LOCATION

Burleson Centennial HS
201 S. Hurst Rd.
Burleson, TX 76028

EMERGENCY CONTACTS (DAY OF SHOW ONLY)

CONTEST ADMINISTRATOR: HEATHER KAYNES – 651.336.0292 / HEATHER@WGI.ORG
EVENT PARTNER: ANDREW KLEIN – 260.609.5112 / AKLEIN@BISDMAIL.NET

JUDGE PANEL

See Pages 2 and 3

COMPETITIONSUITE DETAILS

ACCESSING YOUR GROUP - <https://help.competitionsuite.com/article/16-accessing-your-group>

ADDING YOUR STAFF - <https://help.competitionsuite.com/article/61-adding-staff-members>

ACCESSING COMMENTARY - <https://help.competitionsuite.com/article/17-accessing-commentary>

Score Summary Sheets are also located in your CompetitionSuite account with your overall score.

ADDITIONAL REGIONAL INFO

PRELIMS LOGISTICAL SCHEDULE – [HTTPS://TINYURL.COM/Y5PF87E5](https://tinyurl.com/y5pf87e5)

FINALS LOGISTICAL SCHEDULE – [HTTPS://TINYURL.COM/J53TD9CA](https://tinyurl.com/j53td9ca)

CRITIQUE – TWO (2) STAFF MEMBERS PER GROUP ARE ALLOWED IN THE CRITIQUE ROOM. MASKS ARE REQUIRED.

RETREAT – EACH GROUP MAY DESIGNATE ONE INDIVIDUAL TO REPRESENT THE GROUP ON THE FLOOR DURING RETREAT. **MASKS ARE RECOMMENDED.** IF YOUR GROUP IS NOT ATTENDING RETREAT, PLEASE DESIGNATE ONE INDIVIDUAL (PARENT, STAFFER, OR DESIGNATED REPRESENTATIVE) TO STAY AND RETRIEVE YOUR AWARD AT THE CONCLUSION OF RETREAT. PLEASE INFORM THE CONTEST ADMINISTRATOR ON SITE IF YOUR GROUP WILL NOT BE ATTENDING RETREAT.

No unfolded tarps allowed in parking lots. You may use, as long as space allows without violating any fire codes, a practice tarp and it must be labeled “Practice”. Violation of this policy is subject to penalty. This includes using your performance tarp at remote locations. This is in effect at all sites.

REGIONAL REMINDERS - <https://wgi.org/wp-content/uploads/2022/01/2022-Perc-WindsRegionalReminders.pdf>

THERE COULD BE DIFFERENT PROTOCOLS AT EACH WGI EVENT, PLEASE READ THROUGH ALL INFORMATION CAREFULLY.



2022 DALLAS JUDGE PANELS

PRELIMS

Winds

**Overall Effect – Greg Mills
Visual Analysis – Michael Tarr
Music Analysis – Beth Fabrizio
T&P – Kim Moss**

Winds Critique to begin at 10:45 AM

Panel 1 – PSA, PIA, All Concert Classes

**Effect-Music – Ray Ulibarri
Effect-Visual – Jim Shade
Music – Mike Leitzke
Visual – Ken Giese
T&P – Kim Moss**

PSA, PIA, and Concert Critique to begin at 12:45 PM

Panel 2 – PSO, PIO, PIW

**Effect-Music – Bret Kuhn
Effect-Visual – John Howell
Music – Marty Griffin
Visual – Bret Mascaro
T&P – Jesse Hunter**

PSO, PIO, PIW Critique to begin at 3:45 PM

THERE COULD BE DIFFERENT PROTOCOLS AT EACH WGI EVENT, PLEASE READ THROUGH ALL INFORMATION CAREFULLY.



2022 DALLAS JUDGE PANELS

FINALS

Winds

**Overall Effect – Greg Mills
Visual Analysis – Michael Tarr
Music Analysis – Beth Fabrizio
T&P – Kim Moss**

**Panel 1 – PSO, PIO, PIW
Effect-Music – Ray Ulibarri
Effect-Visual – Jim Shade
Music – Mike Leitzke
Visual – Ken Giese
T&P – Kim Moss**

**Panel 2 – PSA, PIA, All Concert Classes
Effect-Music – Bret Kuhn
Effect-Visual – John Howell
Music – Marty Griffin
Visual – Bret Mascaro
T&P – Jesse Hunter**

Centennial High School
 201 S. Hurst Rd
 Burleson, TX 76028
 (817) 245-0250



Centennial Varsity Football Games
 are played at Burleson ISD Stadium.
 100 Elk Dr. (adjacent to Burleson High School)



WGI Dallas Percussion Regional FRONT PARKING MAP

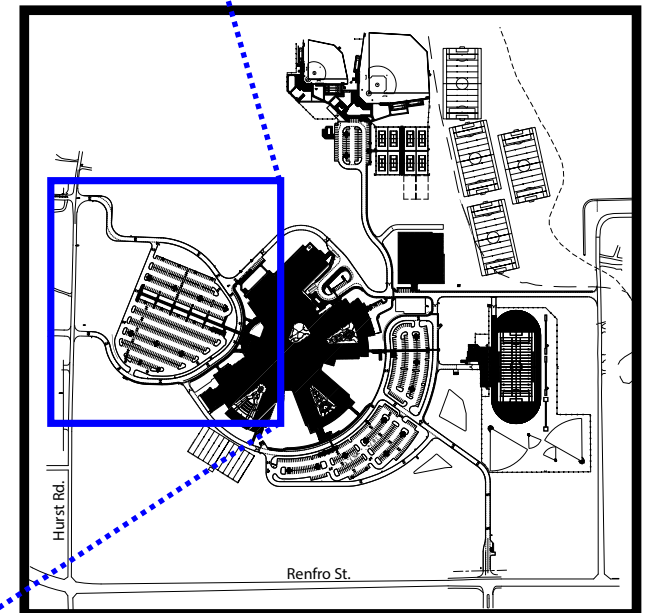
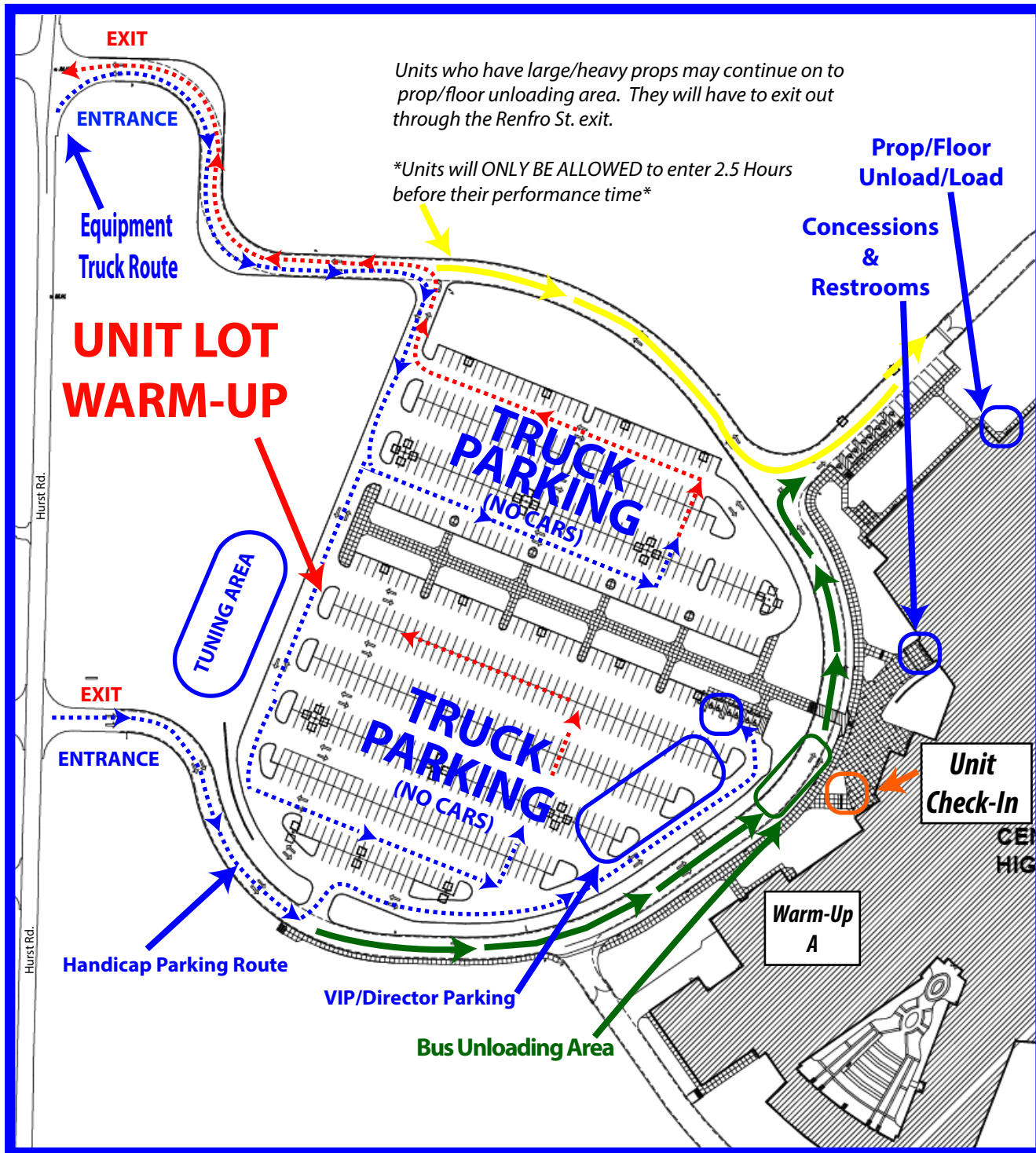



WGI Dallas Percussion Regional
INTERIOR MAP

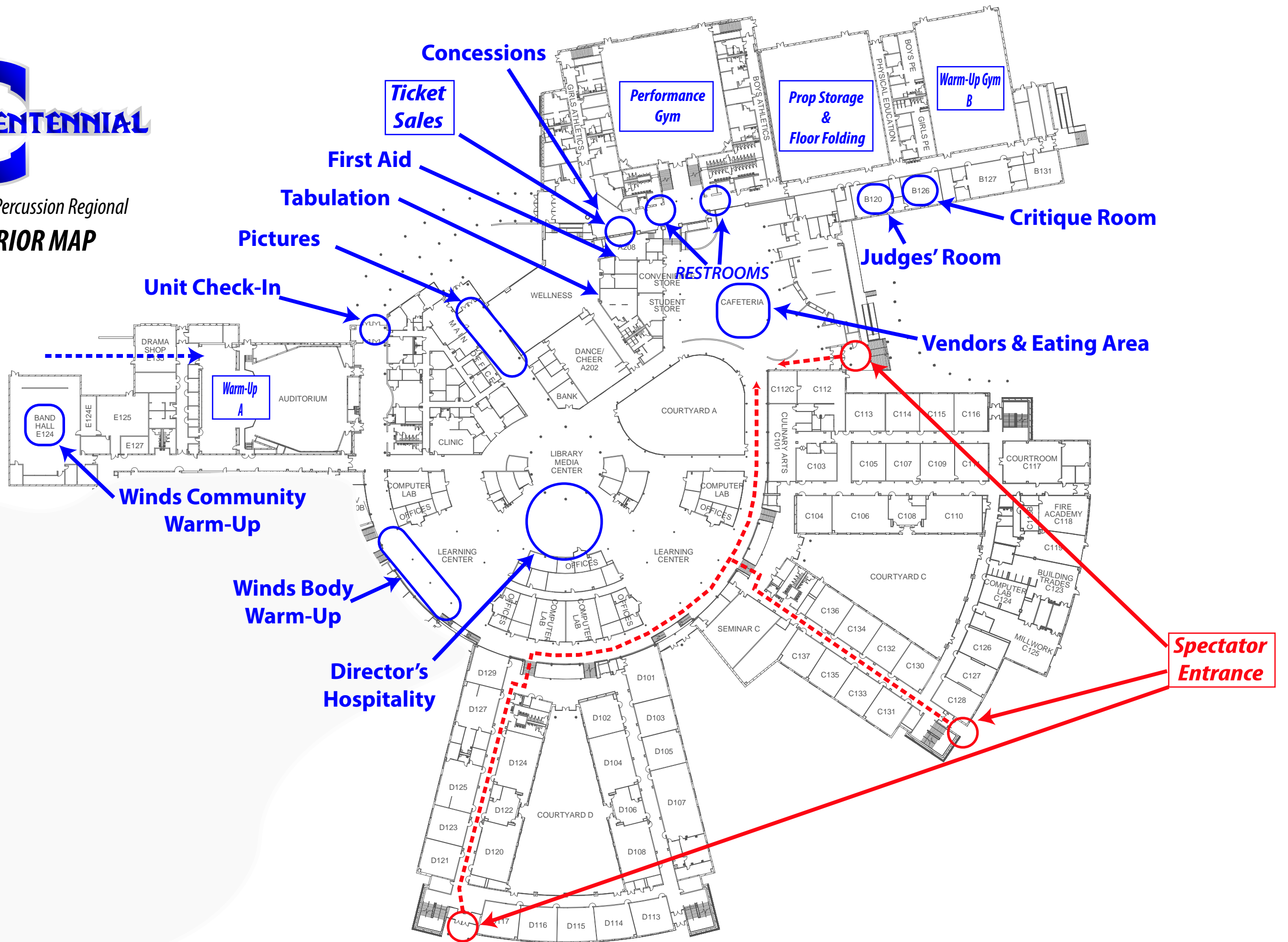



WGI Dallas Percussion Regional
CONTEST FLOW MAP

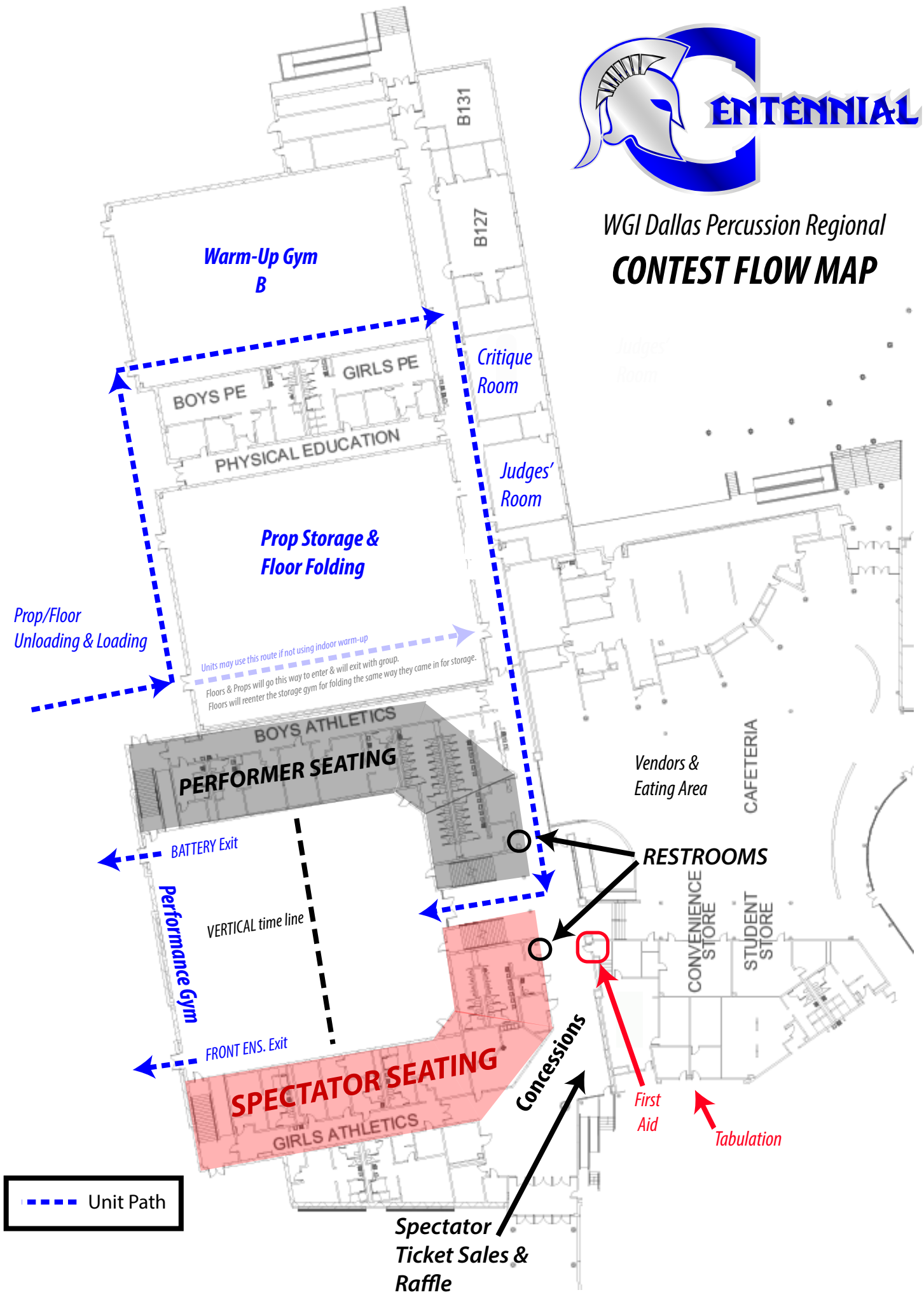



Dallas Regional Competition Area Burleson Centennial High School, Burleson, TX

All WGI contest sites must have a minimum of seventy by one hundred feet (70' x 100') to accommodate a "safety zone" of five (5) feet from any spectator seating. If no spectators are seated on the left and right sides, then the safety zone will be eliminated on the left and right sides of the competition area and extend to the wall.

The "competition area" at this event measures 67'X100'. All performing groups must be prepared to perform within that area. Floors (tarps) may not extend into the safety zones per rules found in the WGI Adjudication Manual and Rulebook

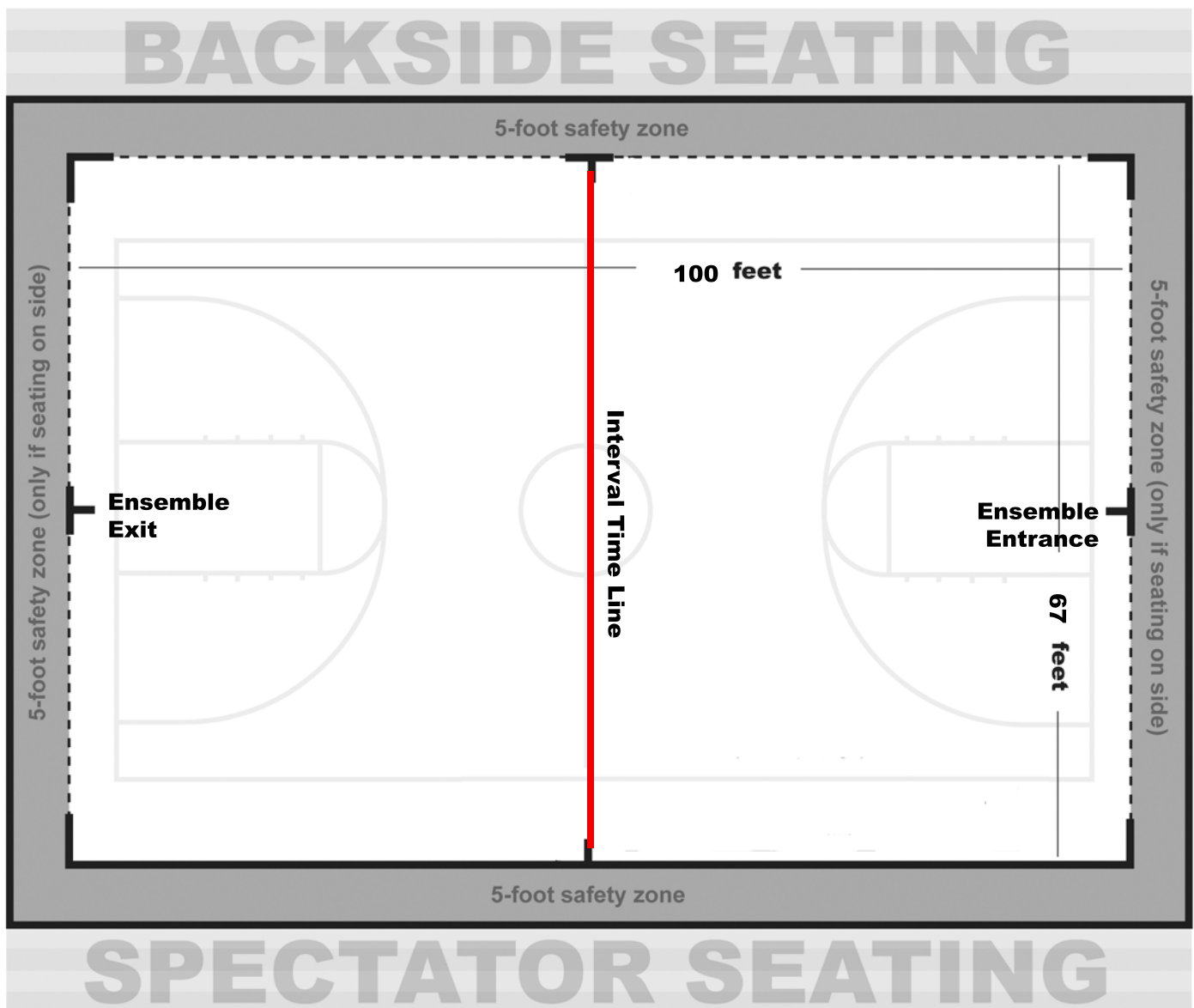

FLOMARCHING

**This event will be
webcast LIVE on
FloMarching**

**For more info visit
WGI.org/webcast**



TEXAS**MARIMBAS**

SIMPLE, INEXPENSIVE & CONVENIENT
PRACTICE MARIMBAS - DELIVERED

PRACTICE MARIMBAS

\$29/MO

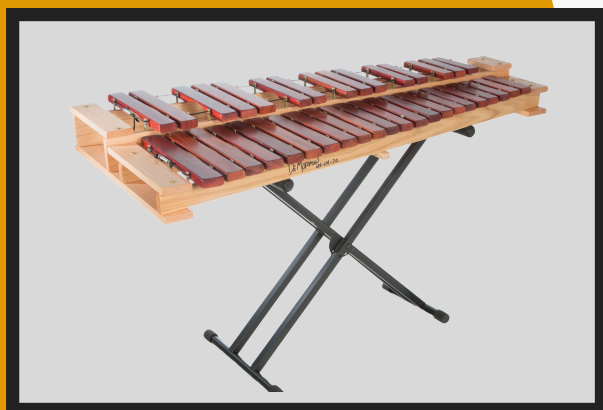

SIMPLE ONLINE SIGNUP
FREE HOME DELIVERY
NO HIDDEN COSTS

TEXASMARIMBAS.COM