

THERE COULD BE DIFFERENT PROTOCOLS AT EACH WGI EVENT, PLEASE READ THROUGH ALL INFORMATION CAREFULLY.

ATLANTA PERCUSSION AND WINDS REGIONAL CONTEST INFORMATION

SATURDAY, MARCH 19, 2022



LOCATION

Lambert High School
805 Nichols Rd.
Suwanee, GA 30024

EMERGENCY CONTACTS (DAY OF SHOW ONLY)

CONTEST ADMINISTRATOR: KENNETH COULTAS - 931.231.0486 / KENNETH@WGI.ORG
EVENT PARTNER: DENISE ABREU - 678.361.5557 / DENISEABREU11@GMAIL.COM

JUDGE PANEL

Effect Music & Winds Overall Effect – Michael McIntosh
Effect Visual – Jim Dwyer
Music & Winds Music Analysis – Tom Rarick
Visual & Winds Visual Analysis – Dave McCarthy
T&P – Mike Lynch

COMPETITIONSUITE DETAILS

ACCESSING YOUR GROUP - <https://help.competitionsuite.com/article/16-accessing-your-group>

ADDING YOUR STAFF - <https://help.competitionsuite.com/article/61-adding-staff-members>

ACCESSING COMMENTARY - <https://help.competitionsuite.com/article/17-accessing-commentary>

Score Summary Sheets are also located in your CompetitionSuite account with your overall score.

ADDITIONAL REGIONAL INFO

PRELIMS LOGISTICAL SCHEDULE - [HTTPS://TINYURL.COM/227J6v4H](https://tinyurl.com/227J6v4H)

FINALS LOGISTICAL SCHEDULE - [HTTPS://TINYURL.COM/YH74XWKM](https://tinyurl.com/YH74XWKM)

CRITIQUE – TWO (2) STAFF MEMBERS PER GROUP ARE ALLOWED IN THE CRITIQUE ROOM. MASKS ARE REQUIRED.

RETREAT – EACH GROUP MAY DESIGNATE ONE INDIVIDUAL TO REPRESENT THE GROUP ON THE FLOOR DURING RETREAT. **MASKS ARE RECOMMENDED.** IF YOUR GROUP IS NOT ATTENDING RETREAT, PLEASE DESIGNATE ONE INDIVIDUAL (PARENT, STAFFER, OR DESIGNATED REPRESENTATIVE) TO STAY AND RETRIEVE YOUR AWARD AT THE CONCLUSION OF RETREAT. PLEASE INFORM THE CONTEST ADMINISTRATOR ON SITE IF YOUR GROUP WILL NOT BE ATTENDING RETREAT.

No unfolded tarps allowed in parking lots. You may use, as long as space allows without violating any fire codes, a practice tarp and it must be labeled “Practice”. Violation of this policy is subject to penalty. This includes using your performance tarp at remote locations. This is in effect at all sites.

REGIONAL REMINDERS - <https://wgi.org/wp-content/uploads/2022/01/2022-Perc-WindsRegionalReminders.pdf>

WGI Atlanta Regional Concession Preorders – [CLICK HERE](#)



WGI ATLANTA REGIONAL LAMBERT^{III} HS

Google

SoFo Modern
Cuisine & Cocktails
Tapas Bar

GROUP ENTRANCE
3595 OLD ATLANTA RD
SUWANEE, GA 30024

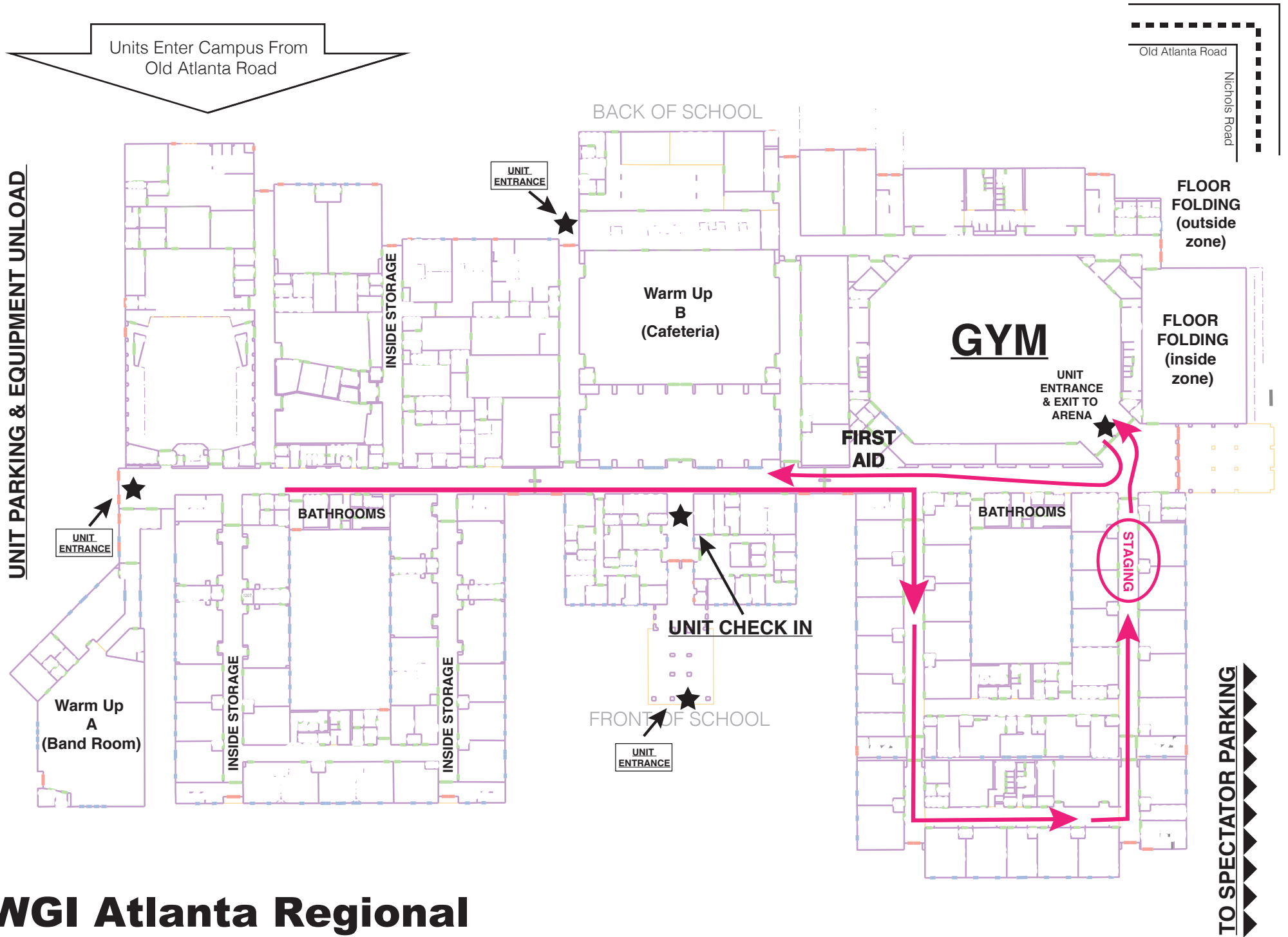

WGI Atlanta Regional Lambert, HS - Suwanee, GA

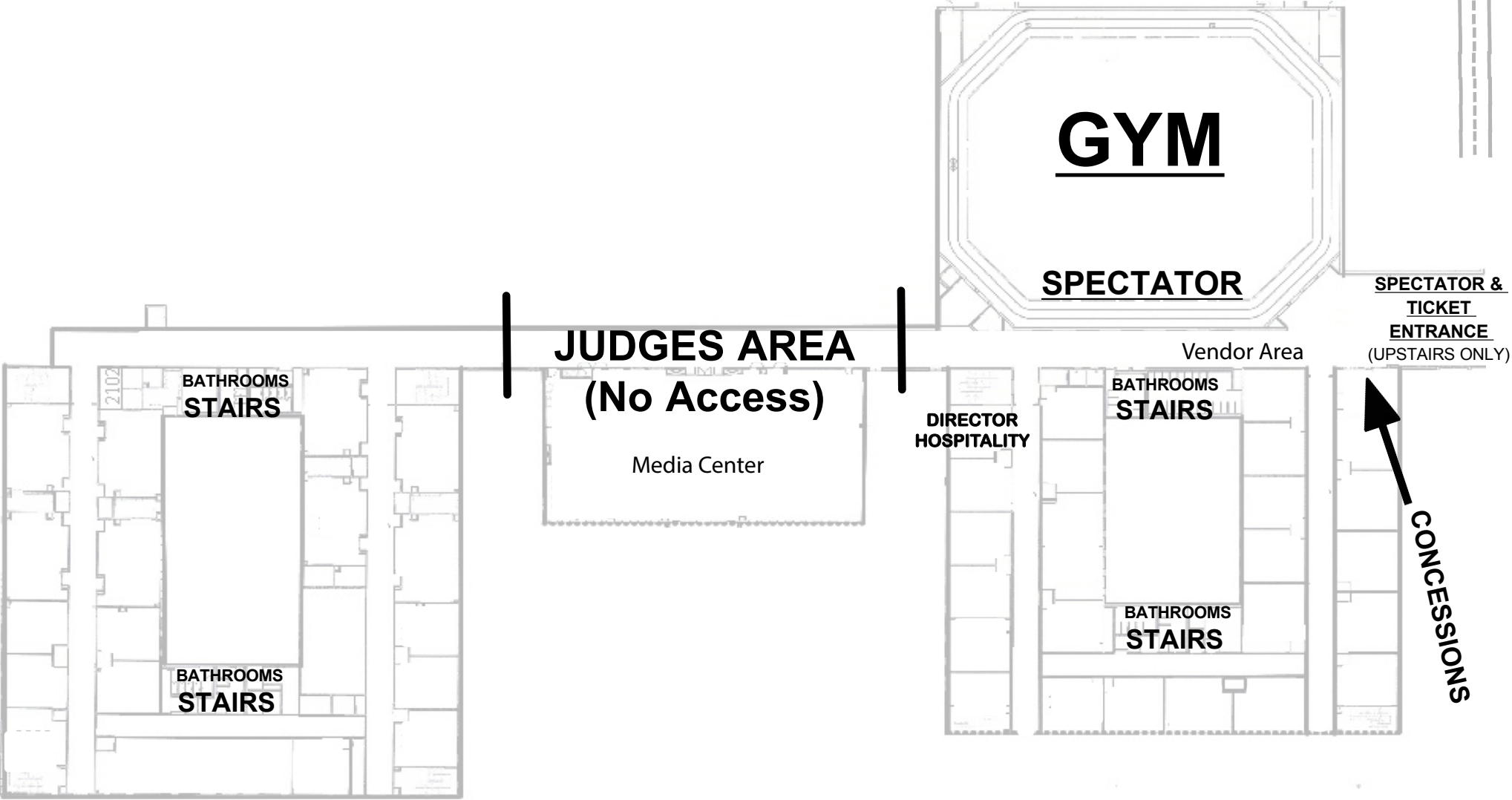
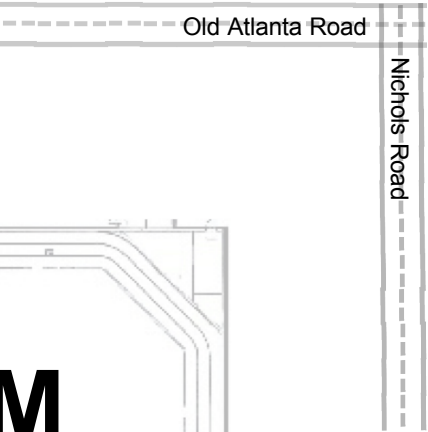

**WGI Atlanta Regional
Lambert HS - Suwanee, GA**

UPPER LEVEL VIEW

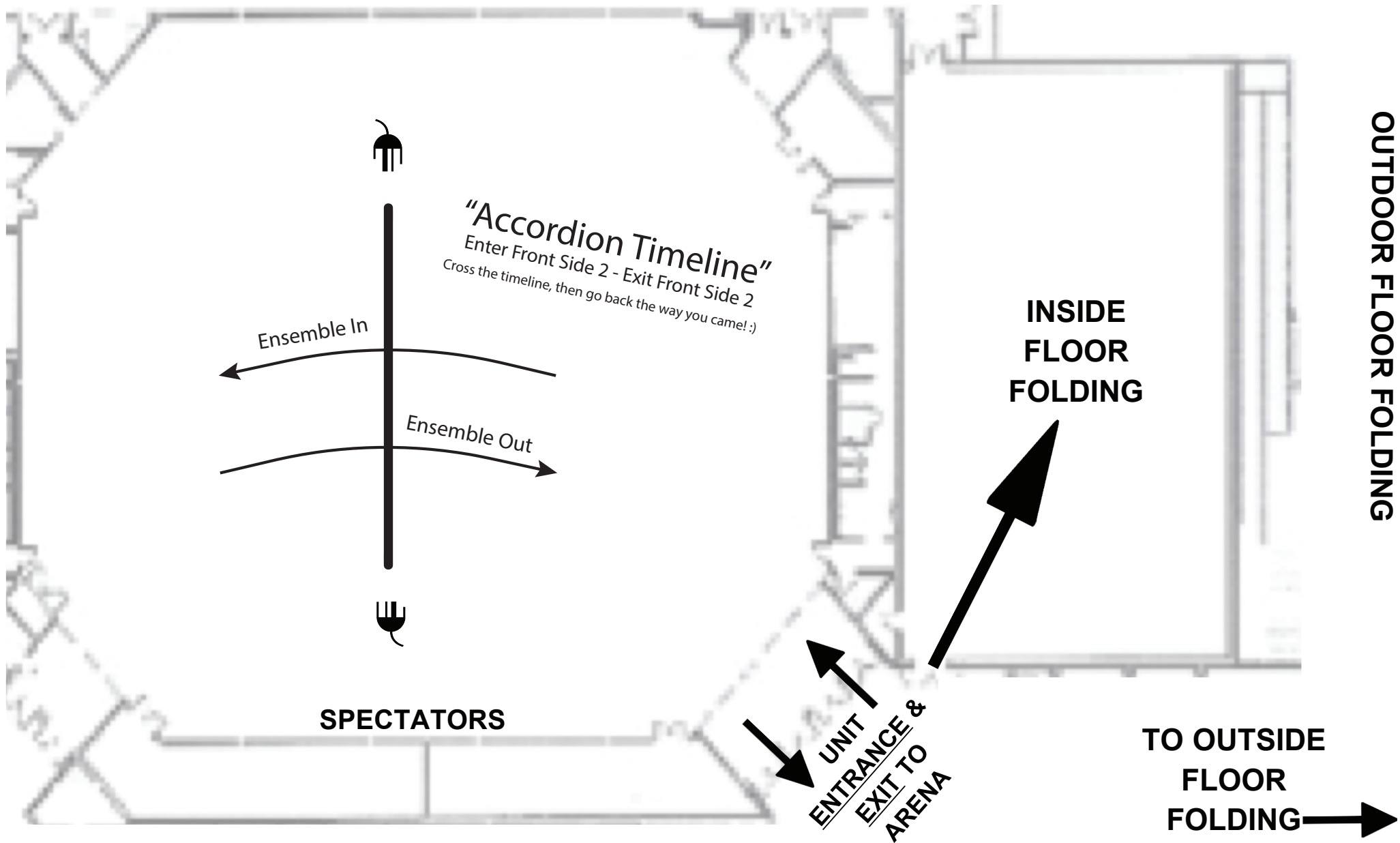

**WGI Atlanta Regional
Lambert HS - Suwanee, GA**

GYM VIEW



Atlanta Regional Competition Area Lambert High School, Suwanee, GA

All WGI contest sites must have a minimum of seventy by one hundred feet (70' x 100') to accommodate a "safety zone" of five (5) feet from any spectator seating. If no spectators are seated on the left and right sides, then the safety zone will be eliminated on the left and right sides of the competition area and extend to the wall.

The "competition area" at this event measures 72'X106'. All performing groups must be prepared to perform within that area. Floors (tarps) may not extend into the safety zones per rules found in the WGI Adjudication Manual and Rulebook

