

OMAHA PERCUSSION AND WINDS REGIONAL CONTEST INFORMATION

SATURDAY, FEBRUARY 29, 2020



LOCATION

LEWIS & CLARK MIDDLE SCHOOL
13502 SOUTH 38TH STREET
BELLEVUE, NE 68123

EMERGENCY CONTACTS (DAY OF SHOW ONLY)

CONTEST ADMINISTRATOR: Benja Russell - 404-988-9393/ benja@wgi.org
EVENT PARTNER: Glen Bueckner glen.buecker@bpsne.net

JUDGE PANEL

Effect Music & Winds Music Analysis – Bret Cappelluti
Effect Visual & Winds Overall Effect – Matt Stevens
Music – Jon Merritt
Visual & Winds Visual Analysis – Mark Metz
T&P – Adam Killham

COMPETITIONSUITE DETAILS

ACCESSING YOUR GROUP - <https://help.competitionsuite.com/article/16-accessing-your-group>

ADDING YOUR STAFF - <https://help.competitionsuite.com/article/61-adding-staff-members>

ACCESSING COMMENTARY - <https://help.competitionsuite.com/article/17-accessing-commentary>

Score Summary Sheets are also located in your CompetitionSuite account with your overall score.

ADDITIONAL REGIONAL INFO

WINDS PRELIMS LOGISTICAL SCHEDULE - [HTTPS://BIT.LY/20QXYMJ](https://bit.ly/20QXYMJ)

PERCUSSION PRELIMS LOGISTICAL SCHEDULE - [HTTPS://BIT.LY/3BkHvQH](https://bit.ly/3BkHvQH)

WINDS FINALS LOGISTICAL SCHEDULE - [HTTPS://BIT.LY/2H0qmxU](https://bit.ly/2H0qmxU)

PERCUSSION FINALS LOGISTICAL SCHEDULE – [HTTPS://BIT.LY/39G6HzB](https://bit.ly/39G6HzB)

REGIONAL REMINDERS - [HTTPS://WGI.ORG/WP-CONTENT/UPLOADS/2020/01/PERC.WINDSREGIONALREMINDERS.PDF](https://wgi.org/wp-content/uploads/2020/01/PERC.WINDSREGIONALREMINDERS.PDF)

Winter Guard International, Inc.

2405 Cross Pointe Drive, Miamisburg, OH 45342/ Phone: 937-247-5919/ Fax: 937-247-9212/ Email: office@wgi.org Web: <http://wgi.org>

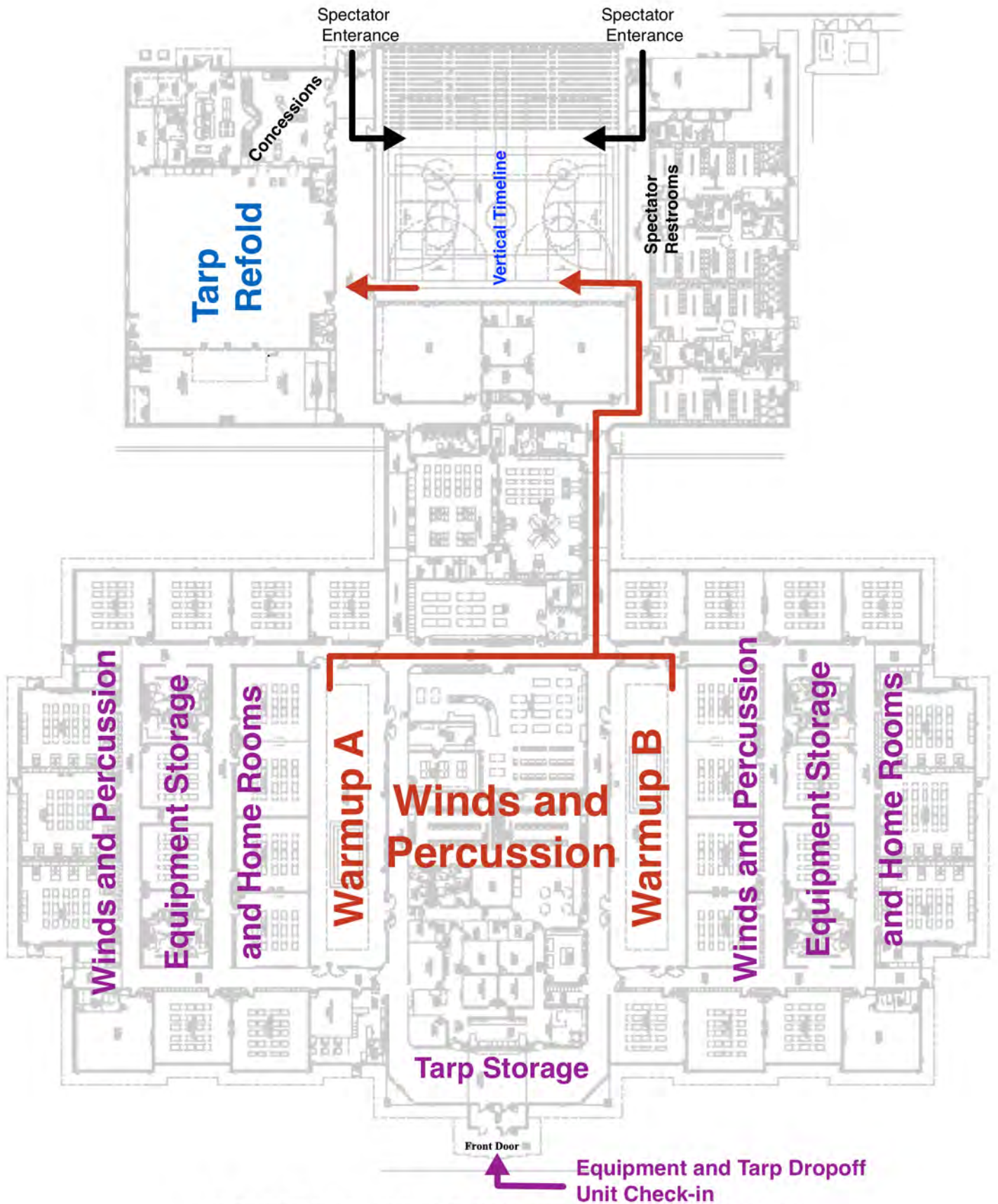

LEWIS & CLARK MIDDLE SCHOOL

13502 S 38th St,
Bellevue, NE 68123

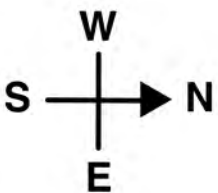

L&C Gym Map

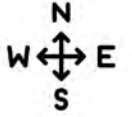

Spectator Restrooms

Performance Entrance

Spectator Entrance

Bleachers

Performance Area

Vertical
Timeline

Path from Percussion Warm-up

Performance Exit

Concessions

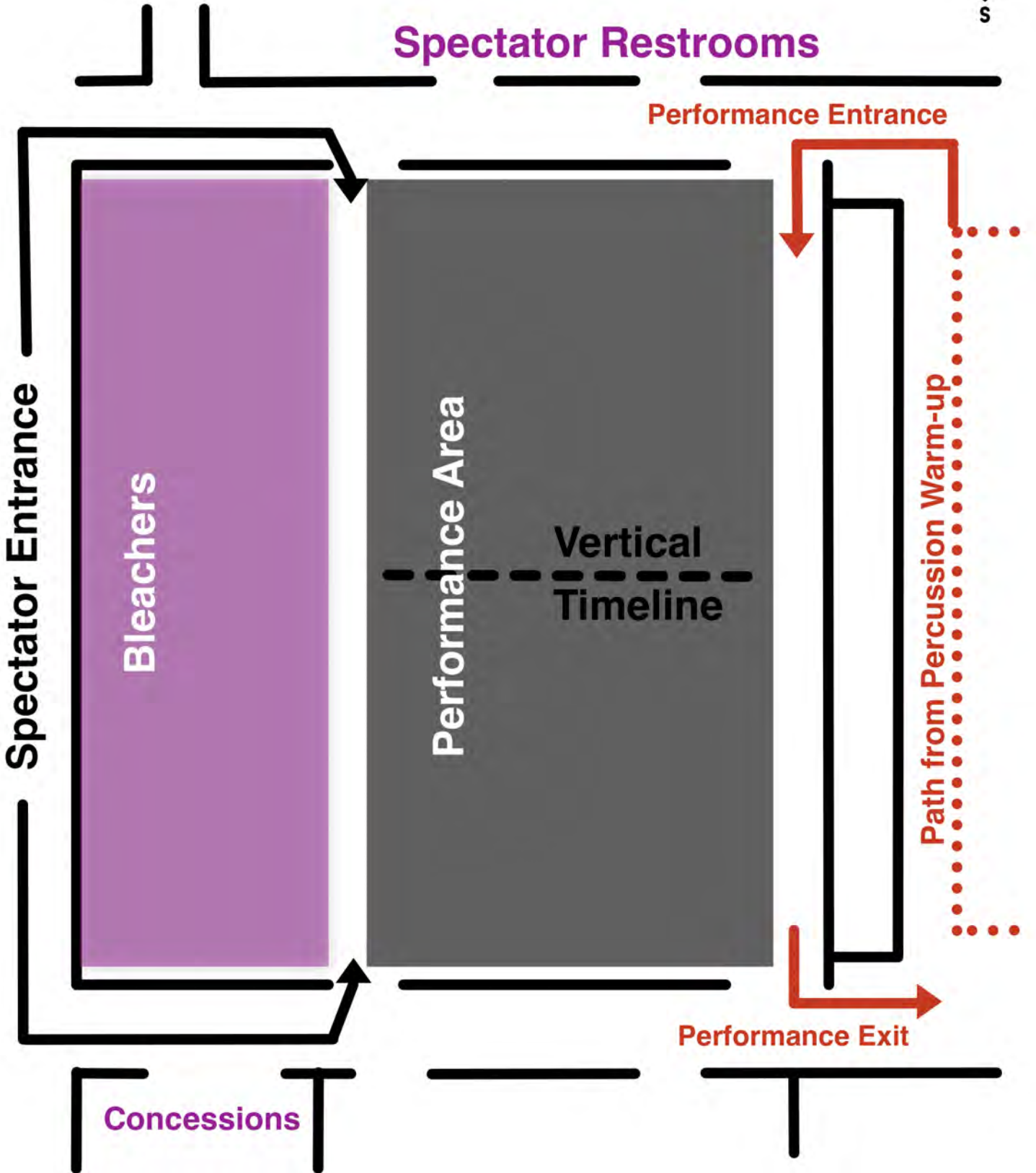

20 WGI
20 I AM WGI



JOIN THE OMAHA PERC/WINDS REGIONAL BAND!

BAND

- Free all-in-one group communication platform.
- Share group announcements via push notification, text message or email.
- Robust group calendar and membership management.
- Customizable to your unique communication needs.
- Available for your mobile device and desktop.

BAND LINK:

<https://band.us/n/a1ad28KbFdx9u>

- 1 Go to the Apple App Store or Google Play Store, search for BAND and download.
- 2 Sign up using your phone number, email, Facebook account or Google account.
- 3 Scan the QR code or use the link below to join the BAND.



#WGI2020

#IAMWGI