

UPDATED 2/9

KANSAS CITY COLOR GUARD REGIONAL CONTEST INFORMATION

SATURDAY, FEBRUARY 11, 2023



LOCATION

Blue Springs High School
2000 NW Ashton Drive
Blue Springs MO 64015

EMERGENCY CONTACTS *(DAY OF SHOW ONLY)*

CONTEST ADMINISTRATOR: Kendra Whelchel / 303-946-3349 / Kendra@wgi.org
EVENT PARTNER: Duane Williams / 314-288-7714 / mccgapresident@yahoo.com

JUDGE PANEL

EQ John Fisher
MV Katie Anderson
DA Brian Murphy
GE Michael Higbe & Grady Robertson
T&P Jean Padawan

COMPETITIONSUITE DETAILS

ACCESSING YOUR GROUP - <https://help.competitionsuite.com/article/16-accessing-your-group>

ADDING YOUR STAFF - <https://help.competitionsuite.com/article/61-adding-staff-members>

ACCESSING COMMENTARY - <https://help.competitionsuite.com/article/17-accessing-commentary>

MUSIC UPLOADS - <https://help.competitionsuite.com/article/74-uploading-performance-music>

Score Summary Sheets are also located in your CompetitionSuite account with your overall score.

ADDITIONAL REGIONAL INFO

Draft Schedules are no longer available.

Please download the latest schedule on the [Kansas City Regional Event Page](#).

WARM UP AREAS – Music may be used in both body and equipment at moderate levels. Groups must provide their own sound system if they wish to use music in warm up.

CRITIQUE – Due to timing constraints, critique will not be offered at this regional event.

RETREAT – Captains only. If your group is not attending retreat, please designate one individual (parent, staffer, or designated representative) to stay and retrieve your award at the conclusion of retreat. Please inform the Contest Administrator on site if your group will not be attending retreat.

REGIONAL REMINDERS – <https://wgi.org/wp-content/uploads/2022/12/2023CGRegionalReminders.pdf>



Baumgardner Park

UNIVERSAL AUTO PLAZA
Used car dealer

Overflow Parking

NW Copper Oaks Cir

Sage Door Group

Paul Hawkins - Thrivent

The Blue Centennial Pool Plex

Calvary Baptist Church

Montessori Day School of Blue Springs

Overflow Parking

Harvest Baptist Church of Blue Springs

First American Title Insurance Company

Overflow Parking

Trinity Wellness

NW Ashton Dr

Parking Lot Entrance

NW Ashton Dr

Kingdom Hall of Jehovah's Witnesses

Bus Parking

Cathy's Angels Child Care

Spectator Parking

Blue Springs High School

Trucks may use either NW 19 Street or NW Willowbrook Drive to get to Equipment/Truck Unloading

Equipment Truck Unloading

First Christian Church

Google

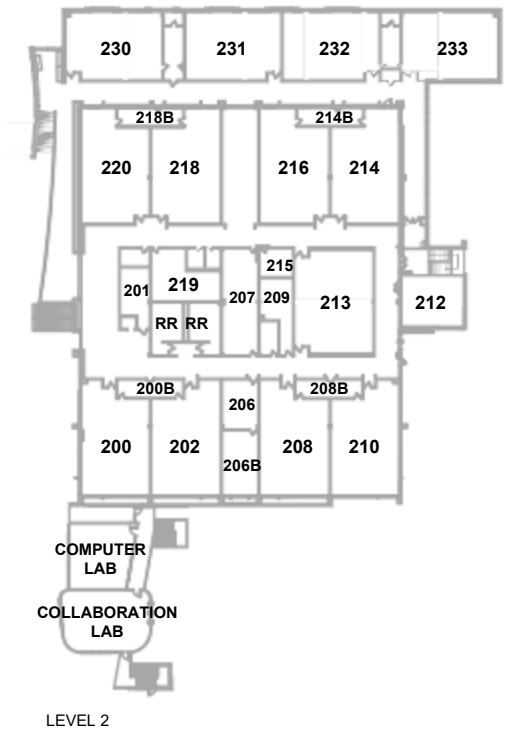

Equipment Vehicle Parking

WGI Kansas City Color Guard Regional Blue Springs High School Performance Area

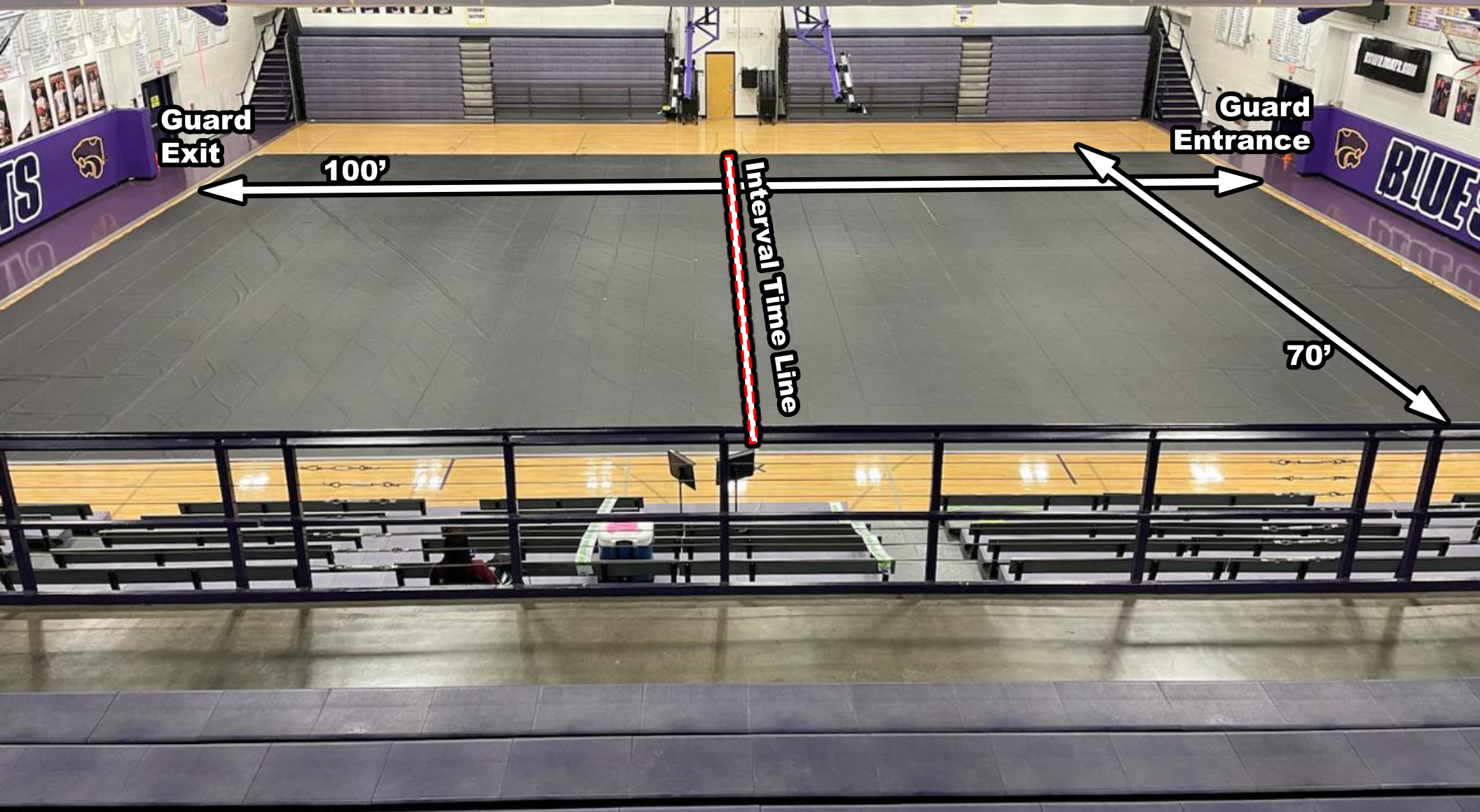



Kansas City Regional Competition Area Blue Springs HS, Blue Springs, MO

All WGI contest sites must have a minimum of seventy by one hundred feet (70' x 100') to accommodate a "safety zone" of five (5) feet from any spectator seating. If no spectators are seated on the left and right sides, then the safety zone will be eliminated on the left and right sides of the competition area and can extend to a maximum of 106'X 78'.

The "competition area" at this event measures 100'X 70'. All performing groups must be prepared to perform within that area. Floors (tarps) may not extend into the safety zones per rules found in the WGI Adjudication Manual and Rulebook.

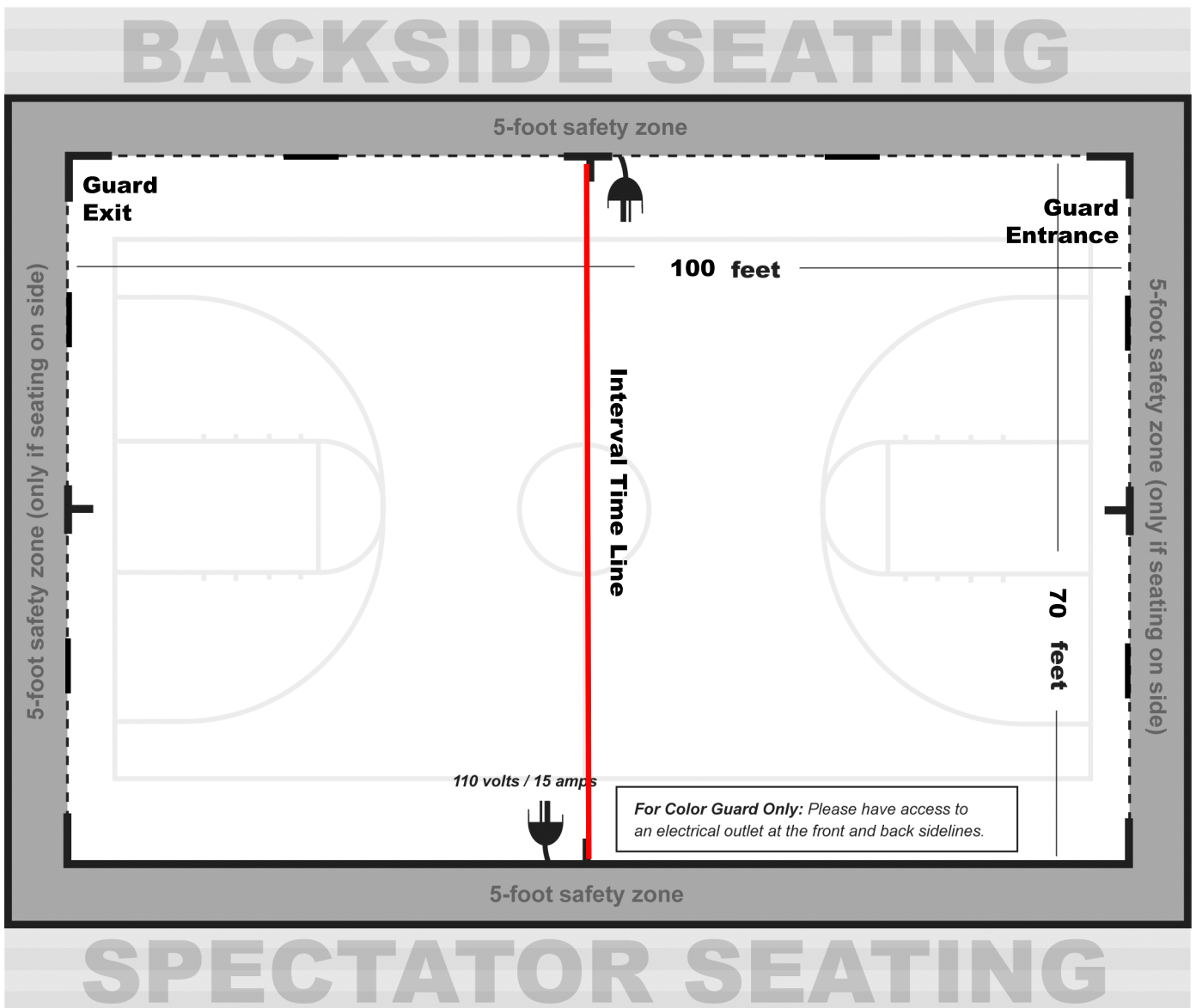

7.3.4 Sound Policy (Color Guard)

- Color Guards must have a designated person at the sound table to provide the method for the soundtrack to be played via smartphone, MP3 player, laptop computer, or music uploaded in CompetitionSuite. The designated person is responsible for setting up and playing the device, and it is strongly recommended to have a backup option in the event of a malfunction.
- It is recommended to do a sound check at the designated times provided in the contest information to ensure the playability of any device used by checking the soundtrack at multiple intervals in the music.
- Color Guard must provide their music in a timely manner to the sound operator. Any delay in providing music is the responsibility of the group.
- If there is an issue with the music such as music is too soft, begins in the wrong place or skips, the designated person must make the decision to stop the music and tell the operator to stop the music. If the choice is made to complete the program, the group will not be offered an opportunity to repeat their performance.
- Interval timing will continue as the group resets and begins again. The Contest Administrator has the sole discretion in waiving any timing penalty due to the restart. If the stoppage is due to faulty sound equipment, operator error or other unexplained reason, overtime penalty may be waived.
- Issues related to the equipment provided by the group or error by the designated person (using wrong playlist on MP3, etc.) will result in the actual interval timing being used and penalties, if any, being assessed.
- Volume direction must come from the designated person at the sound table. Direction will not be taken from the audience viewing area or across the floor.
- Final volume discretion is given to the sound operator based on their equipment and the Chief Judge who ultimately determines an appropriate volume level. Sound decibel levels for each performance venue will be measured from the area designated for the General Effect judges.
- The designated representative may provide direction to the sound operator during the performance regarding equalization.
- Under no circumstances will verbal abuse of the sound operator be tolerated. Penalties will be assessed per current WGI rules.



WATCH



LIVE ON

FLOMARCHING



WATCH LIVE ALL SEASON LONG AND RELIVE YOUR FAVORITE MOMENTS WITH SOUND BY CATCHING THE FLOMARCHING REBROADCAST THE FOLLOWING DAY

SUBSCRIBE TODAY AT [FLOMARCHING.COM](https://www.flomarching.com)

android 

ios



Roku

fire tv 

 chromecast

Be There.