

# 2019 East Power Regional Contest Information

## Saturday, March 16—Prelims - 10 AM

## Sunday, March 17—Finals - 9 AM

### Facility:

Liberty High School  
1115 Linden Avenue  
Bethlehem, PA 18018

### Emergency Contacts

Jamie Rightmyer—585-721-8715  
AJ Kise—484-934-4578

### Ticket Prices/Info

Prelims Only—\$20  
Finals Only—\$23  
Weekend Combo Pass—\$34  
Ticket prices include a \$2 arena ticketing fee.

CASH or Credit Cards ONLY, arena does not accept checks.

Each color guard will receive ten (10) staff passes unless a PLUS pass was purchased. A PLUS pass allows an additional seven (7) staff for a total of seventeen (17). PLUS passes are **NOT** available for purchase at the event.

WGI does not offer any type of director or bus driver hospitality at regional championship events. Please be sure to take care of your drivers and staff.

**Per arena guidelines all backpacks, purses, etc. may be searched prior to entry.**

### Regional Contact Info

*Contest Administrator*

Jamie Rightmyer  
Jamie@wgi.org  
585-721-8715

### General Info

WGI Office  
office@wgi.org  
937-247-5919 x 305

### Judges

Panels will be available in this packet.

### General Contest Info

**TO LISTEN TO JUDGES COMMENTARY:** Each director should be set up with an account through CompetitionSuite. This is the only way to receive judge's commentary for any WGI event. Instructions to do this are available [here](#).

**VIDEOS:** No video cameras will be allowed in any contest venue and no authorized space will be provided for groups to record their performance. Any liability associated with unauthorized recordings will rest with the individual or organization making the recording. WGI does not condone, nor accept any liability for, any unauthorized recording during the event.

**BUS/TRUCK PARKING:** Bus and truck parking is off site at Northeast Middle School. A shuttle will run approx every 15 minutes to shuttle your bus/truck drivers to Liberty High School.

**WARM-UP AREA:** All maps are located in this packet. Color guards need to check in at least one hour prior to performance time. There is to be no music in warm up as it is shared warm up space and will disturb the other guard in the area.

**PRELIM SCORES:** Posted in concession area on main concourse.

**GROUP SUMMARY SHEETS AND RECAPS:** Available on CompetitionSuite.com

**CRITIQUE:** Only those groups attending the 2019 World Championships will be afforded the opportunity for a critique. An email was sent to all primary and secondary contacts regarding signing up before schedules were posted. Critique schedule will be available in this packet once it has been finalized.

**FINALS SCHEDULE:** The finals schedule will be made available on WGI.org after it has been determined. All open and world class color guards must make qualifying score to progress to finals. Qualifying scores are listed in the regional reminders below.

**SOUND CHECK:** One hour prior to the start of the contest and during breaks at the discretion of the Contest Administrator. If you choose to use the new music upload feature available in CompetitionSuite, WGI suggests you still do a sound test. Information regarding music uploads is available in the Regional Reminders.

**PRACTICE SITES:** Color guards making practice arrangements through the regional committee must settle their invoice at color guard check in upon arrival on Saturday.

**PLEASE NOTE:** WGI has adopted and will enforce a **NO SMOKING** policy at all WGI Regionals, including practice facilities.

Don't forget to review the [Regional Reminders!](#)



### Winter Guard International

2405 Crosspointe Drive, Dayton, OH 45342 Phone: 937-247-5919 Fax: 937-247-9212 Email: office@wgi.org <http://www.wgi.org>



## WGI East Power Regional Judge Panels

### Prelims

	Equipment	Movement	Design Analysis	General Effect	
SA/IO Prelims	Robert Solomon	Patty Beggy	Jim Sturgeon	Paul Lampkin	Michael Pavlock
IA/SO/World	Kim Presley	Jeff Stewart	Tom Slaughter	Damon Padilla	Dale White

### Finals

	Equipment	Movement	Design Analysis	General Effect	
All Finals	Robert Solomon	Patty Beggy	Jim Sturgeon	Paul Lampkin	Michael Pavlock
	Kim Presley	Jeff Stewart	Tom Slaughter	Damon Padilla	Dale White

**T&P**

Jeff Krywinski
----------------

**Lead Judge**

Shirley Dorritie
------------------

## WGI East Power Regional Critique Schedule



Group Name	Hometown	Class	Critique Time
Liverpool HS	Liverpool, NY	SA	3:20 PM
West Orange HS	West Orange, NJ	SA	3:20 PM
Mohonasen HS	Schenectady, NY	SA	3:20 PM
Haddon Heights HS	Haddon Heights, NJ	SA	3:20 PM
Bethel HS	Bethel, CT	SA	3:32 PM
Greater Johnstown HS	Johnstown, NY	SA	3:32 PM
Council Rock HS South	Holland, Pa	SA	3:32 PM
Methacton HS	Eagleville, PA	SA	3:32 PM
Spring-Ford Area HS	Royersford, PA	SA	3:44 PM
Unionville HS	Kennett Square, PA	SA	3:44 PM
Hempfield HS	Landisville, PA	SA	3:44 PM
Urbana HS	Ijamsville, MD	SA	3:44 PM
Central Square HS	Central Square, NY	SA	3:56 PM
West Milford HS	West Milford Township, NJ	SA	3:56 PM

**SA Critique Concludes**

**4:08 PM**

Group Name	Hometown	Class	Critique Time
St. Johns Productions	Cambridge, MA	IO	8:10 PM
George Mason University Winterguard	Fairfax, Virginia	IO	8:10 PM
Field of View	West Chester, PA	IO	8:10 PM
Top Hats	Pittsburgh, PA	IO	8:10 PM
Sacred Heart University Winter Guard	Fairfield, CT	IO	8:22 PM
Blessed Sacrament	Cambridge, MA	IO	8:22 PM
Les Eclipses	Longueuil, Quebec, Canada	IO	8:22 PM
Main Line Independent	Wayne, PA	IO	8:22 PM
Delazure	Newark, DE	IO	8:34 PM
Q	East Stroudsburg, PA	IO	8:34 PM

**IO Critique Concudes**

**8:46 PM**

Group Name	Hometown	Class	Critique Time
St. Ann's	Neponset, MA	IA	6:45 PM
Surge Independent	Haddon Heights, NJ	IA	6:45 PM
Gates Chili Independent Winter Guard	Gates Chili, NY	IA	6:45 PM
AMP	Camden, NJ	IA	6:45 PM
3rd Legend	St-Eustache, Quebec	IA	6:57 PM
Revolutionary WinterGuard	Virginia Beach, VA	IA	6:57 PM
Westshoremen	Harrisburg, PA	IA	6:57 PM
Norwalk HS	Norwalk, CT	SO	6:57 PM
West Shore School District	Lewisberry, PA	SO	7:09 PM
Arlington HS	LaGrangeville, NY	SO	7:09 PM
South Brunswick HS	South Brunswick, NJ	SO	7:09 PM
Cumberland Valley HS	Mechanicsburg, PA	SO	7:09 PM
Orchard Park HS	Orchard park, NY	SO	7:21 PM
Phoenix HS	Phoenix, NY	SO	7:21 PM
Dartmouth HS	Dartmouth, Massachusetts	SO	7:21 PM

**IA/SO Critique Concludes**

**7:33 PM**

Group Name	Hometown	Class	Critique Time
North Syracuse Central HS	Cicero, NY	SW	9:35 PM
Trumbull HS	Trumbull, CT	SW	9:35 PM
Shenendehowa HS	Clifton Park, NY	SW	9:35 PM
Emanon	Hackettstown, NJ	IW	9:35 PM
AMP Winter Guard	Camden, NJ	IW	9:51 PM
The Brigadiers	Syracuse, NY	IW	9:51 PM
Alter Ego	West New York, New Jersey	IW	9:51 PM
Fusion Winter Guard	Clifton, NJ	IW	9:51 PM

**SW/IW Critique Concludes**

**10:07 PM**

*To be eligible for critique at a Power Regional, your group must be registered for the 2019 World Championships and you must have signed up for critique in advance.*

*Please notify the Contest Administrator if you are unable to attend in a timely manner. Failure to do so may result in your color guard forfeiting critique opportunities for the remainder of the season.*



## Accessing Judge Commentary

**You must have already activated your Competition Suite Account Profile in order for you to be able to listen to WGI judge commentary.**

### **From a Smart phone:**

Download the Commentary app:

- Apple: <https://itunes.apple.com/us/app/competitionsuite-commentary/id594112091?ls=1&mt=8>
- Android: <https://play.google.com/store/apps/details?id=com.competitionsuite.commentary>

### **From the website:**

1. Visit <http://competitionsuite.com/login/> and log in using the password you set up in your CompetitionSuite profile.
2. Click on "Performances" on the left side of the page under your group's name.
3. Click on the appropriate commentary file you'd like to download or listen to.

### **Support**

If you have questions, feel free to contact support at [help@competitionsuite.com](mailto:help@competitionsuite.com).



# WGI East Power Regional Liberty High School

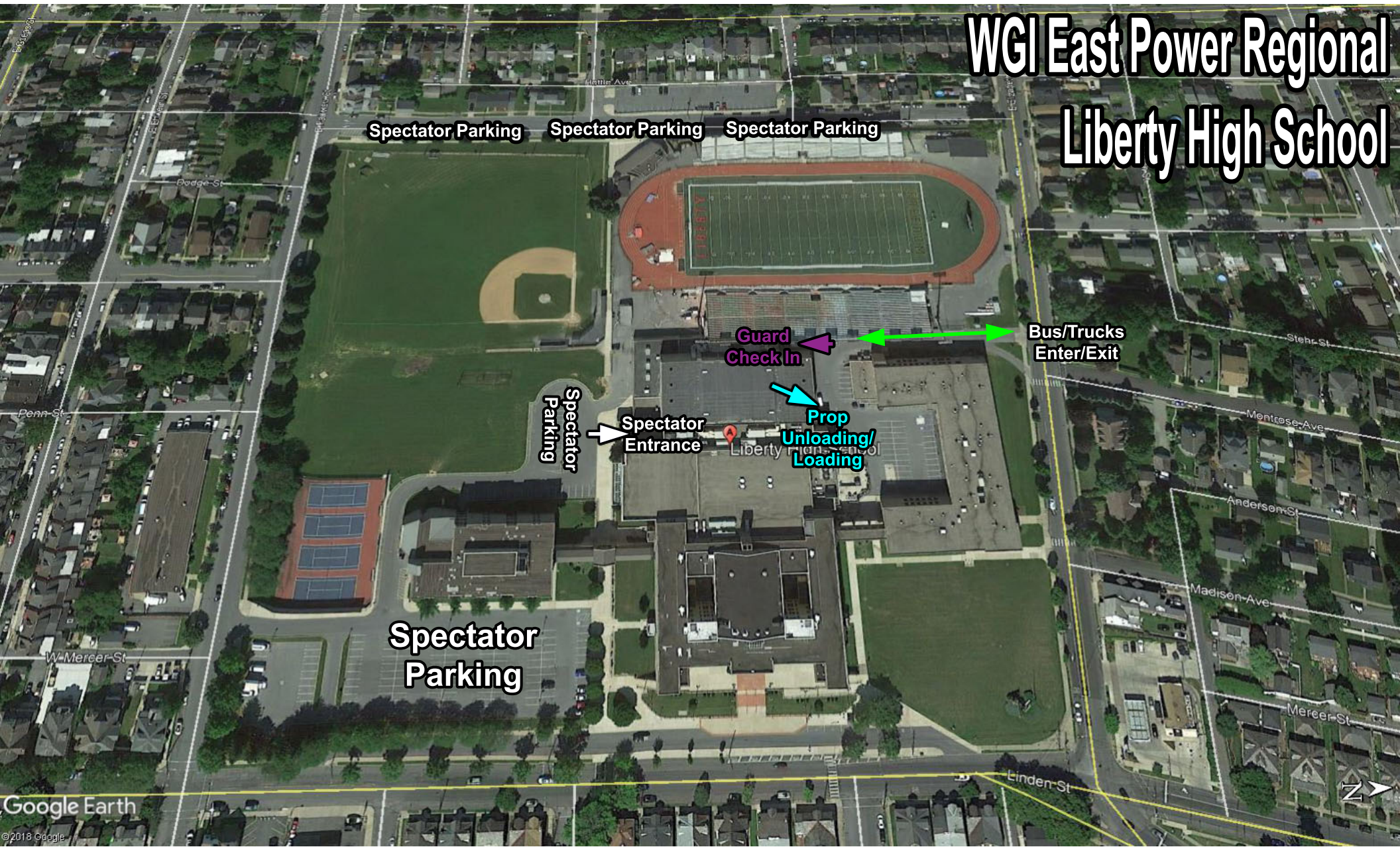

# WGI East Power Regional Liberty High School

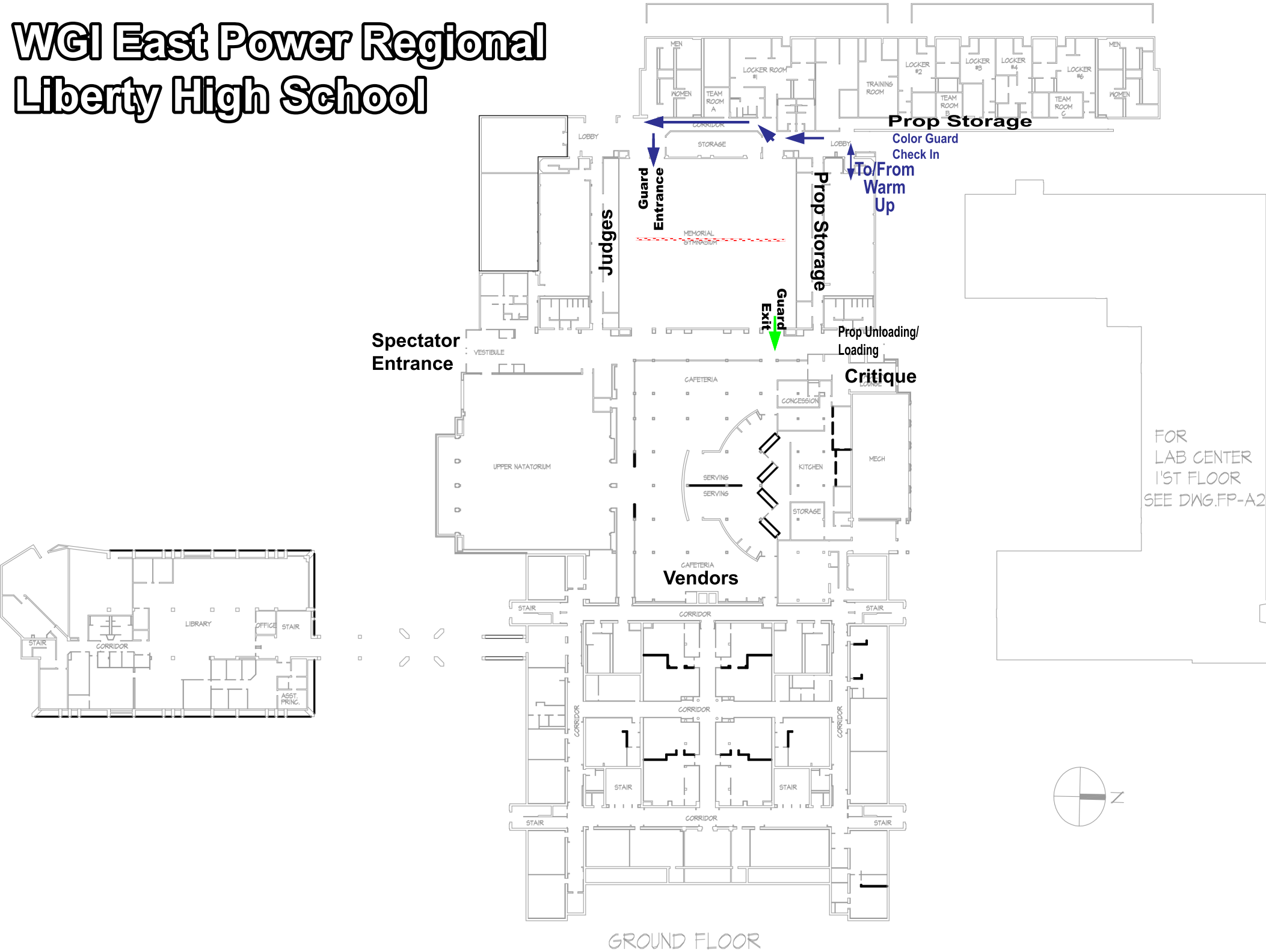



# WGI East Power Regional Liberty High School

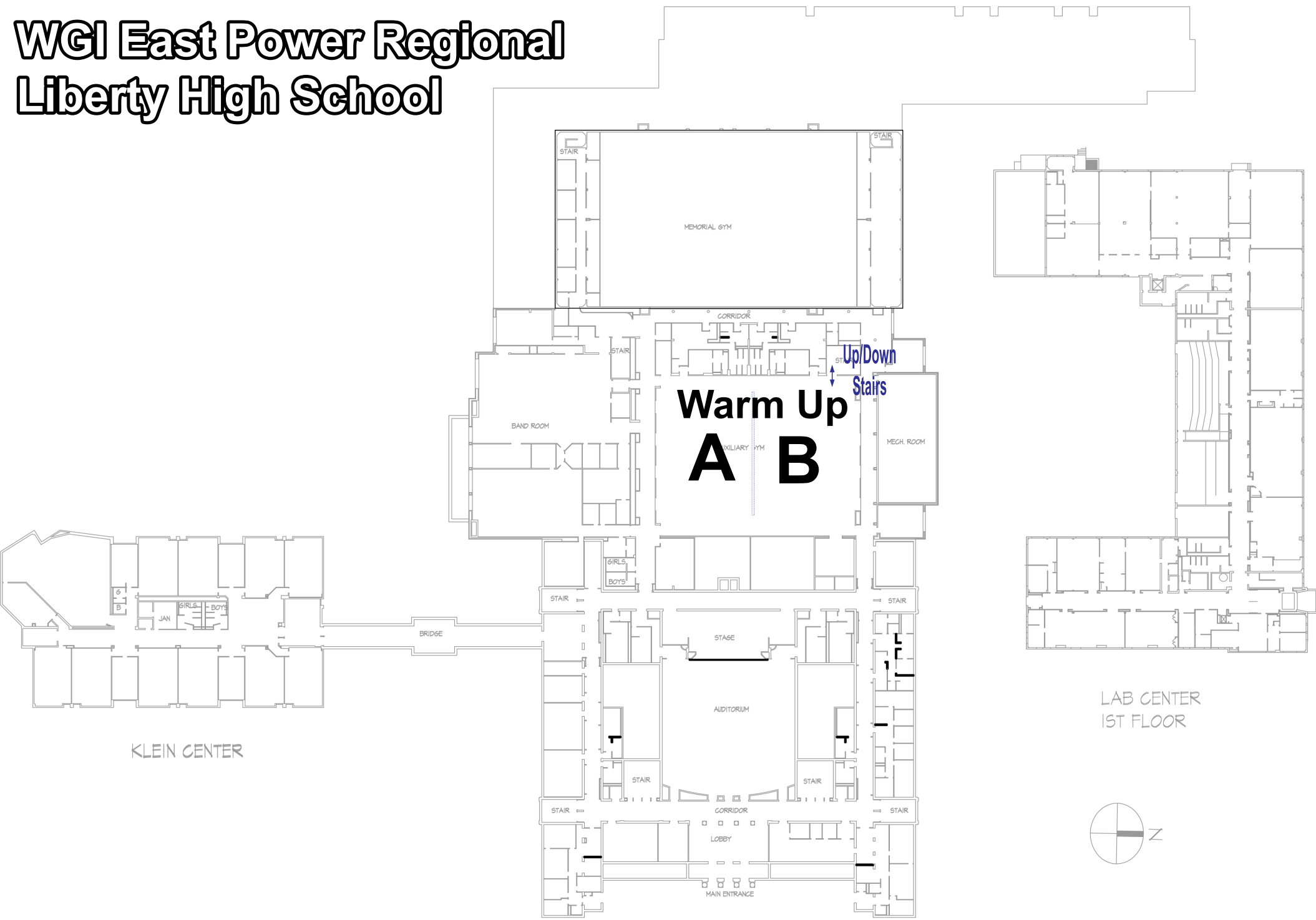

1ST FLOOR PLAN

## Directions from Liberty High School to Northeast Middle School

**As you leave the Prop Drop Off area turn right on to Elizabeth Avenue**  
**Turn right onto Linden Street**  
**Turn left onto East Locust Street**  
**Turn left onto Fernwood Street and Northeast Middle School is on the right.**







## East Power Regional Competition Area Liberty HS, Bethlehem, PA

All WGI contest sites must have a minimum of seventy by one hundred feet (70' x 100') to accommodate a "safety zone" of five (5) feet from any spectator seating. If no spectators are seated on the left and right sides, then the safety zone will be eliminated on the left and right sides of the competition area and can extend to a maximum of 106'X 78'.

The "competition area" at this event measures 100'X 70'. All performing groups must be prepared to perform within that area. Floors (tarps) may not extend into the safety zones per rules found in the WGI Adjudication Manual and Rulebook.

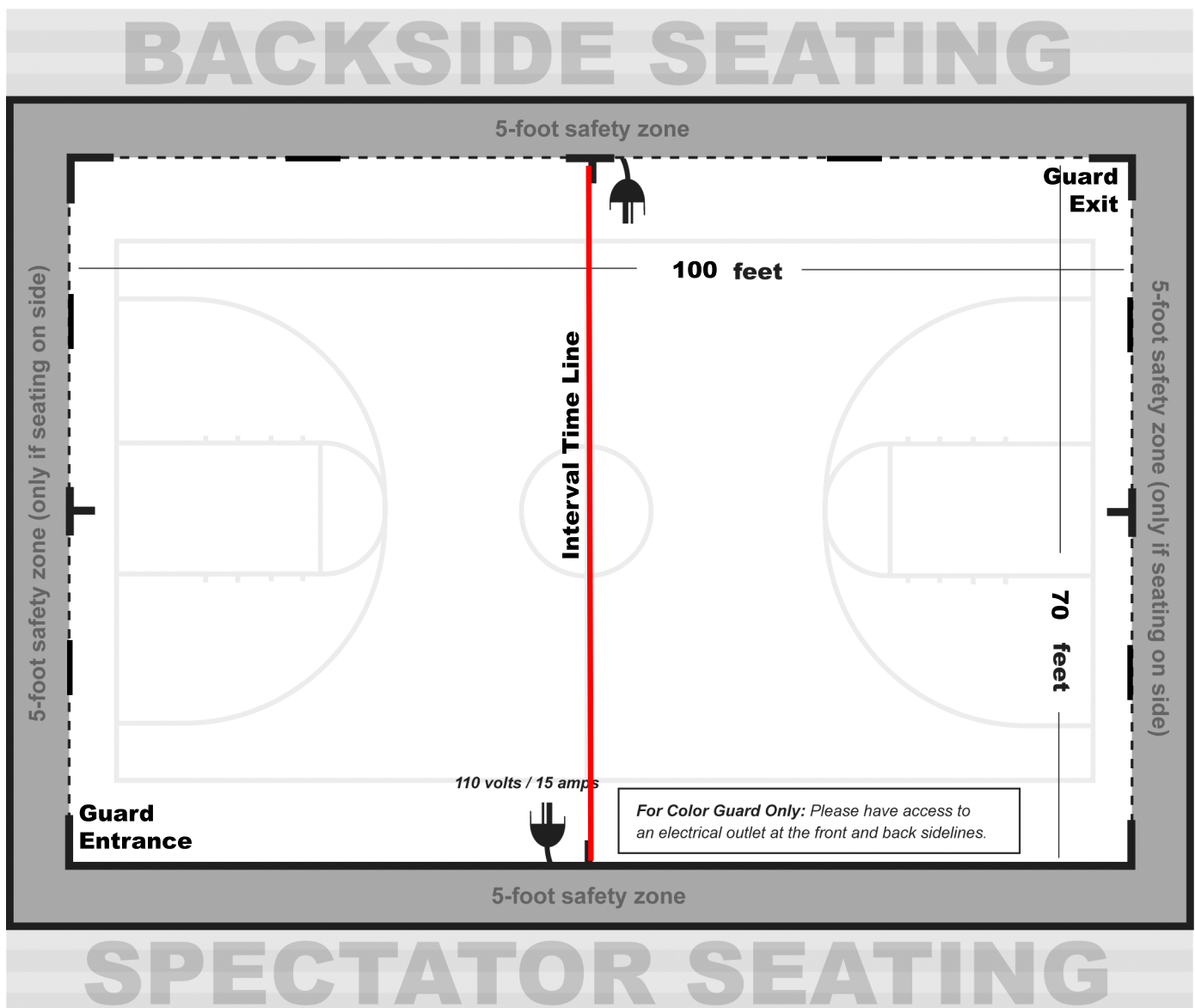

## ***From the 2019 WGI Policy Manual***

### **4.120 Sound Policy (Color Guard)**

- All color guards should do a sound check at the designated times provided in the contest information packet to ensure the playability of any device or CD. Color guards should check the soundtrack at multiple places in the music to verify playability of any device
- Color guards should still do a sound check if they are using the WGI Music Upload in CompetitionSuite to ensure everything is correct.
- Color guard is responsible for providing the method that the music will be played, e.g. CD, MP3, computer, etc. Each color guard should have two methods to play their soundtrack in the event one does not work.
- Color guard must provide their music in a timely manner to the designated sound operator. Any delay in providing music is the responsibility of the color guard.
- Color guards using the Music Upload process through CompetitionSuite should have a backup using another device type such as an MP3 player, iPhone, or CD.
- Color guard must have a designated person at the sound table to operate any device provided to play music such as MP3 players or computers. Guard's representative is responsible to set up and play device. If a CD is provided, the color guard representative must instruct the sound operator as to what track or other relevant information is needed to start the music when directed by the contest Timing and Penalty judge or after the color guard's introduction.
- If the color guard has an issue with the music such as music is too soft, it begins in the wrong place or skips, the color guard's representative must make the decision to stop the music and tell the operator to stop the music. If the color guard representative chooses not to stop and the color guard completes their performance, the color guard will not be offered an opportunity to perform again.
- Interval timing will continue as the color guard resets and begins again. The Contest Administrator has the sole discretion in waiving any timing penalty due to the restart. If the stoppage is due to faulty sound equipment, operator error or an unexplained reason, overtime penalty may be waived.
- Issues related to the equipment provided by the color guard, quality of the CD or the color guard's representative error (using wrong playlist on MP3, etc.) will result in the actual interval timing being used and penalties, if any, being assessed.
- Volume direction must come from the color guard representative at the sound table. Direction will not be taken from the audience viewing area or across the floor. Final volume discretion is given to the sound operator based on their equipment and the Chief Judge who ultimately determines an appropriate volume level.
- The color guard representative may provide direction to the sound operator during the performance regarding equalization.
- It is the responsibility of the color guard to provide their music for each performance and to ensure that their soundtrack is working appropriately. CDs may not be left at sound table between performances.
- Under no circumstances will verbal abuse of the sound operator be tolerated. Penalties will be assessed per current WGI rules