



# IMPORTANT HEALTH & SAFETY UPDATES

# MASKS REQUIRED

## WGI TRUMBULL PERCUSSION REGIONAL

**EVERYONE IN ATTENDANCE AT THIS REGIONAL MUST WEAR A MASK.**

Performers may remove their mask while on the performance floor.

*Those who choose not to follow this mask mandate may be asked to leave without a refund or the group may be disqualified.*

**THERE COULD BE DIFFERENT PROTOCOLS AT EACH WGI EVENT, PLEASE READ THROUGH ALL INFORMATION CAREFULLY.**

# **TRUMBULL PERCUSSION REGIONAL CONTEST INFORMATION**

## **SATURDAY, FEBRUARY 26, 2022**



---

### **LOCATION**

Trumbull High School  
72 Strobel Road  
Trumbull, CT 06611

---

### **EMERGENCY CONTACTS (DAY OF SHOW ONLY)**

CONTEST ADMINISTRATOR: HEATHER KAYNES – 651.336.0292 / [HEATHER@WGI.ORG](mailto:HEATHER@WGI.ORG)  
EVENT PARTNER: JOSH MURPHY – 860.331.6365 / [JMURPHY@TRUMBULLPS.ORG](mailto:JMURPHY@TRUMBULLPS.ORG)

---

### **JUDGE PANEL**

Effect Music – Ed Argenziano  
Effect Visual – Blair Kuhn  
Music – Jeff Prosperie  
Visual – Jay McArthur  
T&P – Bob Molloy

---

### **COMPETITIONSUITE DETAILS**

ACCESSING YOUR GROUP - <https://help.competitionsuite.com/article/16-accessing-your-group>

ADDING YOUR STAFF - <https://help.competitionsuite.com/article/61-adding-staff-members>

ACCESSING COMMENTARY - <https://help.competitionsuite.com/article/17-accessing-commentary>

*Score Summary Sheets are also located in your CompetitionSuite account with your overall score.*

---

### **ADDITIONAL REGIONAL INFO**

PRELIMS LOGISTICAL SCHEDULE – [HTTPS://TINYURL.COM/YE84K7ZF](https://tinyurl.com/ye84k7zf)

FINALS LOGISTICAL SCHEDULE – [HTTPS://TINYURL.COM/2P8FXPHV](https://tinyurl.com/2p8fxphv)

CRITIQUE – TWO (2) STAFF MEMBERS PER GROUP ARE ALLOWED IN THE CRITIQUE ROOM. MASKS ARE REQUIRED.

RETREAT – EACH GROUP MAY DESIGNATE ONE INDIVIDUAL TO REPRESENT THE GROUP ON THE FLOOR DURING RETREAT. YOUR GROUP IS NOT ATTENDING RETREAT, PLEASE DESIGNATE ONE INDIVIDUAL (PARENT, STAFFER, OR DESIGNATED REPRESENTATIVE) TO STAY AND RETRIEVE YOUR AWARD AT THE CONCLUSION OF RETREAT. PLEASE INFORM THE CONTEST ADMINISTRATOR ON SITE IF YOUR GROUP WILL NOT BE ATTENDING RETREAT.

REGIONAL REMINDERS - <https://wgi.org/wp-content/uploads/2022/01/2022-Perc-WindsRegionalReminders.pdf>

Winter Guard International, Inc.

1994 Byers Rd, Miamisburg, OH 45342/ Phone: 937-247-5919/ Fax: 937-247-9212/ Email: [office@wgi.org](mailto:office@wgi.org) Web: <http://wgi.org>

# WGI TRUMBULL REGIONAL TRUMBULL HIGH SCHOOL

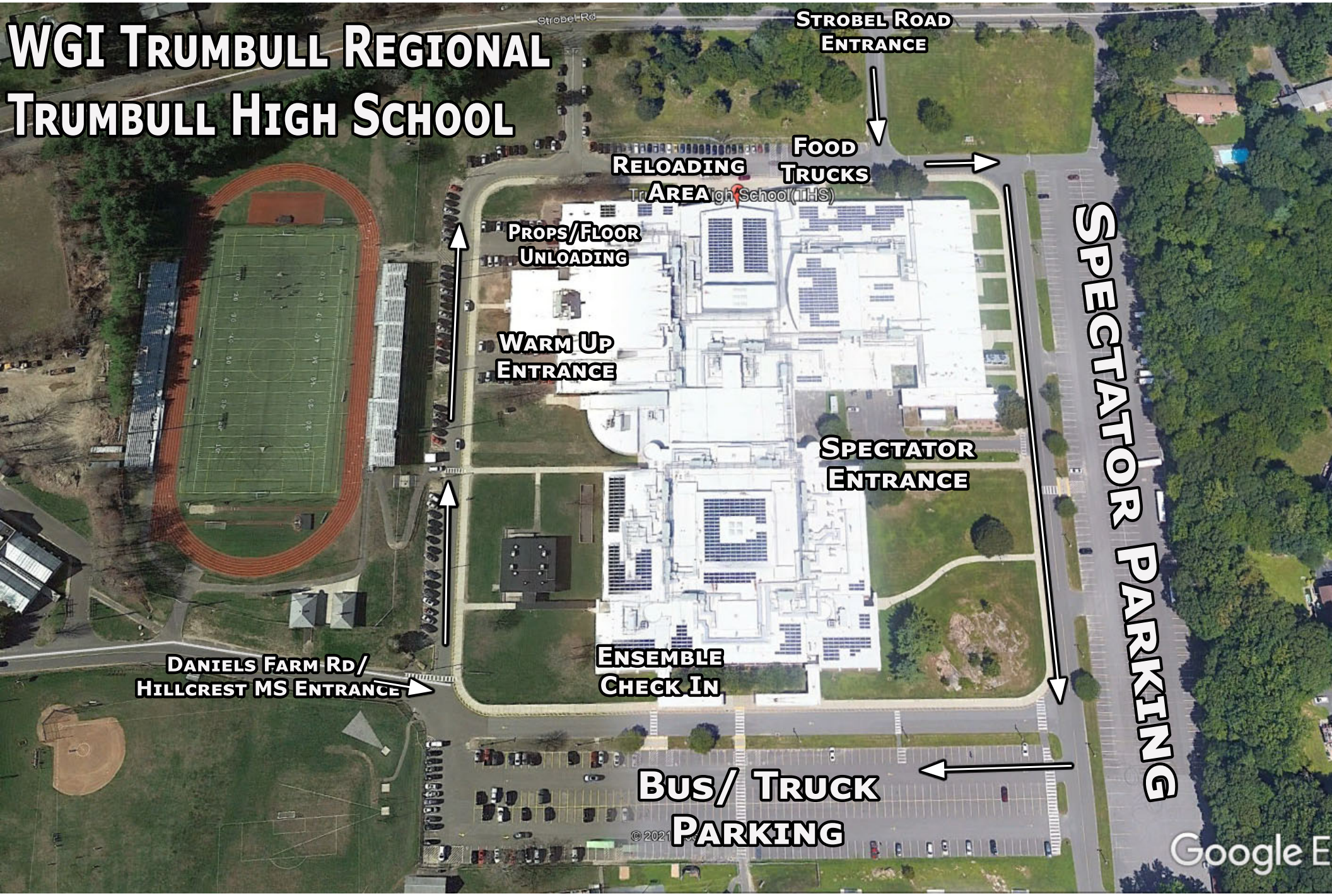

© 2021

Google E

# WGI Trumbull Regional Trumbull High School

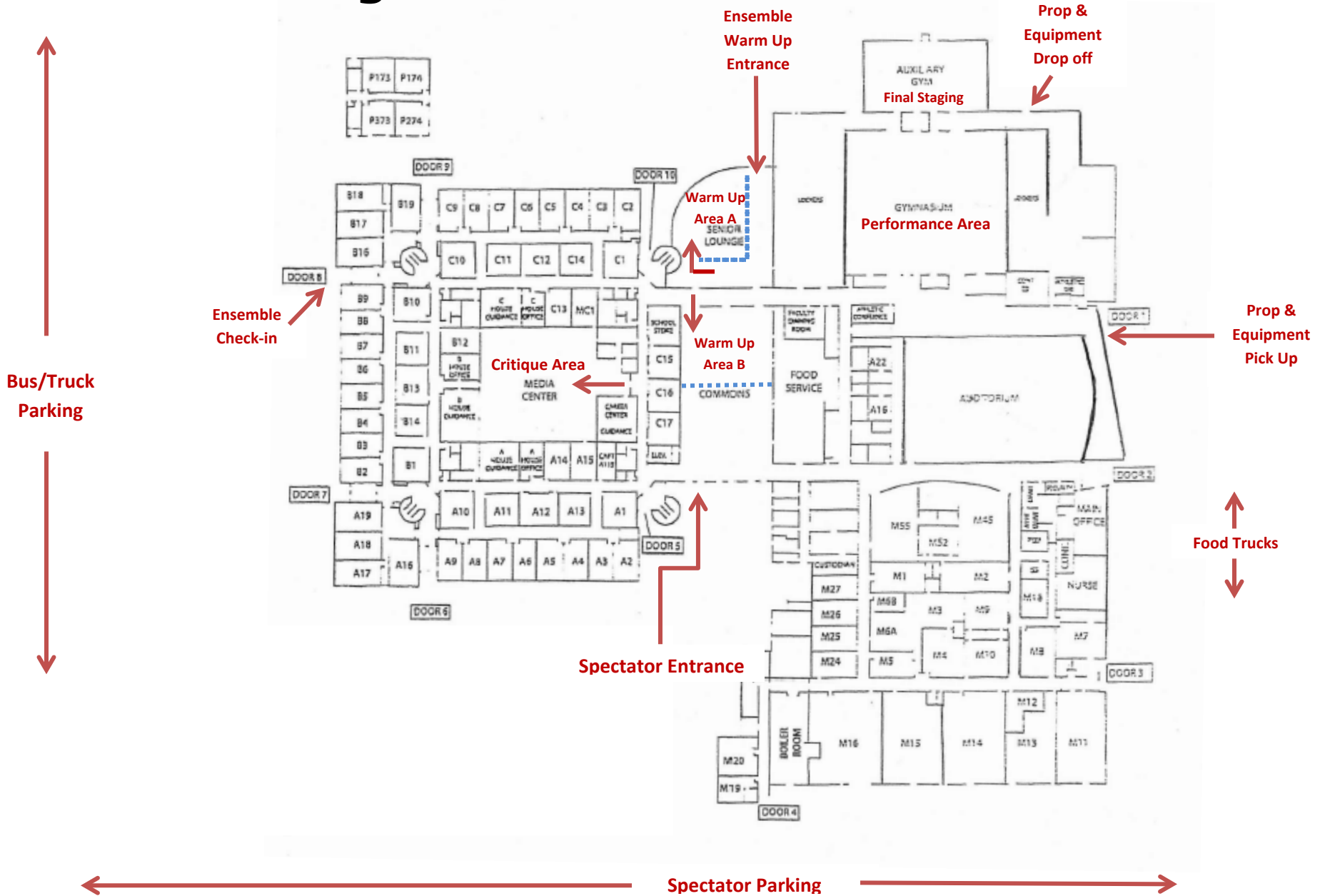



## Trumbull Regional Competition Area Trumbull High School, Trumbull, CT

All WGI contest sites must have a minimum of seventy by one hundred feet (70' x 100') to accommodate a "safety zone" of five (5) feet from any spectator seating. If no spectators are seated on the left and right sides, then the safety zone will be eliminated on the left and right sides of the competition area and extend to the wall.

The "competition area" at this event measures 70'X106'. All performing groups must be prepared to perform within that area. Floors (tarps) may not extend into the safety zones per rules found in the WGI Adjudication Manual and Rulebook

