

THERE COULD BE DIFFERENT PROTOCOLS AT EACH WGI EVENT, PLEASE READ THROUGH ALL INFORMATION CAREFULLY.

INDIANPOLIS PERCUSSION

REGIONAL CONTEST INFORMATION

SATURDAY - SUNDAY, MARCH 5 - 6, 2022



LOCATION

Franklin Central High School
6215 South Franklin Road
Indianapolis, IN 46259

EMERGENCY CONTACTS (DAY OF SHOW ONLY)

CONTEST ADMINISTRATOR: BRIAN JOHNSON - / BRIANJ@WGI.ORG

EVENT PARTNER: EVAN COOPER - 317.362.9663 / EVAN.COOPER@FTCSC.ORG

JUDGE PANEL

See Pages 2 and 3

COMPETITIONSUITE DETAILS

ACCESSING YOUR GROUP - <https://help.competitionsuite.com/article/16-accessing-your-group>

ADDING YOUR STAFF - <https://help.competitionsuite.com/article/61-adding-staff-members>

ACCESSING COMMENTARY - <https://help.competitionsuite.com/article/17-accessing-commentary>

Score Summary Sheets are also located in your CompetitionSuite account with your overall score.

ADDITIONAL REGIONAL INFO

PRELIMS LOGISTICAL SCHEDULE - [HTTPS://TINYURL.COM/Y2M3NPDJ](https://tinyurl.com/Y2M3NPDJ)

FINALS LOGISTICAL SCHEDULE - [HTTPS://TINYURL.COM/22H8BXM9](https://tinyurl.com/22H8BXM9)

CRITIQUE - Two (2) STAFF MEMBERS PER GROUP ARE ALLOWED IN THE CRITIQUE ROOM. MASKS ARE REQUIRED

RETREAT - EACH GROUP MAY DESIGNATE ONE INDIVIDUAL TO REPRESENT THE GROUP ON THE FLOOR DURING RETREAT. **MASKS ARE RECOMMENDED.** IF YOUR GROUP IS NOT ATTENDING RETREAT, PLEASE DESIGNATE ONE INDIVIDUAL (PARENT, STAFFER, OR DESIGNATED REPRESENTATIVE) TO STAY AND RETRIEVE YOUR AWARD AT THE CONCLUSION OF RETREAT. PLEASE INFORM THE CONTEST ADMINISTRATOR ON SITE IF YOUR GROUP WILL NOT BE ATTENDING RETREAT.

REGIONAL REMINDERS - <https://wgi.org/wp-content/uploads/2022/01/2022-Perc-WindsRegionalReminders.pdf>

Winter Guard International, Inc.

1994 Byers Rd, Miamisburg, OH 45342/ Phone: 937-247-5919/ Fax: 937-247-9212/ Email: office@wgi.org Web: <http://wgi.org>

**THERE COULD BE DIFFERENT PROTOCOLS AT EACH WGI EVENT, PLEASE READ
THROUGH ALL INFORMATION CAREFULLY.**



2022 INDIANAPOLIS JUDGE PANELS

PRELIMS

Panel 1 – PSA, PIA, PIO, PSW

Effect-Music – Marc Whitlock

Effect-Visual – Bobby Jones

Music – Jeff Ausdemore

Visual – Dave McCarthy

T&P – Adam Hall

PSA and PIA Overview Commentary – Sean Vega

PSA and PIA Critique to begin at 1:45 PM

PIO and PSW Critique to begin at 7:30 PM

Panel 2 – Concert, PSO, PIW

Effect-Music – Ray Ulibarri

Effect-Visual – Michael Gaines

Music – Mike Leitzke

Visual – Bret Mascaro

T&P – Jerrod Fry

PSO and PIW Overview Commentary – Sean Vega

Concert and PSO Critique to begin at 4:15 PM

PIW Critique to begin at 8:25 PM

**THERE COULD BE DIFFERENT PROTOCOLS AT EACH WGI EVENT, PLEASE READ
THROUGH ALL INFORMATION CAREFULLY.**



2022 INDIANAPOLIS JUDGE PANELS

FINALS

**Panel 1 – Concert, PSO, PIW
Effect-Music – Marc Whitlock
Effect-Visual – Bobby Jones
Music – Jeff Ausdemore
Visual – Dave McCarthy
T&P – Adam Hall**

PSCA, PSCO, PSCW Overview Commentary – Sean Vega

**Panel 2 – PSA, PIA, PIO, PSW
Effect-Music – Ray Ulibarri
Effect-Visual – Michael Gaines
Music – Mike Leitzke
Visual – Bret Mascaro
T&P – Jerrod Fry**

PIO, PSW, PIW Overview Commentary – Sean Vega

Franklin Central High School

6215 S Franklin Rd
Indianapolis, IN 46259



Franklin Central High School

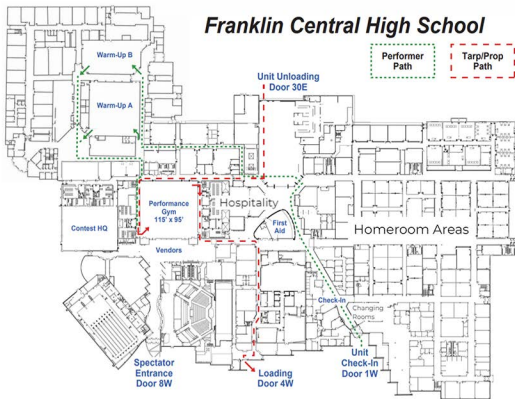

PERFORMANCE GYM LAYOUT

Backside Seating (for performers only)

Unit
Entrance

(groups may enter from either corner)

Unit
Entrance

↓ **HORIZONTAL** ↓

↓ **TIMELINE** ↓

Unit Exit

Spectator Seating



Indianapolis Regional Competition Area Franklin Central High School, Indianapolis, IN

All WGI contest sites must have a minimum of seventy by one hundred feet (70' x 100') to accommodate a "safety zone" of five (5) feet from any spectator seating. If no spectators are seated on the left and right sides, then the safety zone will be eliminated on the left and right sides of the competition area and extend to the wall.

The "competition area" at this event measures 72'X106'. All performing groups must be prepared to perform within that area. Floors (tarps) may not extend into the safety zones per rules found in the WGI Adjudication Manual and Rulebook

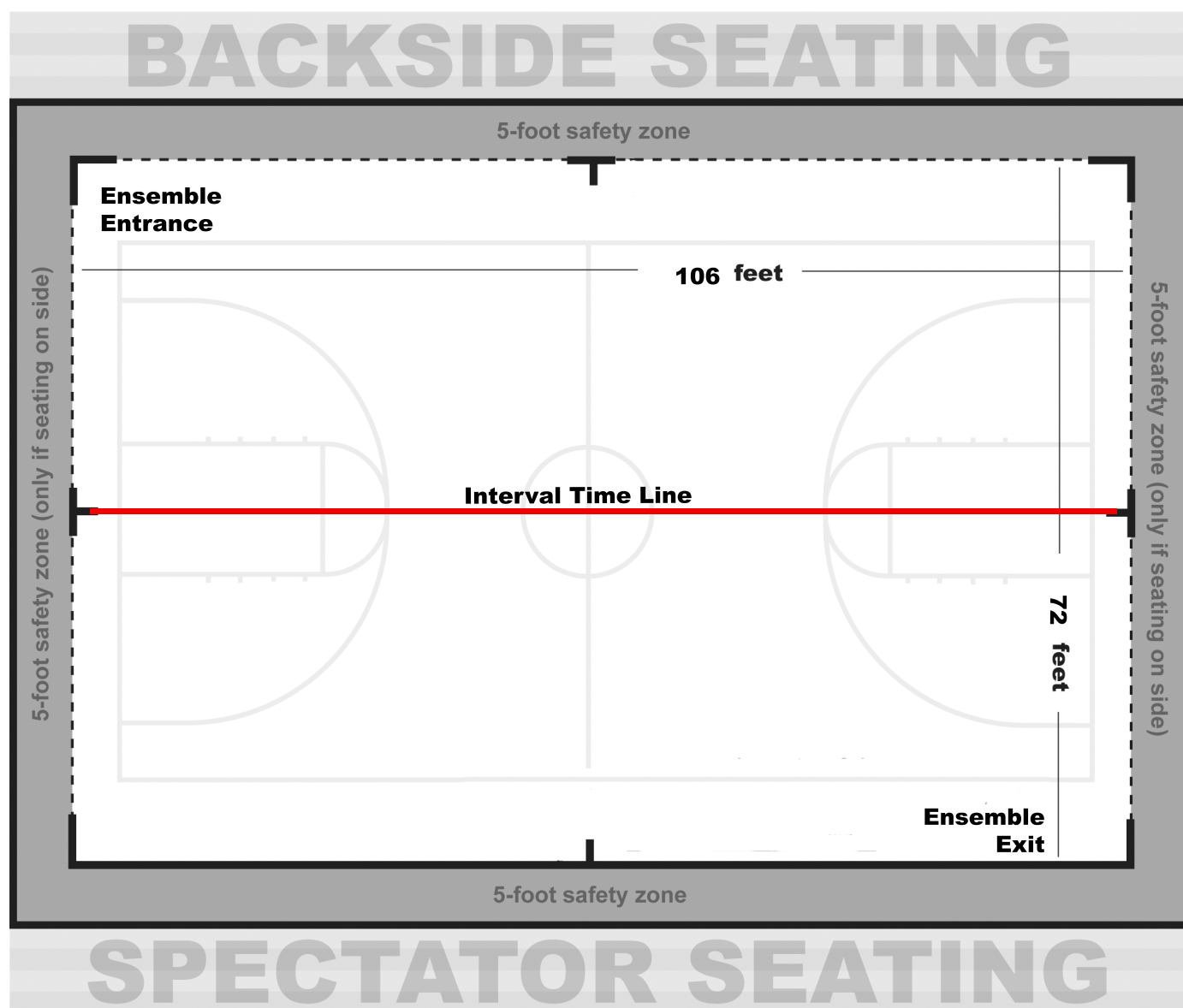

FLOMARCHING

**This event will be
webcast LIVE on
FloMarching**

**For more info visit
WGI.org/webcast**

