

INDIANAPOLIS COLOR GUARD REGIONAL CONTEST INFORMATION IA/SO/IO/SW/IW PRELIMS ALL CLASS FINALS

SATURDAY & SUNDAY, FEBRUARY 15 & 16, 2020



LOCATION

Avon High School
7575 East County Road 150 South
Avon, IN 46123

EMERGENCY CONTACTS (*DAY OF SHOW ONLY*)

CONTEST ADMINISTRATOR: Brian Johnson/ 651-231-7799 / BrianJ@wgi.org

EVENT PARTNER: Cathy Klemmensen / 317-502-5845 / CMKlemmensen@avon-schools.org

PRACTICE CONTACT: Ed Meckes/ 317-691-9150 / emeckes@warren.k12.in.us

JUDGE PANEL

Listed below

COMPETITIONSUITE DETAILS

ACCESSING YOUR GROUP - <https://help.competitionsuite.com/article/16-accessing-your-group>

ADDING YOUR STAFF - <https://help.competitionsuite.com/article/61-adding-staff-members>

ACCESSING COMMENTARY - <https://help.competitionsuite.com/article/17-accessing-commentary>

MUSIC UPLOADS - <https://help.competitionsuite.com/article/74-uploading-performance-music>

Score Summary Sheets are also located in your CompetitionSuite account with your overall score.

ADDITIONAL REGIONAL INFO

PRELIMS LOGISTICAL SCHEDULE - <https://tinyurl.com/t5rabcg>

FINALS LOGISTICAL SCHEDULE - <https://tinyurl.com/yx3xdtt3>

WARM UP AREAS – Music may not be used in the warm up areas as it is shared space.

SCORE POSTING – Posted in the cafeteria area.

REGIONAL REMINDERS - <https://wgi.org/wp-content/uploads/2020/01/2020CGRegionalReminders.pdf>

Winter Guard International, Inc.

2405 Cross Pointe Drive, Miamisburg, OH 45342/ Phone: 937-247-5919/ Fax: 937-247-9212/ Email: office@wgi.org Web: <http://wgi.org>

INDIANAPOLIS COLOR GUARD REGIONAL CONTEST INFORMATION SRA/IRA/SA PRELIMS & SA SEMI FINALS SATURDAY, FEBRUARY 15, 2020



LOCATION

Warren Central High School
9500 East 16th Street
Indianapolis, IN 46229

For GPS address use 9651 East 21st Street, Indianapolis, IN 46229

EMERGENCY CONTACTS (DAY OF SHOW ONLY)

CONTEST ADMINISTRATOR: Eric Beaström / 715-377-6496 / Eric@wgi.org
EVENT PARTNER: Ed Meckes / 317-691-9150 / emeckes@warren.k12.in.us

JUDGE PANEL

Listed below

COMPETITIONSUITE DETAILS

ACCESSING YOUR GROUP - <https://help.competitionsuite.com/article/16-accessing-your-group>

ADDING YOUR STAFF - <https://help.competitionsuite.com/article/61-adding-staff-members>

ACCESSING COMMENTARY - <https://help.competitionsuite.com/article/17-accessing-commentary>

MUSIC UPLOADS - <https://help.competitionsuite.com/article/74-uploading-performance-music>

Score Summary Sheets are also located in your CompetitionSuite account with your overall score.

ADDITIONAL REGIONAL INFO

PRELIMS LOGISTICAL SCHEDULE - <https://tinyurl.com/slj8fxj>

SEMI FINALS LOGISTICAL SCHEDULE - <https://tinyurl.com/r7hkj8c>

WARM UP AREAS – Music is not permitted in warm up areas as it is shared space.

SCORE POSTING – Posted in the Hall of Fame

WARREN CENTRAL HIGH SCHOOL DOES NOT PERMIT ANY OUTSIDE FOOD OR BEVERAGE TO BE BROUGHT INTO THE FACILITY.

REGIONAL REMINDERS - <https://wgi.org/wp-content/uploads/2020/01/2020CGRegionalReminders.pdf>

Winter Guard International, Inc.

2405 Cross Pointe Drive, Miamisburg, OH 45342/ Phone: 937-247-5919/ Fax: 937-247-9212/ Email: office@wgi.org Web: <http://wgi.org>



Indianapolis Color Guard Regional Judge Panels

Saturday @ Warren Central HS

	<i>Equipment</i>	<i>Movement</i>	<i>Design Analysis</i>	<i>General Effect</i>	
SRA/IRA/SA Prelims SA Semis	Tim Hudnall	Beverly Brahan	Kelsey Gleason	Mike Anderson	Ted Wemhoff

T&P - Chris Tomsa
Lead Judge - Beverly Brahan

Saturday @ Avon HS

	<i>Equipment</i>	<i>Movement</i>	<i>Design Analysis</i>	<i>General Effect</i>	
IA/SO/IO/SW/IW Prelims	Jennifer Oswald	Becca Anderson	Phil Madden	Gilles Ouellette	Warren Rickart

T&P - Phil Tanner
Lead Judge - Curtis Costanza

Sunday at Avon HS

	<i>Equipment</i>	<i>Movement</i>	<i>Design Analysis</i>	<i>General Effect</i>	
SRA/IRA/IA/SA Finals	Jennifer Oswald	Becca Anderson	Phil Madden	Gilles Ouellette	Warren Rickart
SO Finals	Tim Hudnall	Beverly Brahan	Kelsey Gleason	Mike Anderson	Ted Wemhoff
IO Finals	Jennifer Oswald	Becca Anderson	Phil Madden	Gilles Ouellette	Warren Rickart
SW Finals	Tim Hudnall	Beverly Brahan	Kelsey Gleason	Mike Anderson	Ted Wemhoff
IW Finals	Jennifer Oswald	Beverly Brahan	Phil Madden	Mike Anderson	Ted Wemhoff

T&P - Phil Tanner
Lead Judge - Curtis Costanza

Avon HS Site Maps & Performance Area Info

WGI Indianapolis Color Guard Regional

Avon High School



**Bus/Truck
Entrance**

**Color Guard
Check In**

**Bus/Truck
Parking**

Avon High School

**Floor/Prop
Loading**

**Spectator
Entrance**

**Performance
Gym**

**Spectator
Parking**

**Floor/Prop
Unloading**

**NO WGI
PARKING**

Maria Ln

**To Bus/Truck
Overflow Parking**

AVON





Indianapolis Regional Competition Area Avon High School, Avon, IN

All WGI contest sites must have a minimum of seventy by one hundred feet (70' x 100') to accommodate a "safety zone" of five (5) feet from any spectator seating. If no spectators are seated on the left and right sides, then the safety zone will be eliminated on the left and right sides of the competition area and can extend to a maximum of 106'X 78'.

The "competition area" at this event measures 106'X 72'. All performing groups must be prepared to perform within that area. Floors (tarps) may not extend into the safety zones per rules found in the WGI Adjudication Manual and Rulebook.

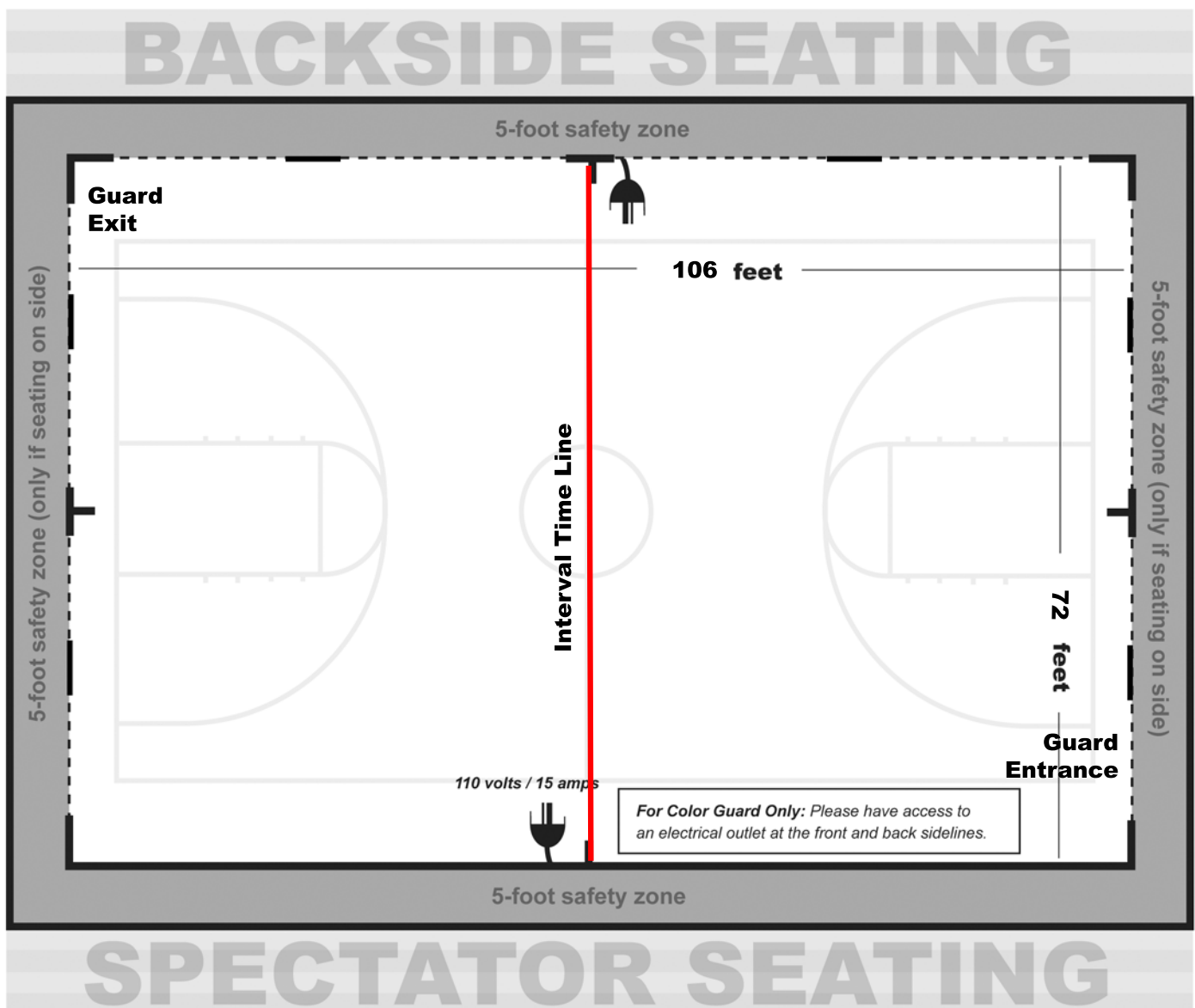

20^{WGI} 20^{I AM}



JOIN THE INDIANAPOLIS - AVON CG REGIONAL BAND!



- Free all-in-one group communication platform.
- Share group announcements via push notification, text message or email.
- Robust group calendar and membership management.
- Customizable to your unique communication needs.
- Available for your mobile device and desktop.

BAND LINK:

<https://band.us/n/a4a529K8F3Gfr>

1

Go to the Apple App Store or Google Play Store, search for BAND and download.

2

Sign up using your phone number, email, Facebook account or Google account.

3

Scan the QR code or use the link below to join the BAND.



#WGI2020

#IAMWGI

RA/SA ONLY

Warren
Central HS
Site Maps &
Performance
Area Info

WGI Indianapolis Color Guard Regional

Warren Central High School

SRA/IRA Prelims/ SA Prelims & Semis



Warren Central High School

All bus/truck traffic use
9651 East 21st Street
Indianapolis, IN 46229

Spectator
Car Entrance
ONLY

© 2014 Google

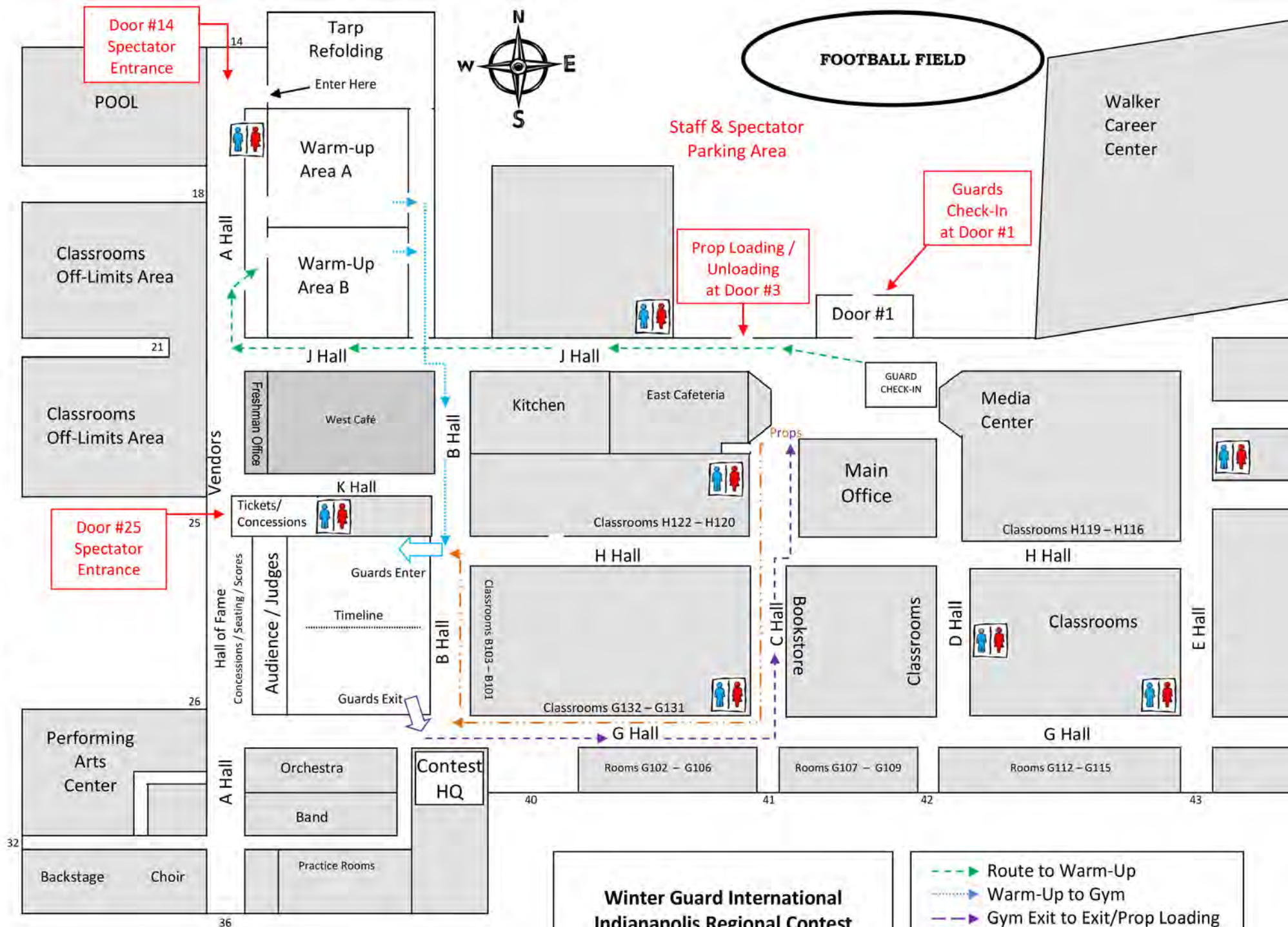

**Winter Guard International
Indianapolis Regional Contest
at Warren Central High School**

- ▶ Route to Warm-Up
- ▶ Warm-Up to Gym
- ▶ Gym Exit to Exit/Prop Loading
- ▶ Prop Staging and Route
- Restrooms

WGI Indianapolis Color Guard Regional

Warren Central High School

SRA/IRA Prelims/ SA Prelims & Semis

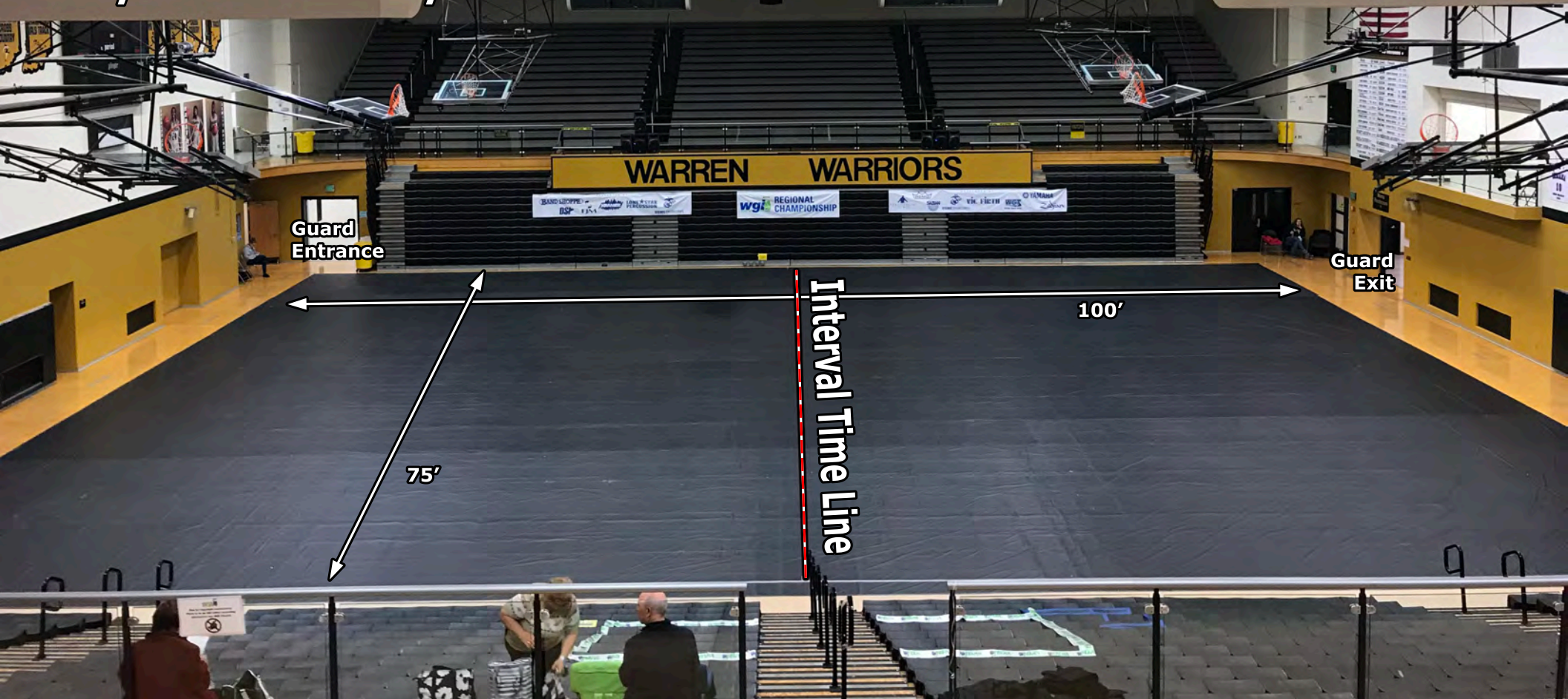



Indianapolis Regional Competition Area Warren Central High School, Indianapolis, IN

All WGI contest sites must have a minimum of seventy by one hundred feet (70' x 100') to accommodate a "safety zone" of five (5) feet from any spectator seating. If no spectators are seated on the left and right sides, then the safety zone will be eliminated on the left and right sides of the competition area and can extend to the maximum of 106'X 78'.

The "competition area" at this event measures 100'X 75'. All performing groups must be prepared to perform within that area. Floors (tarps) may not extend into the safety zones per rules found in the WGI Adjudication Manual and Rulebook.

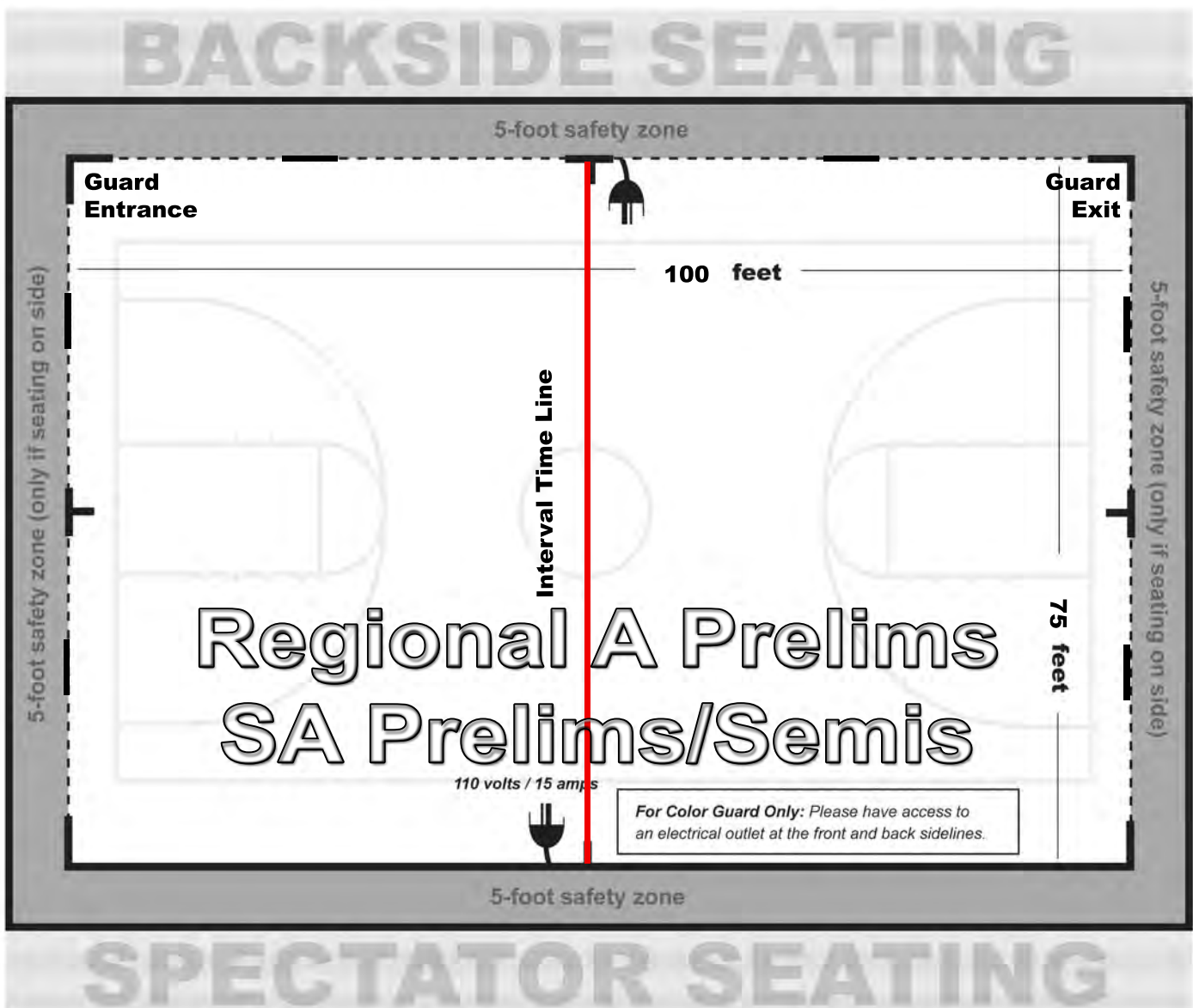

From the WGI Policy Manual

4.120 Sound Policy (Color Guard)

- All color guards should do a sound check at the designated times provided in the contest information packet to ensure the playability of any device or CD. Color guards should check the soundtrack at multiple places in the music to verify playability of any device
- Color guards should still do a sound check if they are using the WGI Music Upload in CompetitionSuite to ensure everything is correct.
- Color guard is responsible for providing the method that the music will be played, e.g. CD, MP3, computer, etc. Each color guard should have two methods to play their soundtrack in the event one does not work.
- Color guard must provide their music in a timely manner to the designated sound operator. Any delay in providing music is the responsibility of the color guard.
- Color guards using the Music Upload process through CompetitionSuite should have a backup using another device type such as an MP3 player, iPhone, or CD.
- Color guard must have a designated person at the sound table to operate any device provided to play music such as MP3 players or computers. Guard's representative is responsible to set up and play device. If a CD is provided, the color guard representative must instruct the sound operator as to what track or other relevant information is needed to start the music when directed by the contest Timing and Penalty judge or after the color guard's introduction.
- If the color guard has an issue with the music such as music is too soft, it begins in the wrong place or skips, the color guard's representative must make the decision to stop the music and tell the operator to stop the music. If the color guard representative chooses not to stop and the color guard completes their performance, the color guard will not be offered an opportunity to perform again.
- Interval timing will continue as the color guard resets and begins again. The Contest Administrator has the sole discretion in waiving any timing penalty due to the restart. If the stoppage is due to faulty sound equipment, operator error or an unexplained reason, overtime penalty may be waived.
- Issues related to the equipment provided by the color guard, quality of the CD or the color guard's representative error (using wrong playlist on MP3, etc.) will result in the actual interval timing being used and penalties, if any, being assessed.
- Volume direction must come from the color guard representative at the sound table. Direction will not be taken from the audience viewing area or across the floor. Final volume discretion is given to the sound operator based on their equipment and the Chief Judge who ultimately determines an appropriate volume level.
- The color guard representative may provide direction to the sound operator during the performance regarding equalization.
- It is the responsibility of the color guard to provide their music for each performance and to ensure that their soundtrack is working appropriately. CDs may not be left at sound table between performances.
- Under no circumstances will verbal abuse of the sound operator be tolerated. Penalties will be assessed per current WGI rules

20^{WGI} 20^{I AM}



JOIN THE INDIANAPOLIS - WARREN CENTRAL CG REGIONAL BAND!



- Free all-in-one group communication platform.
- Share group announcements via push notification, text message or email.
- Robust group calendar and membership management.
- Customizable to your unique communication needs.
- Available for your mobile device and desktop.

BAND LINK:

<https://band.us/n/a1a626K0Ff21w>

1

Go to the Apple App Store or Google Play Store, search for BAND and download.

2

Sign up using your phone number, email, Facebook account or Google account.

3

Scan the QR code or use the link below to join the BAND.



#WGI2020

#IAMWGI