

SOUTHEAST POWER REGIONAL CONTEST INFORMATION

SATURDAY & SUNDAY, MARCH 21 & 22, 2020



LOCATION

Addition Financial Arena at UCF
50 North Gemini Boulevard
Orlando, FL 32816

Per arena guidelines, all purses, backpacks, etc. are subject to search by arena personnel.

EMERGENCY CONTACTS (DAY OF SHOW ONLY)

CONTEST ADMINISTRATOR: Jeanne Strong / 720-641-3945 / Jeanne@wgi.org

JUDGE PANEL

Panels listed below.

COMPETITIONSUITE DETAILS

ACCESSING YOUR GROUP - <https://help.competitionsuite.com/article/16-accessing-your-group>

ADDING YOUR STAFF - <https://help.competitionsuite.com/article/61-adding-staff-members>

ACCESSING COMMENTARY - <https://help.competitionsuite.com/article/17-accessing-commentary>

MUSIC UPLOADS - <https://help.competitionsuite.com/article/74-uploading-performance-music>

Score Summary Sheets are also located in your CompetitionSuite account with your overall score.

ADDITIONAL REGIONAL INFO

PRELIMS LOGISTICAL SCHEDULE - <https://tinyurl.com/th6j7q6>

FINALS LOGISTICAL SCHEDULE - <https://tinyurl.com/tw4h27j>

WARM UP AREAS – Music is not permitted in body or equipment warm up as it will disturb the other guard in the area.

SCORE POSTING – Posted in the vendor area.

REGIONAL REMINDERS - <https://wgi.org/wp-content/uploads/2020/01/2020CGRegionalReminders.pdf>

Southeast Power Regional Judge Panels



Prelims

	<i>Equipment</i>	<i>Movement</i>	<i>Design Analysis</i>	<i>General Effect</i>	
SA	Kim Presley	Hieu Nguyen	Brian Murphy	Meghan McCourt	Dan Niebauer
IA	Jennifer Oswald	Becca Anderson	Dan Campbell	Mike Anderson	Michael Stone
SO	Jennifer Oswald	Becca Anderson	Dan Campbell	Mike Anderson	Michael Stone
IO	Jennifer Oswald	Becca Anderson	Dan Campbell	Mike Anderson	Michael Stone
SW	Kim Presley	Hieu Nguyen	Brian Murphy	Meghan McCourt	Dan Niebauer
IW	Kim Presley	Becca Anderson	Dan Campbell	Mike Anderson	Michael Stone

T&P - Chris Tomsa
Lead Judge - Curtis Costanza

Finals

	<i>Equipment</i>	<i>Movement</i>	<i>Design Analysis</i>	<i>General Effect</i>	
All Finals	Jennifer Oswald	Becca Anderson	Dan Campbell	Mike Anderson	Meghan McCourt
	Kim Presley	Hieu Nguyen	Brian Murphy	Dan Niebauer	Michael Stone

T&P - Chris Tomsa
Lead Judge - Curtis Costanza



WGI Southeast Power Regional Critique Schedule

Color Guard	Hometown	Class	Critique Time
Newsome HS	Lithia, FL	SA	3:30 PM
Ola HS	McDonough, GA	SA	3:30 PM
Bartram Trail HS	St. Johns, FL	SA	3:30 PM
Wiregrass Ranch HS	Wesley Chapel, FL	SA	3:30 PM
Pace HS	Pace, FL	SA	3:30 PM
Jupiter HS	Jupiter, FL	SA	3:42 PM
Fletcher HS	Neptune Beach, FL	SA	3:42 PM
Cypress Creek HS	Orlando, FL	SA	3:42 PM
Cooper City HS	Cooper City, FL	SA	3:42 PM
Timber Creek HS	Orlando, FL	SA	3:54 PM
Bartram Trail HS JV	St. Johns, FL	SA	3:54 PM
Sebastian River HS	Sebastian, FL	SA	3:54 PM

SA Critique Concludes

4:06 PM

Color Guard	Hometown	Class	Critique Time
Stoneman Douglas HS	Parkland, FL	SW	9:00 PM
Tarpon Springs HS	Tarpon Springs, FL	SW	9:00 PM
Park Vista HS	Lake Worth, FL	SW	9:00 PM
Lyman HS	Longwood, FL	SW	9:00 PM
West Broward HS	Pembroke Pines, FL	SW	9:16 PM

SW Critique Concludes

9:32 PM

Color Guard	Hometown	Class	Critique Time
Pegasus Winterguard A	Orlando, FL	IA	9:00 PM
Divenire Winter Guard	Birmingham, AL	IA	9:00 PM
FIU GOLD	Miami, FL	IA	9:00 PM
Reverie A	Atlanta, GA	IA	9:00 PM
William R Boone HS	Orlando, FL	SO	9:12 PM
Oviedo HS	Oviedo, FL	SO	9:12 PM
Lowndes HS	Valdosta, GA	SO	9:12 PM
Freedom HS (Tampa)	Tampa, FL	SO	9:12 PM
Somerset Academy	Pembroke Pines, FL	SO	9:24 PM
Fleming Island HS	Fleming Island, FL	SO	9:24 PM
Sunlake HS	Land O Lakes, FL	SO	9:24 PM
University of South Florida	Tampa, FL	IO	9:24 PM
FIU Winterguard	Miami, FL	IO	9:36 PM
Tampa Independent	Tampa, FL	IO	9:36 PM
Georgia State University Winterguard	Atlanta, GA	IO	9:36 PM
Reverie	Atlanta, GA	IO	9:36 PM

UCF Pegasus World	Orlando, FL	IW	9:48 PM
Northwest Independent	Bentonville, AR	IW	9:48 PM
Paramount	Atlanta, GA	IW	9:48 PM
First Flight	Cary, NC	IW	9:48 PM
Blessed Sacrament	Cambridge, MA	IW	10:04 PM
Relentless	Miami, FL	IW	10:04 PM

IA/SO/IO/IW Critique Concludes

10:20 PM

To be eligible for critique you must be attending the 2020 World Championships and have signed up prior to Wednesday, February 26th

If you are unable to make it to critique, please notify the Contest Administrator as soon as possible.

Those groups who do not appear for critique without notifying the CA may lose their critique opportunities in the future.

**Spectator
Parking
\$5**

**Bus/Truck
Path**

**Color Guard
Check In
Loading Dock
Garage Door**

**Performance
Arena**

**Spectator
Entrance**

Gemini Blvd N

**Bus/Truck
Parking**

**Bus/Truck
Parking**

**WGI Southeast Power Regional
CFE Arena, University of Central Florida**

Google

Imagery Date: 3/5/2016 28°36'22.45" N 81°11'49.07" W elev

© 2016 Google

1990

Body Warm Up

Equipment Warm Up

Performance Direction

Floor Exit

Floor Entrance

Pipe/Drape

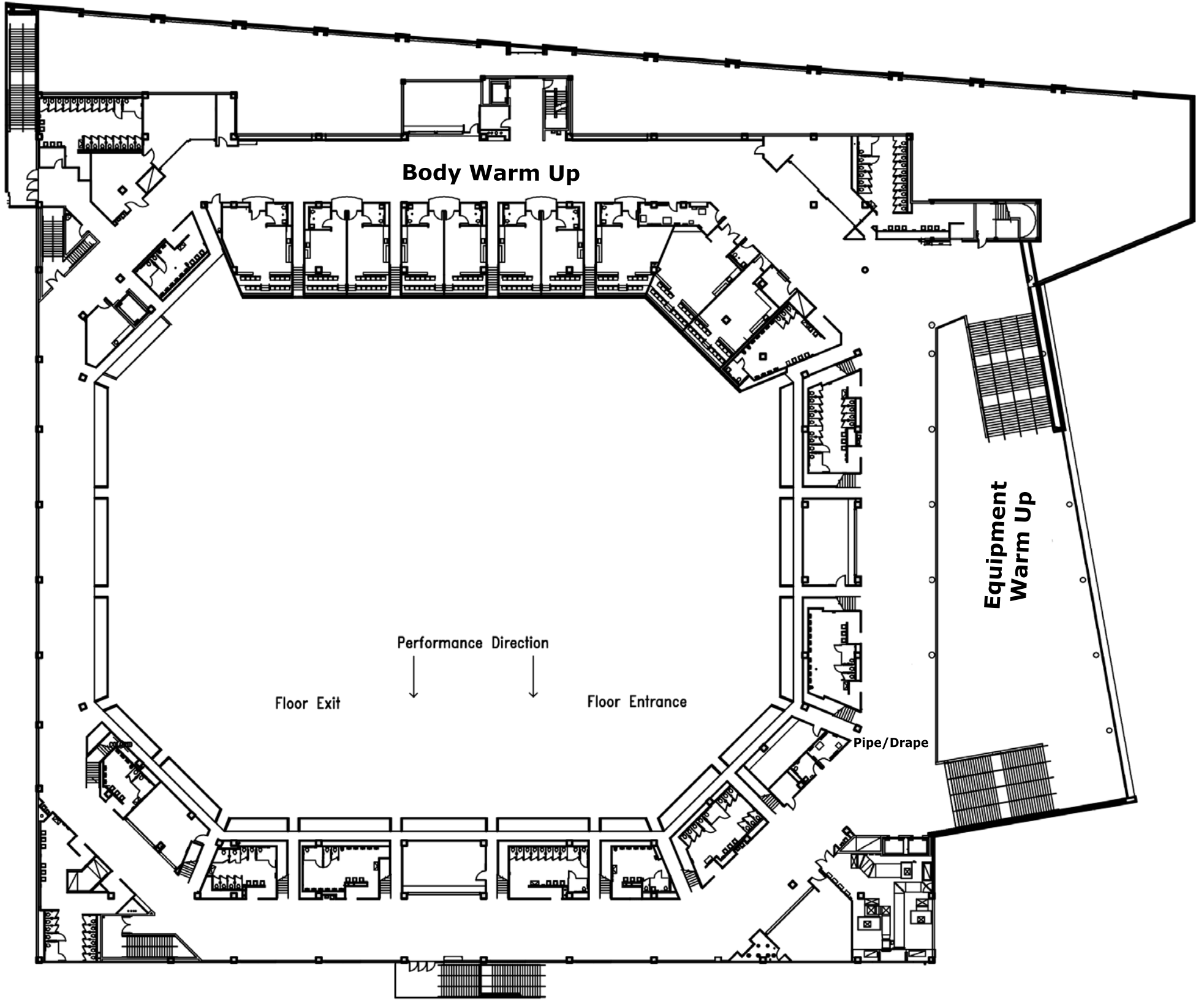

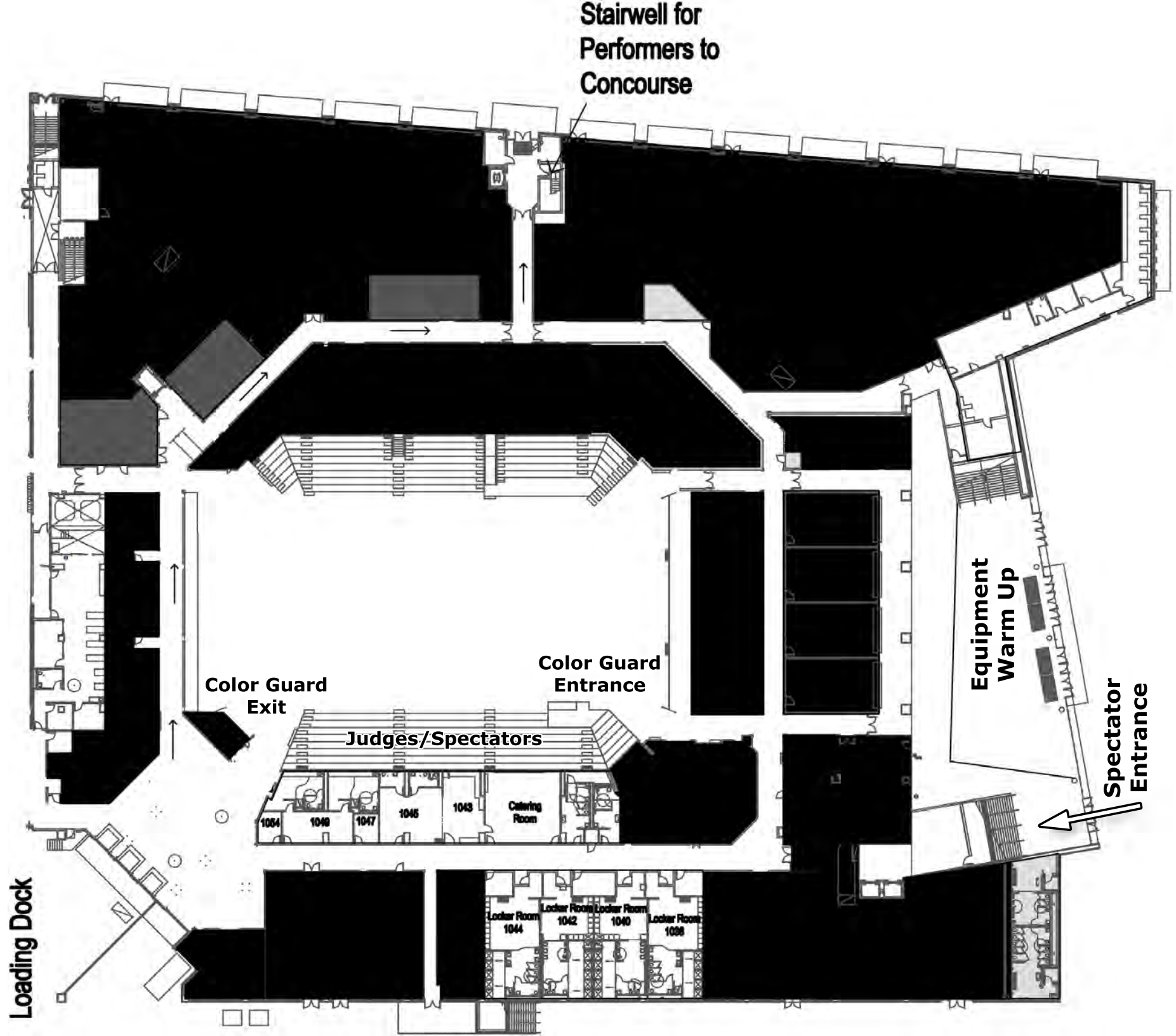

WGI Southeast Power Regional CFE Arena at University of Central Florida Performance Arena

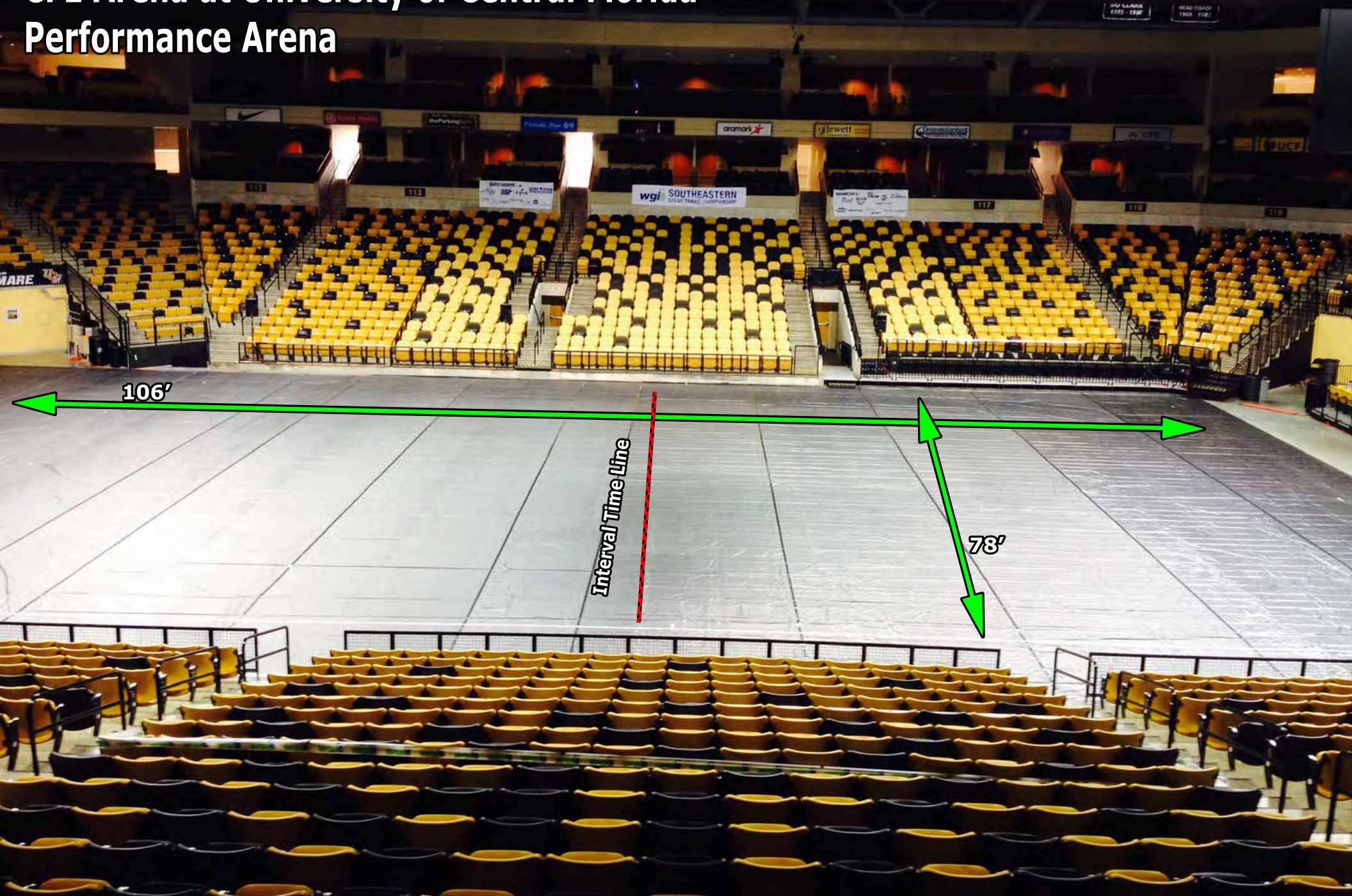



Southeast Power Regional Competition Area CFE Arena, University of Central Florida, Orlando, FL

All WGI contest sites must have a minimum of seventy by one hundred feet (70' x 100') to accommodate a "safety zone" of five (5) feet from any spectator seating. If no spectators are seated on the left and right sides, then the safety zone will be eliminated on the left and right sides of the competition area and can extend to the maximum of 106'X 78'.

The "competition area" at this event measures 106'X 78'. All performing groups must be prepared to perform within that area. Floors (tarps) may not extend into the safety zones per rules found in the WGI Adjudication Manual and Rulebook.

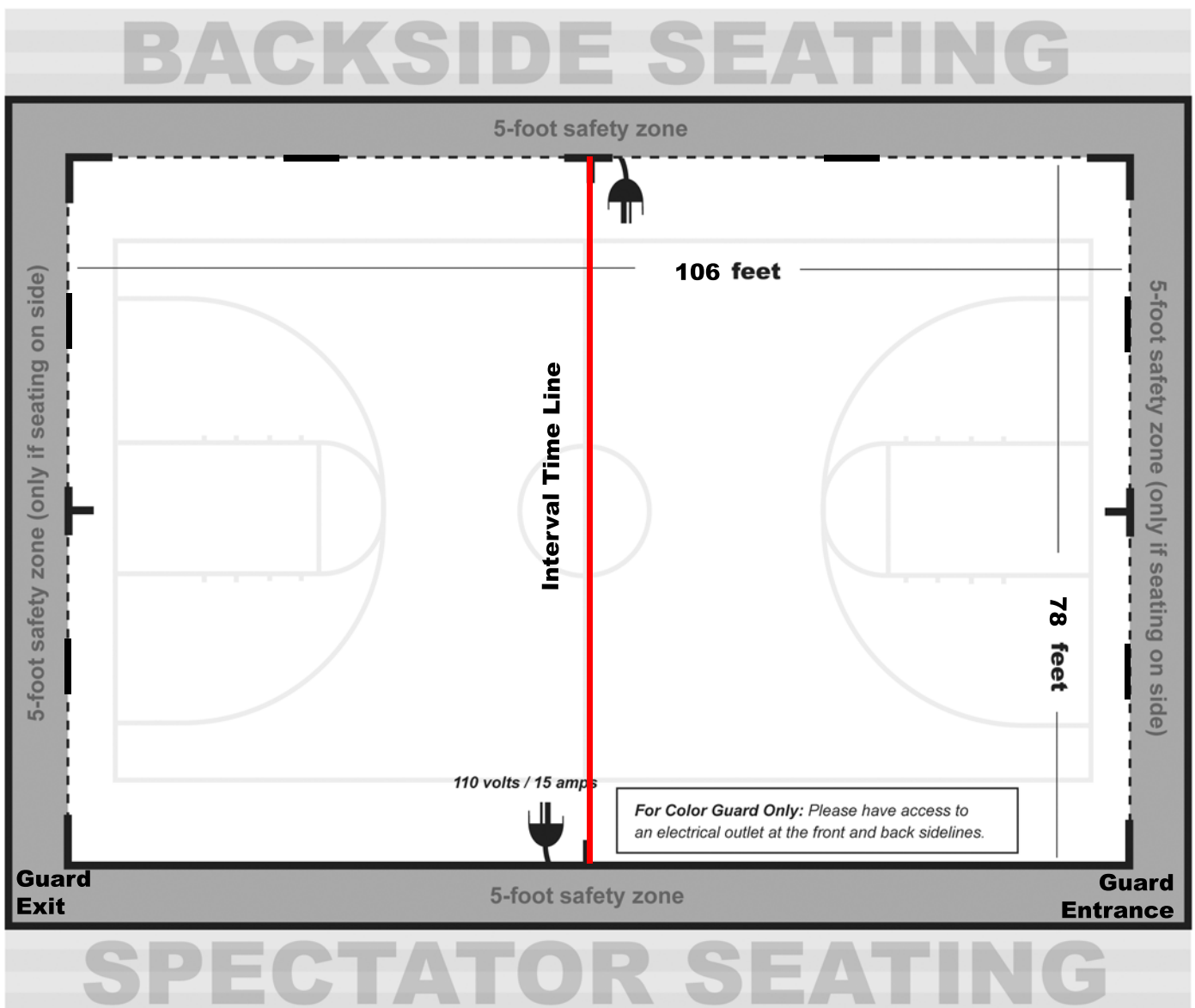

From the WGI Policy Manual

4.120 Sound Policy (Color Guard)

- All color guards should do a sound check at the designated times provided in the contest information packet to ensure the playability of any device or CD. Color guards should check the soundtrack at multiple places in the music to verify playability of any device
- Color guards should still do a sound check if they are using the WGI Music Upload in CompetitionSuite to ensure everything is correct.
- Color guard is responsible for providing the method that the music will be played, e.g. CD, MP3, computer, etc. Each color guard should have two methods to play their soundtrack in the event one does not work.
- Color guard must provide their music in a timely manner to the designated sound operator. Any delay in providing music is the responsibility of the color guard.
- Color guards using the Music Upload process through CompetitionSuite should have a backup using another device type such as an MP3 player, iPhone, or CD.
- Color guard must have a designated person at the sound table to operate any device provided to play music such as MP3 players or computers. Guard's representative is responsible to set up and play device. If a CD is provided, the color guard representative must instruct the sound operator as to what track or other relevant information is needed to start the music when directed by the contest Timing and Penalty judge or after the color guard's introduction.
- If the color guard has an issue with the music such as music is too soft, it begins in the wrong place or skips, the color guard's representative must make the decision to stop the music and tell the operator to stop the music. If the color guard representative chooses not to stop and the color guard completes their performance, the color guard will not be offered an opportunity to perform again.
- Interval timing will continue as the color guard resets and begins again. The Contest Administrator has the sole discretion in waiving any timing penalty due to the restart. If the stoppage is due to faulty sound equipment, operator error or an unexplained reason, overtime penalty may be waived.
- Issues related to the equipment provided by the color guard, quality of the CD or the color guard's representative error (using wrong playlist on MP3, etc.) will result in the actual interval timing being used and penalties, if any, being assessed.
- Volume direction must come from the color guard representative at the sound table. Direction will not be taken from the audience viewing area or across the floor. Final volume discretion is given to the sound operator based on their equipment and the Chief Judge who ultimately determines an appropriate volume level.
- The color guard representative may provide direction to the sound operator during the performance regarding equalization.
- It is the responsibility of the color guard to provide their music for each performance and to ensure that their soundtrack is working appropriately. CDs may not be left at sound table between performances.
- Under no circumstances will verbal abuse of the sound operator be tolerated. Penalties will be assessed per current WGI rules

20^{WGI}
20^{I AM}



JOIN THE SOUTHEAST POWER REGIONAL BAND!



- Free all-in-one group communication platform.
- Share group announcements via push notification, text message or email.
- Robust group calendar and membership management.
- Customizable to your unique communication needs.
- Available for your mobile device and desktop.

BAND LINK:

<https://band.us/n/a8a72eWaOeK3t>

1

Go to the Apple App Store or Google Play Store, search for BAND and download.

2

Sign up using your phone number, email, Facebook account or Google account.

3

Scan the QR code or use the link below to join the BAND.



#WGI2020

#IAMWGI



2020 WGI REGIONAL PATCH DELAYED

Order yours today to receive
them as soon as they arrive.



\$8 Plus Tax • **FREE DOMESTIC SHIPPING** ON ORDERS OF 10 OR MORE!

SHOP.WGI.ORG

POWERED BY *PepWear*