



Salem Color Guard Regional

Site:

Salem HS
77 Willson Street
Salem, MA 01970

Dimensions: 94ft. X 70ft.

Front Side Bleacher Rows: 20

Seating Capacity: 1200

Approximate Ceiling Height: 50 ft

There is one set of stairs to contend with in the competition area. They are located at the back entrance.

There are no permanent obstructions in the ceiling of the performance gym.

Color guards do not enter the competition area directly from the outdoors.

There is electrical power available.

Color guards do not exit the competition area directly to the outdoors.

There is indoor space to be utilized for prop storage prior to the competition.

There is not an indoor area to fold floors after the performance.

There will be a black vinyl tarp measuring appx 60' x 90' covering the composite gym floor.

The distance from body warm up to equipment warm up is appx 5 minutes.

The distance from equipment warm up to the competition area is about 30 seconds.

There are separate areas for body and equipment.

Body Warm Up

Auditorium

Dimensions: 35ft. X 15ft.

No obstructions in the area.

Music may be used in body warm up at moderate levels to be determined per the contest director.

Equipment Warm Up

Auxiliary Gym

Dimensions: 75ft. X 50ft.

Approximate Ceiling Height: 30 ft

There are no obstructions in the area of equipment warm up.

Music may be used in equipment warm up at moderate levels to be determined per the contest director.

The above information is being provided to you in order give you the most complete information we currently have on this contest. All information is subject to change either before or during the event by contest personnel based on need.



Outside Doors

The above information is being provided to you in order give you the most complete information we currently have on this contest. All information is subject to change either before or during the event by contest personnel based on need.

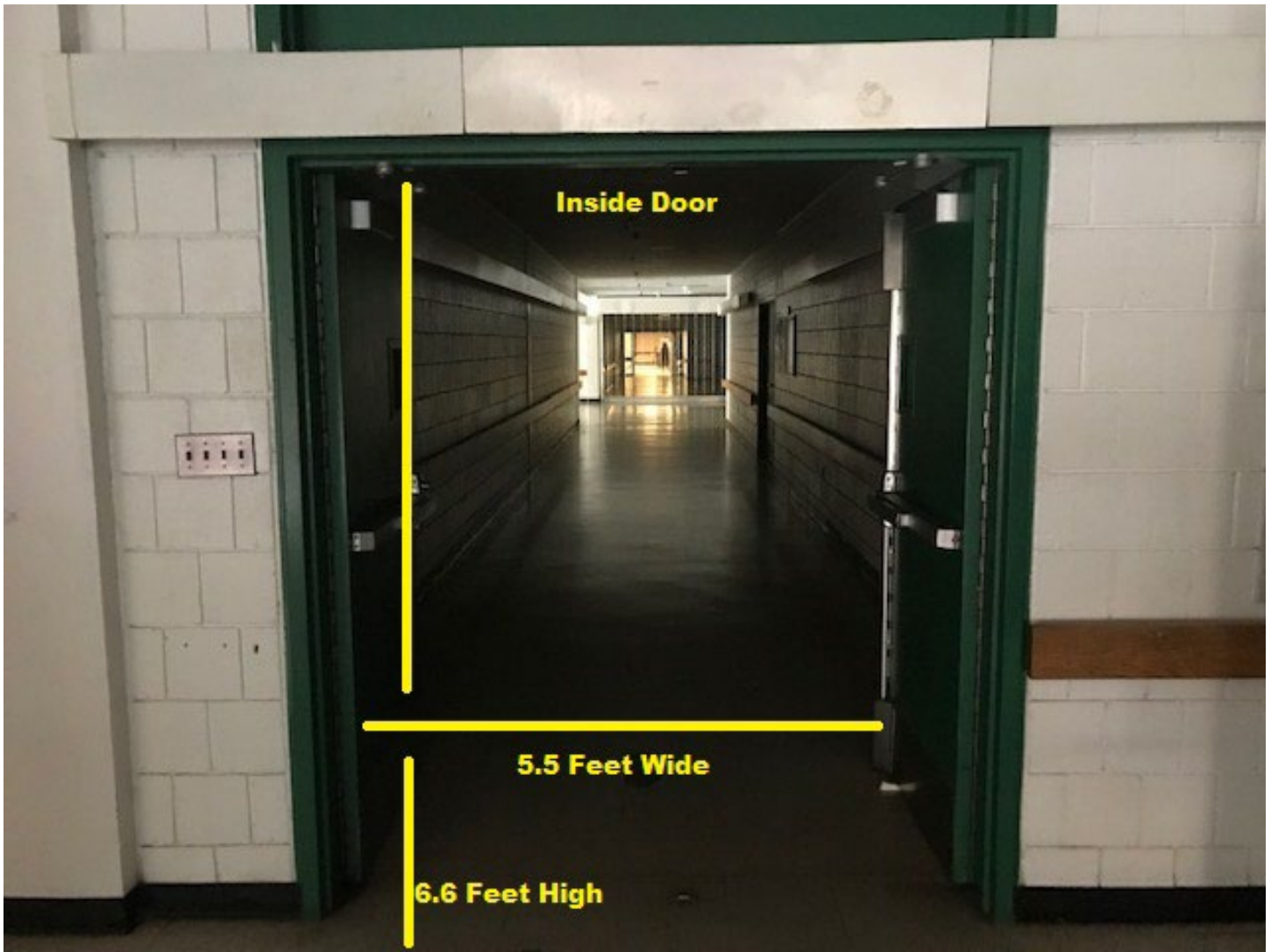

Inside Door

The above information is being provided to you in order give you the most complete information we currently have on this contest. All information is subject to change either before or during the event by contest personnel based on need.