



## **Gulfport Color Guard Regional**

### **Site:**

Gulfport High School  
100 Perry Street  
Gulfport, MS 39507

**Dimensions:** 106' x 70'

**Front Side Bleacher Rows:** 23                      **Seating Capacity:** appx 1200

**Approximate Ceiling Height:** appx 35 ft

There are no stairs to contend with in the competition area.

There are raised basketball goals and a scoreboard above the competition floor.

Color guards enter the competition area directly from the outdoors.

There is electrical power available at the front and back sideline.

Color guards do exit the competition area directly to the outdoors.

The cafeteria will be utilized for prop storage prior to the competition.

There will be a black vinyl tarp measuring appx 60'x120' covering the entire wooden performance gym floor.

In case of inclement weather, there will be an indoor space available for floor refolding during breaks.

The distance from body to equipment warm up is approximately 3 minutes.

The distance from equipment warm up to the performance gym is less than 1 minute.

### **Body Warm Up**

Band Room

Dimensions: appx 67 ft. x 67 ft.

There are no obstructions in the area.

Music may be used in body warm up at moderate levels.

### **Equipment Warm Up**

Auxiliary Gym

Dimensions: 97 ft. X 63 ft.

Approximate Ceiling Height: 30 ft.

There are basketball goals and a divider curtain hanging from the ceiling in the area.

Music may be used in equipment warm up at moderate levels.

The above information is being provided to you in order give you the most complete information we currently have on this contest. All information is subject to change either before or during the event by contest personnel based on need.

### SITE PLAN GENERAL NOTES

1. ALL INFORMATION IS BASED ON FIELD OBSERVATIONS AND OWNER SUPPLIED DOCUMENTS AND MAY NOT REFLECT ACTUAL FIELD CONDITIONS. UPON DISCOVERY OF ANY DISCREPANCIES BETWEEN DRAWINGS DEPICTING EXISTING CONDITIONS OR UPON DISCOVERY OF UNKNOWN CONDITIONS DETRIMENTAL TO THE COMPLETION OF THE WORK AS INDICATED IN THE DOCUMENTS, THE CONTRACTOR SHALL IMMEDIATELY NOTIFY THE ARCHITECT, IN WRITING, OF THE CONDITION IN QUESTION BEFORE PROCEEDING WITH WORK IN THAT AREA.
2. SEE CIVIL FOR SITE IMPROVEMENT DETAILS
3. SITE PLAN LAYOUT FOR REFERENCE ONLY - SEE CIVIL FOR EXACT LAYOUT OF BUILDINGS
4. -CJ PATTERN SHOWN ON ARCHITECTURAL DRAWINGS ARE BE BASED OFF CIVIL SIDEWALK LAYOUT. ALL DIMENSIONS APPROXIMATE. SEE CIVIL FOR SIDEWALK EXTENTS & DETAILS. SUMIT CJ LAYOUT FOR APPROVAL PRIOR TO POUR.
5. -SEE ELEVATIONS AND ROOF PLANS FOR ADDITIONAL EXISTING BUILDING DOWNSPOUT WORK AND ROOFING EXTENTS

### LEGEND - ENLARGED SITE PLAN

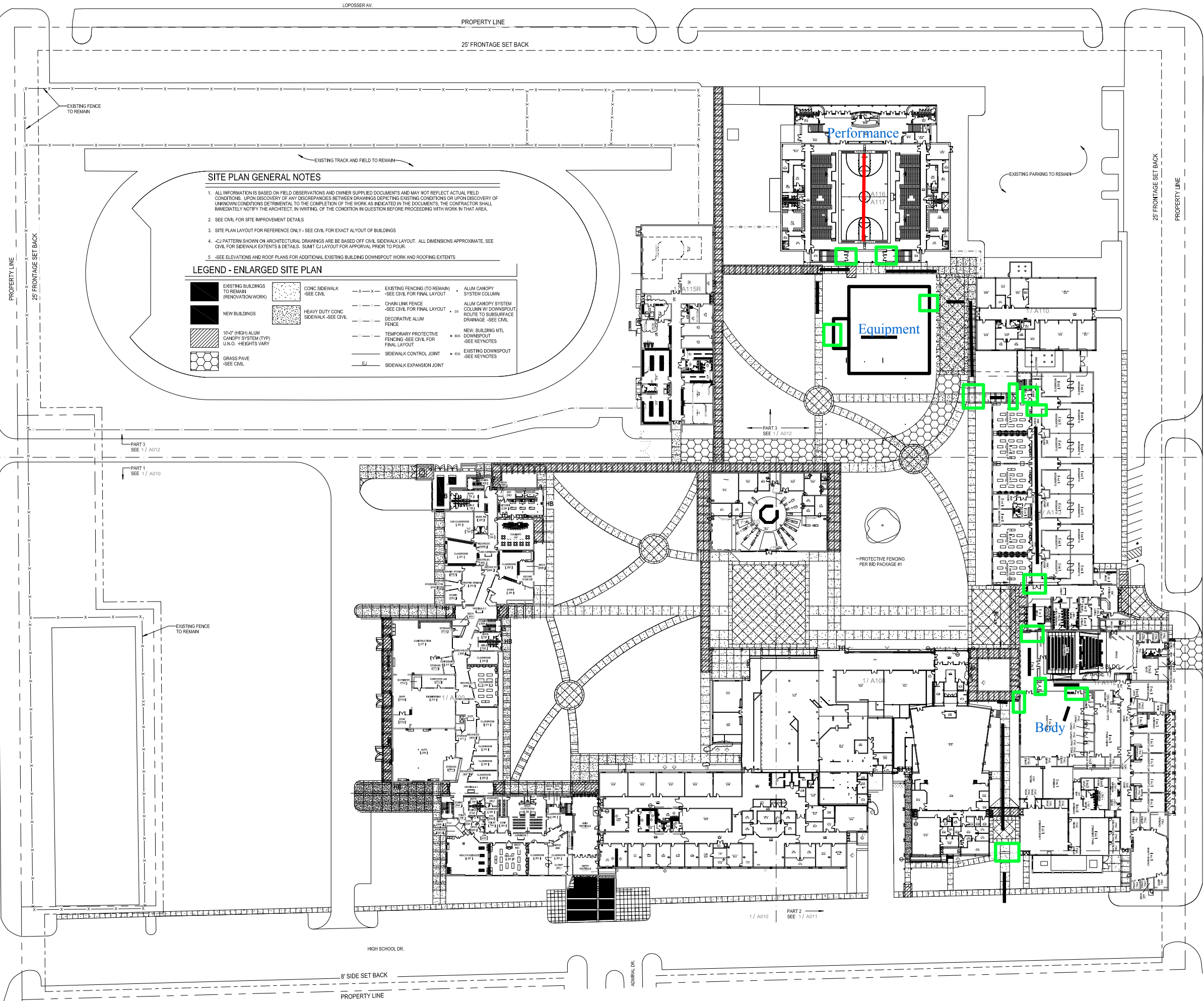

# Gate



108" W

# Body/Warm-Up Entrance



81" H

67" W

# Body/Warm-Up Exit



# Hallway 1





# Hallway 2 - Doorway 1



# Hallway 2 - Doorway 2



## Hallway 2 - Doorway 3



## Hallway 3







# Equipment Entrance



# Equipment Exit

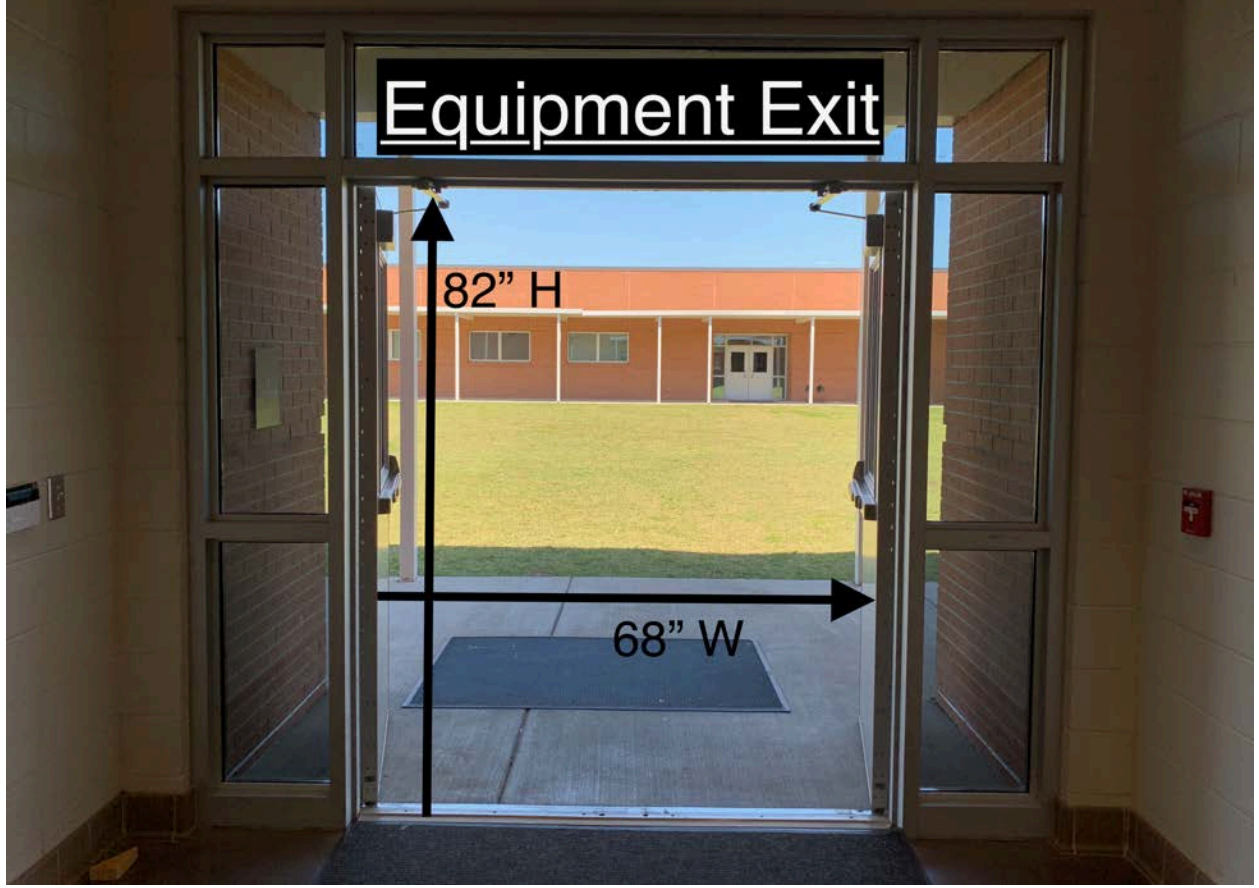





Performance Entrance and Exit tight turn

width is 72" and the length is 156" from outside corner and 97" from inside corner.

