



**Color Guard World Championships
University of Dayton Arena Site Info
1801 South Edwin C Moses Blvd
Dayton, OH 45417**

- The arena is situated on three floors:
 - The lower level is the competition area, color guard first aid, and staging area.
 - The walk-in level is Performance Check-In, body and equipment warm up, ticket office, sound check, entrance to the arena for competing color guards, entrances for spectators and non-performing color guards. (Photography is on the west concourse.)
 - On the upper level is Director Check In & WGI Headquarters (entrance is at walk-in level, Boesch Lounge).
- Parking for color guards and spectators is abundant. Spectators enter at Parking Gate C or D ONLY.
- Each color guard will be allotted 4 parking passes. Buses and trucks do not need a parking pass and will be permitted parking in the Bus/Truck Lot. See maps for details and traffic flow.
- University of Dayton has implemented security screening procedures. Please instruct everyone traveling with you to allow extra time upon arrival. A list of prohibited items is located in this packet. Absolutely no color guard equipment will be permitted in the spectator entrance.
- The mixing board for the sound system and the sound person will be located in the front stands. The WGI sound person will have control of the level of sound. See contest info packet for sound check times.
- There are NO dressing facilities available. Performing members should arrive at the arena in competitive attire.
- A 12' black drape will adorn the back stands of the competition area.
- Music is permitted in body and equipment warm up at moderate levels. In body warm up, the sound system should be placed in the corner of the room. WGI does not provide a sound system in any warm up area. If you wish to use music, please provide your own system.
- The floor surface is concrete. A black tarp will cover the entire competition area. A black tarp will cover the entire competition area. The black strips will be placed approximately 9.5 feet apart from the front to the back of the performance floor. The last strip at the back will vary in width.
- The competition area is 106' X 78'. Please see the floor plan for more details.
- An electrical outlet will be available at the front and back side line.
- There is a scoreboard that hangs in the middle of the performance floor. Distance from the floor to the bottom of the scoreboard is 32'.
- There are no floor folding facilities available.

WGI Color Guard World Championships University of Dayton Arena



Google earth

Imagery Date: 10/10/2015 39°44'10.60" N 84°11'57.26" W elev 727 ft eye alt 2976 ft



**Color Guard World Championships
University of Dayton Arena Site Info
Color Guard Prop Storage Details**

During the Board of Directors meeting this past July, the 2019 Advisory Board Proposal # 8, to have an additional tent behind UD for prop storage, was not approved. The Board of Directors put forth a directive to provide designated spaces that groups can unload and leave props behind UD Arena.

Based on this directive, WGI plans to cone off 19 lettered spaces that will be approximately 60'x36' each behind UD arena. (See map)

Groups will have a published time (90 minutes prior to their performance time) to enter their designated space. Trucks/trailers will park in this spot. Busses will still park in the side parking Lot.

This spot is where you can unload and all your prop/items will remain there until you are told to move towards the tunnel entrance by WGI personnel. **Each group is to be prepared to cover their own equipment/props with a tarp, or some other protective cover in case of inclement weather.**

Trucks will remain in the designated spot until you have re-loaded. Appointed times to depart that assigned space will be determined as you arrive on-site with a "Golden Ticket" handed to truck drivers. This "Golden Ticket" has your expected "exit time" from the assigned space printed on the ticket.

These designated prop storage spaces will **only** be available at UD Arena.

WGI Color Guard World Championships

UD Arena Outdoor Prop Storage

Each space measures appx 60'x36'

L M N O P Q R S

A B C D E F G H I J K

WALKTHRU

**Equipment
Tent**

Google

Equipment Warm Up Tent Dimensions

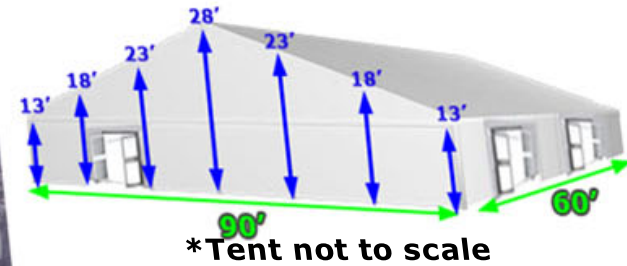

To Tunnel

**Photos West Concourse
(Thursday Only)**

**Body Warm Up
West Concourse Club**

**Performance
Check In**

**To
Body**

WGI Color Guard World Championships
University of Dayton Arena

University of Dayton Arena Body Warm Up Area

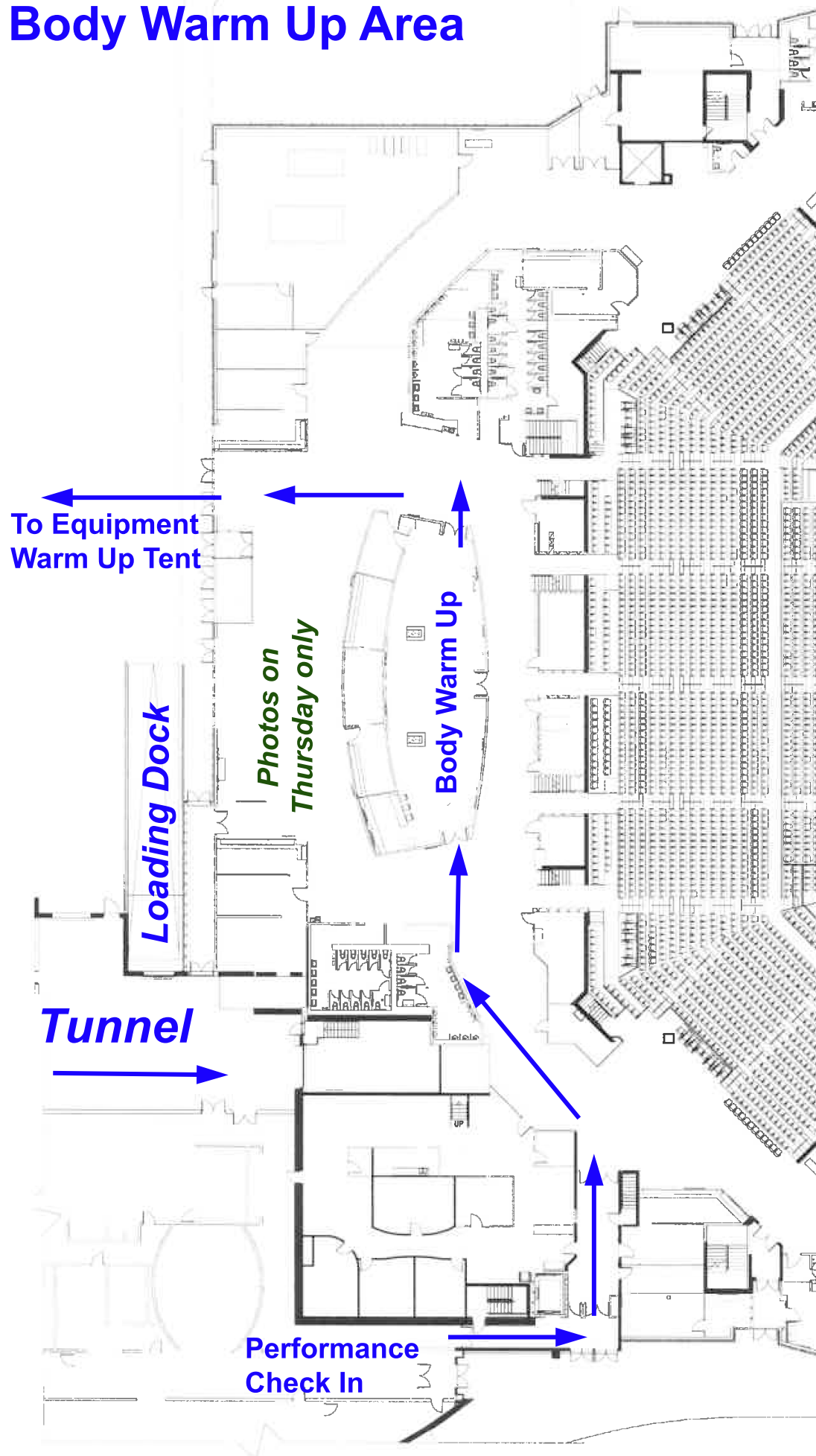

University of Dayton Arena Body Warm Up Specs West Concourse Club

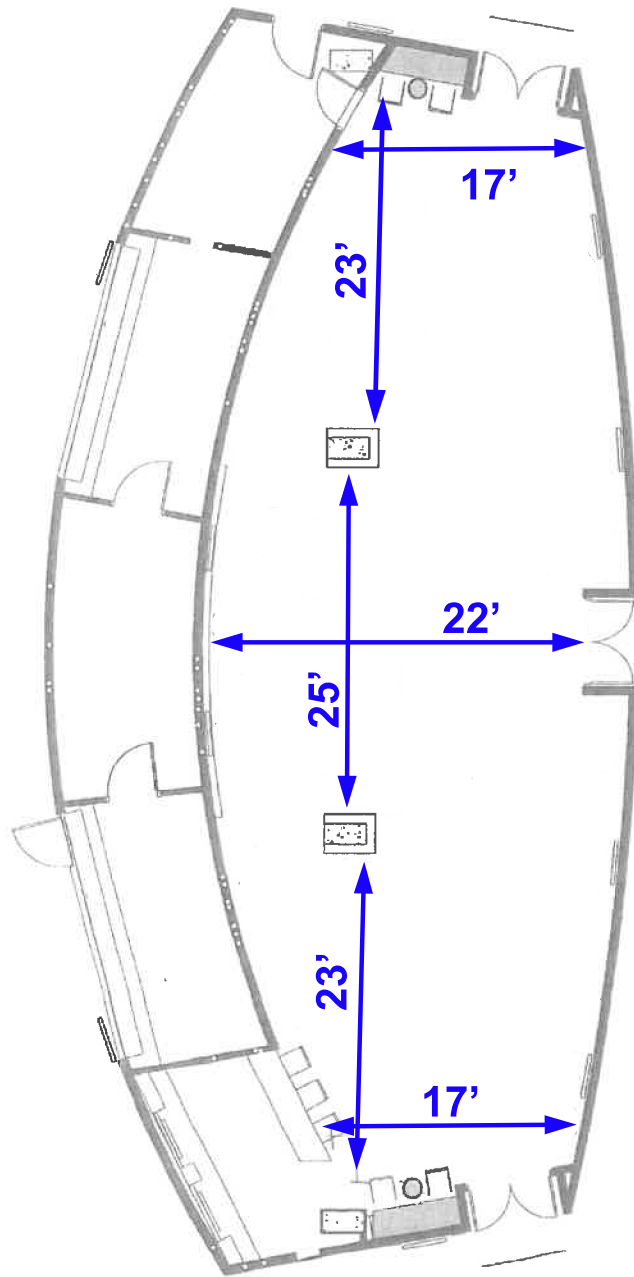

WGI Color Guard World Championships

University of Dayton Arena

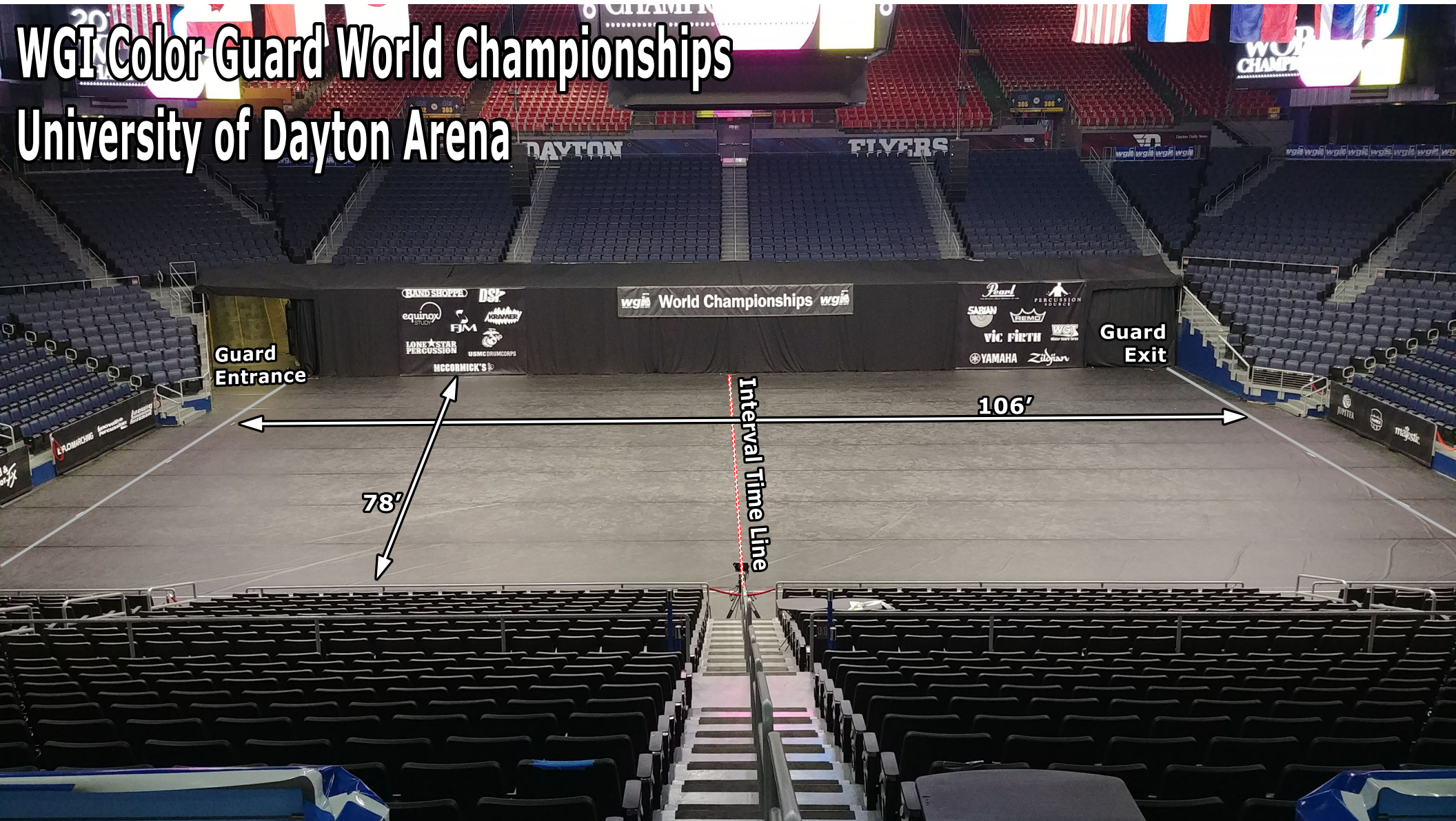



Color Guard World Championships Competition Area University of Dayton Arena, Dayton, OH

All WGI contest sites must have a minimum of seventy by one hundred feet (70' x 100') to accommodate a "safety zone" of five (5) feet from any spectator seating. If no spectators are seated on the left and right sides, then the safety zone will be eliminated on the left and right sides of the competition area and could extend to a maximum of 106' X 78'.

The "competition area" at this event measures 106' X 78'. All performing groups must be prepared to perform within that area. Floors (tarps) may not extend into the safety zones per rules found in the WGI Adjudication Manual and Rulebook.

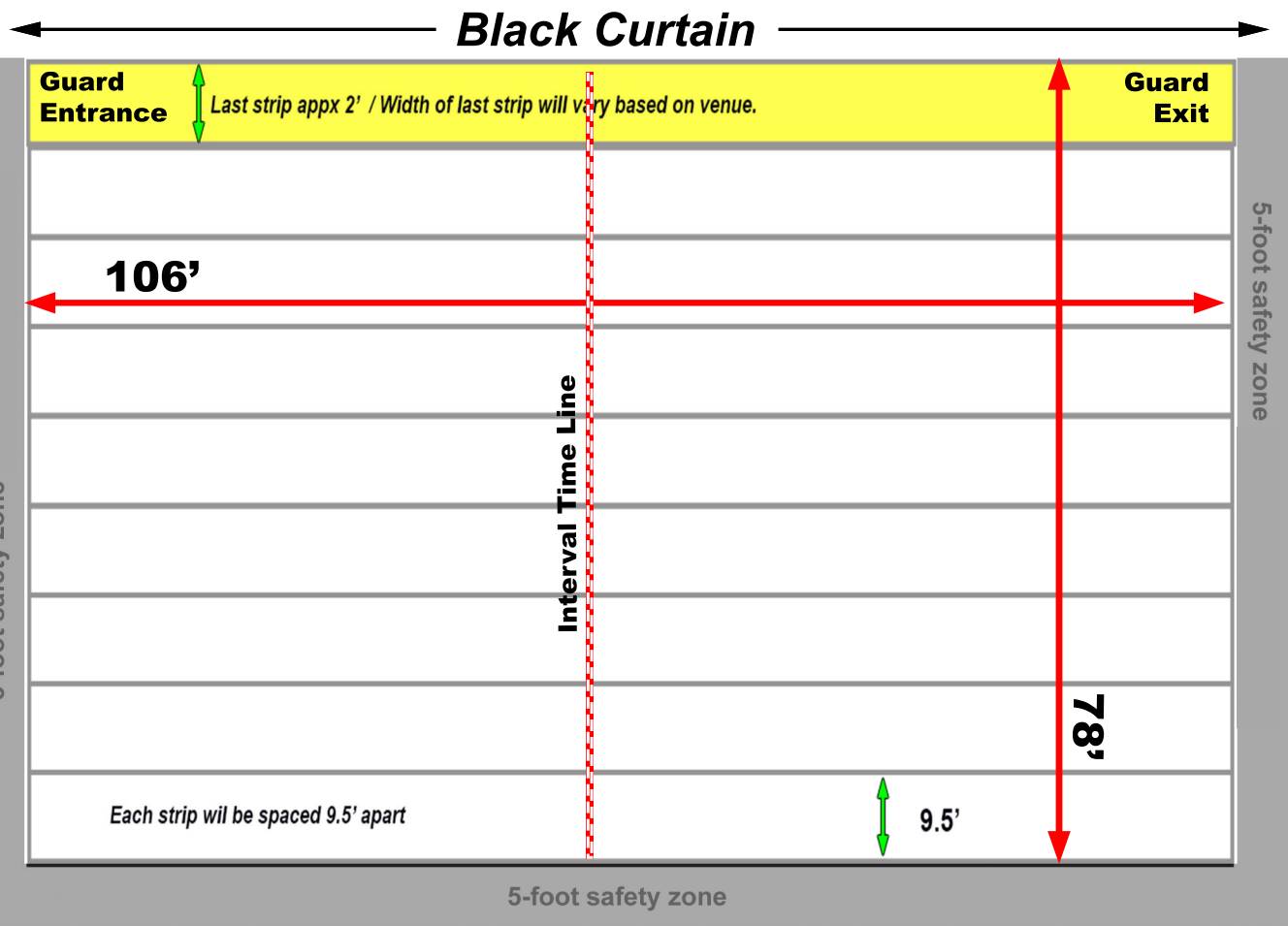



2022 UD ARENA PROCEDURES

UD ARENA IS NOW CASHLESS: Box Office, Concession stands, and the UD team store are now **100% cashless**. They will accept all major credit cards, debit cards, Apple Pay and Google Pay.

METAL DETECTORS: All persons will walk through a metal detector or be screened with a hand-held metal detector, to search for prohibited items any time they enter or re-enter the building. **Please allow extra time** to your arrival to the arena to account for this process.

NO COLOR GUARD EQUIPMENT will be allowed in the main spectator arena entrances. Equipment may only enter the building through the warm/up guard check-in entrance and the designated performance entrance at the top of the tunnel. *(See additional information on where groups can leave equipment and props outside backstage).*

ALL BAGS ARE SUBJECT TO SEARCH. We ask you to please limit the number of bags/purses/small backpacks being brought into the arena. Personal bags may be allowed after a thorough inspection. Bags and backpacks larger than 16x16x8 are not permitted except for diaper bags and medical equipment which are subject to inspection at any time.

Flag bags/ equipment bags/ cymbal bags are not permitted in the spectator entrances.

PROHIBITED ITEMS: Including, but not limited to: firearms, weapons of any kind, outside food and drink, strollers, signs larger than 8.5 x 11, tripods, balloons, animals (with the exception of service animals), camera lenses longer than eight (8) inches, laser pointers, and noisemakers

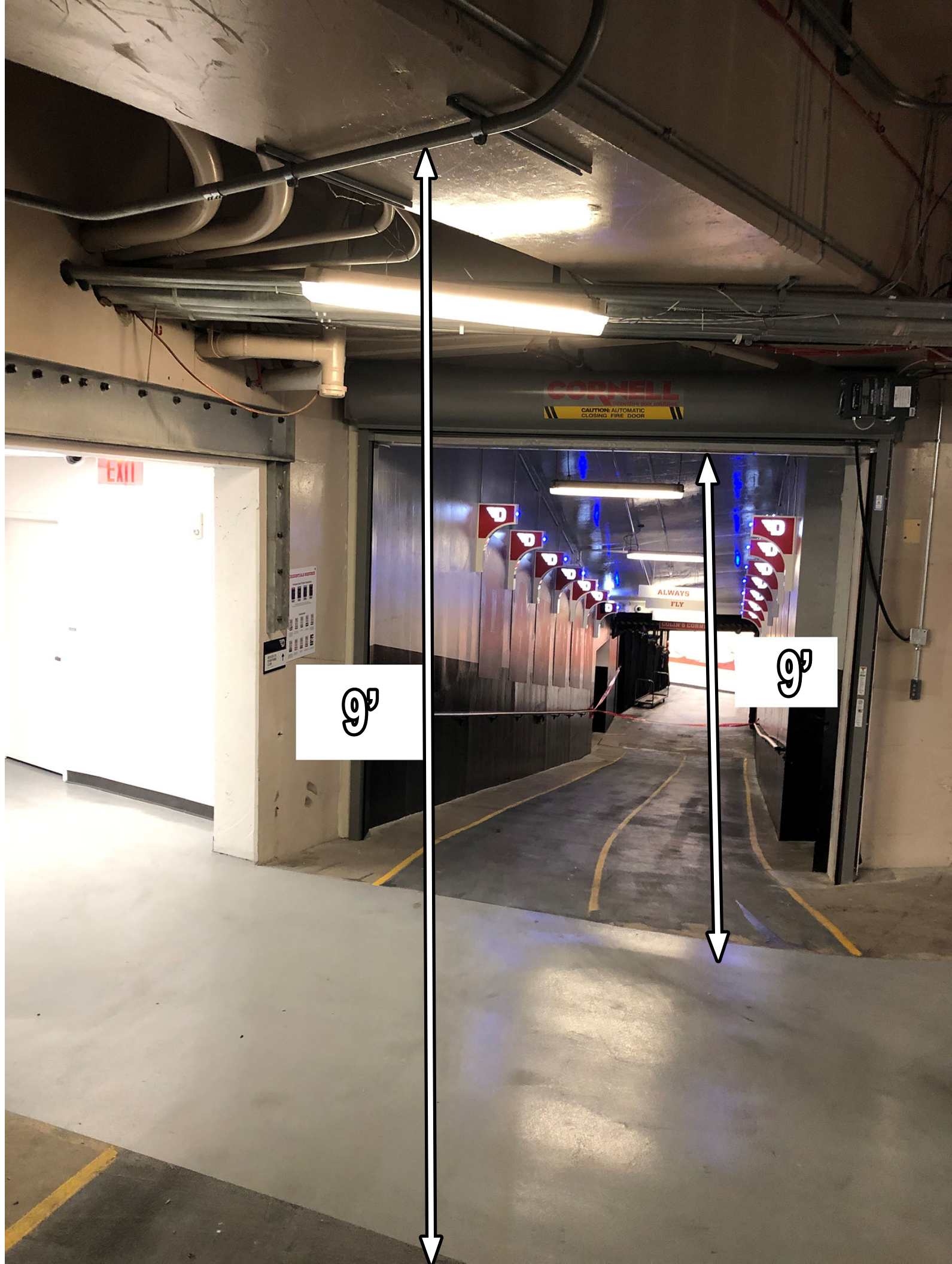

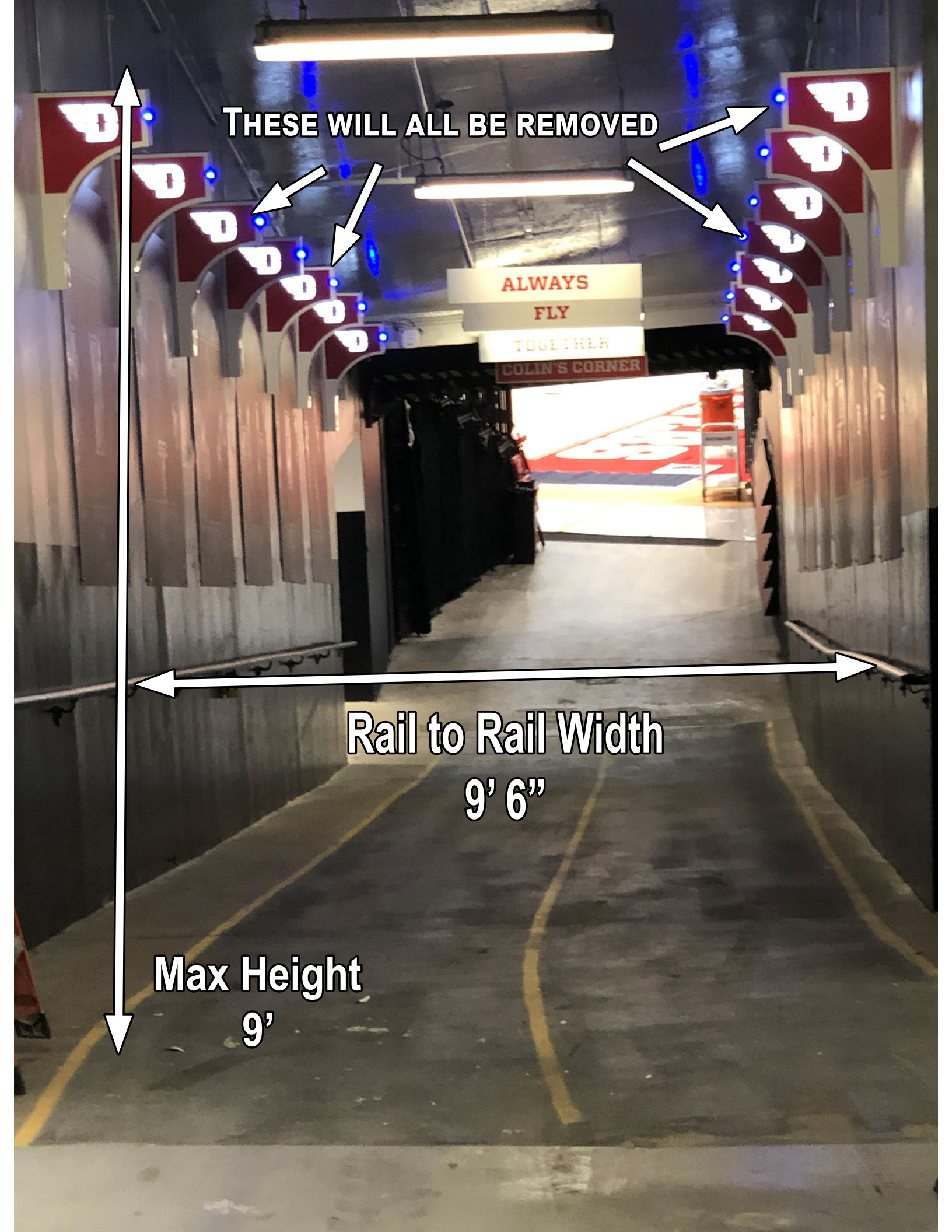

THESE WILL ALL BE REMOVED

Rail to Rail Width
9' 6"

Max Height
9'

EXIT

78"

60'

Performance Exit

Doors will be removed

Performance Exit Hallway

