



**Percussion World Championships
Hobart Arena Site Info
255 Adams St.
Troy, OH 45373**

- Parking for ensembles and spectators is abundant. See maps for details and traffic flow.
- Dressing facilities are very limited. Please come in competitive attire.
- All warm ups will be conducted in the parking lot of the southwest side of the building. There are two tents in the warm up parking lot that may be utilized as well. Please see logistical schedule for tent times.
- A floor to ceiling black drape will adorn the back wall of the arena, covering entrances and exits.
- Ensembles will push behind the performance area curtain to get to the ready line. This space is 10 ft. wide.
- The performance floor will be concrete. A black tarp will cover the entire competitive floor.
- The contest floor is 72' x 106'. Please see the floor plan for more details.
- Height of the facility is more than adequate.
- Director Check in is located in the loading dock.
- Equipment trucks must be moved 60 minutes after an ensembles contest completion. There is remote parking available at Duke Park, map attached in this packet, a shuttle service will be provided as well.
- Power Specifications - WGI will provide two 20 amp dedicated circuits on the front and back sidelines.

WGI PercussionWorld Championships
Hobart Arena
Troy, OH

Spectator Parking

Spectator Entrance

**Director
Check In**

**Group
Entrance and Exit**

A

B

Hobart Arena

**Bus and Truck
Entrance**

**Alpha Lot
Warm up**

Bus Drop Off

Truck Parking

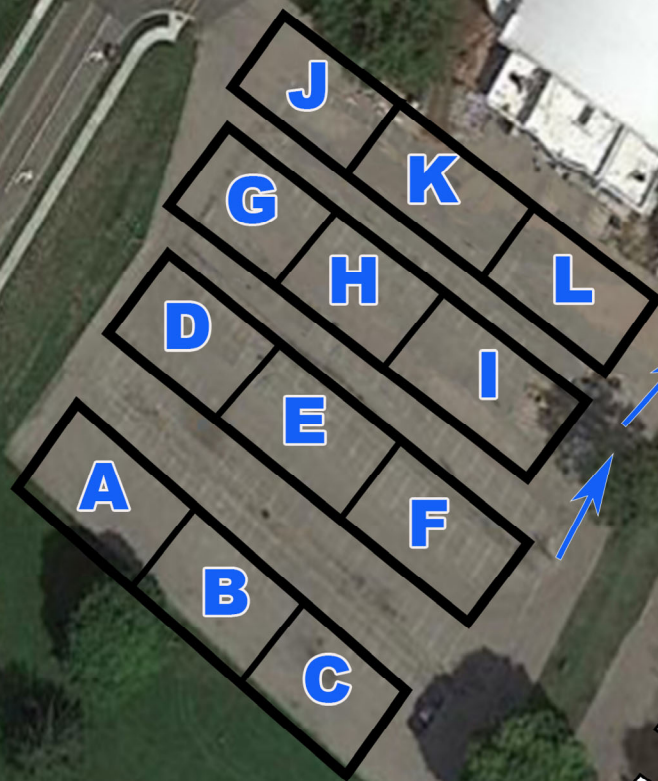

Truck and Bus Entrance

An aerial photograph of a road. A green arrow points from the top left towards a white sign that reads "Bus Drop Off". The road is paved and has a white line marking. The surrounding area is green and appears to be a park or wooded area.

An aerial photograph showing a large, rectangular green field, likely a sports field or park. A road runs along the left side of the field. There are some trees and a building visible on the right side of the field. The text is overlaid on the top left of the image.

WGI Percussion World Championships
Hobart Arena
Troy, OH
Alpha Lot
 Lots are apprx. 40'x75'

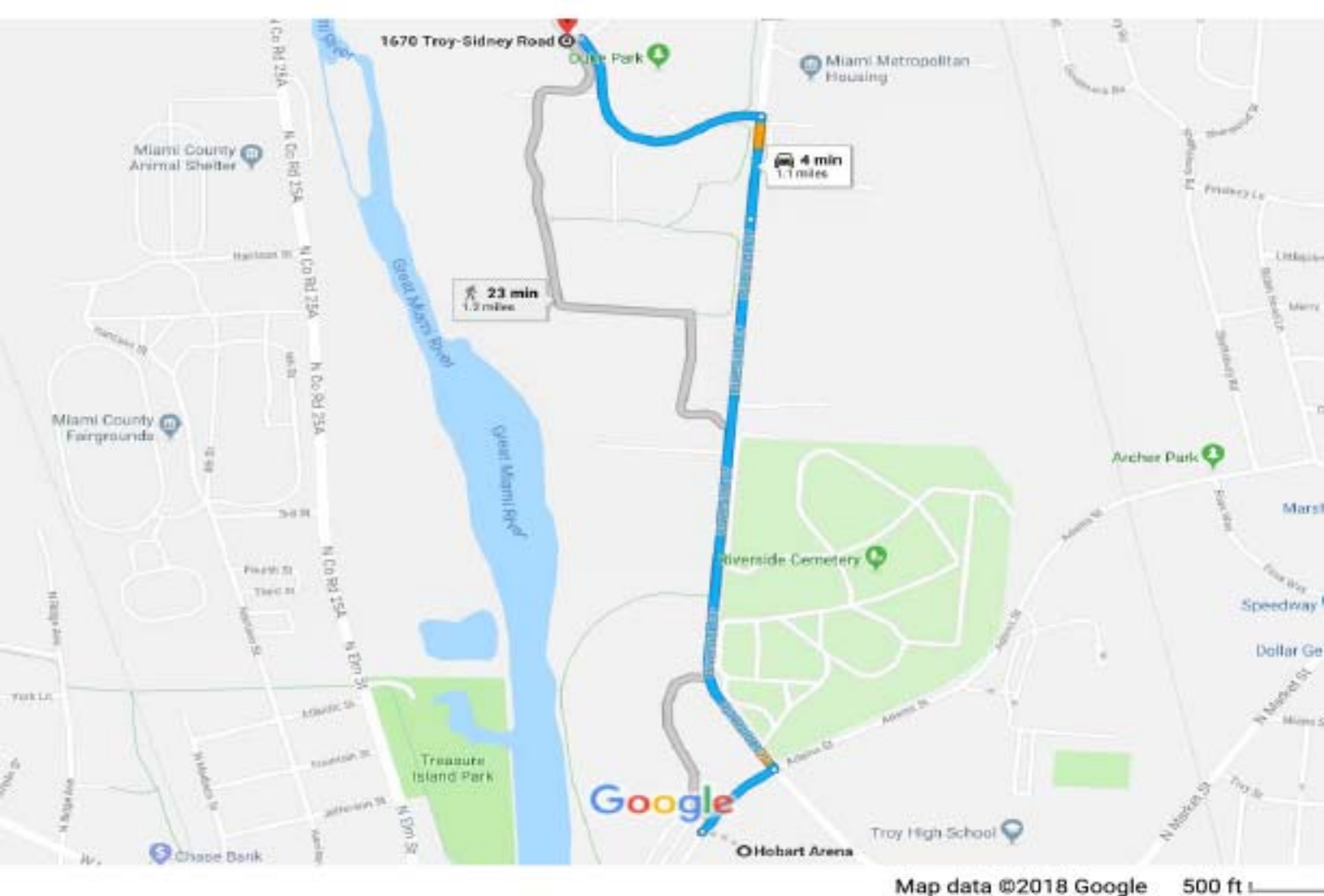

Directions to bus parking and overflow truck parking - Duke Park.

Exit Hobart Arena from Staunton Rd. turn left.

Continue straight through intersection at Adams St. Staunton Rd. turns into Riverside Dr.

Continue straight on Riverside Dr. for .9 miles.

Turn left into Duke Park. 1670 Troy-Sidney Rd., Troy Ohio, 45373

There will be a shuttle service to and from Hobart Arena and Duke Park.

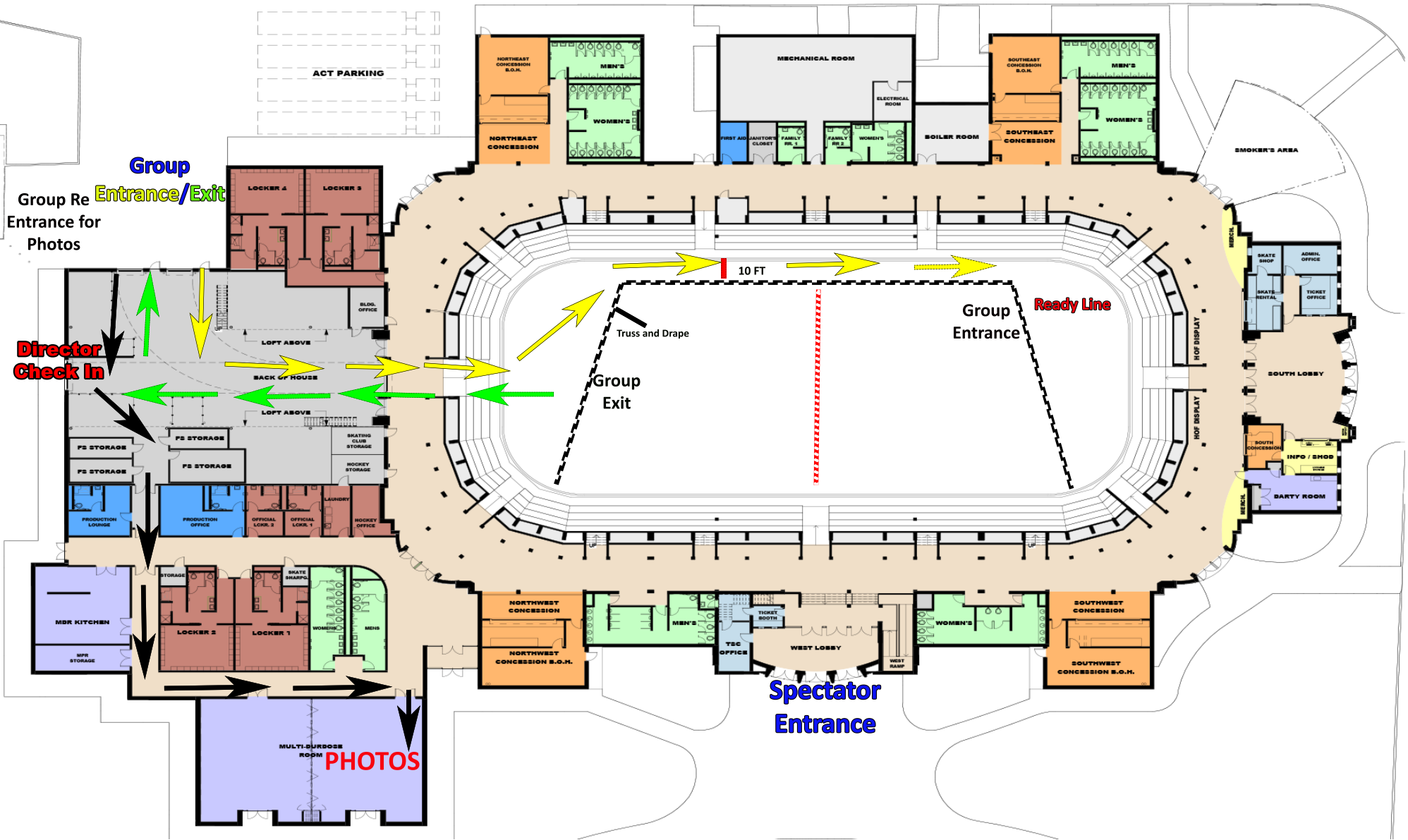



Percussion World Championship Competition Area Hobart Arena, Troy, OH

All WGI contest sites must have a minimum of seventy by one hundred feet (70' x 100') to accommodate a "safety zone" of five (5) feet from any spectator seating. If no spectators are seated on the left and right sides, then the safety zone will be eliminated on the left and right sides of the competition area and extend to a maximum of 72' X 106',

All performing groups must be prepared to perform within the competition area. Floors (tarps) may not extend into the safety zones per rules found in the WGI Adjudication Manual and Rulebook

