



**Percussion World Championships  
Hobart Arena Site Info  
255 Adams St.  
Troy, OH 45373**

- Parking for ensembles and spectators is abundant. See maps for details and traffic flow.
- Dressing facilities are very limited. Please come in competitive attire.
- All warm ups will be conducted in the parking lot of the southwest side of the building. There are two tents in the warm up parking lot that may be utilized as well. Please see logistical schedule for tent times.
- A floor to ceiling black drape will adorn the back wall of the arena, covering entrances and exits.
- Ensembles will push behind the performance area curtain to get to the ready line. This space is 10 ft. wide.
- The performance floor will be concrete. A black tarp will cover the entire competitive floor.
- The contest floor is 72' x 106'. Please see the floor plan for more details.
- Height of the facility is more than adequate.
- Director Check in is located in the lobby area facing the warm up zones.
- Equipment trucks must be moved 60 minutes after an ensembles contest completion. There is remote parking available at Duke Park, map attached in this packet, a shuttle service will be provided as well.
- Power Specifications - WGI will provide two 20 amp dedicated circuits on the front and back sidelines.

# WGI Percussion World Championships

## Hobart Arena

### Troy, OH

**Spectator Parking**

**Spectator Entrance**

**Group Entrance and Exit**

**A B**

Hobart Arena

**Director Check In**

**Bus and Truck Entrance**

**Alpha Lot Warm up**

**Bus Drop Off**

**Truck Parking**

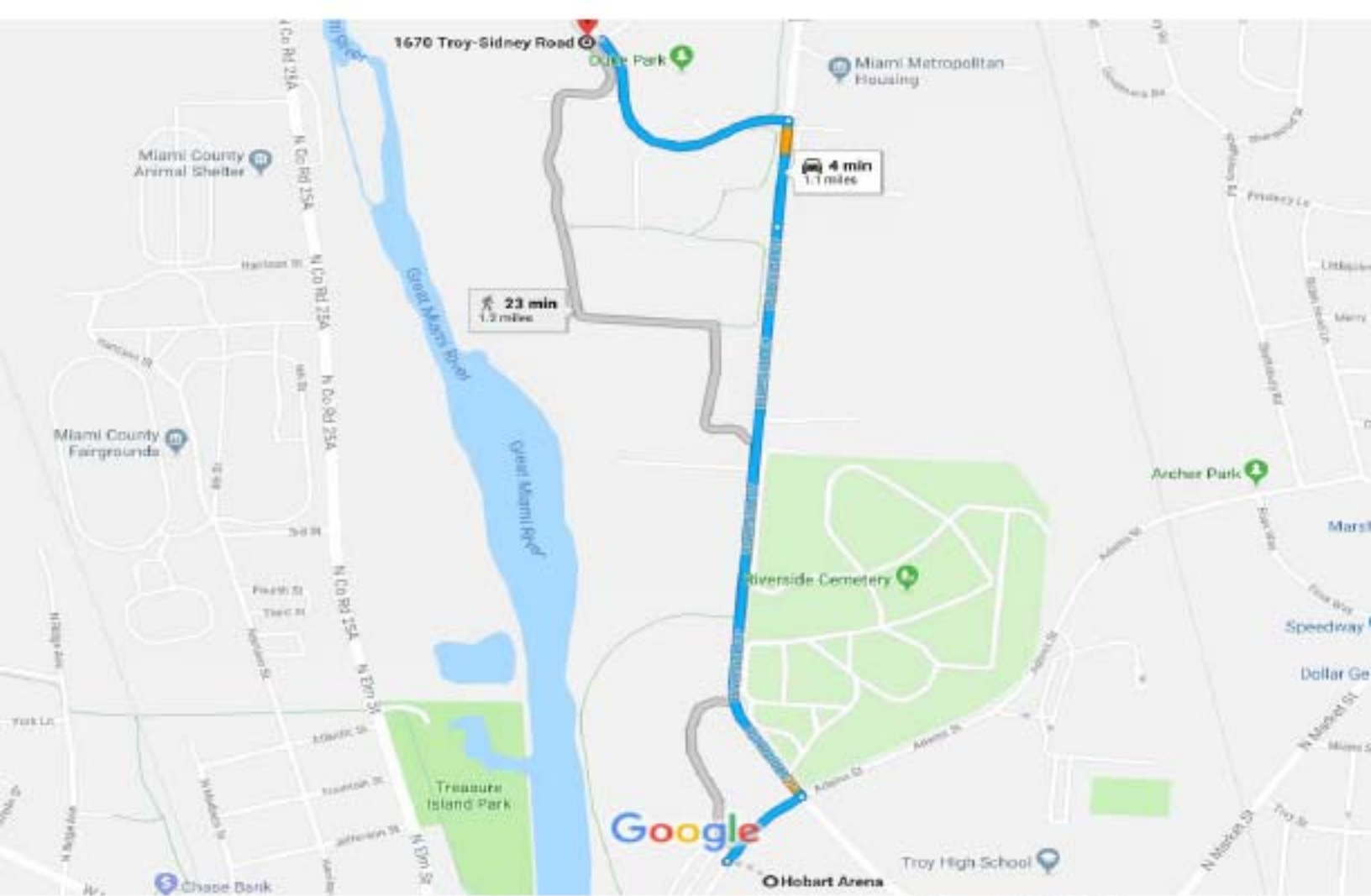

Map data ©2018 Google 500 ft

## **Directions to bus parking and overflow truck parking - Duke Park.**

**Exit Hobart Arena from Staunton Rd. turn left.**

**Continue straight through intersection at Adams St. Staunton Rd. turns into Riverside Dr.**

**Continue straight on Riverside Dr. for .9 miles.**

**Turn left into Duke Park. 1670 Troy-Sidney Rd., Troy Ohio, 45373**

**There will be a shuttle service to and from Hobart Arena and Duke Park.**

**WGI Percussion World Championships  
Hobart Arena  
Troy, OH  
Alpha Lot  
Lots are apprx. 40'x75'**

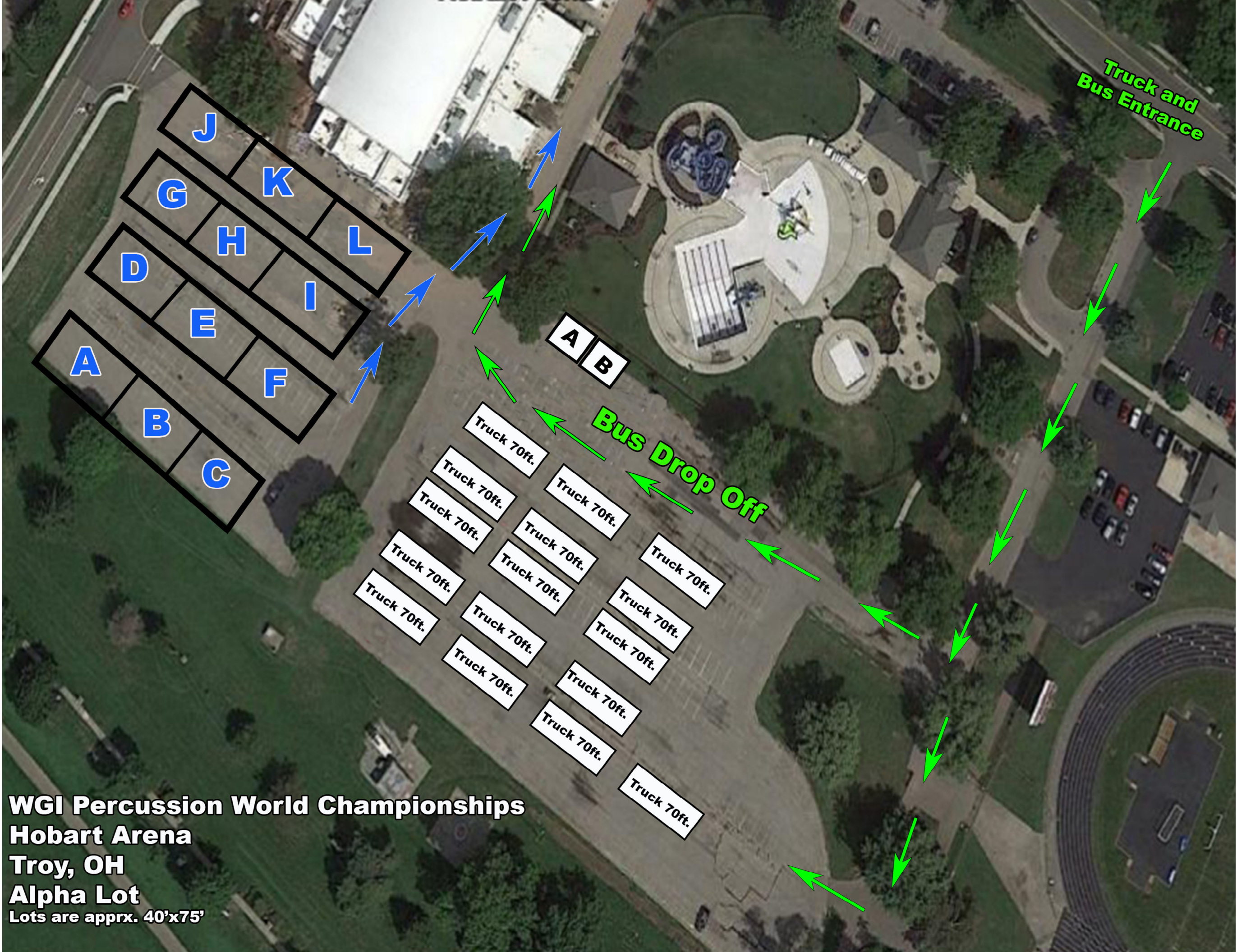

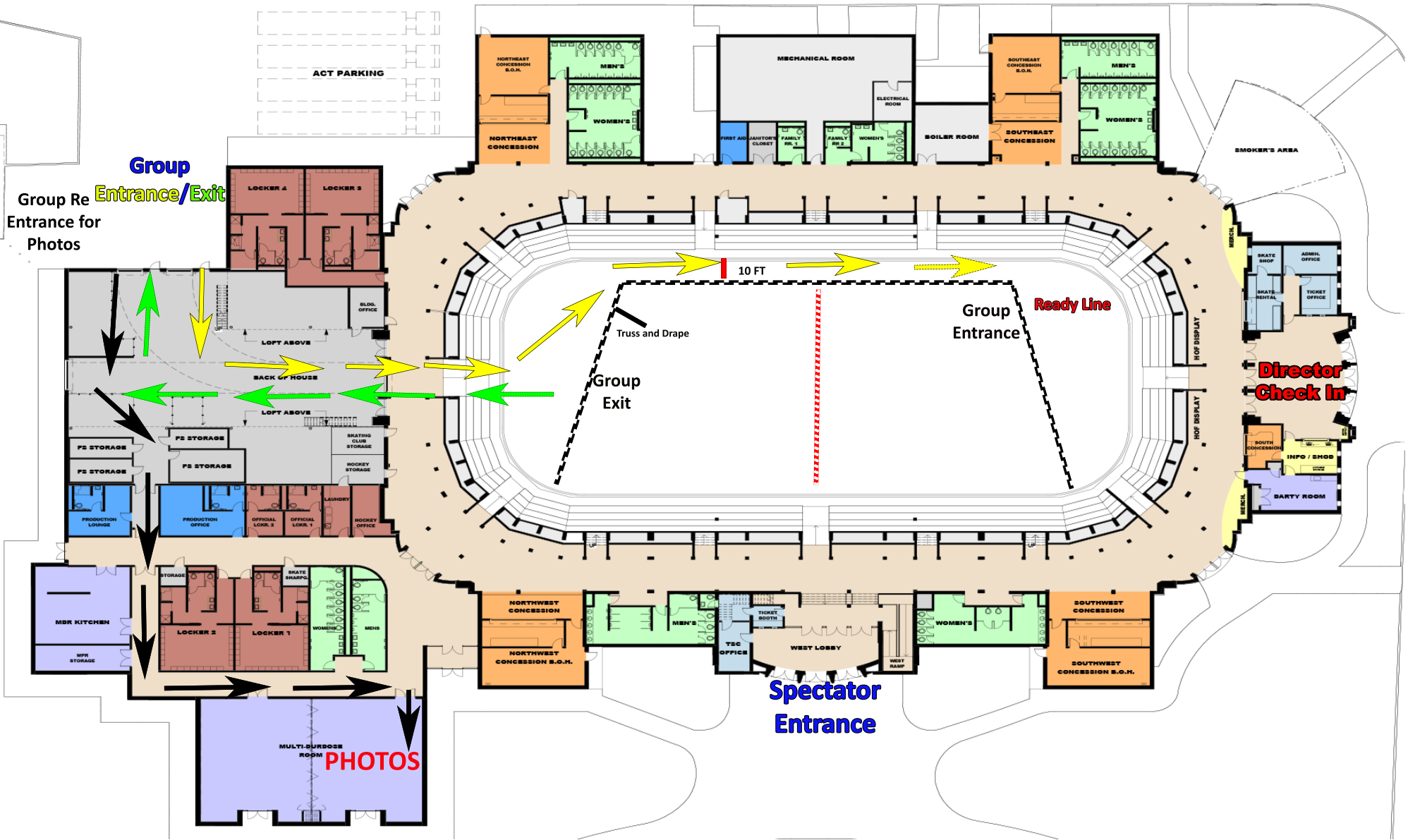

**Group Entrance/Exit**  
Group Re Entrance for Photos

LOCKER 4 LOCKER 3

NORTHEAST CONCESSION S.O.H.  
NORTHEAST CONCESSION  
MEN'S  
WOMEN'S

MECHANICAL ROOM  
ELECTRICAL ROOM  
BOILER ROOM  
FIRST AID JANITORS CLOSET  
FAMILY RR 1  
FAMILY RR 2  
WOMEN'S

SOUTHEAST CONCESSION S.O.H.  
SOUTHEAST CONCESSION  
MEN'S  
WOMEN'S

SMOKER'S AREA

SKATE SHOP  
SKATE RENTAL  
ADMIRAL OFFICE  
TICKET OFFICE

**Director Check In**

SOUTH CONCESSION  
INFO / SHOP  
PARTY ROOM

NORTHWEST CONCESSION  
NORTHWEST CONCESSION S.O.H.

MEN'S  
TICKET BOOTH  
TSC OFFICE

WEST LOBBY  
WEST RAMP

WOMEN'S  
SOUTHWEST CONCESSION  
SOUTHWEST CONCESSION S.O.H.

SKATE SHOPS  
LOCKER 2  
LOCKER 1  
MEN'S  
WOMEN'S

MULTI-PURPOSE ROOM  
**PHOTOS**

**Spectator Entrance**

Group Entrance  
**Ready Line**

Group Exit

10 FT

Truss and Drape



## Percussion World Championship Competition Area Hobart Arena, Troy, OH

All WGI contest sites must have a minimum of seventy by one hundred feet (70' x 100') to accommodate a "safety zone" of five (5) feet from any spectator seating. If no spectators are seated on the left and right sides, then the safety zone will be eliminated on the left and right sides of the competition area and extend to a maximum of 72' X 106',

All performing groups must be prepared to perform within the competition area. Floors (tarps) may not extend into the safety zones per rules found in the WGI Adjudication Manual and Rulebook

