



**Percussion World Championships
Hobart Arena Site Info
255 Adams St.
Troy, OH 45373**

- Parking for ensembles and spectators is abundant. See maps for details and traffic flow.
- Dressing facilities are very limited. Please come in competitive attire.
- All warm ups will be conducted in the parking lot of the southwest side of the building. There are two tents in the warm up parking lot that may be utilized as well. Please see logistical schedule for tent times.
- A floor to ceiling black drape will adorn the back wall of the arena, covering entrances and exits.
- A black tarp will cover the entire competitive floor.
- The contest floor is 72' x 106'. Please see the floor plan for more details.
- Height of the facility is more than adequate.
- Equipment trucks must be moved 45 minutes after an ensembles contest completion.
- Please report to Performance Check In no earlier than your listed report time. Performance Check In times are listed in the logistical schedule. Participant wristbands will allow entrance at regular doors.

REMINDER - Your ensemble MUST check in at Championship Headquarters in the Boesch Lounge at UD ARENA prior to your prelims performance at the Nutter Center to pick up all contest materials. Those ensembles who do not check in at Championship Headquarters may be denied entrance to the facility.

WGI Percussion World Championships

Hobart Arena

Troy, OH

Spectator Parking

Spectator Entrance

Group Entrance and Exit

Hobart Arena

Bus and Truck Entrance

**Alpha Lot
Warm up**

A B

Bus Drop Off

Truck Parking

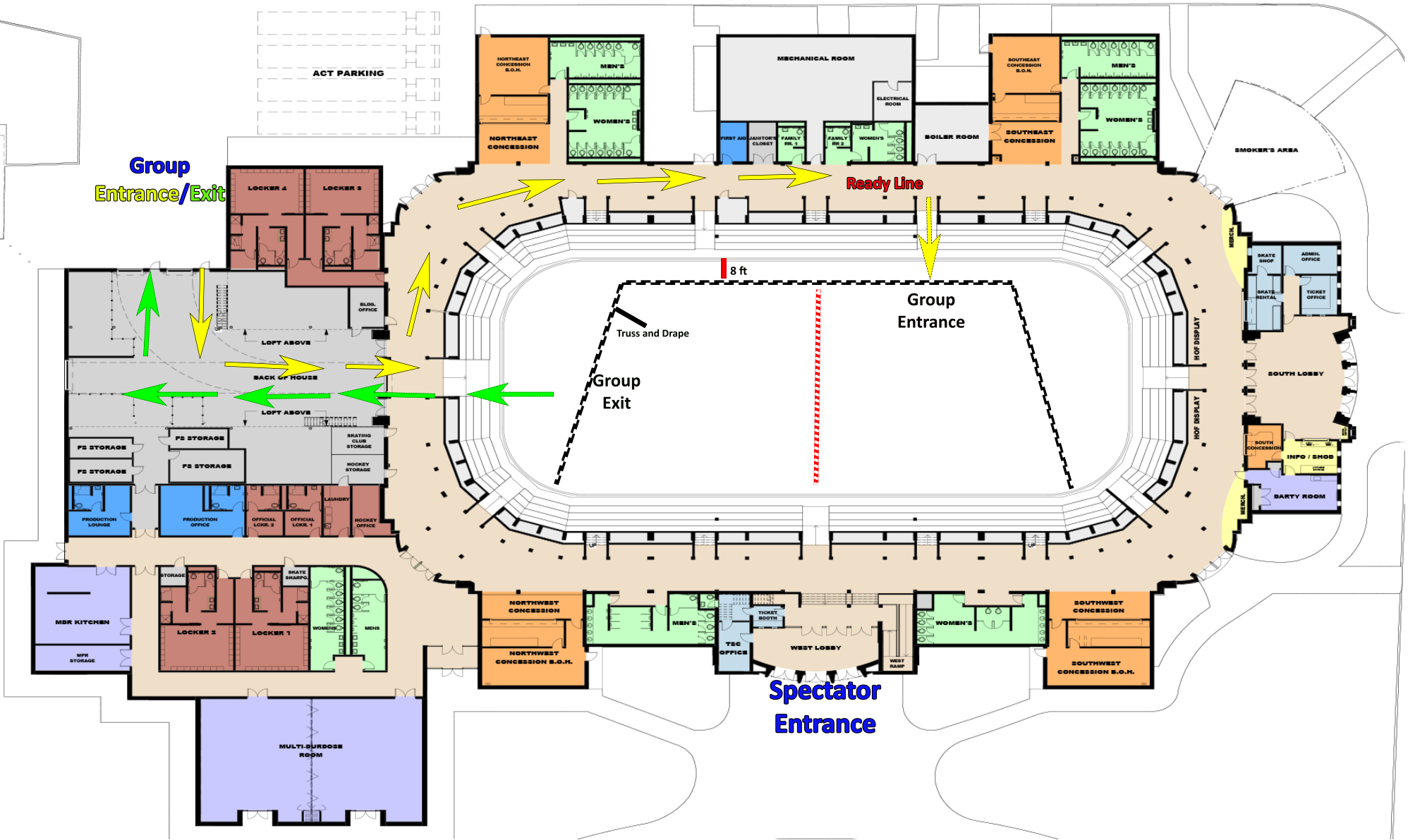

Group
Entrance/Exit

Ready Line

8 ft

Group
Entrance

Group
Exit

Spectator
Entrance



Percussion World Championship Competition Area Hobart Arena, Troy, OH

All WGI contest sites must have a minimum of seventy by one hundred feet (70' x 100') to accommodate a "safety zone" of five (5) feet from any spectator seating. If no spectators are seated on the left and right sides, then the safety zone will be eliminated on the left and right sides of the competition area and extend to a maximum of 72' X 106',

All performing groups must be prepared to perform within the competition area. Floors (tarps) may not extend into the safety zones per rules found in the WGI Adjudication Manual and Rulebook

